



Aluminios Iberica, Lda



PALA - MIGUEL & REIS, LDA.



EXEMPLO CONCRETO

Painéis Sandwich - Perfis - Chapas - Remates - Acessórios



ALUMÍNIOS DE VISEU, LDA.



ANGULAR - Alumínios, Lda.

Catálogo COR 70 C16 ST



COR 70 C16 ST
Perfiles a escala

COR 70 C16 ST
Profiles to scale

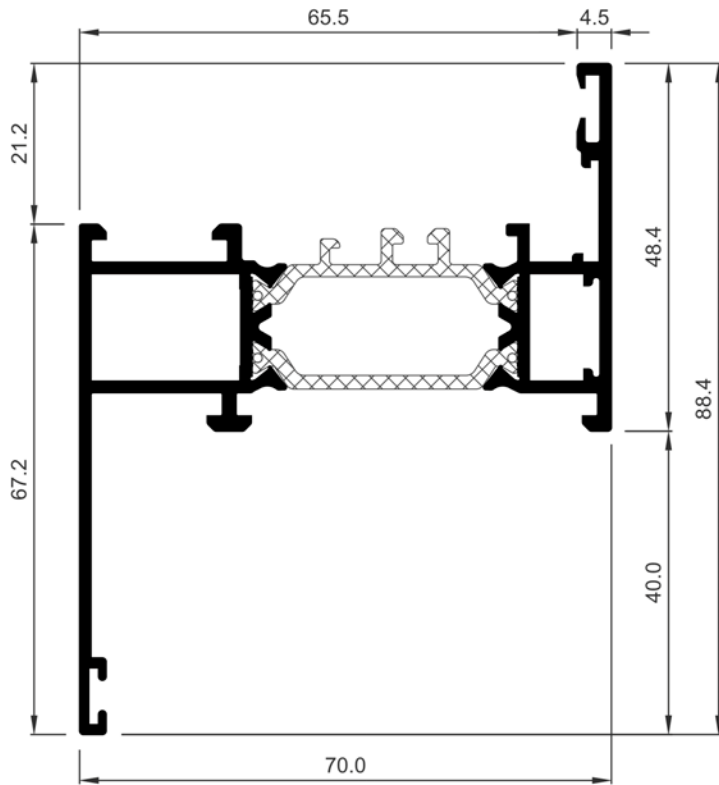

772440	
Descripción Description	Marco con solape de 40 mm Frame with 40 mm overlap
Peso Weight (g/m)	1449,5
Superficie Surface (dm ² /m)	56,44
Ix (cm ⁴)	14
Iy (cm ⁴)	34,27
Escuadra principal Main cleat	914015
Troquel Punch tool	386799
Escuadra secundaria Secondary cleat	327921
Escuadra alineamiento Alignment cleat	296838 960023

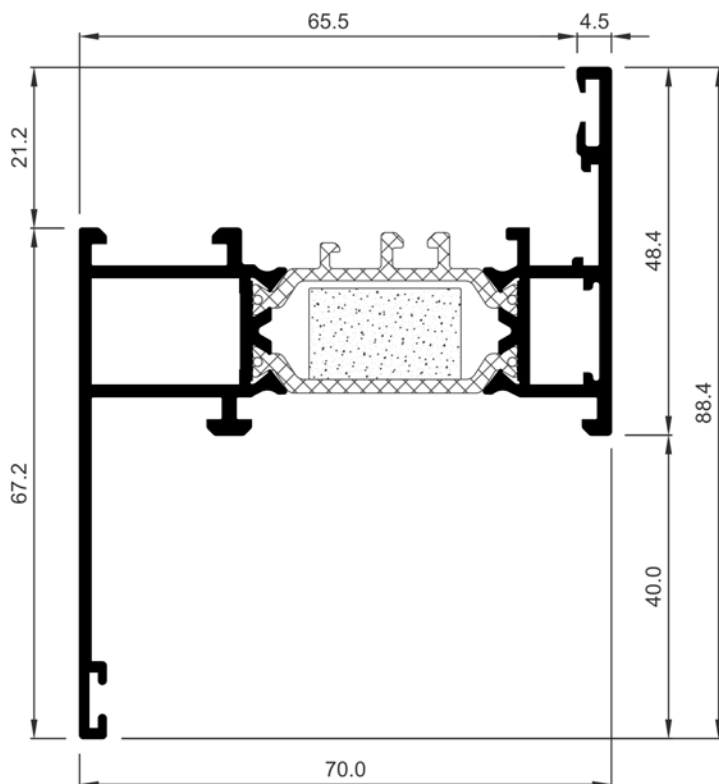

772441	
Descripción Description	Marco HI con solape de 40 mm Frame with 40 mm overlap HI
Peso Weight (g/m)	1449,5
Superficie Surface (dm ² /m)	56,44
Ix (cm ⁴)	14
Iy (cm ⁴)	34,27
Escuadra principal Main cleat	914015
Troquel Punch tool	386799
Escuadra secundaria Secondary cleat	327921
Escuadra alineamiento Alignment cleat	296838 960023

COR 70 C16 ST
Perfiles a escala

COR 70 C16 ST
Profiles to scale

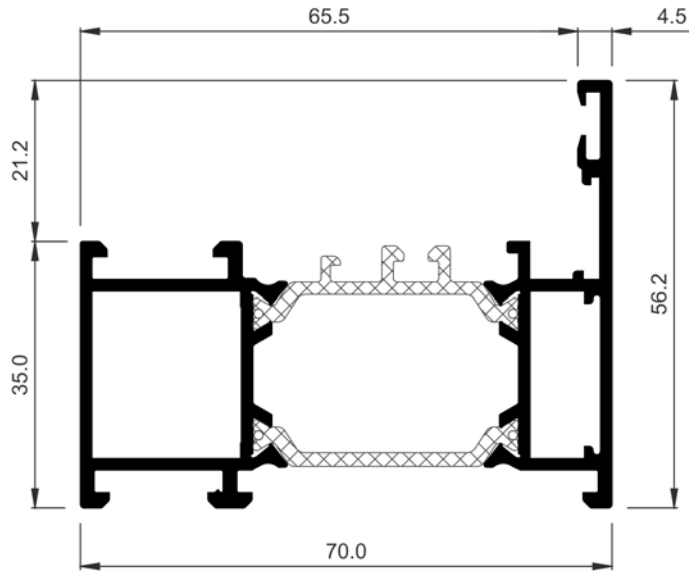

COR-6730	
Descripción Description	Marco alto ventana apertura interior Inner opening high window frame
Peso Weight (g/m)	1409
Superficie Surface (dm ² /m)	53,78
I_x (cm ⁴)	8,2
I_y (cm ⁴)	30,26
Escuadra principal Main cleat	396710
Troquel Punch tool	386799
Escuadra secundaria Secondary cleat	366733
Escuadra alineamiento Alignment cleat	296838

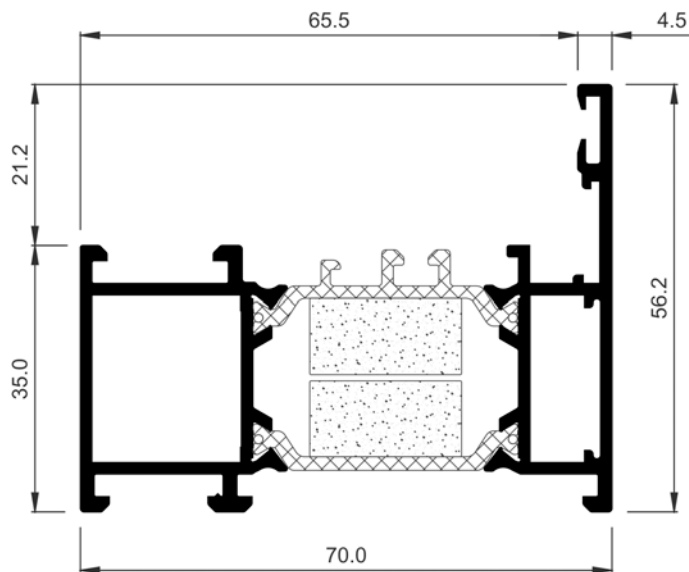

COR-6731	
Descripción Description	Marco alto ventana apertura interior HI Inner opening high window frame HI
Peso Weight (g/m)	1409
Superficie Surface (dm ² /m)	53,78
I_x (cm ⁴)	8,2
I_y (cm ⁴)	30,26
Escuadra principal Main cleat	396710
Troquel Punch tool	386799
Escuadra secundaria Secondary cleat	366733
Escuadra alineamiento Alignment cleat	296838

COR 70 C16 ST
Perfiles a escala

COR 70 C16 ST
Profiles to scale

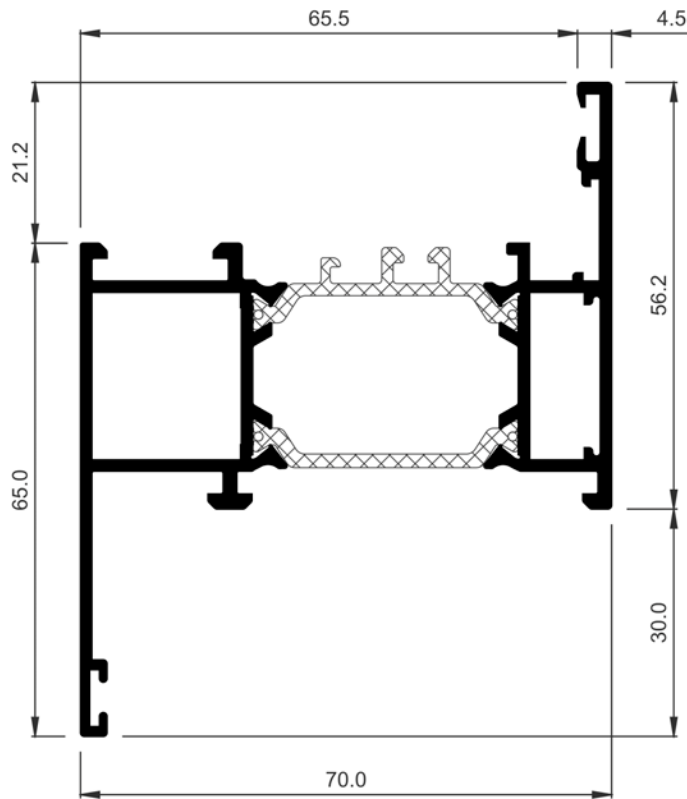

COR-6732	
Descripción Description	Marco alto ventana A.I. con solape Inner opening high window frame with 30 mm overlap
Peso Weight (g/m)	1533,2
Superficie Surface (dm ² /m)	60,85
Ix (cm⁴)	14,73
Iy (cm⁴)	36,17
Escuadra principal Main cleat	396710
Troquel Punch tool	386799
Escuadra secundaria Secondary cleat	366733
Escuadra alineamiento Alignment cleat	296838 960023

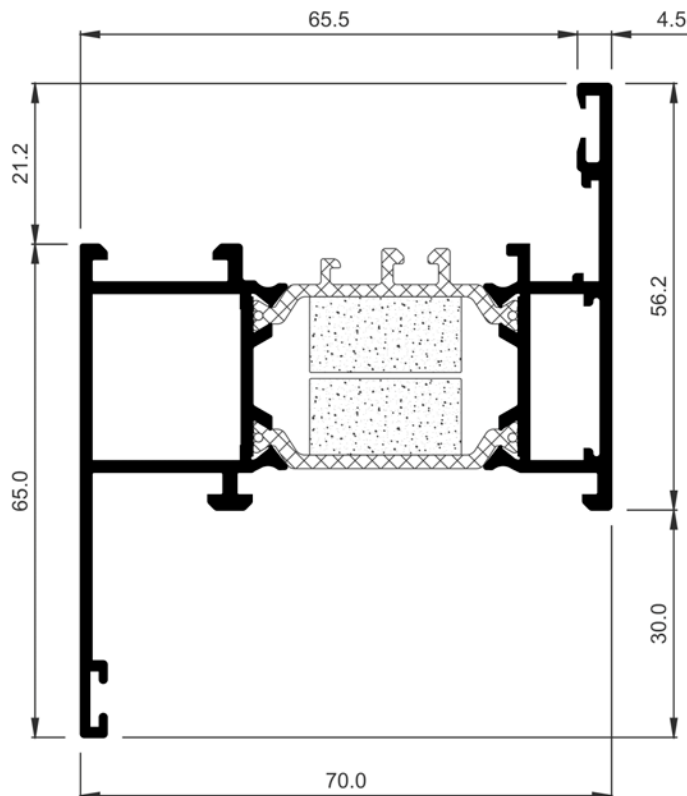

COR-6733	
Descripción Description	Marco alto ventana apertura interior con solape HI Inner opening high window frame with 30 mm overlap HI
Peso Weight (g/m)	1533,2
Superficie Surface (dm ² /m)	60,85
Ix (cm⁴)	14,73
Iy (cm⁴)	36,17
Escuadra principal Main cleat	396710
Troquel Punch tool	386799
Escuadra secundaria Secondary cleat	366733
Escuadra alineamiento Alignment cleat	296838 960023

COR 70 C16 ST
Perfiles a escala

COR 70 C16 ST
Profiles to scale

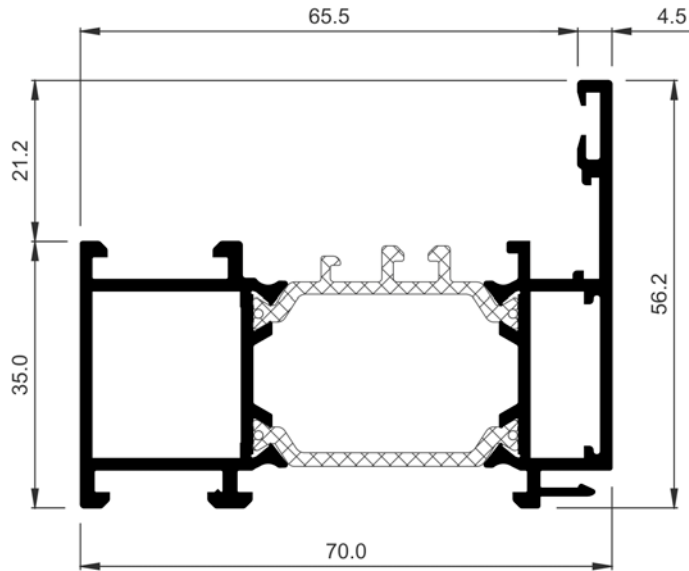

COR-6780	
Descripción Description	Marco alto ventana con enganche exterior High window frame with exterior hook
Peso Weight (g/m)	1425,2
Superficie Surface (dm ² /m)	55,15
Ix (cm⁴)	8,41
Iy (cm⁴)	30,11
Escuadra principal Main cleat	396710
Troquel Punch tool	386799
Escuadra secundaria Secondary cleat	366733
Escuadra alineamiento Alignment cleat	296838
Observaciones Observations	Para el mecanizado de los enganches usar el troquel de escuadras 347799 For hooks machining use the punch tool 347799

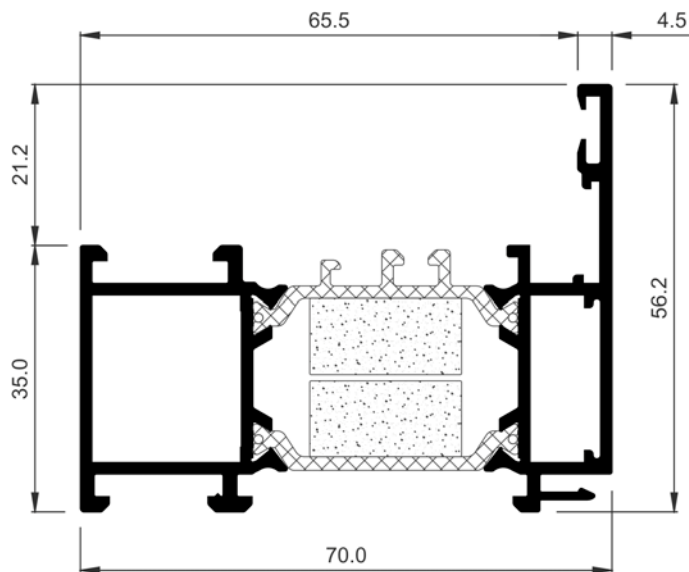

COR-6781	
Descripción Description	Marco alto ventana con enganche exterior HI High window frame with exterior hook HI
Peso Weight (g/m)	1425,2
Superficie Surface (dm ² /m)	55,15
Ix (cm⁴)	8,41
Iy (cm⁴)	30,11
Escuadra principal Main cleat	396710
Troquel Punch tool	386799
Escuadra secundaria Secondary cleat	366733
Escuadra alineamiento Alignment cleat	296838
Observaciones Observations	Para el mecanizado de los enganches usar el troquel de escuadras 347799 For hooks machining use the punch tool 347799

COR 70 C16 ST
Perfiles a escala

COR 70 C16 ST
Profiles to scale

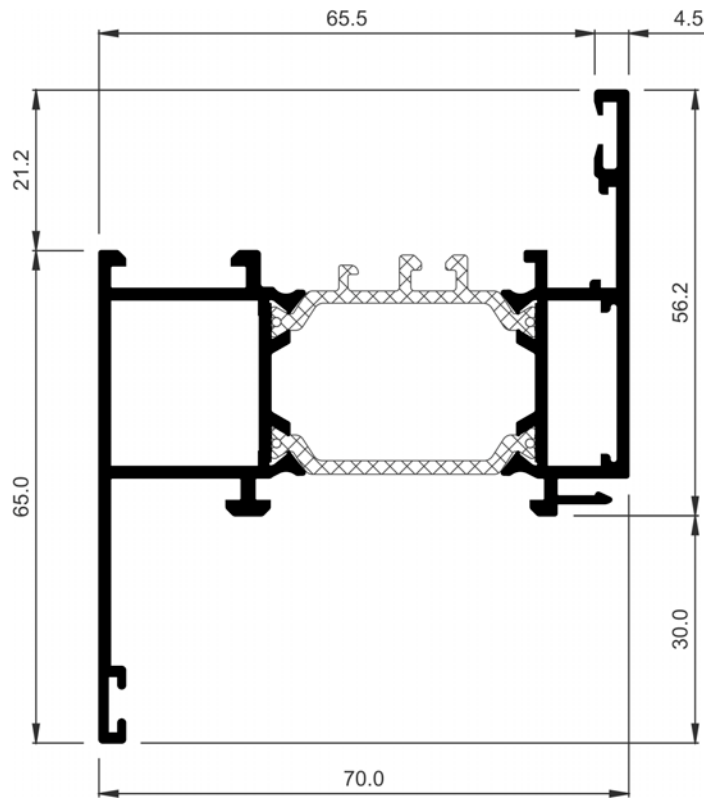

COR-6782	
Descripción Description	Marco alto ventana con enganche exterior y solape High window frame with exterior hook and overlap
Peso Weight (g/m)	1549,4
Superficie Surface (dm ² /m)	62,22
Ix (cm⁴)	14,87
Iy (cm⁴)	36,06
Escuadra principal Main cleat	396710
Troquel Punch tool	386799
Escuadra secundaria Secondary cleat	366733
Escuadra alineamiento Alignment cleat	296838
Observaciones Observations	960023
	Para el mecanizado de los enganches usar el troquel de escuadras 347799 For hooks machining use the punch tool 347799

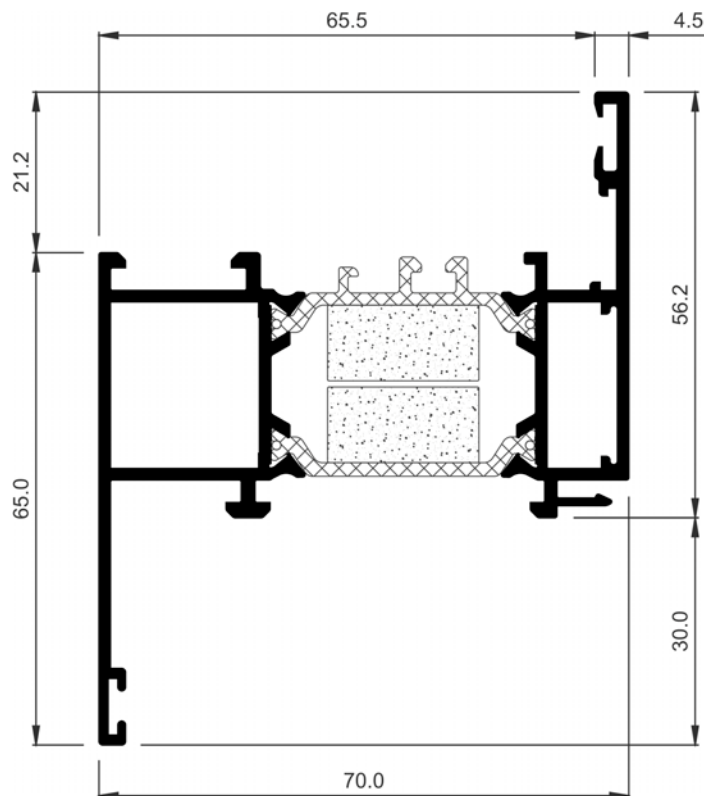

COR-6783	
Descripción Description	Marco alto ventana con enganche exterior y solape HI High window frame with exterior hook and overlap HI
Peso Weight (g/m)	1549,4
Superficie Surface (dm ² /m)	62,22
Ix (cm⁴)	14,87
Iy (cm⁴)	36,06
Escuadra principal Main cleat	396710
Troquel Punch tool	386799
Escuadra secundaria Secondary cleat	366733
Escuadra alineamiento Alignment cleat	296838
Observaciones Observations	960023
	Para el mecanizado de los enganches usar el troquel de escuadras 347799 For hooks machining use the punch tool 347799

COR 70 C16 ST
Perfiles a escala

COR 70 C16 ST
Profiles to scale

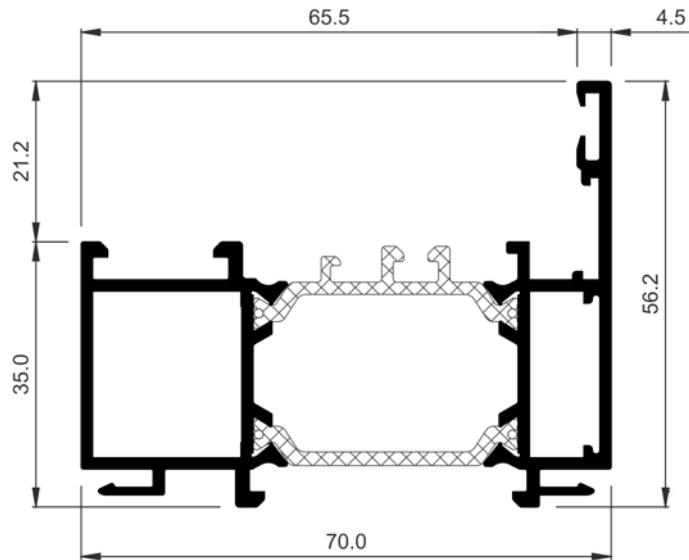

COR-6784	
Descripción Description	Marco alto ventana con doble enganche High window frame with double hook
Peso Weight (g/m)	1414,4
Superficie Surface (dm ² /m)	55,54
Ix (cm⁴)	8,26
Iy (cm⁴)	29,36
Escuadra principal Main cleat	396710
Troquel Punch tool	386799
Escuadra secundaria Secondary cleat	366733
Escuadra alineamiento Alignment cleat	296838
Observaciones Observations	Para el mecanizado de los enganches usar el troquel de escuadras 347799 For hooks machining use the punch tool 347799

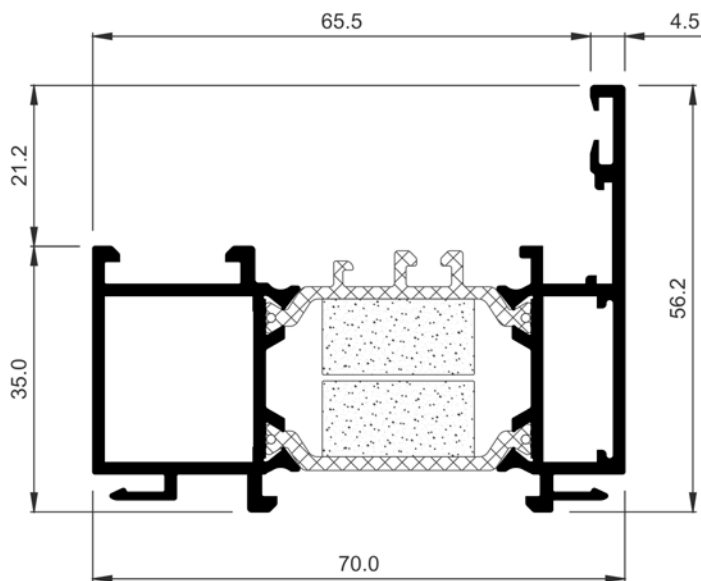

COR-6785	
Descripción Description	Marco alto ventana con doble enganche HI High window frame with double hook HI
Peso Weight (g/m)	1414,4
Superficie Surface (dm ² /m)	55,54
Ix (cm⁴)	8,26
Iy (cm⁴)	29,36
Escuadra principal Main cleat	396710
Troquel Punch tool	386799
Escuadra secundaria Secondary cleat	366733
Escuadra alineamiento Alignment cleat	296838
Observaciones Observations	Para el mecanizado de los enganches usar el troquel de escuadras 347799 For hooks machining use the punch tool 347799

COR 70 C16 ST
Perfiles a escala

COR 70 C16 ST
Profiles to scale

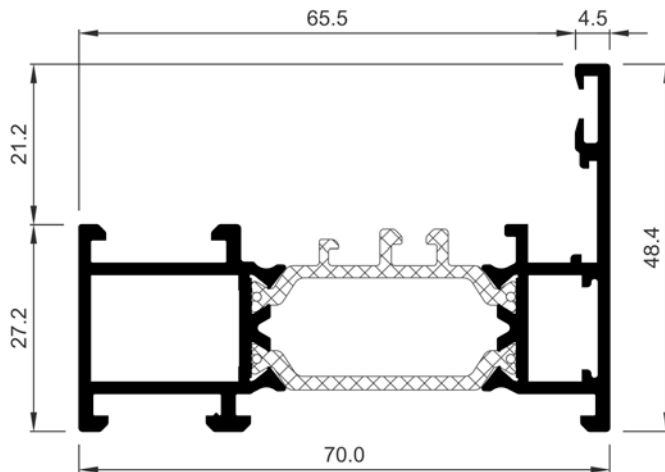

COR-7930	
Descripción Description	Marco ventana apertura interior Inner opening window frame
Peso Weight (g/m)	1284,8
Superficie Surface (dm ² /m)	47,37
Ix (cm⁴)	4,9
Iy (cm⁴)	26,73
Escuadra principal Main cleat	914015
Troquel Punch tool	386799
Escuadra secundaria Secondary cleat	327921
Escuadra alineamiento Alignment cleat	296838

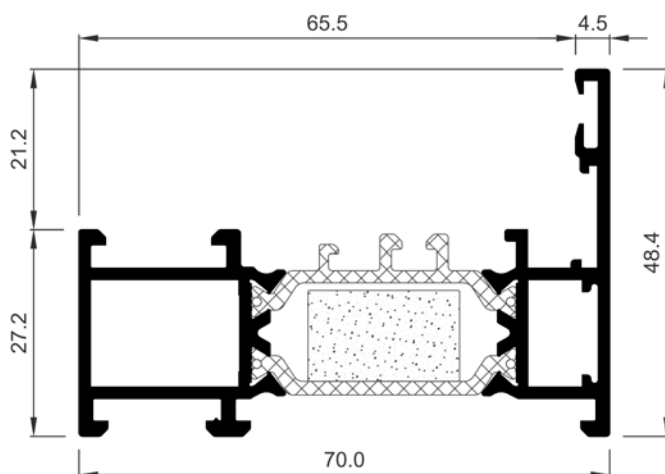

COR-7931	
Descripción Description	Marco ventana apertura interior HI Inner opening HI window frame
Peso Weight (g/m)	1284,8
Superficie Surface (dm ² /m)	47,37
Ix (cm⁴)	4,9
Iy (cm⁴)	26,73
Escuadra principal Main cleat	914015
Troquel Punch tool	386799
Escuadra secundaria Secondary cleat	327921
Escuadra alineamiento Alignment cleat	296838

COR 70 C16 ST
Perfiles a escala

COR 70 C16 ST
Profiles to scale

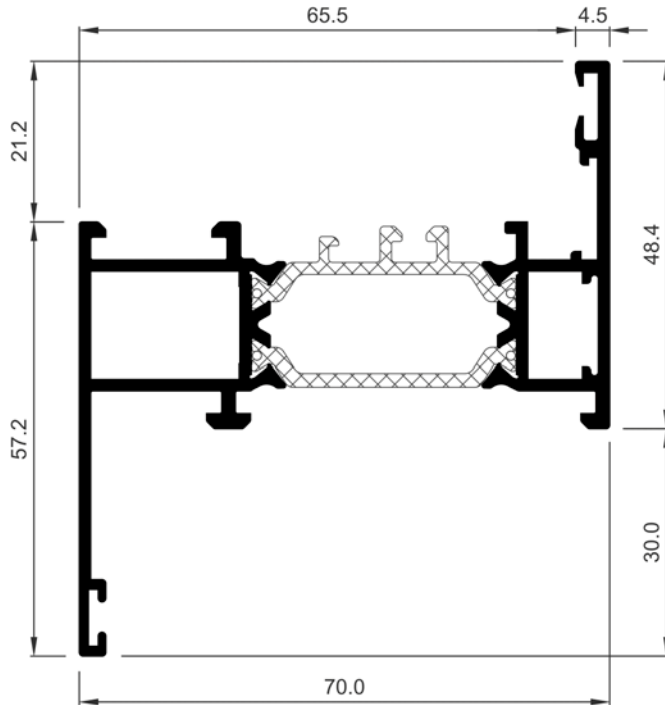

COR-7932	
Descripción Description	Marco ventana apertura interior con solape de 30 mm Inner opening window frame with 30 mm overlap
Peso Weight (g/m)	1409
Superficie Surface (dm ² /m)	54,44
Ix (cm⁴)	10,15
Iy (cm⁴)	32,61
Escuadra principal Main cleat	914015
Troquel Punch tool	386799
Escuadra secundaria Secondary cleat	327921
Escuadra alineamiento Alignment cleat	296838 960023

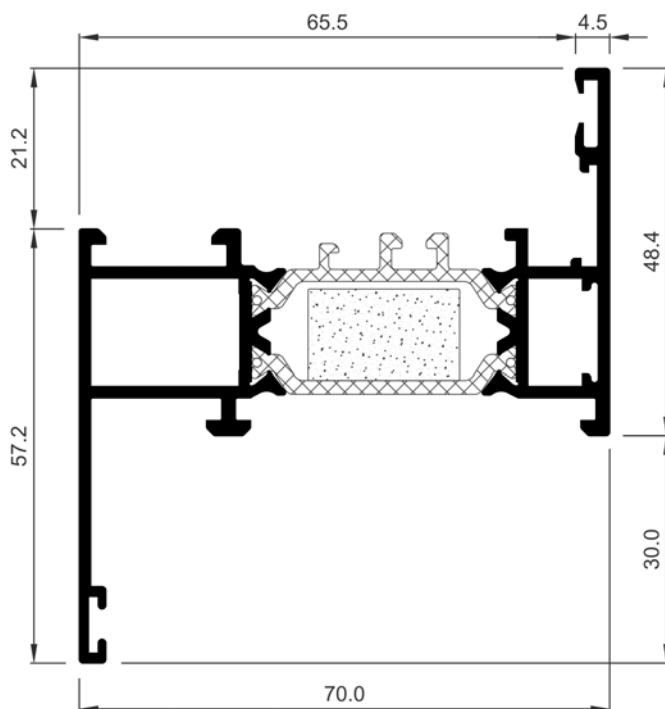

COR-7933	
Descripción Description	Marco ventana apertura interior HI con solape de 30 mm Inner opening HI window frame with 30 mm overlap
Peso Weight (g/m)	1409
Superficie Surface (dm ² /m)	54,44
Ix (cm⁴)	10,15
Iy (cm⁴)	32,61
Escuadra principal Main cleat	914015
Troquel Punch tool	386799
Escuadra secundaria Secondary cleat	327921
Escuadra alineamiento Alignment cleat	296838 960023

COR 70 C16 ST
Perfiles a escala

COR 70 C16 ST
Profiles to scale

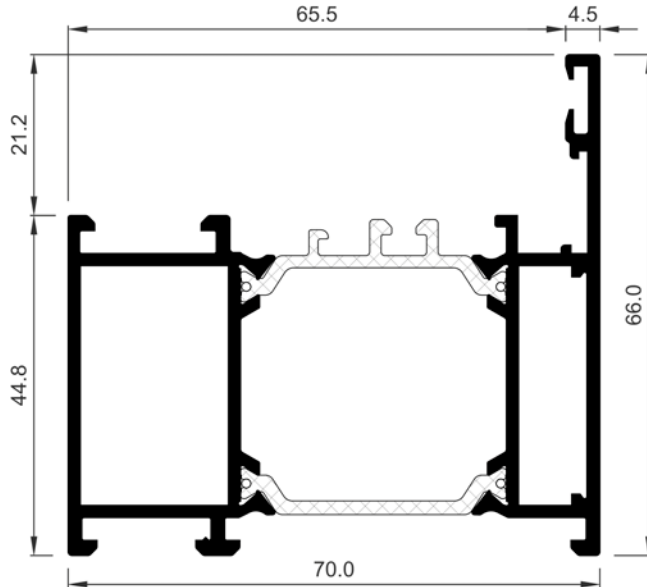

COR-7935	
Descripción Description	Marco balconera apertura interior Inner opening balcony frame
Peso Weight (g/m)	1625
Superficie Surface (dm ² /m)	61,3
Ix (cm⁴)	14,49
Iy (cm⁴)	36,44
Escuadra principal Main cleat	397907
Troquel Punch tool	386799
Escuadra secundaria Secondary cleat	357924
Escuadra alineamiento Alignment cleat	296838

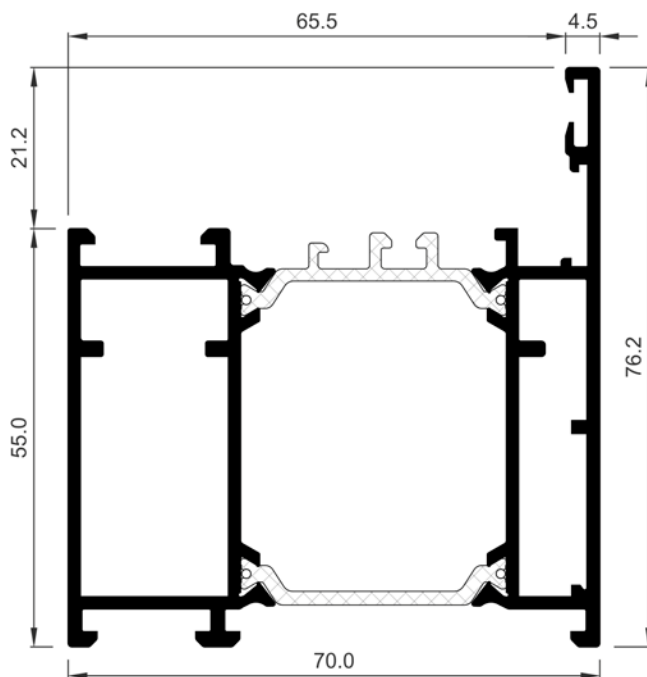

COR-7936	
Descripción Description	Marco balconera embutir recogedor Balcony frame scoop cram
Peso Weight (g/m)	1859,9
Superficie Surface (dm ² /m)	71,48
Ix (cm⁴)	23,5
Iy (cm⁴)	42,87
Escuadra principal Main cleat	397907
Troquel Punch tool	386799
Escuadra secundaria Secondary cleat	357924
Escuadra alineamiento Alignment cleat	296838

COR 70 C16 ST
Perfiles a escala

COR 70 C16 ST
Profiles to scale

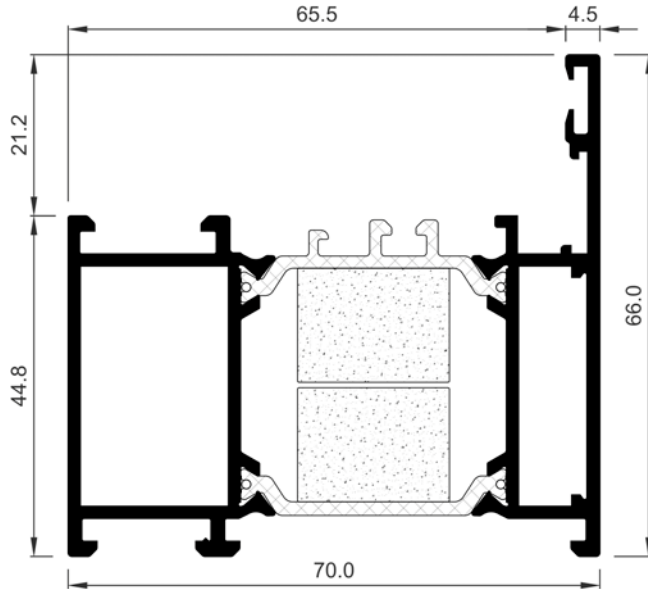

COR-7937	
Descripción Description	Marco balconera HI Balcony frame HI
Peso Weight (g/m)	1625
Superficie Surface (dm ² /m)	61,3
Ix (cm⁴)	14,49
Iy (cm⁴)	36,44
Escuadra principal Main cleat	397907
Troquel Punch tool	386799
Escuadra secundaria Secondary cleat	357924
Escuadra alineamiento Alignment cleat	296838

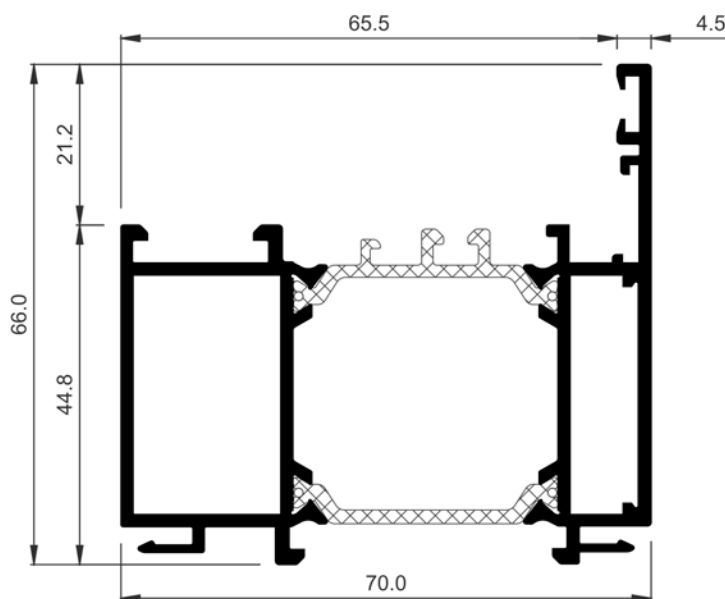

COR-8071	
Descripción Description	Marco balconera con enganches Balcony frame with hooks
Peso Weight (g/m)	1633,1
Superficie Surface (dm ² /m)	63,33
Ix (cm⁴)	14,54
Iy (cm⁴)	35,46
Escuadra principal Main cleat	397907
Troquel Punch tool	347799
	386799
Escuadra secundaria Secondary cleat	357924
Escuadra alineamiento Alignment cleat	296838
Observaciones Observations	Para el mecanizado de los enganches usar el troquel de escuadras 347799 For hooks machining use the punch tool 347799

COR 70 C16 ST
Perfiles a escala

COR 70 C16 ST
Profiles to scale

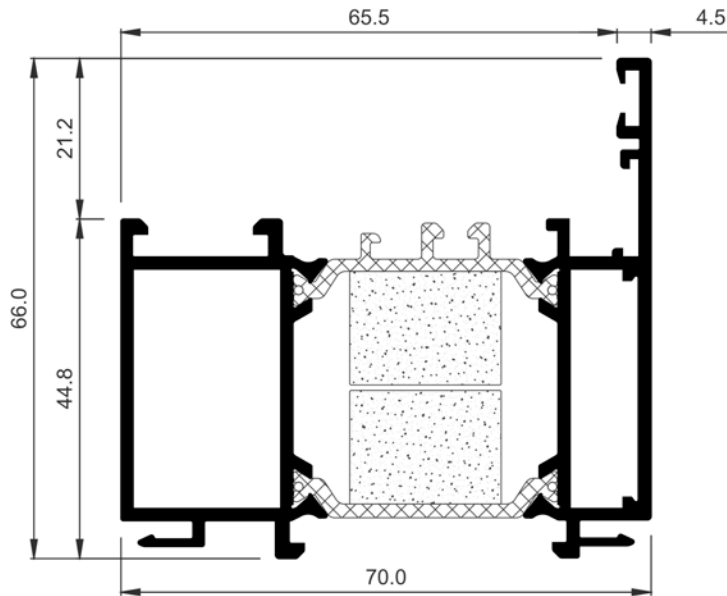

COR-8072	
Descripción Description	Marco balconera con enganches HI Balcony frame with hooks HI
Peso Weight (g/m)	1633,1
Superficie Surface (dm ² /m)	63,33
Ix (cm ⁴)	14,54
Iy (cm ⁴)	35,46
Escuadra principal Main cleat	397907
Troquel Punch tool	347799 386799
Escuadra secundaria Secondary cleat	357924
Escuadra alineamiento Alignment cleat	296838
Observaciones Observations	Para el mecanizado de los enganches usar el troquel de escuadras 347799 For hooks machining use the punch tool 347799

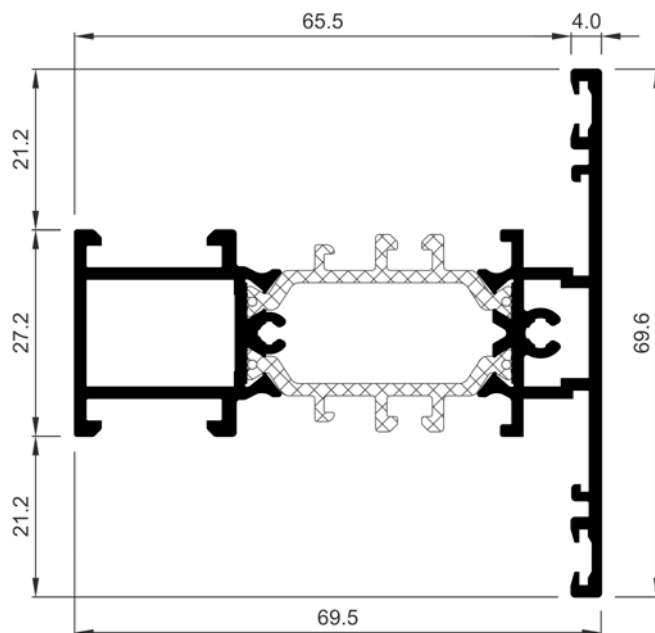

COR-7970	
Descripción Description	Travesaño ventana apertura interior Inner opening window transom
Peso Weight (g/m)	1457,6
Superficie Surface (dm ² /m)	56,87
Ix (cm ⁴)	8,05
Iy (cm ⁴)	29,95
Fresa Miller	327991
Troquel Punch tool	386799
Tope travesaño interior Internal transom stop	920140
Tope travesaño exterior External transom stop	327971

COR 70 C16 ST
Perfiles a escala

COR 70 C16 ST
Profiles to scale

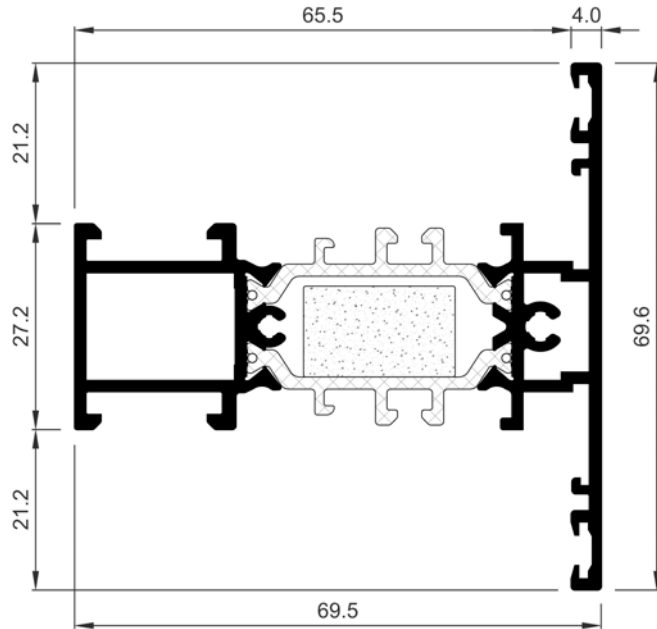

COR-7971	
Descripción Description	Travesaño ventana apertura interior HI Inner opening HI window transom
Peso Weight (g/m)	1457,6
Superficie Surface (dm ² /m)	56,87
Ix (cm⁴)	8,05
Iy (cm⁴)	29,95
Fresa Miller	327991
Troquel Punch tool	386799
Tope travesaño interior Internal transom stop	920140
Tope travesaño exterior External transom stop	327971

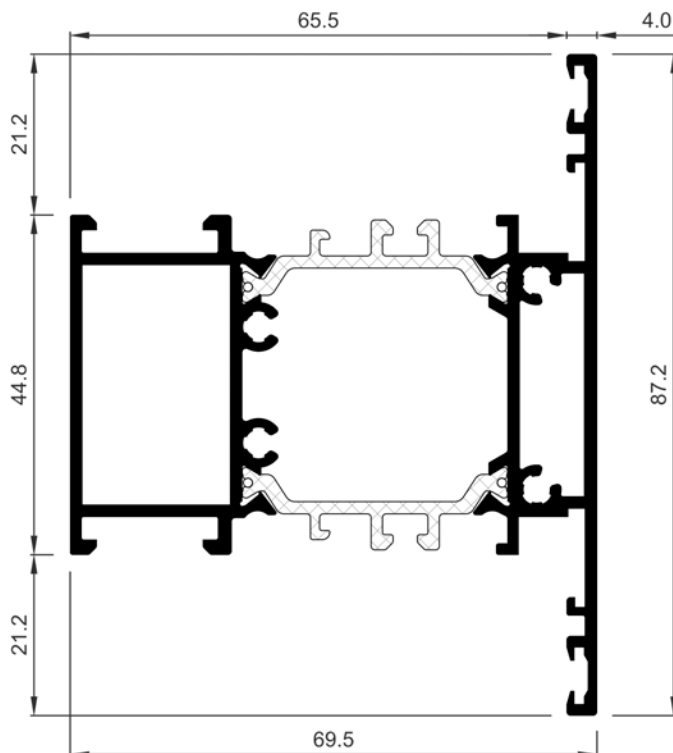

COR-7975	
Descripción Description	Travesaño balconera apertura interior Inner opening balcony transom
Peso Weight (g/m)	1849,1
Superficie Surface (dm ² /m)	72,49
Ix (cm⁴)	20,4
Iy (cm⁴)	40,32
Fresa Miller	327991
Troquel Punch tool	386799
Tope travesaño interior Internal transom stop	920150
Tope travesaño exterior External transom stop	327971

COR 70 C16 ST
Perfiles a escala

COR 70 C16 ST
Profiles to scale

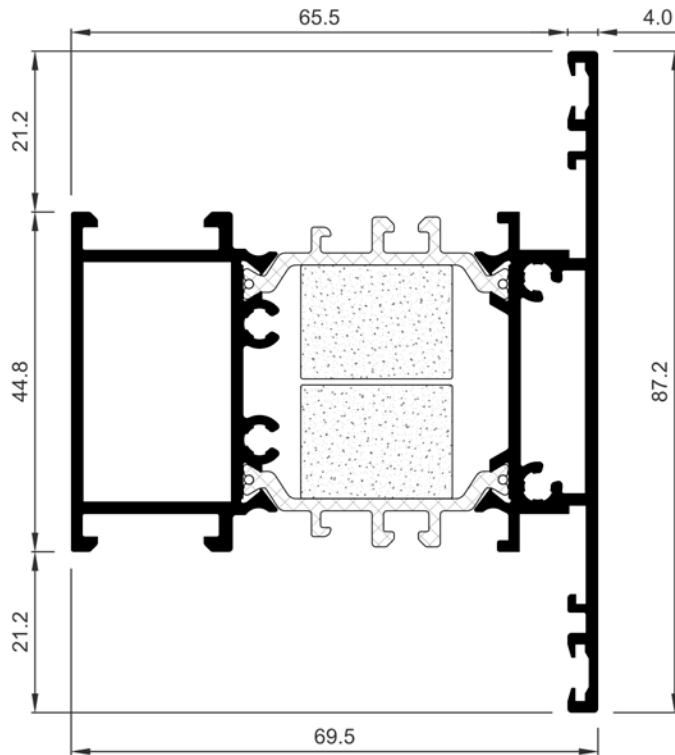

COR-7976	
Descripción Description	Travesaño balconera HI HI balcony transom
Peso Weight (g/m)	1849,1
Superficie Surface (dm ² /m)	72,49
Ix (cm⁴)	20,4
Iy (cm⁴)	40,32
Fresa Miller	327991
Troquel Punch tool	386799
Tope travesaño interior Internal transom stop	920150
Tope travesaño exterior External transom stop	327971

COR 70 C16 ST
Perfiles a escala

COR 70 C16 ST
Profiles to scale

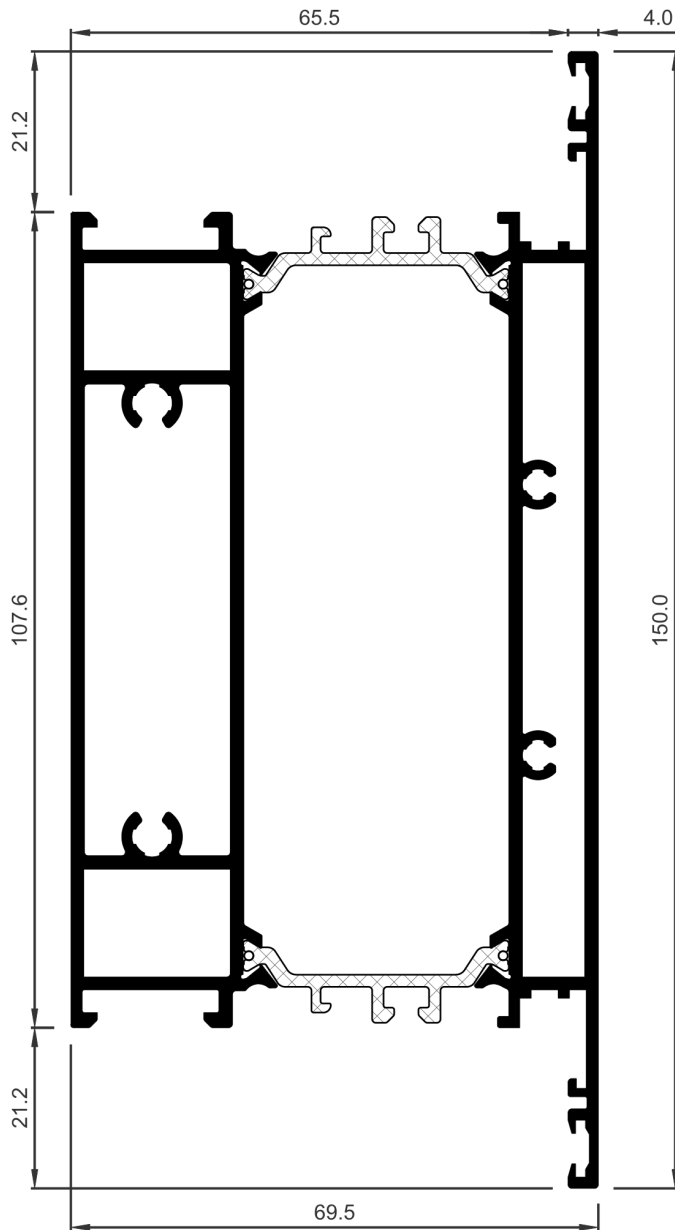

COR-7977	
Descripción Description	Travesaño de 150 mm 150 mm transom
Peso Weight (g/m)	3388,1
Superficie Surface (dm ² /m)	133,34
Ix (cm⁴)	160,11
Iy (cm⁴)	84,35
Fresa Miller	327991
Troquel Punch tool	386799
Tope travesaño interior Internal transom stop	920140
Tope travesaño exterior External transom stop	327971

COR 70 C16 ST
Perfiles a escala

COR 70 C16 ST
Profiles to scale

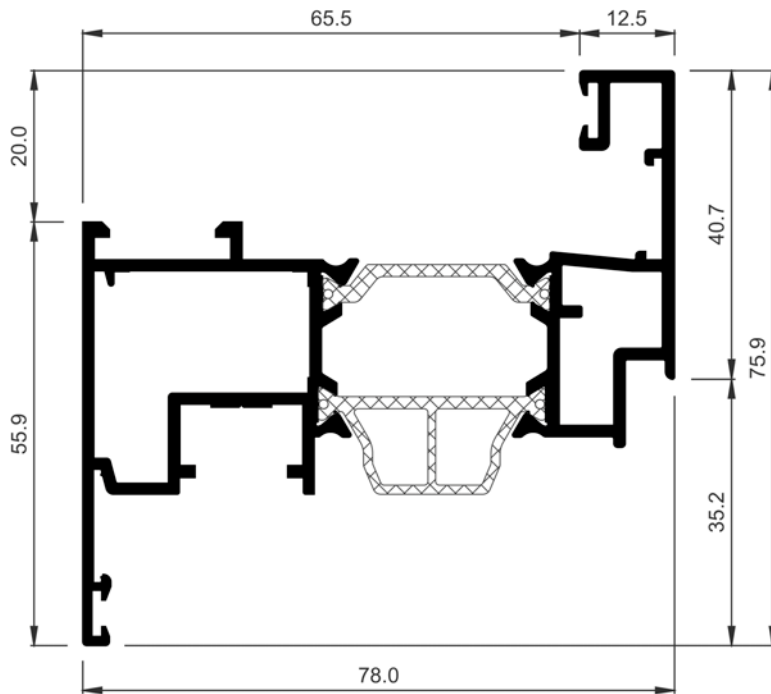

COR-6720	
Descripción Description	Hoja ventana apertura interior Inner opening window sash
Peso Weight (g/m)	1679
Superficie Surface (dm ² /m)	69,07
Ix (cm⁴)	13,96
Iy (cm⁴)	43,51
Escuadra principal Main cleat	396720
Troquel Punch tool	386799
Escuadra secundaria Secondary cleat	327921
Escuadra alineamiento Alignment cleat	296838
	920135

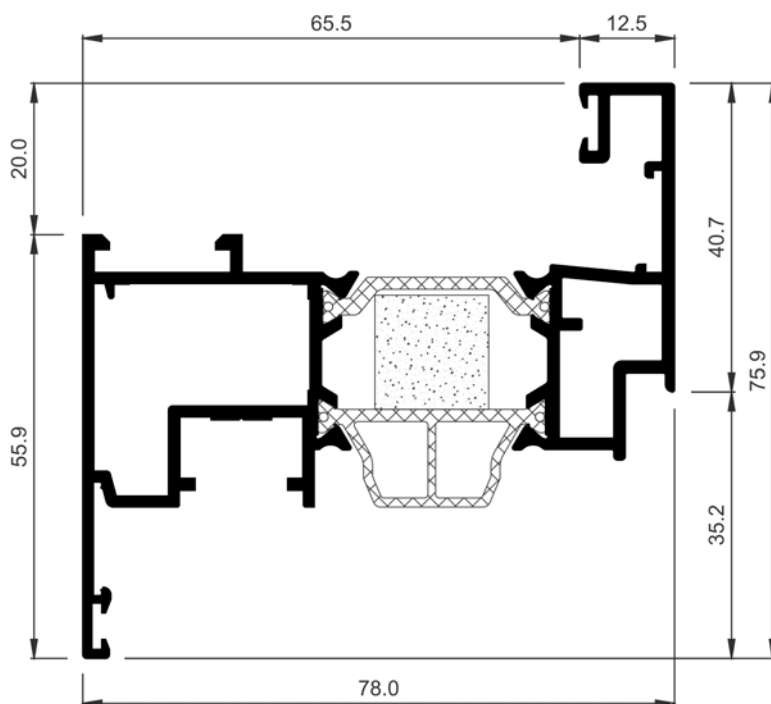

COR-6721	
Descripción Description	Hoja ventana apertura interior HI Inner opening window sash HI
Peso Weight (g/m)	1679
Superficie Surface (dm ² /m)	69,07
Ix (cm⁴)	13,96
Iy (cm⁴)	43,51
Escuadra principal Main cleat	396720
Troquel Punch tool	386799
Escuadra secundaria Secondary cleat	327921
Escuadra alineamiento Alignment cleat	296838
	920135

COR 70 C16 ST
Perfiles a escala

COR 70 C16 ST
Profiles to scale

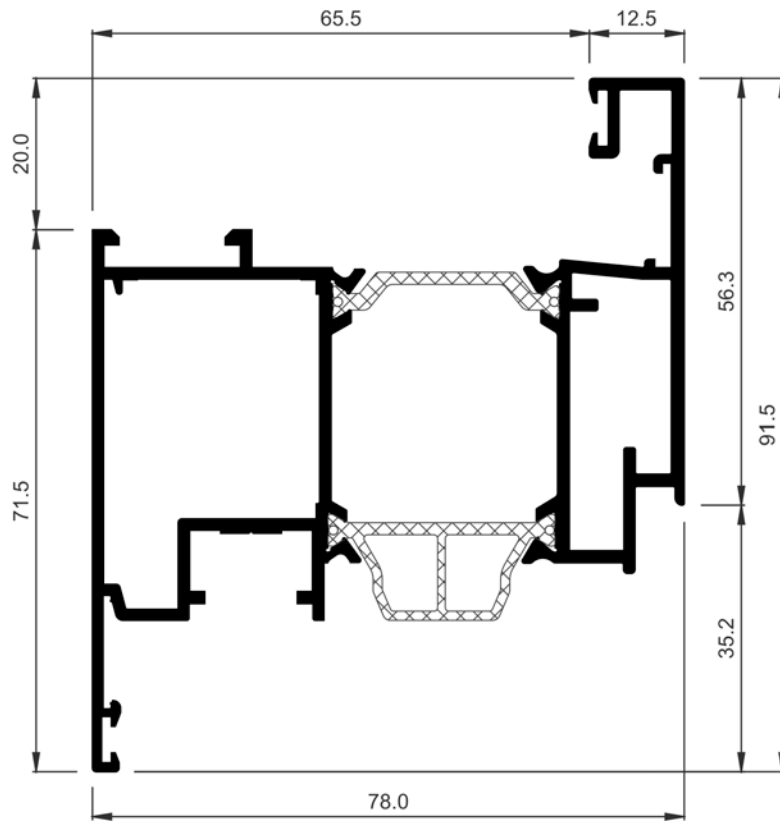

COR-6722	
Descripción Description	Hoja balconera apertura interior Inner opening balcony sash
Peso Weight (g/m)	1981,4
Superficie Surface (dm ² /m)	82,21
Ix (cm⁴)	28,46
Iy (cm⁴)	53,26
Escuadra principal Main cleat	396724
Troquel Punch tool	386799
Escuadra secundaria Secondary cleat	357924
Escuadra alineamiento Alignment cleat	296838
	920135

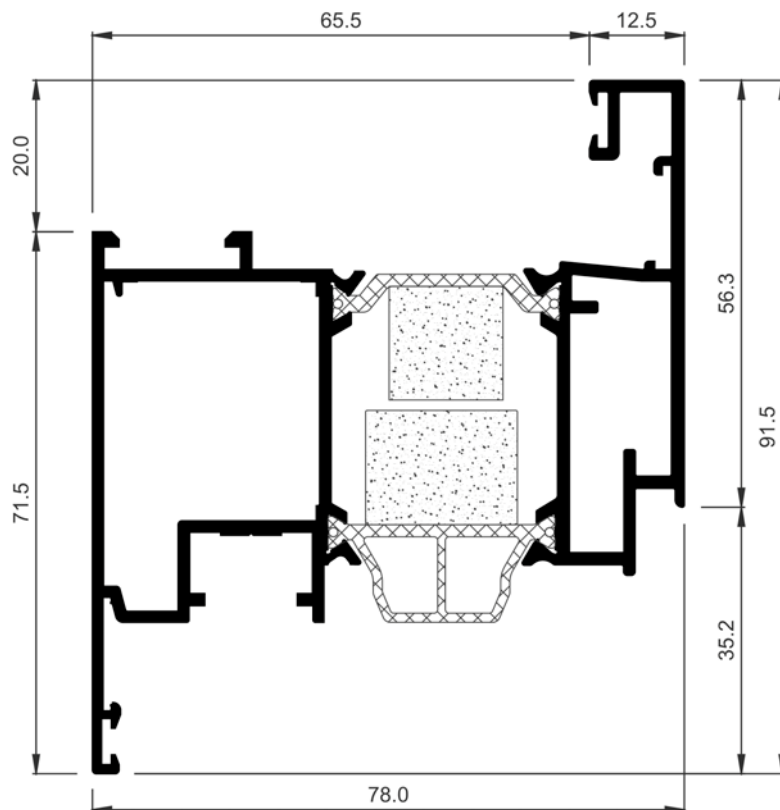

COR-6723	
Descripción Description	Hoja balconera apertura interior HI Inner opening balcony sash HI
Peso Weight (g/m)	1981,4
Superficie Surface (dm ² /m)	82,21
Ix (cm⁴)	28,46
Iy (cm⁴)	53,26
Escuadra principal Main cleat	396724
Troquel Punch tool	386799
Escuadra secundaria Secondary cleat	357924
Escuadra alineamiento Alignment cleat	296838
	920135

COR 70 C16 ST
Perfiles a escala

COR 70 C16 ST
Profiles to scale

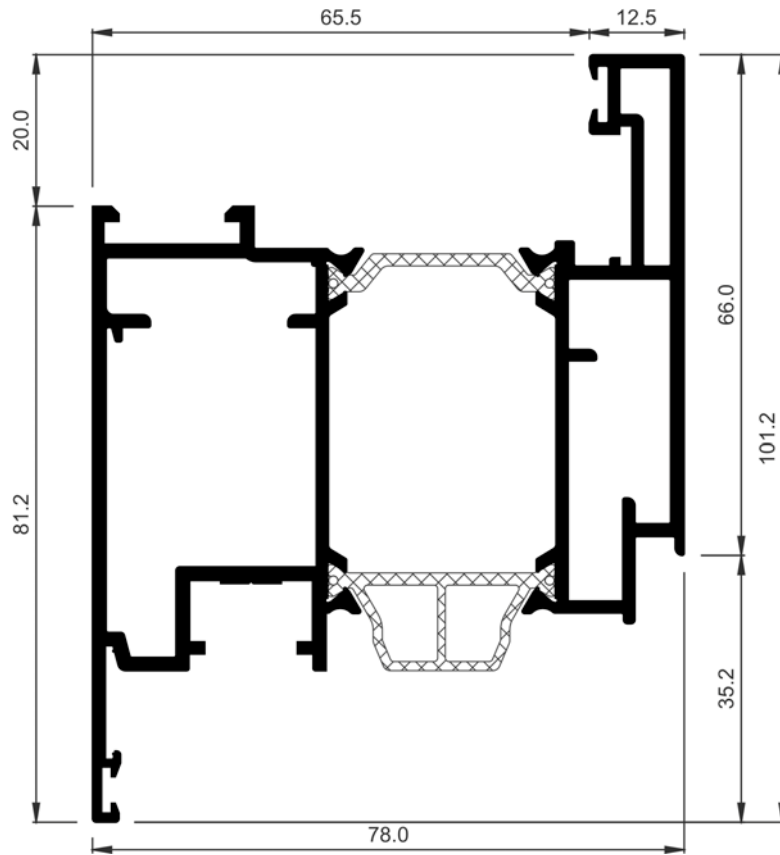

COR-6726	
Descripción Description	Hoja puerta apertura interior Inwards opening door sash
Peso Weight (g/m)	2437,7
Superficie Surface (dm ² /m)	94,48
Ix (cm⁴)	46,99
Iy (cm⁴)	69,26
Escuadra principal Main cleat	396724
Troquel Punch tool	386799
Escuadra secundaria Secondary cleat	357924
Escuadra alineamiento Alignment cleat	287310
	920135

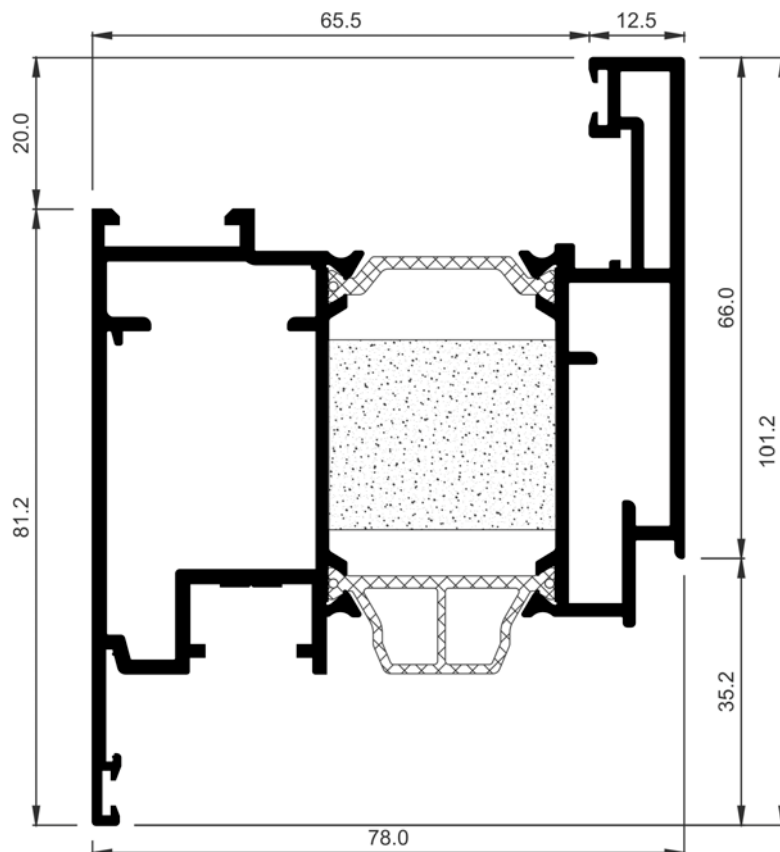

COR-6727	
Descripción Description	Hoja puerta apertura interior HI Inward opening door sash HI
Peso Weight (g/m)	2437,7
Superficie Surface (dm ² /m)	94,48
Ix (cm⁴)	46,99
Iy (cm⁴)	69,26
Escuadra principal Main cleat	396724
Troquel Punch tool	386799
Escuadra secundaria Secondary cleat	357924
Escuadra alineamiento Alignment cleat	287310
	920135

COR 70 C16 ST
Perfiles a escala

COR 70 C16 ST
Profiles to scale

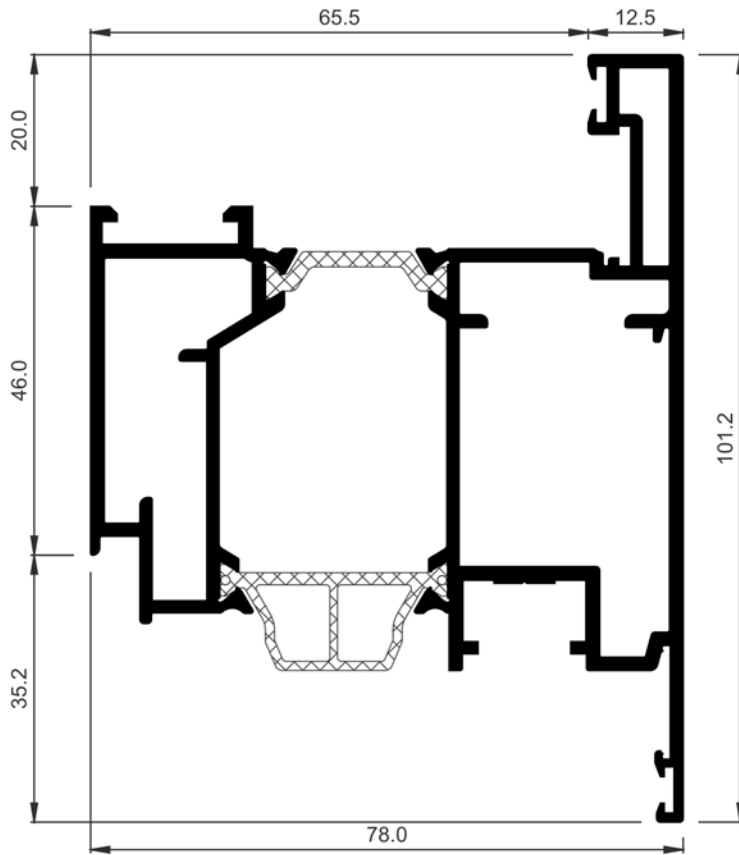

COR-6728	
Descripción Description	Hoja puerta apertura exterior Outer opening door sash
Peso Weight (g/m)	2480,9
Superficie Surface (dm ² /m)	96,37
Ix (cm⁴)	47,44
Iy (cm⁴)	65,27
Escuadra principal Main cleat	396724
Troquel Punch tool	386799
Escuadra secundaria Secondary cleat	357924
Escuadra alineamiento Alignment cleat	287310
	920135

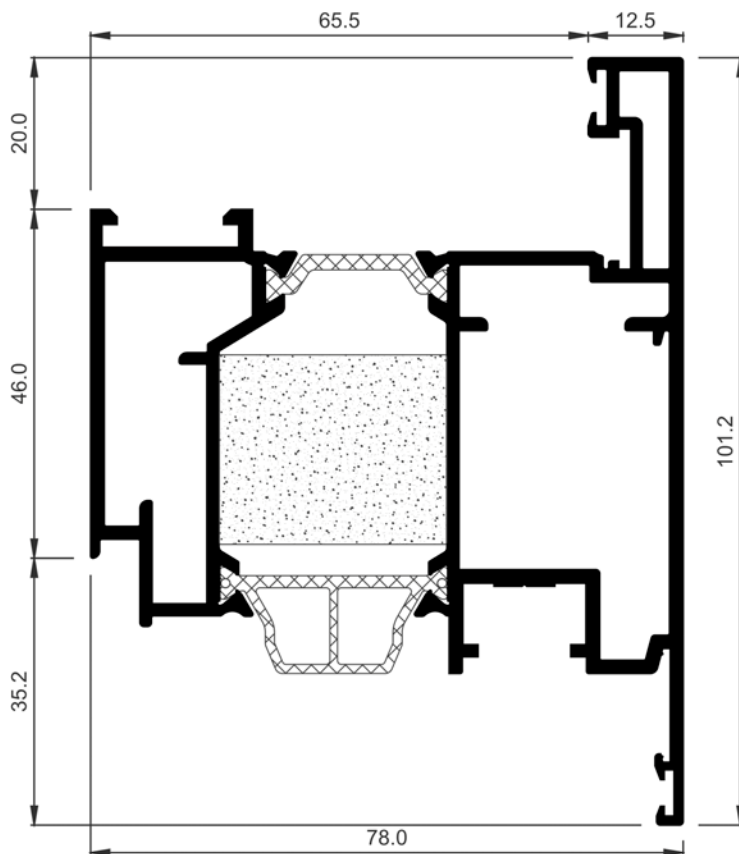

COR-6729	
Descripción Description	Hoja puerta apertura exterior HI Outer opening door sash HI
Peso Weight (g/m)	2480,9
Superficie Surface (dm ² /m)	96,37
Ix (cm⁴)	47,44
Iy (cm⁴)	65,27
Escuadra principal Main cleat	396724
Troquel Punch tool	386799
Escuadra secundaria Secondary cleat	357924
Escuadra alineamiento Alignment cleat	287310
	920135

COR 70 C16 ST
Perfiles a escala

COR 70 C16 ST
Profiles to scale

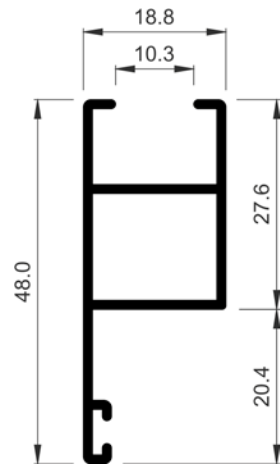

770226	
Descripción Description	Hoja de contra recta Straight shutter sash
Peso Weight (g/m)	399,6
Superficie Surface (dm ² /m)	24,06
Ix (cm⁴)	2,5
Iy (cm⁴)	0,81
Escuadra principal Main cleat	920425
Troquel Punch tool	386799

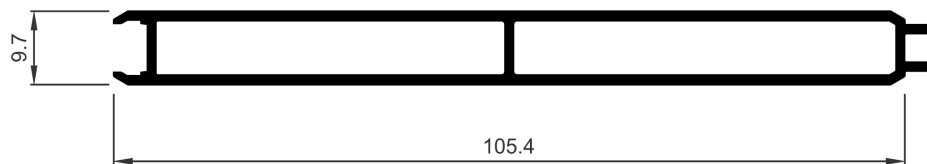

COR-2366	
Descripción Description	Lama contra de ventana Window louvre
Peso Weight (g/m)	796,5
Superficie Surface (dm ² /m)	47,49
Ix (cm⁴)	0,48
Iy (cm⁴)	30,48

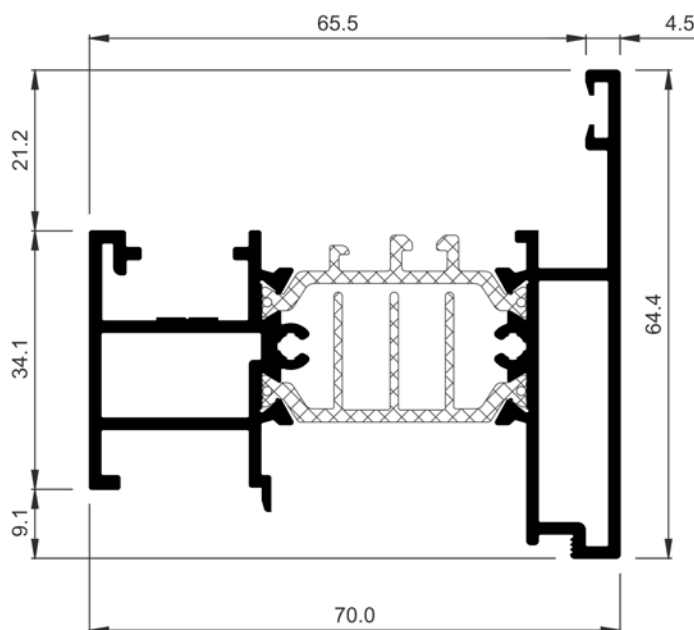

COR-6740	
Descripción Description	Inversor apertura interior Inner opening inverter
Peso Weight (g/m)	1560,2
Superficie Surface (dm ² /m)	60,71
Ix (cm⁴)	9,42
Iy (cm⁴)	32,67
Tapas Covers	366740
Tornillería Screws	813922

COR 70 C16 ST
Perfiles a escala

COR 70 C16 ST
Profiles to scale

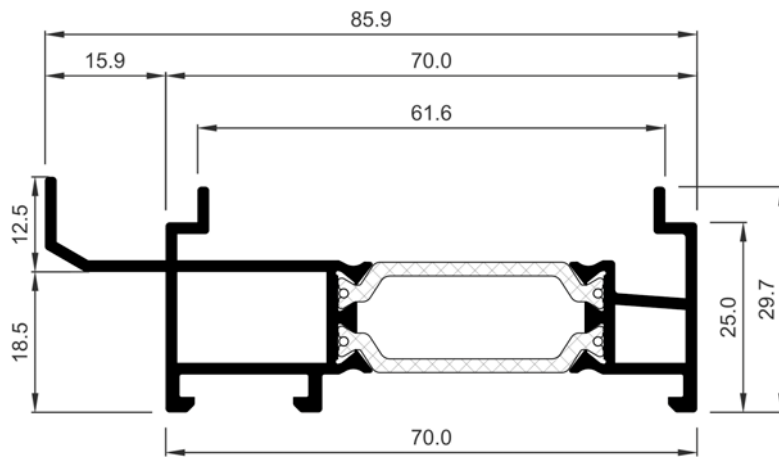

COR-7960	
Descripción Description	Condensación Condensation
Peso Weight (g/m)	1179,5
Superficie Surface (dm ² /m)	43,39
Ix (cm ⁴)	2,01
Iy (cm ⁴)	27,86
Tapas Covers	257200

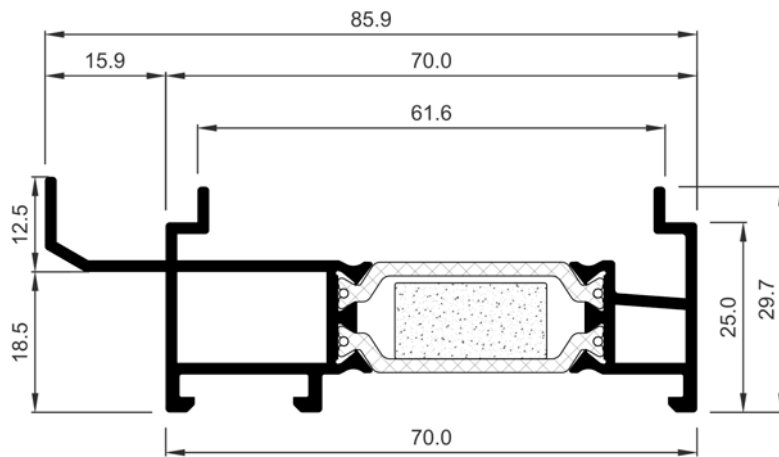

COR-7961	
Descripción Description	Condensación HI HI condensation
Peso Weight (g/m)	1179,5
Superficie Surface (dm ² /m)	43,39
Ix (cm ⁴)	2,01
Iy (cm ⁴)	27,86
Tapas Covers	257200

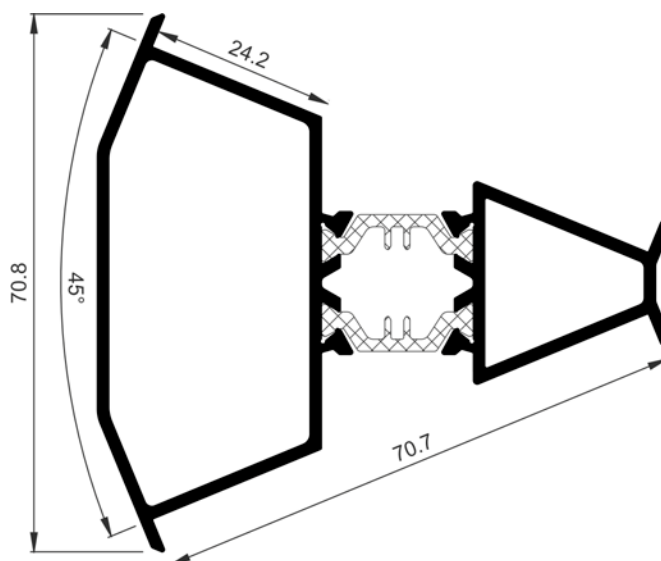

COR-3880	
Descripción Description	Esquinero fijo 135° 135° Corner
Peso Weight (g/m)	1358,3
Superficie Surface (dm ² /m)	56,14
Ix (cm ⁴)	11,43
Iy (cm ⁴)	23,68

COR 70 C16 ST
Perfiles a escala

COR 70 C16 ST
Profiles to scale

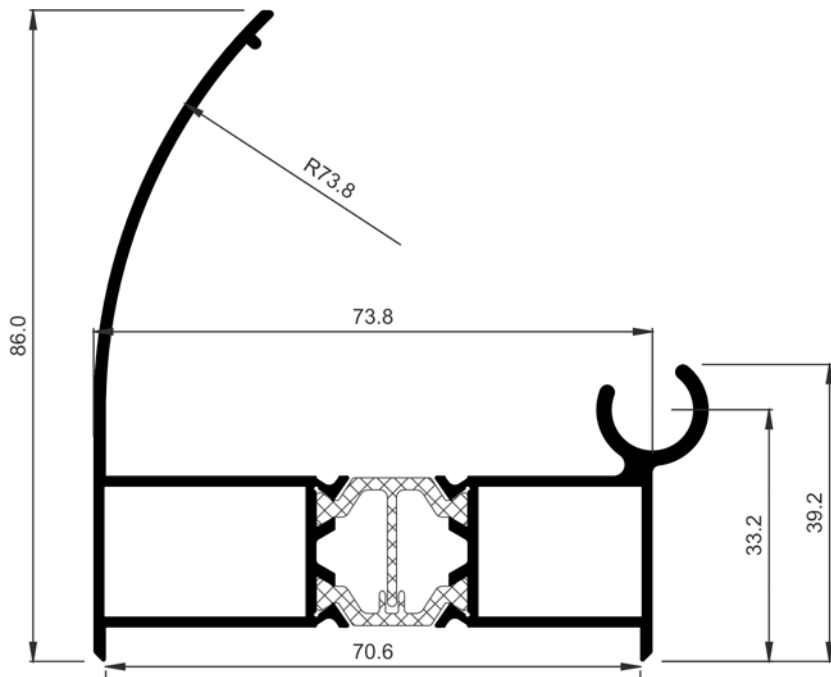

COR-7357	
Descripción Description	Esquinero regulable hembra Adjustable corne female
Peso Weight (g/m)	1521
Superficie Surface (dm ² /m)	63,05
Ix (cm⁴)	21,09
Iy (cm⁴)	37,2

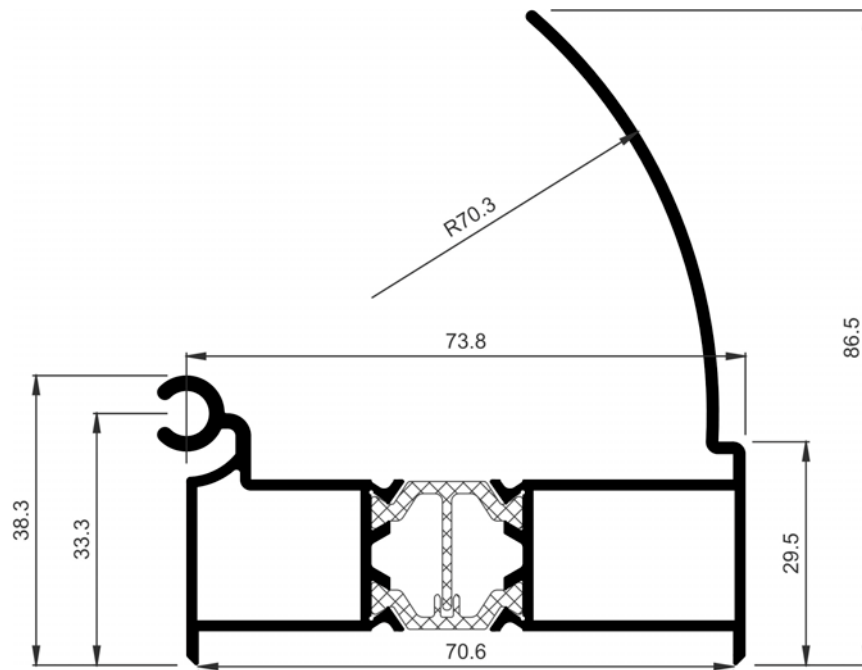

COR-7358	
Descripción Description	Esquinero regulable macho Adjustable corne male
Peso Weight (g/m)	1512,9
Superficie Surface (dm ² /m)	63,84
Ix (cm⁴)	20,98
Iy (cm⁴)	33,3

COR 70 C16 ST
Perfiles a escala

COR 70 C16 ST
Profiles to scale

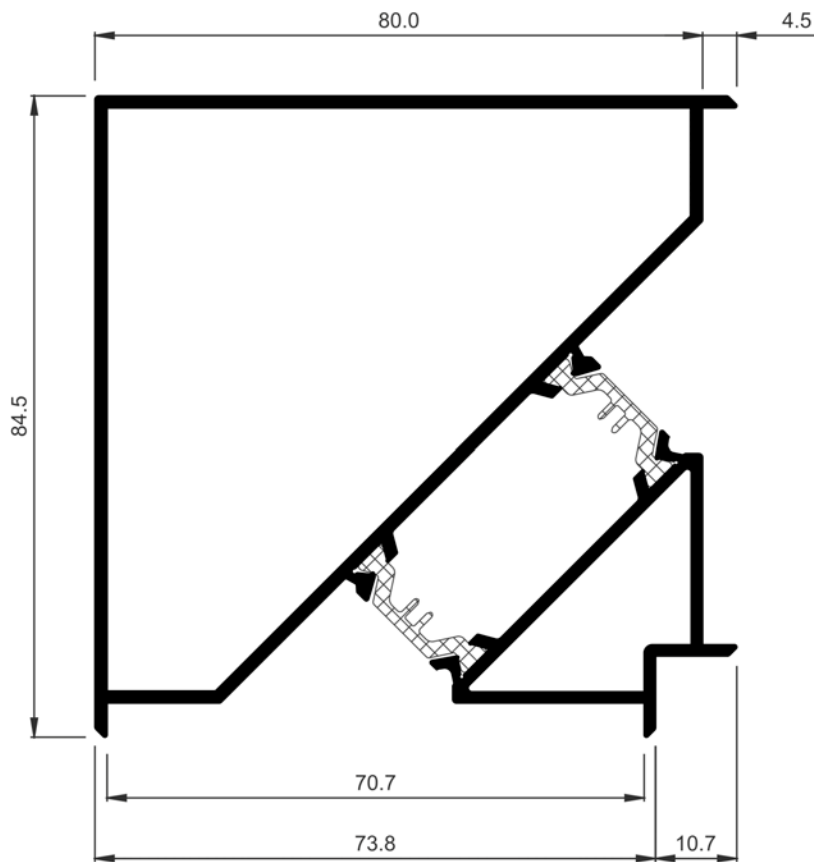

COR-7359	
Descripción Description	Esquinero recto Straight corner
Peso Weight (g/m)	2027,9
Superficie Surface (dm ² /m)	86,34
Ix (cm⁴)	56,84
Iy (cm⁴)	56,84

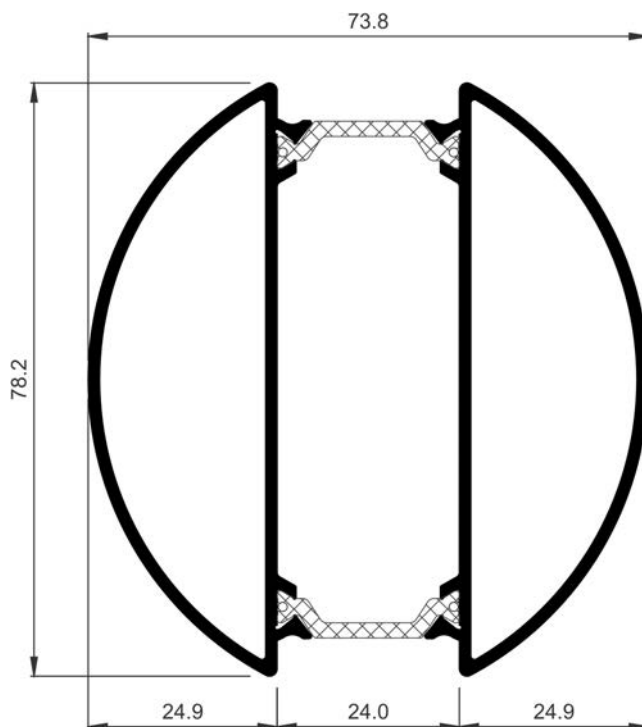

COR-7980	
Descripción Description	Esquinero regulable Adjustable corner
Peso Weight (g/m)	1706,6
Superficie Surface (dm ² /m)	74,14
Ix (cm⁴)	32,41
Iy (cm⁴)	27,95

COR 70 C16 ST
Perfiles a escala

COR 70 C16 ST
Profiles to scale

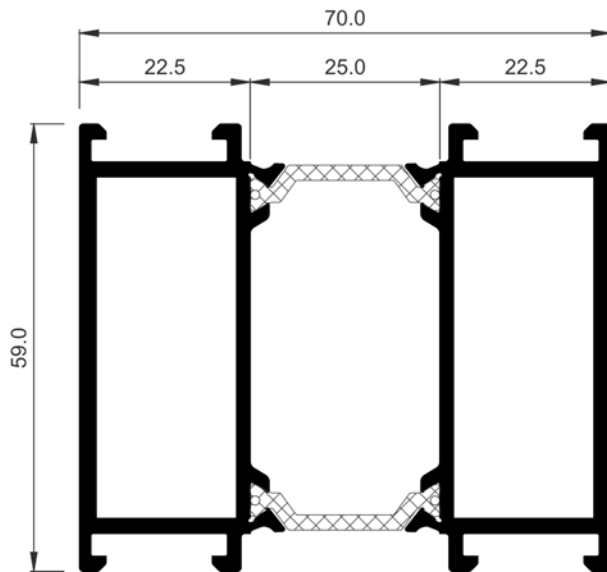

COR-7985	
Descripción Description	Suplemento marco Frame supplement
Peso Weight (g/m)	2061,4
Superficie Surface (dm ² /m)	70,38
Ix (cm⁴)	25,2
Iy (cm⁴)	43,28
Tapas Covers	377985

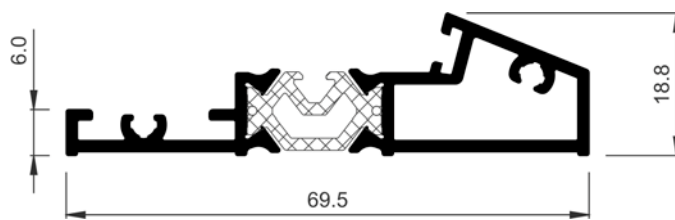

COR-6764	
Descripción Description	Umbral puerta balconera Balcony door threshold
Peso Weight (g/m)	917,6
Superficie Surface (dm ² /m)	32,16
Ix (cm⁴)	0,62
Iy (cm⁴)	10,59



COR-6766	
Descripción Description	Perfil batiente umbral Threshold swing profile
Peso Weight (g/m)	218,7
Superficie Surface (dm ² /m)	10,97
Ix (cm⁴)	0,25
Iy (cm⁴)	0,69
Tornillería Screws	822995

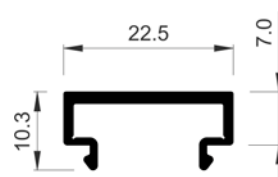

COR-6765	
Descripción Description	Tapa umbral Threshold cover
Peso Weight (g/m)	145,8
Superficie Surface (dm ² /m)	9,41
Ix (cm⁴)	0,05
Iy (cm⁴)	0,33

COR 70 C16 ST
Perfiles a escala

COR 70 C16 ST
Profiles to scale

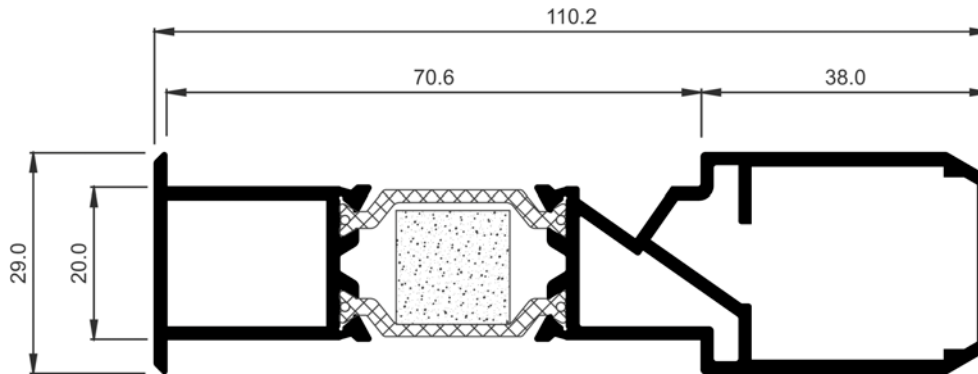

COR-6755

Descripción Description	Unión de marcos con refuerzo HI Frame joint profile with reinforcement HI
Peso Weight (g/m)	1648,9
Superficie Surface (dm²/m)	62,83
Ix (cm⁴)	4,53
Iy (cm⁴)	62,22
Tapas Covers	257201

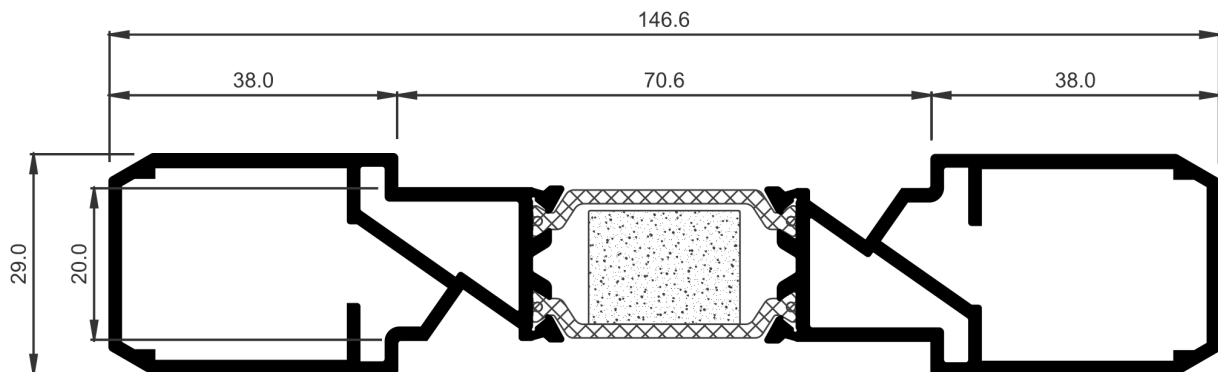

COR-6756

Descripción Description	Unión de marcos con doble refuerzo HI Frame joint profile with double reinforcement
Peso Weight (g/m)	2094,4
Superficie Surface (dm²/m)	83,16
Ix (cm⁴)	6,85
Iy (cm⁴)	142,81
Tapas Covers	257201

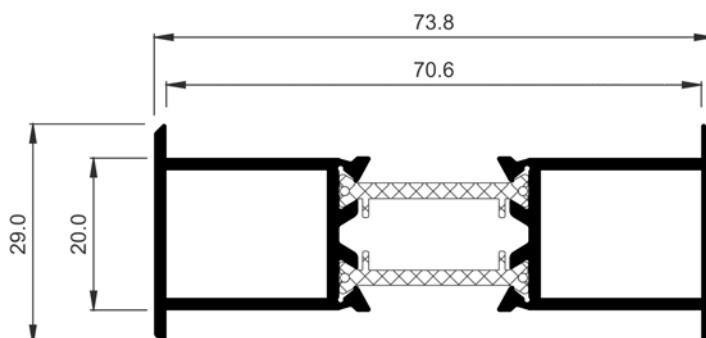

COR-7354

Descripción Description	Unión de marcos Frame joint profile
Peso Weight (g/m)	1143,4
Superficie Surface (dm²/m)	42,5
Ix (cm⁴)	2,22
Iy (cm⁴)	22,24

COR 70 C16 ST
Perfiles a escala

COR 70 C16 ST
Profiles to scale

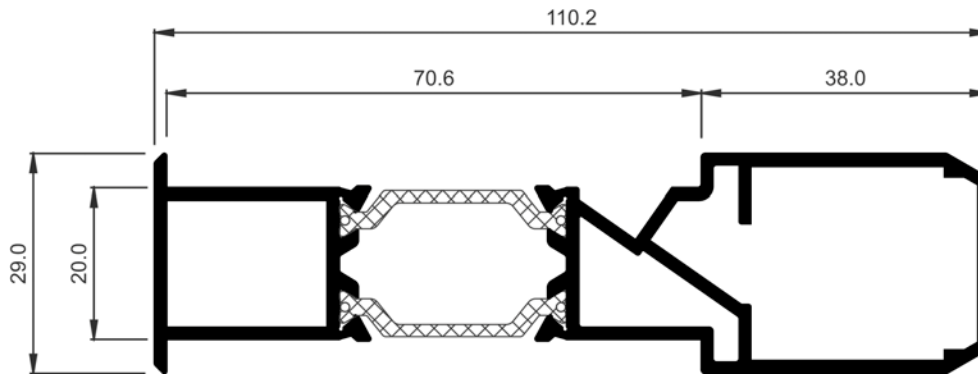

COR-7355

Descripción Description	Unión de marcos con refuerzo Frame joint profile with reinforcement
Peso Weight (g/m)	1648,9
Superficie Surface (dm ² /m)	62,83
I_x (cm ⁴)	4,53
I_y (cm ⁴)	62,22
Tapas Covers	257201

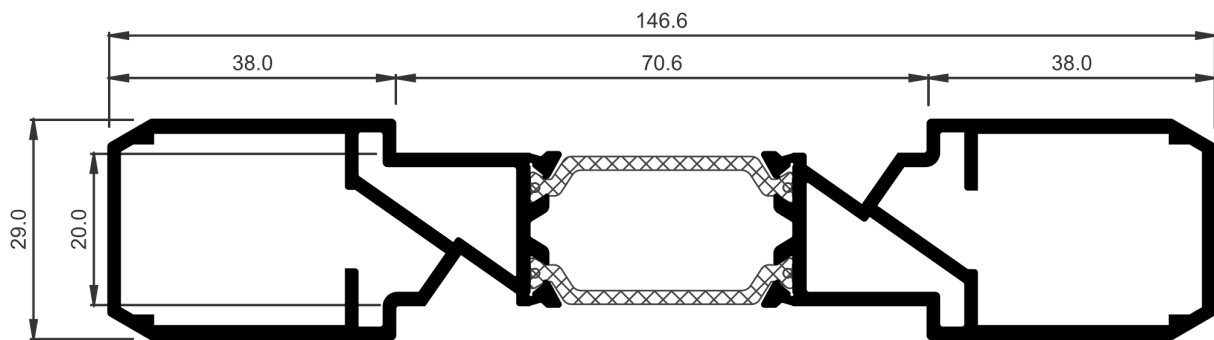

COR-7356

Descripción Description	Unión de marcos con doble refuerzo Frame joint profile with double reinforcement
Peso Weight (g/m)	2094,4
Superficie Surface (dm ² /m)	83,16
I_x (cm ⁴)	6,84
I_y (cm ⁴)	142,81
Tapas Covers	257201

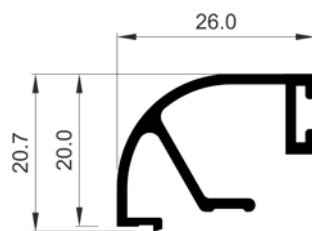

COR-2013

Descripción Description	Junquillo curvo grapa 26 mm Curve glazing bead clip 26 mm
Peso Weight (g/m)	280,8
Superficie Surface (dm ² /m)	15,71
I_x (cm ⁴)	0,42
I_y (cm ⁴)	0,74
Varios Various	252012

COR 70 C16 ST
Perfiles a escala

COR 70 C16 ST
Profiles to scale

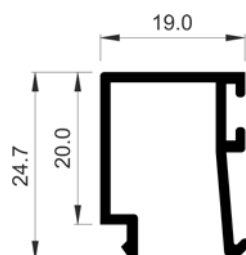
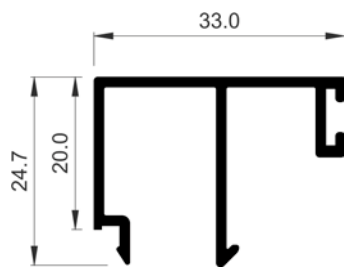
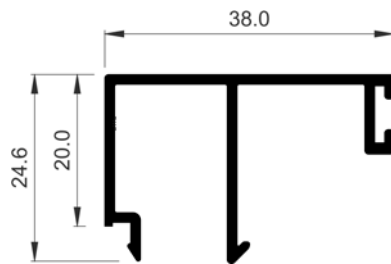
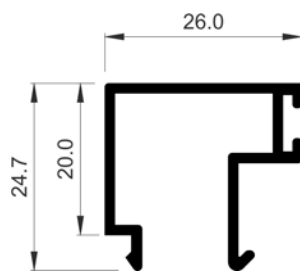
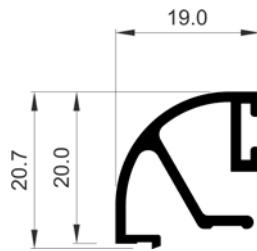

COR-2014	
Descripción Description	Junquillo curvo grapa 19 mm Curve glazing bead clip 19 mm
Peso Weight (g/m)	256,5
Superficie Surface (dm ² /m)	14,31
Ix (cm ⁴)	0,35
Iy (cm ⁴)	0,35
Varios Various	252012

COR-2015	
Descripción Description	Junquillo clip recto de 26 mm Straight glazing bead clip 26 mm
Peso Weight (g/m)	321,3
Superficie Surface (dm ² /m)	18,04
Ix (cm ⁴)	0,75
Iy (cm ⁴)	0,97

COR-2016	
Descripción Description	Junquillo clip recto de 38 mm Straight glazing bead clip 38 mm
Peso Weight (g/m)	369,9
Superficie Surface (dm ² /m)	20,98
Ix (cm ⁴)	0,82
Iy (cm ⁴)	2,16

COR-2017	
Descripción Description	Junquillo clip recto de 33 mm Straight glazing bead clip 33 mm
Peso Weight (g/m)	353,7
Superficie Surface (dm ² /m)	19,98
Ix (cm ⁴)	0,78
Iy (cm ⁴)	1,55

COR-2018	
Descripción Description	Junquillo clip recto de 19 mm Straight glazing bead clip 19 mm
Peso Weight (g/m)	275,4
Superficie Surface (dm ² /m)	15,52
Ix (cm ⁴)	0,67
Iy (cm ⁴)	0,53

COR 70 C16 ST
Perfiles a escala

COR 70 C16 ST
Profiles to scale

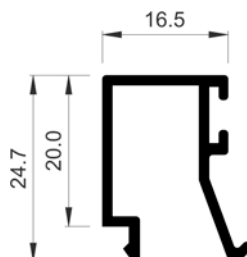
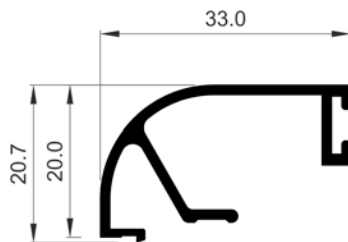
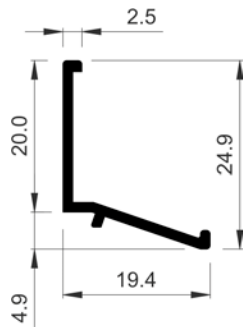
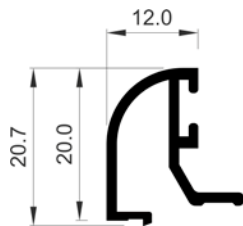
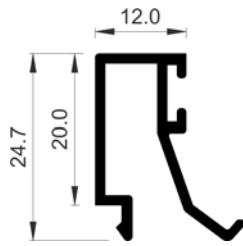

COR-2019	
Descripción Description	Junquillo clip recto de 12 mm Straight glazing bead clip 12 mm
Peso Weight (g/m)	261,9
Superficie Surface (dm ² /m)	14,77
Ix (cm⁴)	0,61
Iy (cm⁴)	0,27

COR-2021	
Descripción Description	Junquillo curvo grapa 12 mm Curve glazing bead clip 12 mm
Peso Weight (g/m)	216
Superficie Surface (dm ² /m)	12,55
Ix (cm⁴)	0,31
Iy (cm⁴)	0,18
Varios Various	252012

COR-2023	
Descripción Description	Junquillo recto de 2,5 mm 2,5 Straight glazing bead clip
Peso Weight (g/m)	151,2
Superficie Surface (dm ² /m)	8,71
Ix (cm⁴)	0,32
Iy (cm⁴)	0,21

COR-2038	
Descripción Description	Junquillo curvo grapa 33 mm Curve glazing bead clip 33 mm
Peso Weight (g/m)	307,8
Superficie Surface (dm ² /m)	17,32
Ix (cm⁴)	0,47
Iy (cm⁴)	1,37
Varios Various	252012

COR-2065	
Descripción Description	Junquillo clip recto de 16.50 mm Straight glazing bead clip 16,50 mm
Peso Weight (g/m)	270
Superficie Surface (dm ² /m)	15,13
Ix (cm⁴)	0,65
Iy (cm⁴)	0,41

COR 70 C16 ST
Perfiles a escala

COR 70 C16 ST
Profiles to scale

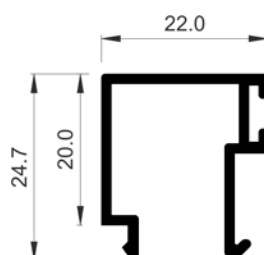
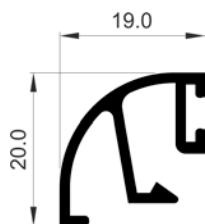
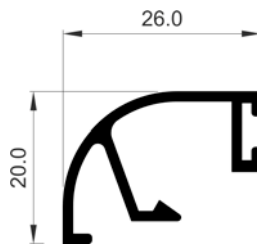
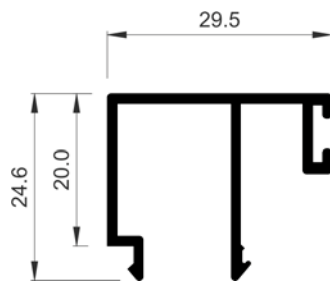
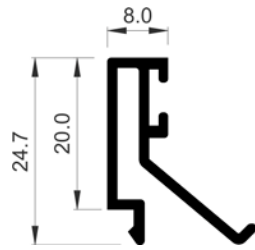

COR-2093	
Descripción Description	Junquillo clip recto de 8 mm Straight glazing bead clip 8 mm
Peso Weight (g/m)	256,5
Superficie Surface (dm ² /m)	14,51
Ix (cm⁴)	0,56
Iy (cm⁴)	0,23

COR-2094	
Descripción Description	Junquillo doble clip recto de 29,5 mm Straight glazing bead double clip 29,5 mm
Peso Weight (g/m)	332,1
Superficie Surface (dm ² /m)	19,15
Ix (cm⁴)	0,72
Iy (cm⁴)	1,2

COR-2113	
Descripción Description	Junquillo curvo grapa plástica 26 mm Curve glazing bead plastic clip 26 mm
Peso Weight (g/m)	272,7
Superficie Surface (dm ² /m)	15
Ix (cm⁴)	0,36
Iy (cm⁴)	0,72
Varios Various	212001

COR-2114	
Descripción Description	Junquillo curvo grapa plástica 19 mm Curve glazing bead plastic clip 19 mm
Peso Weight (g/m)	251,1
Superficie Surface (dm ² /m)	13,74
Ix (cm⁴)	0,31
Iy (cm⁴)	0,31
Varios Various	212001

COR-2117	
Descripción Description	Junquillo clip recto de 22 mm Straight glazing bead clip 22 mm
Peso Weight (g/m)	294,3
Superficie Surface (dm ² /m)	16,44
Ix (cm⁴)	0,7
Iy (cm⁴)	0,69

COR 70 C16 ST
Perfiles a escala

COR 70 C16 ST
Profiles to scale

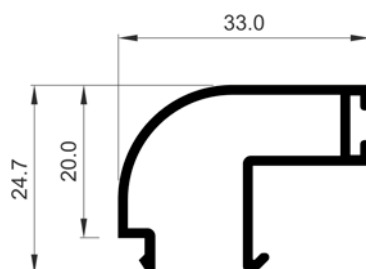
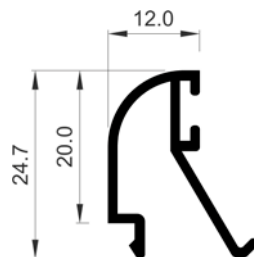
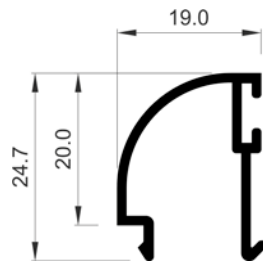
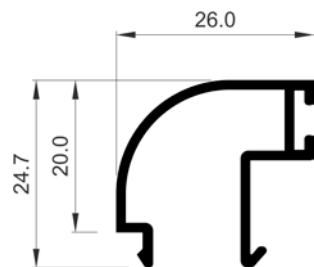
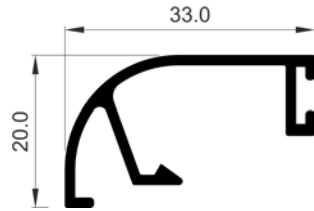

COR-2138	
Descripción Description	Junquillo curvo grapa plástica 33 mm Curve glazing bead plastic clip 33 mm
Peso Weight (g/m)	294,3
Superficie Surface (dm ² /m)	16,15
Ix (cm ⁴)	0,41
Iy (cm ⁴)	1,35
Varios Various	212001

COR-2313	
Descripción Description	Junquillo curvo 26 mm Curve glazing bead 26 mm
Peso Weight (g/m)	278,1
Superficie Surface (dm ² /m)	16,99
Ix (cm ⁴)	0,61
Iy (cm ⁴)	0,76

COR-2314	
Descripción Description	Junquillo curvo 19 mm Curve glazing bead 19 mm
Peso Weight (g/m)	237,6
Superficie Surface (dm ² /m)	14,5
Ix (cm ⁴)	0,52
Iy (cm ⁴)	0,41

COR-2321	
Descripción Description	Junquillo curvo 12 mm Curve glazing bead 12 mm
Peso Weight (g/m)	228,5
Superficie Surface (dm ² /m)	13,98
Ix (cm ⁴)	0,49
Iy (cm ⁴)	0,24

COR-2338	
Descripción Description	Junquillo curvo 33 mm Curve glazing bead 33 mm
Peso Weight (g/m)	326,7
Superficie Surface (dm ² /m)	19,91
Ix (cm ⁴)	0,68
Iy (cm ⁴)	1,35

COR 70 C16 ST
Perfiles a escala

COR 70 C16 ST
Profiles to scale

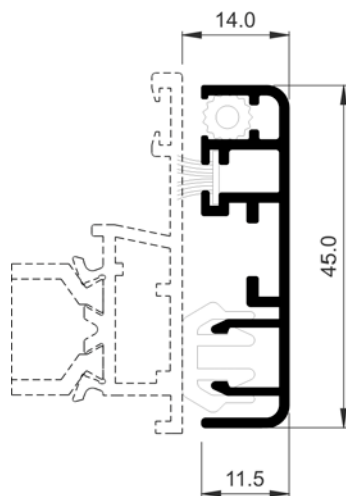
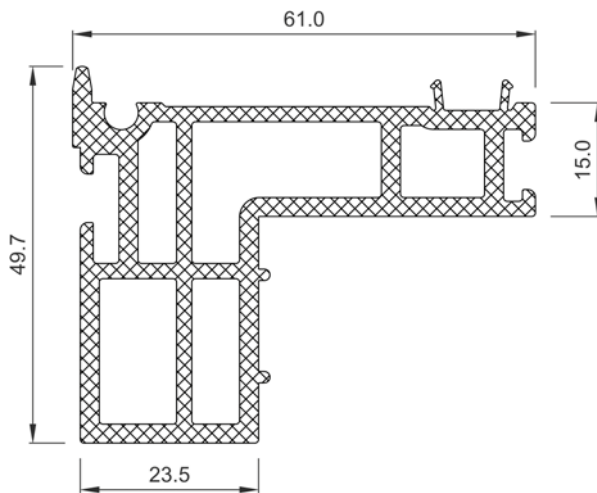
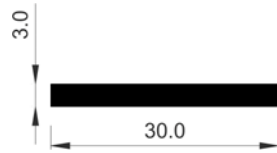

603003	
Descripción Description	Pletina de 30x3 mm Plate 30x3mm
Peso Weight (g/m)	243
Superficie Surface (dm ² /m)	6,6
Ix (cm⁴)	0,01
Iy (cm⁴)	0,68

COR-1720	
Descripción Description	Perfil base Base profile

COR-2170	
Descripción Description	Mosquitera fija Fixed insect screen
Peso Weight (g/m)	405
Superficie Surface (dm ² /m)	24,41
Ix (cm⁴)	3,02
Iy (cm⁴)	0,19
Varios Various	272170
Juntas Gaskets	272100 950040
Escuadra alineamiento Alignment cleat	245054
Observaciones Observations	Telas mosquitera 272125/26/27/28 Mosquito net 272125/26/27/28

COR 70 C16 ST
Perfiles a escala

COR 70 C16 ST
Profiles to scale

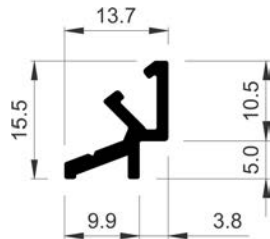

COR-2714	
Descripción Description	Acople esquinero regulable Adjustable corner attachment
Peso Weight (g/m)	162
Superficie Surface (dm ² /m)	7,34
Ix (cm⁴)	0,1
Iy (cm⁴)	0,08
Observaciones Observations	Tornillo Ø3.5 mm DIN7504N Ø3.5 mm DIN7504N screw

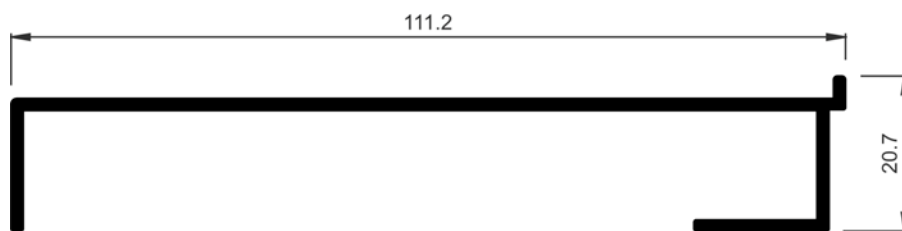

COR-2778	
Descripción Description	Peana de 110 mm 110 mm stand
Peso Weight (g/m)	696,6
Superficie Surface (dm ² /m)	32,73
Ix (cm⁴)	0,89
Iy (cm⁴)	38,59
Tornillería Screws	853913

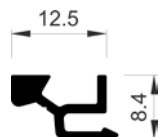

COR-2843	
Descripción Description	Grapa para enganche postizo Clip for coupling for hook
Peso Weight (g/m)	116,1
Superficie Surface (dm ² /m)	6,17
Ix (cm⁴)	0,02
Iy (cm⁴)	0,07
Tornillería Screws	822919

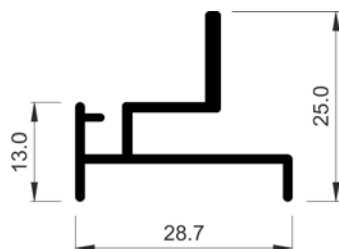

COR-2890	
Descripción Description	Complemento tapa registro (para panel) Register cover complement (for pannel)
Peso Weight (g/m)	280,8
Superficie Surface (dm ² /m)	15,65
Ix (cm⁴)	0,37
Iy (cm⁴)	0,73
Juntas Gaskets	262810
Tornillería Screws	853913

COR 70 C16 ST
Perfiles a escala

COR 70 C16 ST
Profiles to scale

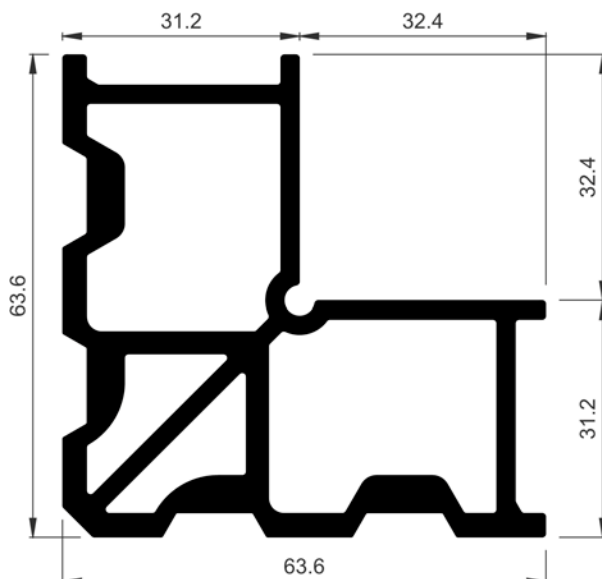
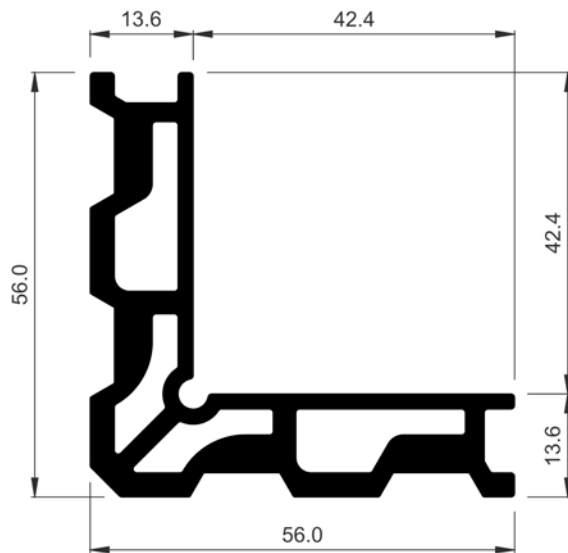
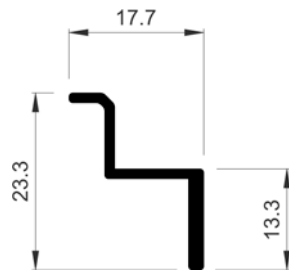

COR-2891	
Descripción Description	Asiento tapa registro Register cover seat
Peso Weight (g/m)	159,3
Superficie Surface (dm ² /m)	7,92
Ix (cm ⁴)	0,23
Iy (cm ⁴)	0,19
Juntas Gaskets	262810

COR-3160	
Descripción Description	Perfil para escuadra de ensamblar de 13,60 mm Profile for assembly cleat - 13.60 mm
Peso Weight (g/m)	1884,6
Superficie Surface (dm ² /m)	45,94
Ix (cm ⁴)	18,6
Iy (cm ⁴)	18,6

COR-3161	
Descripción Description	Perfil para escuadra de ensamblar de 31,20 mm Profile for assembly cleat - 31.20 mm
Peso Weight (g/m)	2651,4
Superficie Surface (dm ² /m)	62,87
Ix (cm ⁴)	34,52
Iy (cm ⁴)	34,52

COR 70 C16 ST
Perfiles a escala

COR 70 C16 ST
Profiles to scale

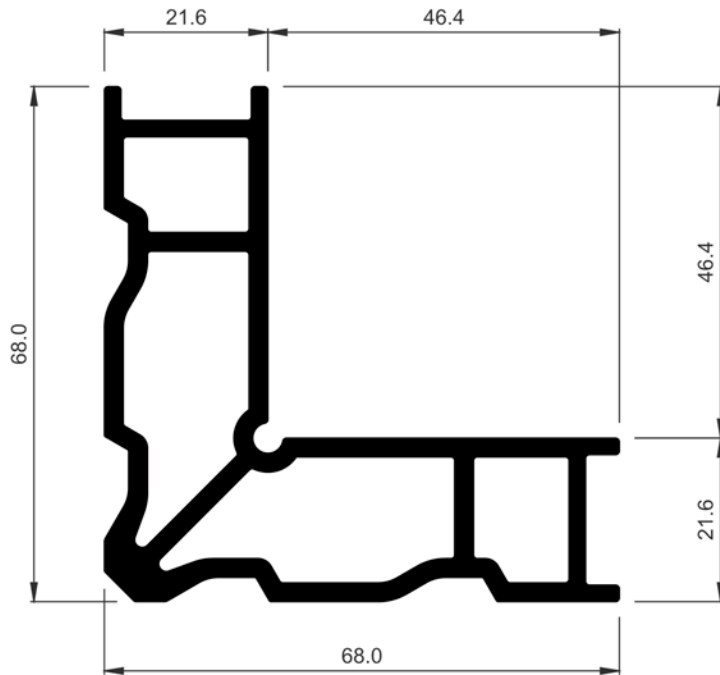

COR-3166	
Descripción Description	Perfil para escuadra de ensamblar de 21,60 mm Profile for assembly cleat - 21,60 mm
Peso Weight (g/m)	2178,9
Superficie Surface (dm ² /m)	61,25
Ix (cm ⁴)	33,47
Iy (cm ⁴)	33,47

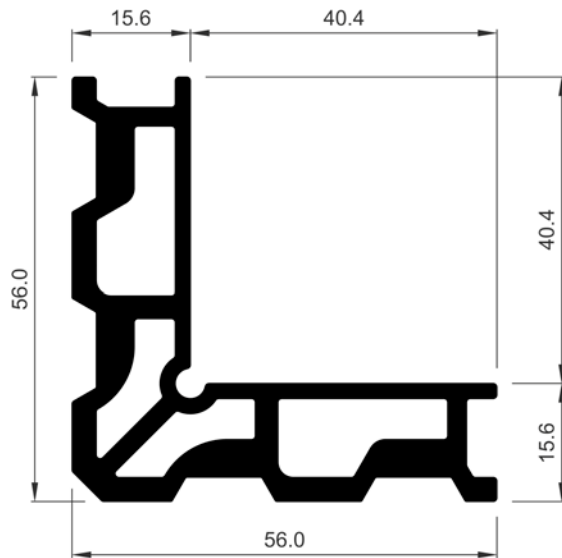

COR-3660	
Descripción Description	Perfil para escuadra de ensamblar 15,6 mm Profile for crimping cleat - 15,6 mm
Peso Weight (g/m)	1941,3
Superficie Surface (dm ² /m)	47,3
Ix (cm ⁴)	18,98
Iy (cm ⁴)	18,98

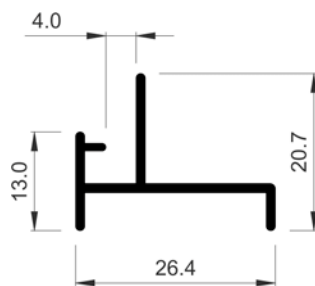

COR-5057	
Descripción Description	Complemento tapa registro (para chapa) Register cover complement (for plate)
Peso Weight (g/m)	191,7
Superficie Surface (dm ² /m)	12,06
Ix (cm ⁴)	0,14
Iy (cm ⁴)	0,5
Juntas Gaskets	262810
Tornillería Screws	853913

COR 70 C16 ST
Perfiles a escala

COR 70 C16 ST
Profiles to scale

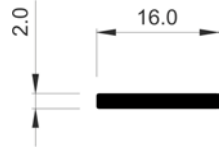

COR-7198	
Descripción Description	Cubre canal C16 16 mm groove cover
Peso Weight (g/m)	86,4
Superficie Surface (dm ² /m)	3,55
I_y (cm ⁴)	0,07

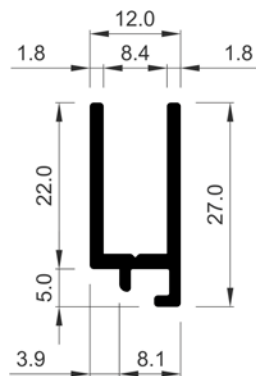

COR-7997	
Descripción Description	Acople para junta de dilatación Expansion gasket attachment
Peso Weight (g/m)	297
Superficie Surface (dm ² /m)	12,56
I_x (cm ⁴)	0,63
I_y (cm ⁴)	0,24
Juntas Gaskets	347901
Tornillería Screws	813919

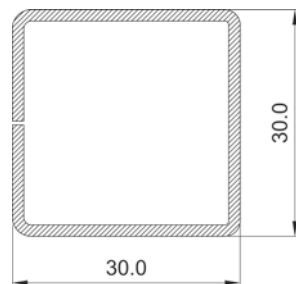

771704	
Descripción Description	Refuerzo de 30x30 Reinforcement 30x30
Peso Weight (g/m)	1284,1
I_x (cm ⁴)	2,2
I_y (cm ⁴)	2,17
Material Material	Acero galvanizado DX51D-Z140

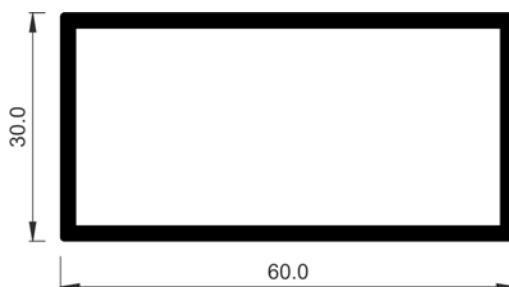

806030	
Descripción Description	Tubo de 60x30x2 mm 60x30x2 mm tube
Peso Weight (g/m)	928,8
Superficie Surface (dm ² /m)	34,4
I_x (cm ⁴)	15,93
I_y (cm ⁴)	5,29

COR 70 C16 ST
Perfiles a escala

COR 70 C16 ST
Profiles to scale

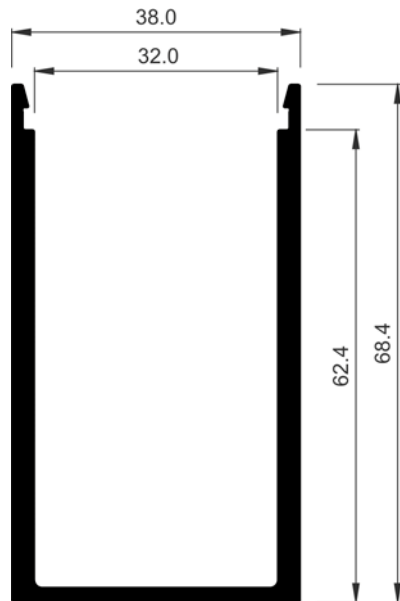

COR-1700	
Descripción Description	U de refuerzo U Reinforcement U
Peso Weight (g/m)	1239,3
Superficie Surface (dm ² /m)	34,5
Ix (cm⁴)	20,05
Iy (cm⁴)	12,71
Observaciones Observations	Con tapa Cor-1701 With cover Cor-1701

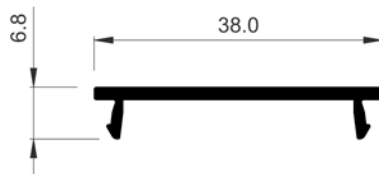

COR-1701	
Descripción Description	Tapa clipaje U refuerzo Reinforcement U-clip end plate
Peso Weight (g/m)	202,5
Superficie Surface (dm ² /m)	10
Ix (cm⁴)	0,02
Iy (cm⁴)	1,09

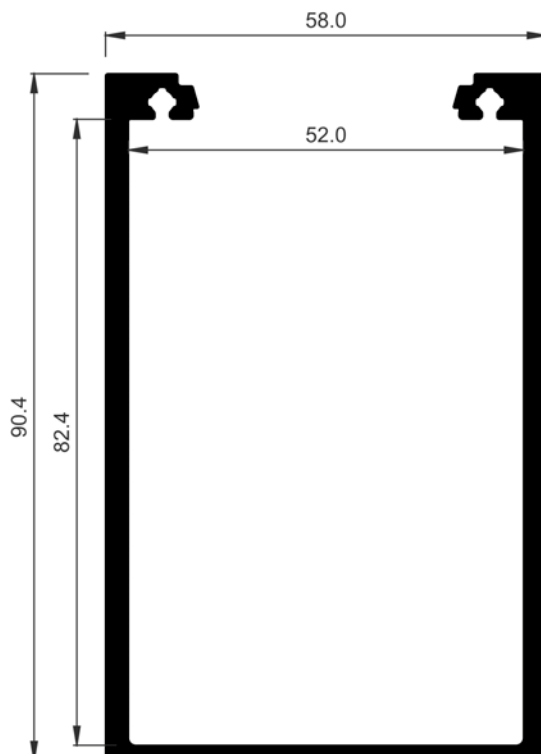

COR-1703	
Descripción Description	U de refuerzo 90x58 mm 90x58 mm reinforcement U
Peso Weight (g/m)	1952,1
Superficie Surface (dm ² /m)	52,44
Ix (cm⁴)	70,69
Iy (cm⁴)	47,16
Observaciones Observations	Con tapa Cor-1701 With cover Cor-1701

COR 70 C16 ST
Perfiles a escala

COR 70 C16 ST
Profiles to scale

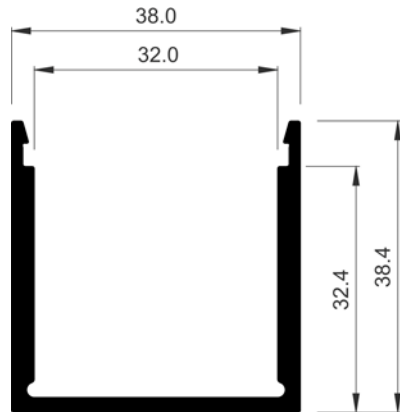

COR-1704	
Descripción Description	U refuerzo 40 mm Reinforcement U 40 mm
Peso Weight (g/m)	743,31
Superficie Surface (dm ² /m)	22,78
Ix (cm⁴)	3,77
Iy (cm⁴)	7,09
Observaciones Observations	Con tapa Cor-1701 With cover Cor-1701

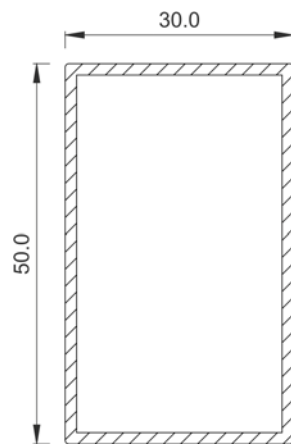

COR-6852	
Descripción Description	Tubo de 50x30 INOX 50x30 mm stainless tube
Ix (cm⁴)	7,87
Iy (cm⁴)	3,54

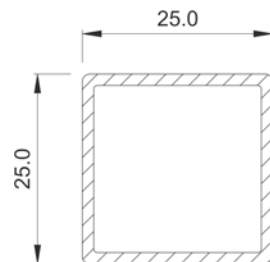

COR-7252	
Descripción Description	Tubo 25x25 INOX Tube of 25x25 stainless steel
Superficie Surface (dm ² /m)	18,8
Ix (cm⁴)	1,29
Iy (cm⁴)	1,29

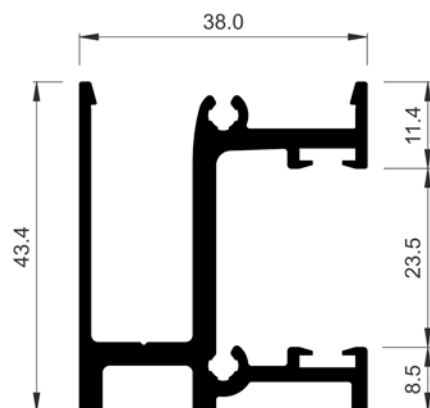

COR-8540	
Descripción Description	Soporte barandilla superpuesta Juliet balcony support
Peso Weight (g/m)	1012,5
Superficie Surface (dm ² /m)	34,51
Ix (cm⁴)	7,15
Iy (cm⁴)	5,04
Tapas Covers	358542
Tornillería Screws	814832 824222
Observaciones Observations	Compatible con perfil Cor-1701 Compatible with profile Cor-1701

COR 70 C16 ST
Perfiles a escala

COR 70 C16 ST
Profiles to scale

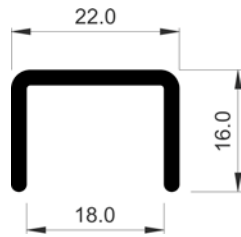

COR-8562	
Descripción Description	Remate vidrio 8.8 Glass finishing 8.8
Peso Weight (g/m)	261,9
Superficie Surface (dm ² /m)	9,97
Ix (cm⁴)	2,4
Iy (cm⁴)	7

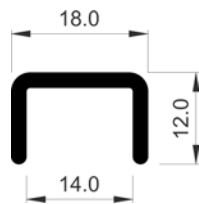

COR-8563	
Descripción Description	Remate vidrio 6.6 Glass finishing 6.6
Peso Weight (g/m)	197,1
Superficie Surface (dm ² /m)	7,57
Ix (cm⁴)	0,9
Iy (cm⁴)	0,33

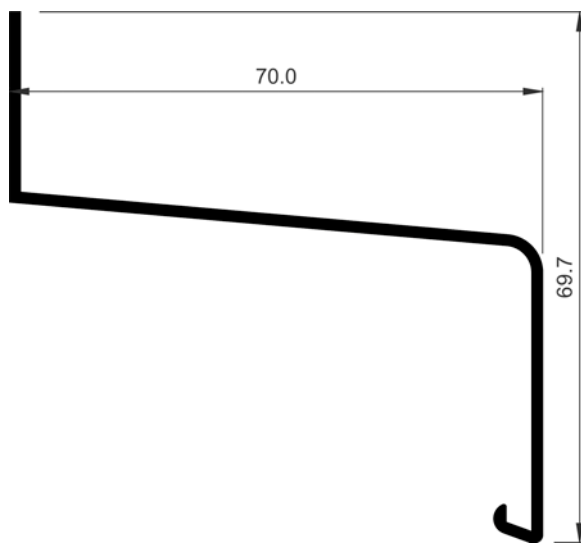

771401	
Descripción Description	Alargadera 70 mm 70 mm cill
Peso Weight (g/m)	521,1
Superficie Surface (dm ² /m)	27,8
Ix (cm⁴)	5,42
Iy (cm⁴)	14,46

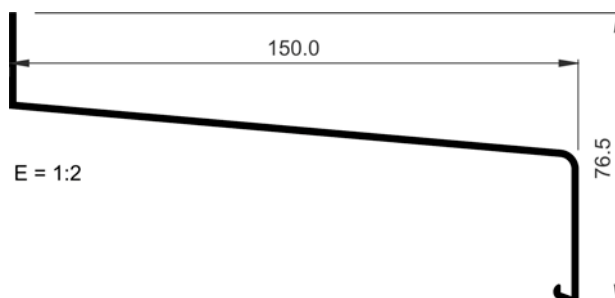

771405	
Descripción Description	Alargadera 150 mm 150 mm cill
Peso Weight (g/m)	939,6
Superficie Surface (dm ² /m)	43,75
Ix (cm⁴)	8,32
Iy (cm⁴)	101,81

COR 70 C16 ST
Perfiles a escala

COR 70 C16 ST
Profiles to scale

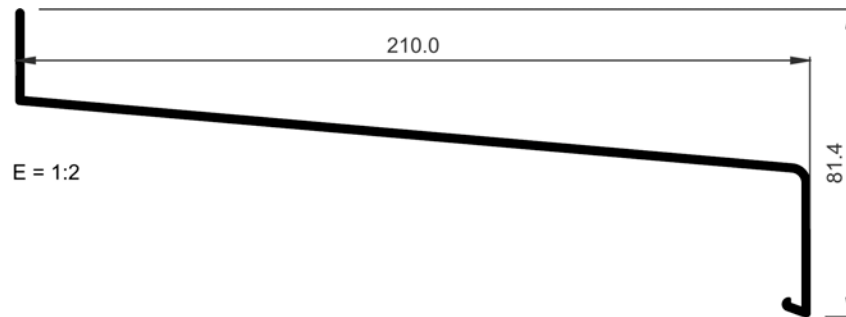

771409	
Descripción Description	Alargadera 210 mm 210 mm cill
Peso Weight (g/m)	1493,1
Superficie Surface (dm ² /m)	55,52
Ix (cm ⁴)	17,06
Iy (cm ⁴)	301,68

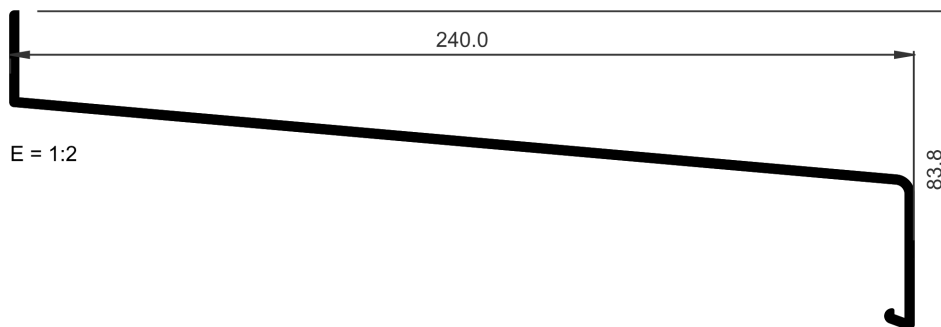

771411	
Descripción Description	Alargadera 240 mm 240 mm cill
Peso Weight (g/m)	1822,5
Superficie Surface (dm ² /m)	61,62
Ix (cm ⁴)	15,96
Iy (cm ⁴)	452,78
Observaciones Observations	CONSULTAR DISPONIBILIDAD CHECK AVAILABILITY

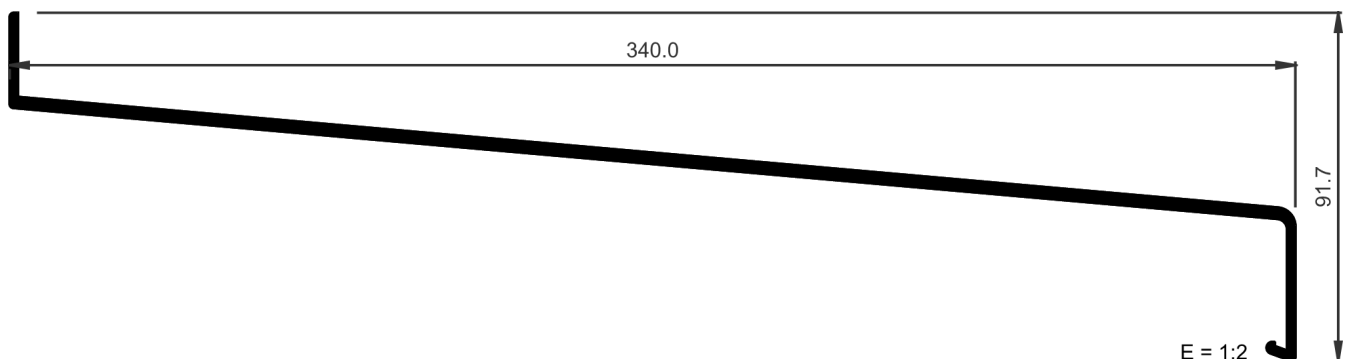

771416	
Descripción Description	Alargadera 340 mm 340 mm cill
Peso Weight (g/m)	3142,8
Superficie Surface (dm ² /m)	81,44
Ix (cm ⁴)	25,13
Iy (cm ⁴)	1378,75

COR 70 C16 ST
Perfiles a escala

COR 70 C16 ST
Profiles to scale

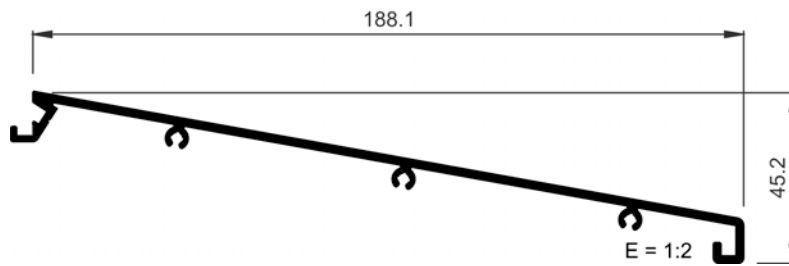

772694	
Descripción Description	Alargadera de 190 mm 190 mm cill
Peso Weight (g/m)	1385,1
Superficie Surface (dm ² /m)	53,44
Ix (cm ⁴)	6,7
Iy (cm ⁴)	191,64
Observaciones Observations	CONSULTAR DISPONIBILIDAD CHECK AVAILABILITY

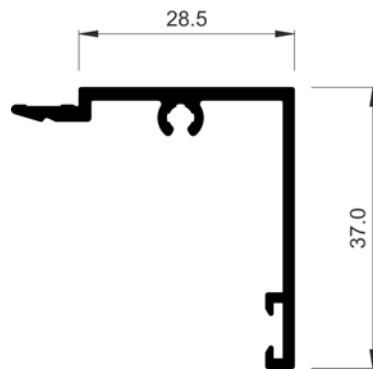

COR-1780	
Descripción Description	Tapé recto de 28,5 mm Straight cap of 28,5 mm
Peso Weight (g/m)	388,8
Superficie Surface (dm ² /m)	18,5
Ix (cm ⁴)	2,01
Iy (cm ⁴)	1,87

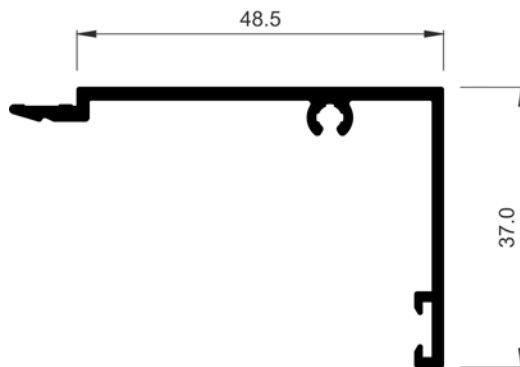

COR-1781	
Descripción Description	Tapé recto de 48,5 mm Straight cap of 48,5 mm
Peso Weight (g/m)	480,6
Superficie Surface (dm ² /m)	22,5
Ix (cm ⁴)	2,25
Iy (cm ⁴)	5,96

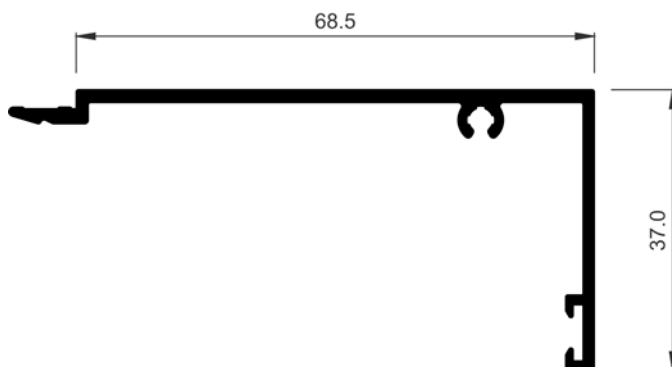

COR-1782	
Descripción Description	Tapé recto de 68,5 mm Straight cap of 68,5 mm
Peso Weight (g/m)	572,4
Superficie Surface (dm ² /m)	26,5
Ix (cm ⁴)	2,41
Iy (cm ⁴)	13,47

COR 70 C16 ST
Perfiles a escala

COR 70 C16 ST
Profiles to scale

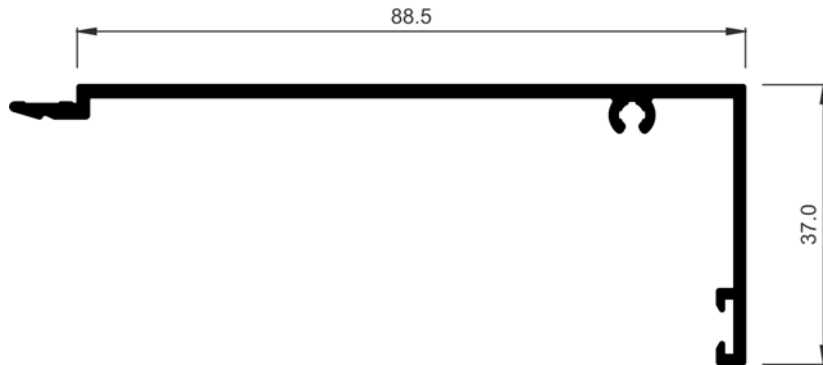

COR-1783	
Descripción Description	Tapé recto de 88,5 mm Straight cap of 88,5 mm
Peso Weight (g/m)	664,2
Superficie Surface (dm ² /m)	30,5
I_x (cm ⁴)	2,53
I_y (cm ⁴)	25,14

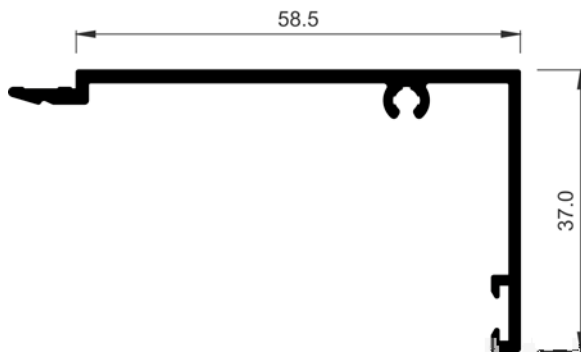

COR-1784	
Descripción Description	Tapé recto de 58,5 mm Straight cap of 58,5 mm
Peso Weight (g/m)	529,2
Superficie Surface (dm ² /m)	24,52
I_x (cm ⁴)	2,34
I_y (cm ⁴)	9,28

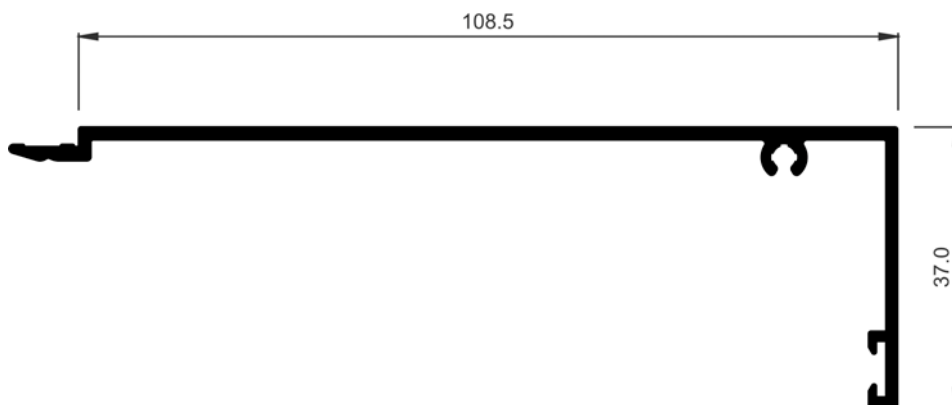

COR-1785	
Descripción Description	Tapé recto de 108,50 mm Straight cap of 108,50 mm
Peso Weight (g/m)	756
Superficie Surface (dm ² /m)	34,57
I_x (cm ⁴)	2,62
I_y (cm ⁴)	41,58

COR 70 C16 ST
Perfiles a escala

COR 70 C16 ST
Profiles to scale

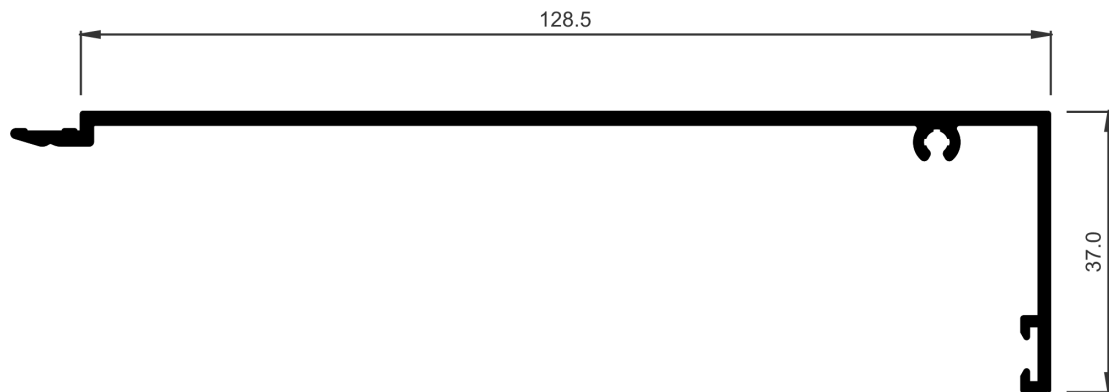

COR-1786	
Descripción Description	Tapé recto de 128,50 mm Straight cap of 128,50 mm
Peso Weight (g/m)	847,8
Superficie Surface (dm ² /m)	38,57
Ix (cm ⁴)	2,69
Iy (cm ⁴)	63,65

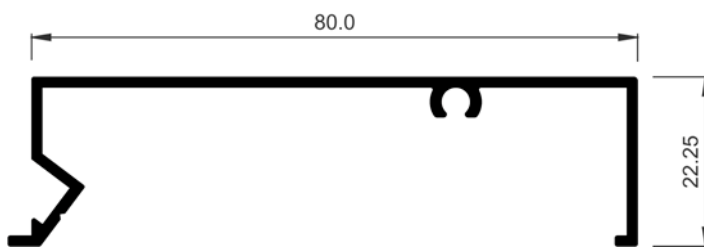

COR-2724	
Descripción Description	Cubre premarco 80 mm Pre-frame cover 80 mm
Peso Weight (g/m)	537,3
Superficie Surface (dm ² /m)	28,05
Ix (cm ⁴)	0,99
Iy (cm ⁴)	17,3
Observaciones Observations	Tornillo Ø3.9 mm DIN7504N-A2 Ø3.9 mm DIN7504N-A2 screw

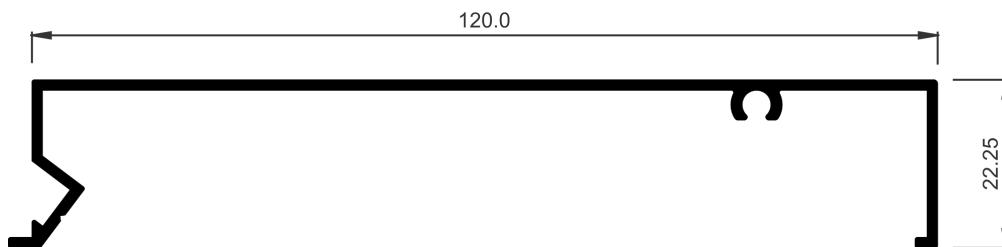

COR-2726	
Descripción Description	Cubre premarco 120 mm Pre-frame cover 120 mm
Peso Weight (g/m)	688,5
Superficie Surface (dm ² /m)	36,05
Ix (cm ⁴)	1,09
Iy (cm ⁴)	47,2
Observaciones Observations	Tornillo Ø3.9 mm DIN7504N-A2 Ø3.9 mm DIN7504N-A2 screw

COR 70 C16 ST
Perfiles a escala

COR 70 C16 ST
Profiles to scale

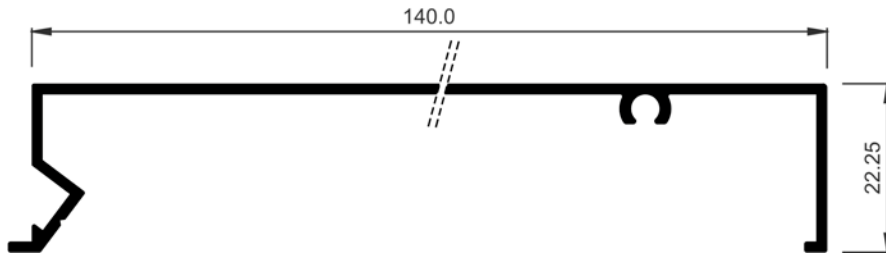

COR-2727	
Descripción Description	Cubre premarco 140 mm Pre-frame cover 140 mm
Peso Weight (g/m)	764,1
Superficie Surface (dm ² /m)	40,05
Ix (cm ⁴)	1,13
Iy (cm ⁴)	69,51
Observaciones Observations	Tornillo Ø3.9 mm DIN7504N-A2 Ø3.9 mm DIN7504N-A2 screw

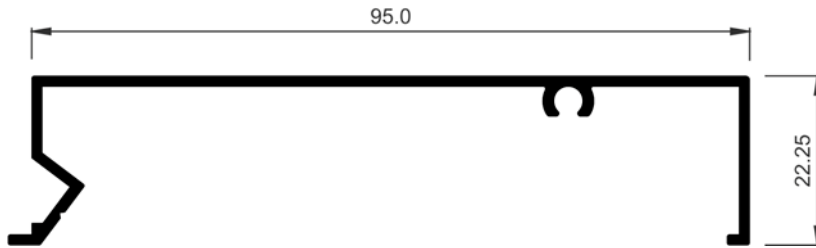

COR-2790	
Descripción Description	Cubre premarco 95 mm Pre-frame cover 95 mm
Peso Weight (g/m)	591,3
Superficie Surface (dm ² /m)	30,96
Ix (cm ⁴)	1,02
Iy (cm ⁴)	26,25
Observaciones Observations	Tornillo Ø3.9 mm DIN7504N-A2 Ø3.9 mm DIN7504N-A2 screw

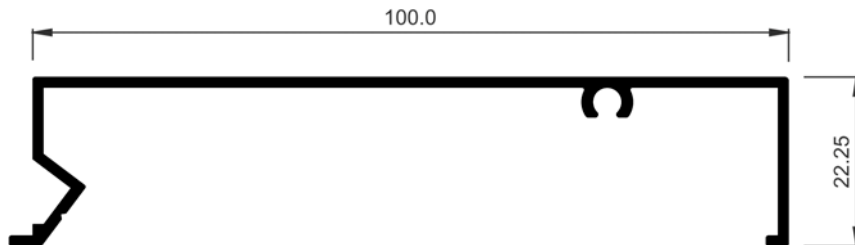

COR-2791	
Descripción Description	Cubre premarco 100 mm Pre-frame cover 100 mm
Peso Weight (g/m)	610,2
Superficie Surface (dm ² /m)	31,96
Ix (cm ⁴)	1,03
Iy (cm ⁴)	29,81
Observaciones Observations	Tornillo Ø3.9 mm DIN7504N-A2 Ø3.9 mm DIN7504N-A2 screw

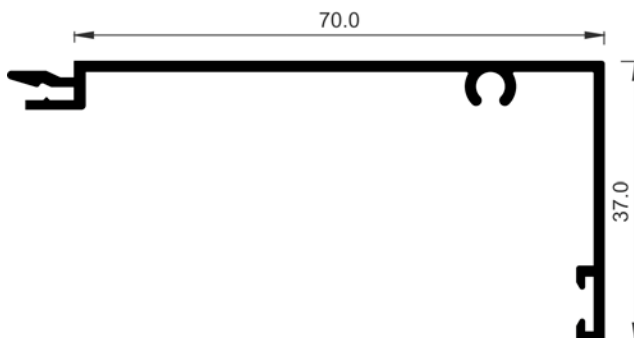

COR-2815	
Descripción Description	Tapé recto de 70 mm Straight cap of 70 mm
Peso Weight (g/m)	499,5
Superficie Surface (dm ² /m)	28,54
Ix (cm ⁴)	2,16
Iy (cm ⁴)	13,69

COR 70 C16 ST
Perfiles a escala

COR 70 C16 ST
Profiles to scale

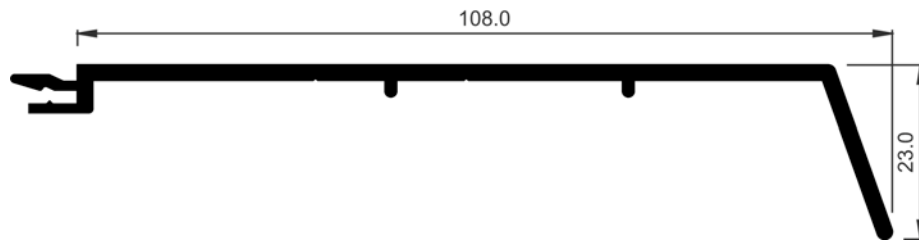

COR-2816	
Descripción Description	Tapé achaflanado de 108 mm Bevelled cap of 108 mm
Peso Weight (g/m)	753,3
Superfície Surface (dm ² /m)	29,58
Ix (cm ⁴)	0,64
Iy (cm ⁴)	37,19

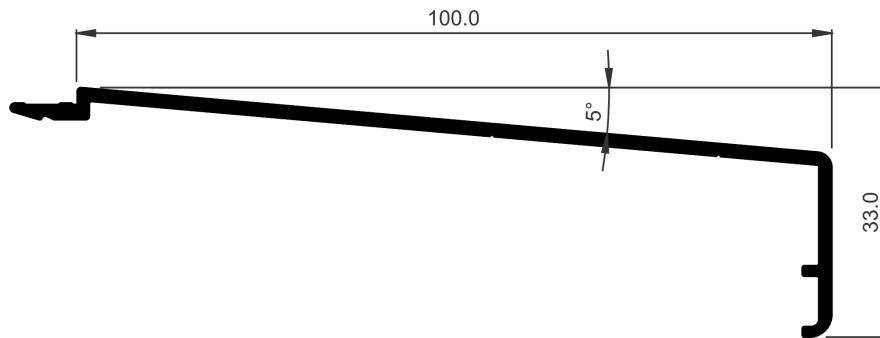

COR-2817	
Descripción Description	Alargadera con enganche de 100 mm Extension with attachment of 100 mm
Peso Weight (g/m)	626,4
Superfície Surface (dm ² /m)	27,69
Ix (cm ⁴)	1,34
Iy (cm ⁴)	29,29

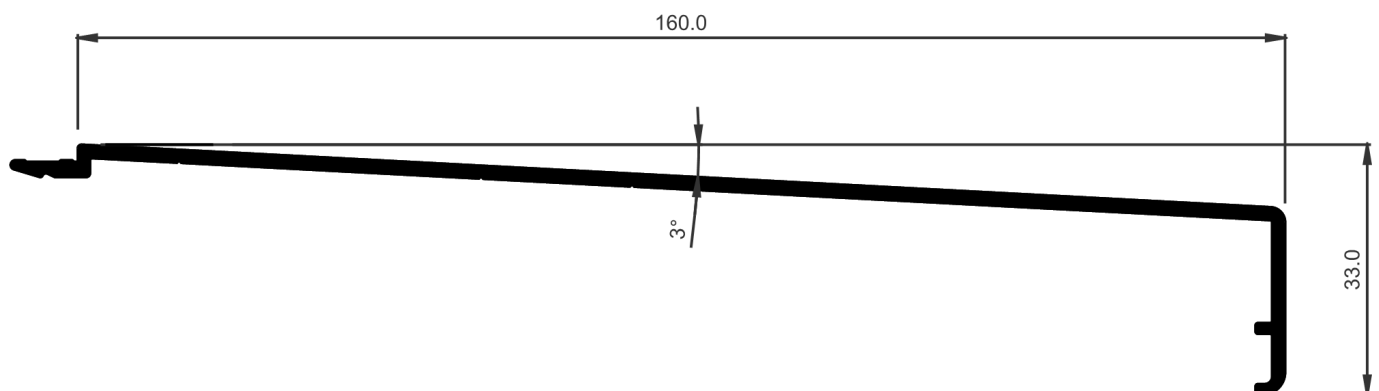

COR-2818	
Descripción Description	Alargadera con enganche de 160 mm Extension with attachment of 160 mm
Peso Weight (g/m)	901,8
Superfície Surface (dm ² /m)	39,76
Ix (cm ⁴)	1,47
Iy (cm ⁴)	97,1

COR 70 C16 ST
Perfiles a escala

COR 70 C16 ST
Profiles to scale

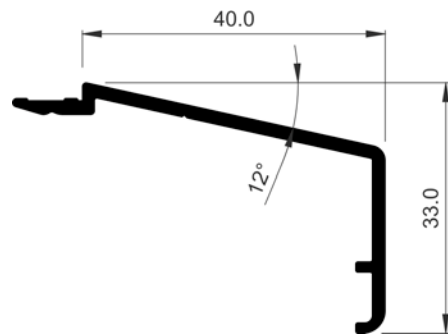

COR-2819	
Descripción Description	Alargadera con enganche de 40 mm Extension with attachment of 40 mm
Peso Weight (g/m)	353,7
Superficie Surface (dm ² /m)	15,8
Ix (cm⁴)	1,12
Iy (cm⁴)	3,38

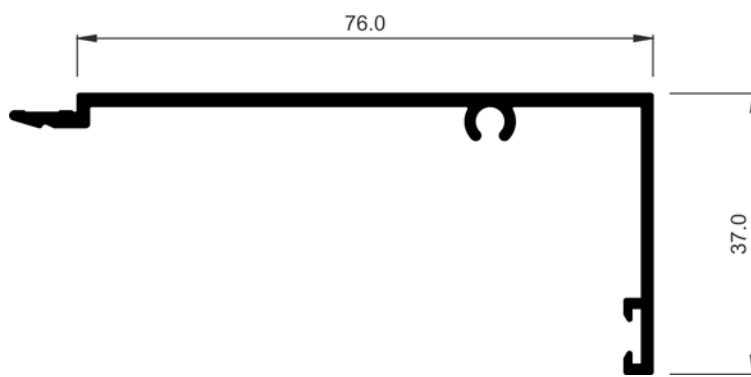

COR-2824	
Descripción Description	Tapé recto de 75 mm Straight cap of 75 mm
Peso Weight (g/m)	604,8
Superficie Surface (dm ² /m)	27,93
Ix (cm⁴)	2,46
Iy (cm⁴)	17,14

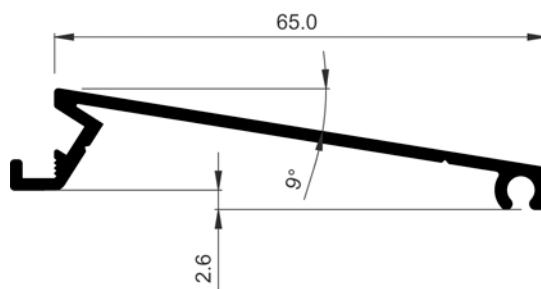

COR-2870	
Descripción Description	Alargadera de 65 mm 65 mm cill
Peso Weight (g/m)	415,8
Superficie Surface (dm ² /m)	19,92
Ix (cm⁴)	0,23
Iy (cm⁴)	8,45
Observaciones Observations	Tornillo Ø3.9 mm DIN7504N-A2 Ø3.9 mm DIN7504N- A2 screw

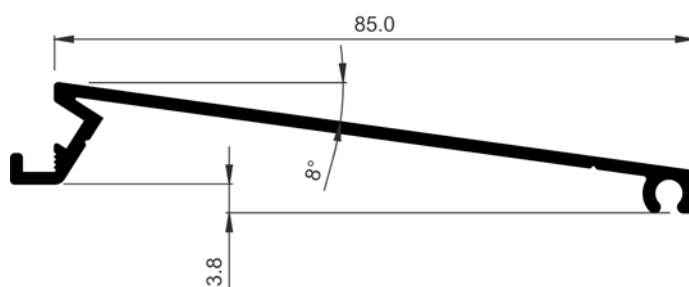

COR-2872	
Descripción Description	Alargadera de 85 mm 85 mm cill
Peso Weight (g/m)	496,8
Superficie Surface (dm ² /m)	23,92
Ix (cm⁴)	0,3
Iy (cm⁴)	16,49
Observaciones Observations	Tornillo Ø3.9 mm DIN7504N-A2 Ø3.9 mm DIN7504N- A2 screw

COR 70 C16 ST
Perfiles a escala

COR 70 C16 ST
Profiles to scale

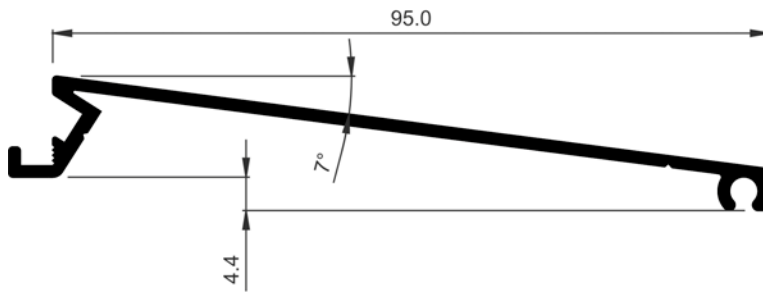

COR-2873	
Descripción Description	Alargadera de 95 mm 95 mm cill
Peso Weight (g/m)	537,3
Superficie Surface (dm ² /m)	25,92
Ix (cm⁴)	0,35
Iy (cm⁴)	21,83
Observaciones Observations	Tornillo Ø3.9 mm DIN7504N-A2 Ø3.9 mm DIN7504N-A2 screw

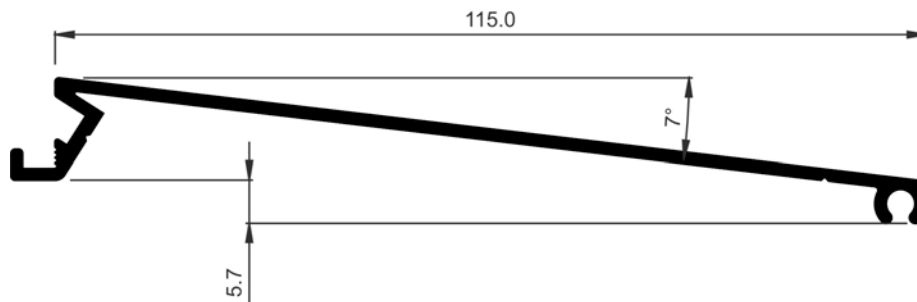

COR-2875	
Descripción Description	Alargadera de 115 mm 115 mm cill
Peso Weight (g/m)	618,3
Superficie Surface (dm ² /m)	29,93
Ix (cm⁴)	0,45
Iy (cm⁴)	35,54
Observaciones Observations	Tornillo Ø3.9 mm DIN7504N-A2 Ø3.9 mm DIN7504N-A2 screw

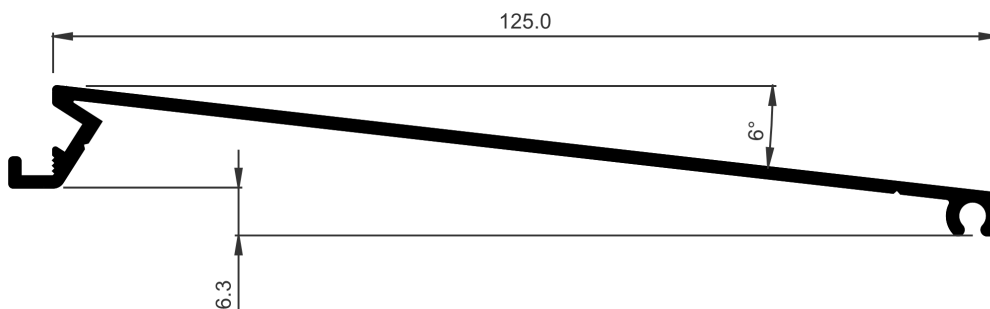

COR-2876	
Descripción Description	Alargadera de 125 mm 125 mm cill
Peso Weight (g/m)	656,1
Superficie Surface (dm ² /m)	31,93
Ix (cm⁴)	0,51
Iy (cm⁴)	44,06
Observaciones Observations	Tornillo Ø3.9 mm DIN7504N-A2 Ø3.9 mm DIN7504N-A2 screw

COR 70 C16 ST
Perfiles a escala

COR 70 C16 ST
Profiles to scale

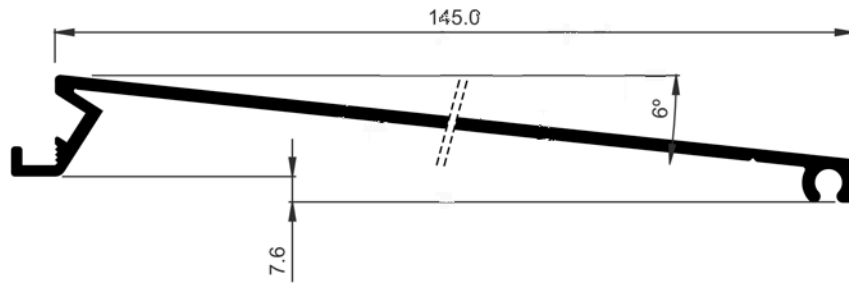

COR-2878	
Descripción Description	Alargadera de 145 mm 145 mm cill
Peso Weight (g/m)	737,1
Superficie Surface (dm ² /m)	35,94
Ix (cm ⁴)	0,64
Iy (cm ⁴)	64,8
Observaciones Observations	Tornillo Ø3.9 mm DIN7504N-A2 Ø3.9 mm DIN7504N-A2 screw

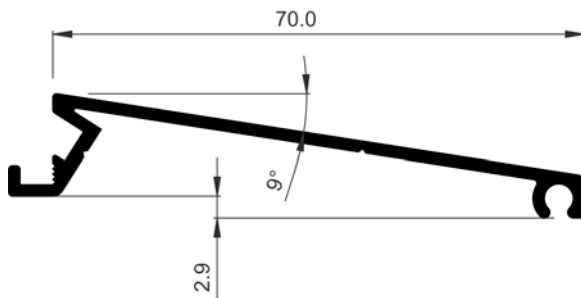

COR-2888	
Descripción Description	Alargadera de 70 mm 70 mm cill
Peso Weight (g/m)	437,4
Superficie Surface (dm ² /m)	20,92
Ix (cm ⁴)	0,25
Iy (cm ⁴)	10,17
Observaciones Observations	Tornillo Ø3.9 mm DIN7504N-A2 Ø3.9 mm DIN7504N-A2 screw

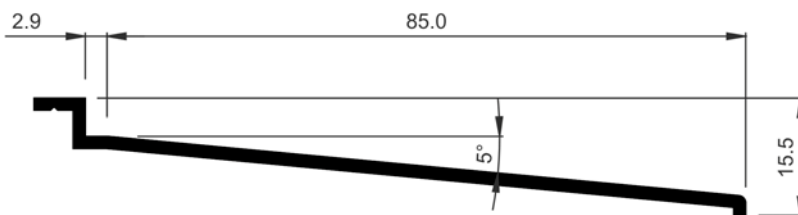

COR-7055	
Descripción Description	Alargadera de 85 mm 85 mm cill
Peso Weight (g/m)	434,7
Superficie Surface (dm ² /m)	20,54
Ix (cm ⁴)	0,19
Iy (cm ⁴)	12,95
Tornillería Screws	812913

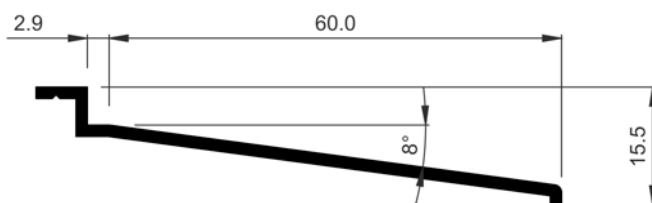

COR-7056	
Descripción Description	Alargadera de 60 mm 60 mm cill
Peso Weight (g/m)	307,8
Superficie Surface (dm ² /m)	15,57
Ix (cm ⁴)	0,15
Iy (cm ⁴)	5
Tornillería Screws	812913

COR 70 C16 ST
Perfiles a escala

COR 70 C16 ST
Profiles to scale

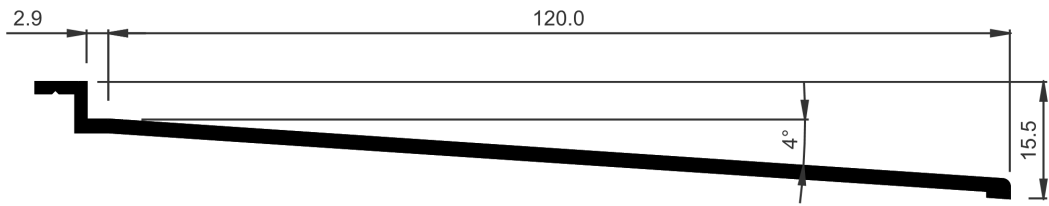

COR-7057	
Descripción Description	Alargadera de 120 mm 120 mm cill
Peso Weight (g/m)	618,3
Superficie Surface (dm ² /m)	27,5
Ix (cm ⁴)	0,23
Iy (cm ⁴)	33,9
Tornillería Screws	812913

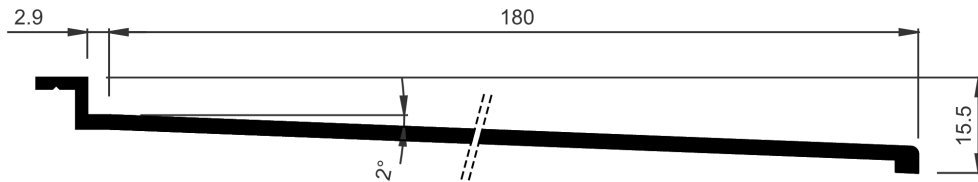

COR-7072	
Descripción Description	Alargadera de 180 mm 180 mm cill
Peso Weight (g/m)	950,4
Superficie Surface (dm ² /m)	39,66
Ix (cm ⁴)	0,26
Iy (cm ⁴)	110,95
Tornillería Screws	812913

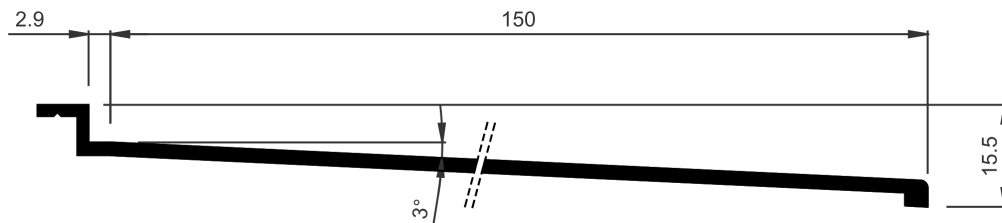

COR-7073	
Descripción Description	Alargadera de 150 mm 150 mm cill
Peso Weight (g/m)	764,1
Superficie Surface (dm ² /m)	33,66
Ix (cm ⁴)	0,22
Iy (cm ⁴)	64,13
Tornillería Screws	812913

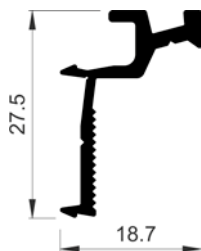

COR-2705	
Descripción Description	Grapa para solapes Clip for overlap
Peso Weight (g/m)	232,2
Superficie Surface (dm ² /m)	112,1
Ix (cm ⁴)	0,58
Iy (cm ⁴)	0,23
Tornillería Screws	853913

COR 70 C16 ST
Perfiles a escala

COR 70 C16 ST
Profiles to scale

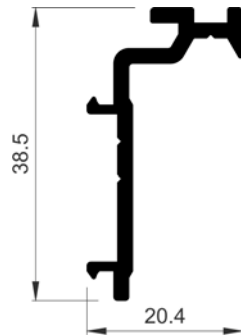

COR-2744	
Descripción Description	Grapa para solapes Clip for overlap
Peso Weight (g/m)	348,3
Superficie Surface (dm ² /m)	13,98
I_x (cm ⁴)	1,84
I_y (cm ⁴)	0,36
Tornillería Screws	853913

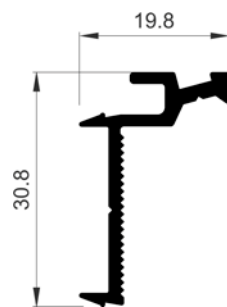

COR-2842	
Descripción Description	Grapa para solapes Clip for overlap
Peso Weight (g/m)	261,9
Superficie Surface (dm ² /m)	12,73
I_x (cm ⁴)	0,9
I_y (cm ⁴)	0,24
Tornillería Screws	853913

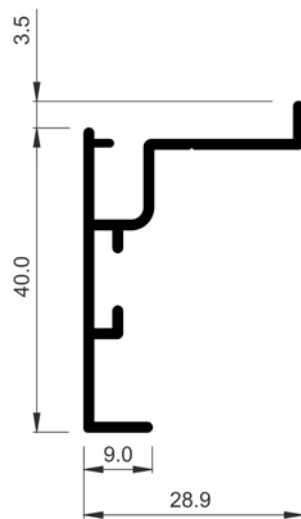

770224	
Descripción Description	Solape de registro recto Straight register overlap
Peso Weight (g/m)	353,7
Superficie Surface (dm ² /m)	20,3
I_x (cm ⁴)	2,24
I_y (cm ⁴)	0,98
Escuadra alineamiento Alignment cleat	245054
Observaciones Observations	Tornillo Ø3,9 mm DIN7504N-A2 Screw Ø3,9 mm DIN7504N-A2

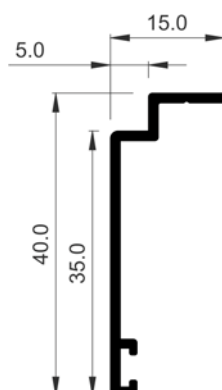

770229	
Descripción Description	Solape de 35 mm 35 mm overlap
Peso Weight (g/m)	205
Superficie Surface (dm ² /m)	12
I_x (cm ⁴)	1,38
I_y (cm ⁴)	0,11
Escuadra alineamiento Alignment cleat	282730

COR 70 C16 ST
Perfiles a escala

COR 70 C16 ST
Profiles to scale

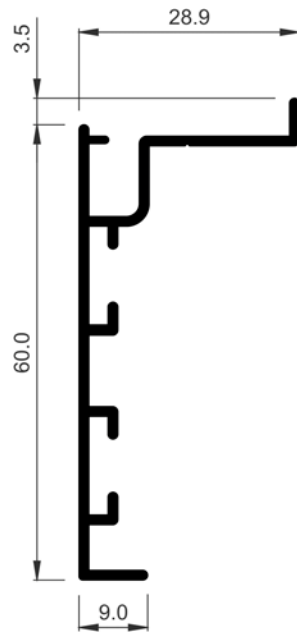

770563	
Descripción Description	Solape 60 mm 60 mm overlap
Peso Weight (g/m)	469,8
Superficie Surface (dm ² /m)	26,85
Ix (cm⁴)	6,94
Iy (cm⁴)	1,09
Escuadra alineamiento Alignment cleat	245054
Observaciones Observations	Tornillo Ø3.9 mm DIN7504N-A2 Screw Ø3.9 mm DIN7504N-A2

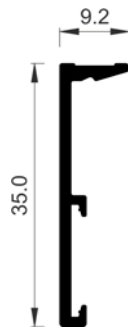

COR-1770	
Descripción Description	Solape de 35 mm 35 mm overlap
Peso Weight (g/m)	197,1
Superficie Surface (dm ² /m)	10,05
Ix (cm⁴)	0,95
Iy (cm⁴)	0,03
Escuadra alineamiento Alignment cleat	920135

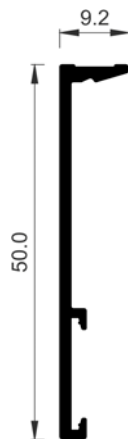

COR-1771	
Descripción Description	Solape de 50 mm 50 mm overlap
Peso Weight (g/m)	256,5
Superficie Surface (dm ² /m)	13,06
Ix (cm⁴)	2,5
Iy (cm⁴)	0,03



COR-1772	
Descripción Description	Solape de 25 mm 25 mm overlap
Peso Weight (g/m)	156,6
Superficie Surface (dm ² /m)	80,6
Ix (cm⁴)	0,39
Iy (cm⁴)	0,02

COR 70 C16 ST
Perfiles a escala

COR 70 C16 ST
Profiles to scale

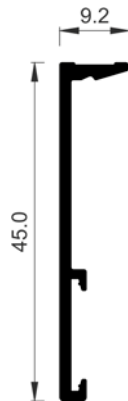

COR-1773	
Descripción Description	Solape de 45 mm 45 mm overlap
Peso Weight (g/m)	237,6
Superficie Surface (dm ² /m)	12,06
Ix (cm⁴)	1,87
Iy (cm⁴)	0,03

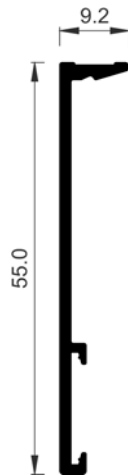

COR-1776	
Descripción Description	Solape de 55 mm 55 mm overlap
Peso Weight (g/m)	278,1
Superficie Surface (dm ² /m)	14,06
Ix (cm⁴)	3,23
Iy (cm⁴)	0,28

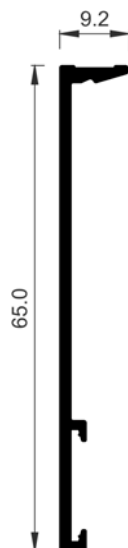

COR-1777	
Descripción Description	Solape de 65 mm 65 mm overlap
Peso Weight (g/m)	318,6
Superficie Surface (dm ² /m)	16,06
Ix (cm⁴)	5,1
Iy (cm⁴)	0,29

COR 70 C16 ST
Perfiles a escala

COR 70 C16 ST
Profiles to scale

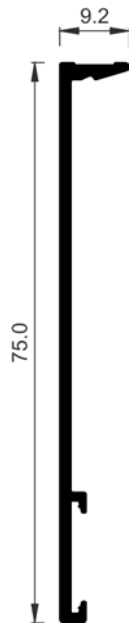

COR-1778	
Descripción Description	Solape de 75 mm 75 mm overlap
Peso Weight (g/m)	35,91
Superficie Surface (dm ² /m)	18,06
Ix (cm⁴)	7,57
Iy (cm⁴)	0,29

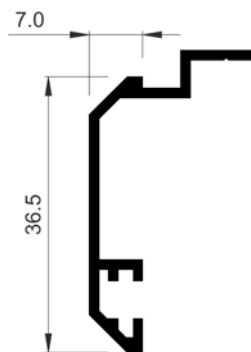

COR-2026	
Descripción Description	Solape 35 mm 35 mm overlap
Peso Weight (g/m)	272,7
Superficie Surface (dm ² /m)	15,24
Ix (cm⁴)	1,8
Iy (cm⁴)	0,33
Escuadra alineamiento Alignment cleat	212008
Observaciones Observations	Tornillo Ø3.9 mm DIN7504N-A2. Screw Ø3.9 mm DIN7504N-A2

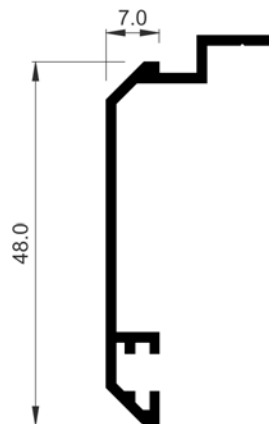

COR-2036	
Descripción Description	Solape 48 mm 48 mm overlap
Peso Weight (g/m)	272,7
Superficie Surface (dm ² /m)	17,63
Ix (cm⁴)	3,19
Iy (cm⁴)	0,31
Escuadra alineamiento Alignment cleat	212008
Observaciones Observations	Tornillo Ø3.9 mm DIN7504N-A2 Screw Ø3.9 mm DIN7504N-A2

COR 70 C16 ST
Perfiles a escala

COR 70 C16 ST
Profiles to scale

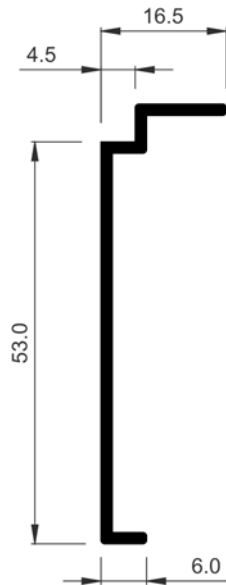

COR-2077	
Descripción Description	Solape recto de 53 mm 53 mm straight overlap
Peso Weight (g/m)	315,9
Superficie Surface (dm ² /m)	15,75
Ix (cm ⁴)	4,43
Iy (cm ⁴)	0,17
Observaciones Observations	Tornillo Ø3.9 mm DIN7504N-A2 Screw Ø3.9 mm DIN7504N-A2

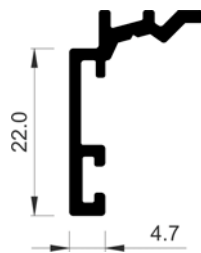

COR-2725	
Descripción Description	Solape recto 22 mm 22 mm straight overlap
Peso Weight (g/m)	245,7
Superficie Surface (dm ² /m)	11,2
Ix (cm ⁴)	0,71
Iy (cm ⁴)	0,2
Escuadra alineamiento Alignment cleat	212007
Observaciones Observations	Tornillo Ø3.9 mm DIN7504P-A2 Screw Ø3.9 mm DIN7504N-A2

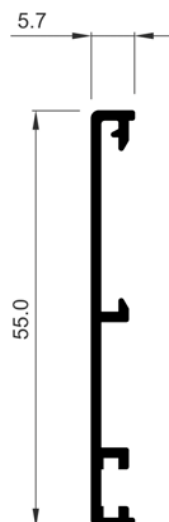

COR-2728	
Descripción Description	Solape recto de 55 mm Straight overlap 55 mm
Peso Weight (g/m)	270
Superficie Surface (dm ² /m)	16,03
Ix (cm ⁴)	3,19
Iy (cm ⁴)	0,02
Escuadra alineamiento Alignment cleat	212008 912100
Observaciones Observations	Grapa 2705 Clip 2705

COR 70 C16 ST
Perfiles a escala

COR 70 C16 ST
Profiles to scale

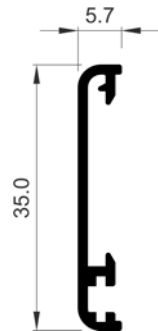

COR-2731	
Descripción Description	Solape de 35 mm Straight overlap 35 mm
Peso Weight (g/m)	183,6
Superficie Surface (dm ² /m)	11
Ix (cm⁴)	0,92
Iy (cm⁴)	0,02
Escuadra alineamiento Alignment cleat	212007 912100
Observaciones Observations	Grapa 2705 Clip 2705

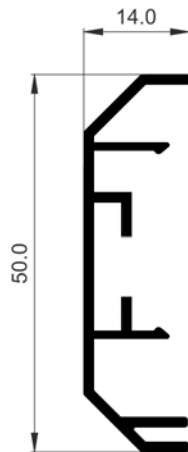

COR-2733	
Descripción Description	Solape chaflán de 50 mm Bevelled overlap 50 mm
Peso Weight (g/m)	367,2
Superficie Surface (dm ² /m)	21,82
Ix (cm⁴)	2,94
Iy (cm⁴)	1,75
Escuadra alineamiento Alignment cleat	207004 277004
Observaciones Observations	Grapa 2744 Clip 2744

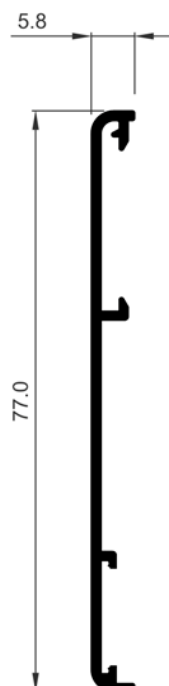

COR-2734	
Descripción Description	Solape de 77 mm 77 mm overlap
Peso Weight (g/m)	337,5
Superficie Surface (dm ² /m)	19,66
Ix (cm⁴)	7,31
Iy (cm⁴)	0,02
Escuadra alineamiento Alignment cleat	912100 920135
Observaciones Observations	Grapa 2705 Clip 2705

COR 70 C16 ST
Perfiles a escala

COR 70 C16 ST
Profiles to scale

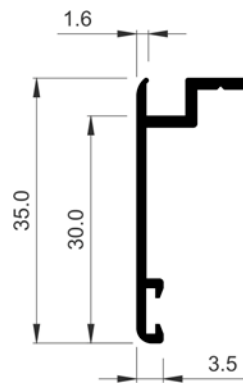

COR-2735	
Descripción Description	Solape de 35 mm Screw overlap
Peso Weight (g/m)	205,2
Superficie Surface (dm ² /m)	12,02
Ix (cm⁴)	0,99
Iy (cm⁴)	0,11
Tornillería Screws	852913
Escuadra alineamiento Alignment cleat	212007

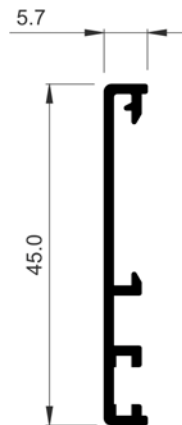

COR-2745	
Descripción Description	Solape recto 45 mm Straight overlap 45 mm
Peso Weight (g/m)	237,6
Superficie Surface (dm ² /m)	14,03
Ix (cm⁴)	1,88
Iy (cm⁴)	0,02
Escuadra alineamiento Alignment cleat	212008 912100
Observaciones Observations	Grapa 2705 Clip 2705

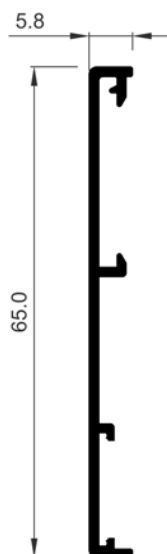

COR-2773	
Descripción Description	Solape recto de 65 mm Straight overlap 65 mm
Peso Weight (g/m)	299,7
Superficie Surface (dm ² /m)	17,49
Ix (cm⁴)	4,7
Iy (cm⁴)	0,02
Escuadra alineamiento Alignment cleat	912100 920135
Observaciones Observations	Grapa 2705 Clip 2705

COR 70 C16 ST
Perfiles a escala

COR 70 C16 ST
Profiles to scale

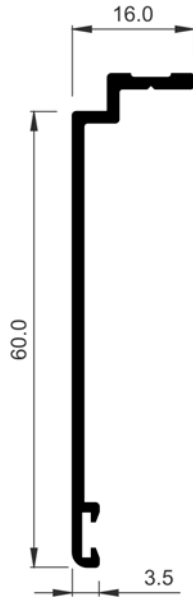

COR-2781	
Descripción Description	Solape recto 60 mm 60 mm straight overlap
Peso Weight (g/m)	337,5
Superficie Surface (dm ² /m)	17,32
Ix (cm⁴)	5,59
Iy (cm⁴)	0,18
Escuadra alineamiento Alignment cleat	212007
Observaciones Observations	Tornillo Ø3.9 mm DIN7504N-A2 Screw Ø3.9 mm DIN7504N-A2

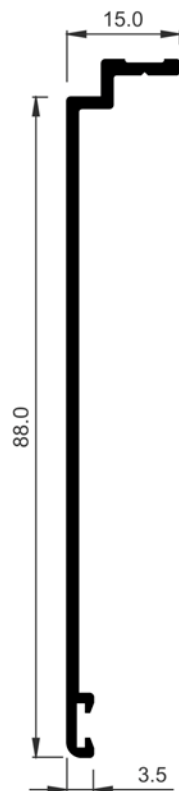

COR-2788	
Descripción Description	Solape recto 88 mm 88 mm straight overlap
Peso Weight (g/m)	450,9
Superficie Surface (dm ² /m)	22,92
Ix (cm⁴)	14,88
Iy (cm⁴)	0,19
Escuadra alineamiento Alignment cleat	212007
Observaciones Observations	Tornillo Ø3.9 mm DIN7504N-A2 Screw Ø3.9 mm DIN7504N-A2

COR 70 C16 ST
Perfiles a escala

COR 70 C16 ST
Profiles to scale

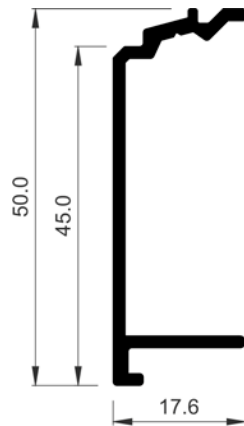

COR-2820	
Descripción Description	Tapa guía Guide end plate
Peso Weight (g/m)	369,9
Superficie Surface (dm ² /m)	16,72
Ix (cm⁴)	4,19
Iy (cm⁴)	0,36
Observaciones Observations	Tornillo Ø3,9 mm DIN7504P-A2 Ø2,9 mm DIN7504N- A2 screw

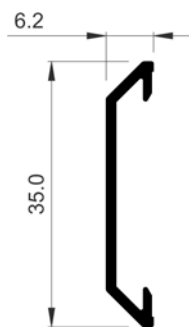

COR-2831	
Descripción Description	Solape de 35 mm 35 mm overlap
Peso Weight (g/m)	159,3
Superficie Surface (dm ² /m)	9,31
Ix (cm⁴)	0,76
Iy (cm⁴)	0,02
Escuadra alineamiento Alignment cleat	242831
Grapa Clip	342842

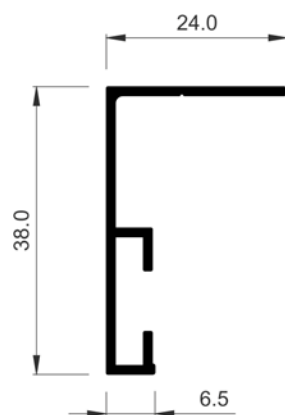

COR-2833	
Descripción Description	Tapajuntas atornillar 38 mm 38 mm flashings screw
Peso Weight (g/m)	259,2
Superficie Surface (dm ² /m)	16,08
Ix (cm⁴)	1,74
Iy (cm⁴)	0,37
Tornillería Screws	813919
Escuadra alineamiento Alignment cleat	207004 277004

COR 70 C16 ST
Perfiles a escala

COR 70 C16 ST
Profiles to scale

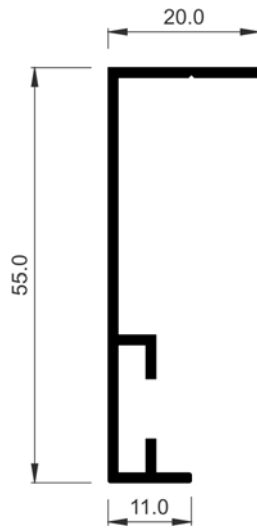

COR-2834	
Descripción Description	Solape de 55 mm atornillar (en L) 55 mm overlap screw (in L)
Peso Weight (g/m)	340,2
Superficie Surface (dm ² /m)	19,71
I_x (cm ⁴)	4,91
I_y (cm ⁴)	0,28
Tornillería Screws	813919
Escuadra alineamiento Alignment cleat	207004 277004

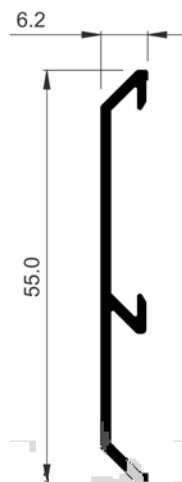

COR-2835	
Descripción Description	Solape de 55 mm 55 mm overlap
Peso Weight (g/m)	253,8
Superficie Surface (dm ² /m)	14,4
I_x (cm ⁴)	2,44
I_y (cm ⁴)	0,03
Escuadra alineamiento Alignment cleat	242831
Grapa Clip	342842

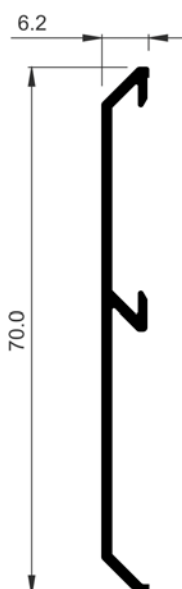

COR-2837	
Descripción Description	Solape de 70 mm 70 mm overlap
Peso Weight (g/m)	305,1
Superficie Surface (dm ² /m)	17,4
I_x (cm ⁴)	4,74
I_y (cm ⁴)	0,03
Escuadra alineamiento Alignment cleat	242831
Grapa Clip	342842

COR 70 C16 ST
Perfiles a escala

COR 70 C16 ST
Profiles to scale



COR-2839	
Descripción Description	Solape recto de 40 mm 40 mm straight overlap
Peso Weight (g/m)	232,2
Superficie Surface (dm ² /m)	14,42
Ix (cm⁴)	1,59
Iy (cm⁴)	0,04
Escuadra alineamiento Alignment cleat	920135
Observaciones Observations	Grapa 2744 Clip 2744

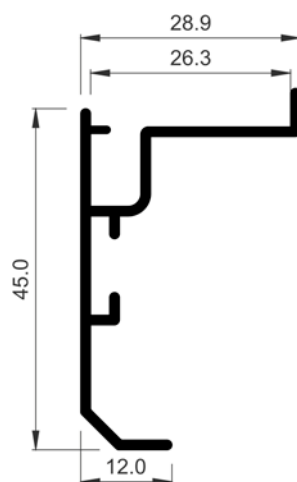

COR-2894	
Descripción Description	Solape de registro de 45 mm 45 mm register overlap
Peso Weight (g/m)	372,6
Superficie Surface (dm ² /m)	21,37
Ix (cm⁴)	2,87
Iy (cm⁴)	1
Tornillería Screws	813919
Escuadra alineamiento Alignment cleat	245054
Observaciones Observations	Tornillo Ø3,9 mm DIN7504N-A2 Screw Ø3,9 mm DIN7504N-A2

COR 70 C16 ST
Perfiles a escala

COR 70 C16 ST
Profiles to scale

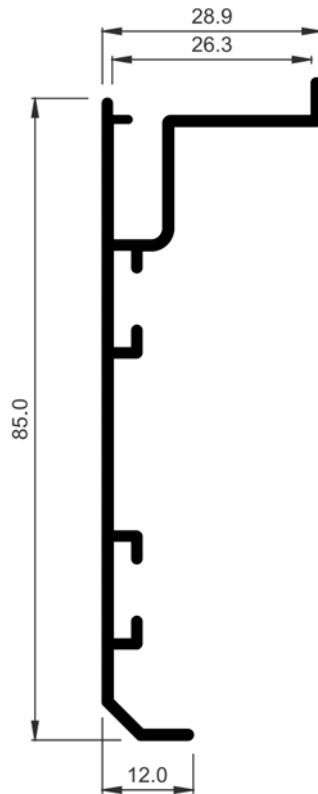

COR-2898	
Descripción Description	Solape de registro de 85 mm 85 mm register overlap
Peso Weight (g/m)	612,9
Superficie Surface (dm ² /m)	33,06
Ix (cm⁴)	17,56
Iy (cm⁴)	1,24
Tornillería Screws	813919
Escuadra alineamiento Alignment cleat	245054
Observaciones Observations	Tornillo Ø3.9 mm DIN7504N-A2 Screw Ø3.9 mm DIN7504N-A2

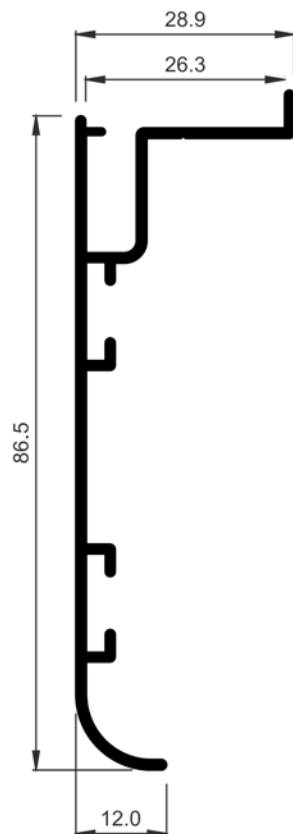

COR-5054	
Descripción Description	Solape de registro curvo de 86.50 mm Curve register overlap of 86,50 mm
Peso Weight (g/m)	621
Superficie Surface (dm ² /m)	33,11
Ix (cm⁴)	17,92
Iy (cm⁴)	1,23
Tornillería Screws	813919
Escuadra alineamiento Alignment cleat	245054
Observaciones Observations	Tornillo Ø3.9 mm DIN7504N-A2 Screw Ø3.9 mm DIN7504N-A2

COR 70 C16 ST
Perfiles a escala

COR 70 C16 ST
Profiles to scale

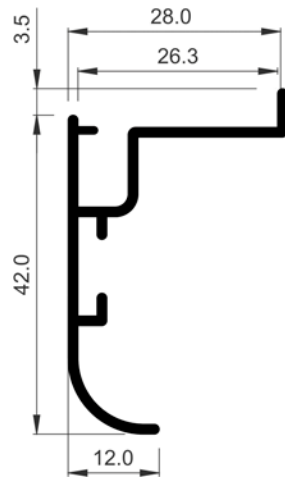

COR-5056	
Descripción Description	Solape de registro Register overlap
Peso Weight (g/m)	356,4
Superficie Surface (dm ² /m)	20,49
I_x (cm ⁴)	2,38
I_y (cm ⁴)	0,97
Tornillería Screws	813919
Escuadra alineamiento Alignment cleat	245054
Observaciones Observations	Tornillo Ø3.9 mm DIN7504N-A2 Screw Ø3.9 mm DIN7504N-A2

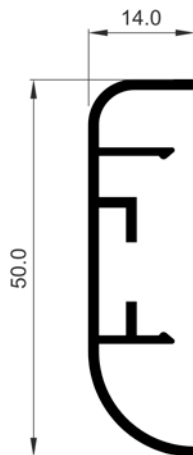

COR-7026	
Descripción Description	Solape de 50 mm 50 mm overlap
Peso Weight (g/m)	340,2
Superficie Surface (dm ² /m)	20,45
I_x (cm ⁴)	2,99
I_y (cm ⁴)	0,18
Escuadra alineamiento Alignment cleat	207004 277004
Observaciones Observations	Grapa 2744 Clip 2744

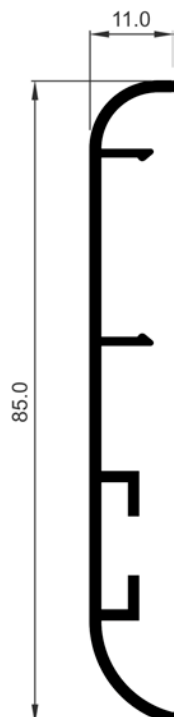

COR-7027	
Descripción Description	Solape de 85 mm 85 mm overlap
Peso Weight (g/m)	464,4
Superficie Surface (dm ² /m)	25,82
I_x (cm ⁴)	11,36
I_y (cm ⁴)	0,12
Escuadra alineamiento Alignment cleat	207004 277004
Observaciones Observations	Grapa 2744 Clip 2744

COR 70 C16 ST
Perfiles a escala

COR 70 C16 ST
Profiles to scale

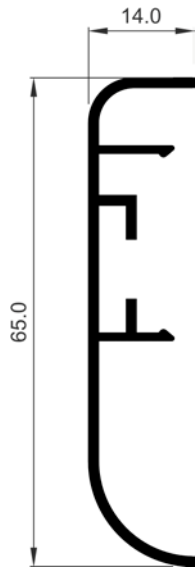

COR-7029	
Descripción Description	Solape de 65 mm 65 mm overlap
Peso Weight (g/m)	394,2
Superficie Surface (dm ² /m)	23,45
Ix (cm⁴)	5,75
Iy (cm⁴)	0,2
Escuadra alineamiento Alignment cleat	207004 277004
Observaciones Observations	Grapa 2744 Clip 2744

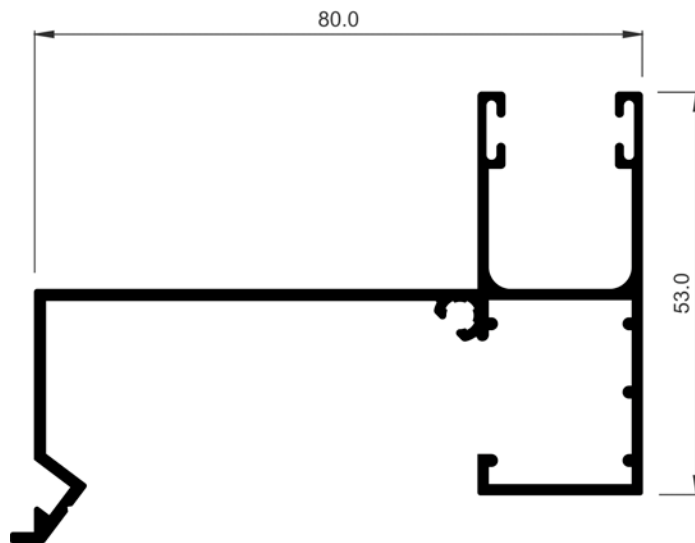

COR-2708	
Descripción Description	Guía de 80 mm 80 mm guide
Peso Weight (g/m)	926,1
Superficie Surface (dm ² /m)	50,34
Ix (cm⁴)	7,61
Iy (cm⁴)	29,27
Observaciones Observations	Tornillo Ø3.9 mm DIN7504N-A2. Sólo válida para persianas motorizadas Ø3.9 mm DIN7504N- A2 screw. Only for motorized shutters

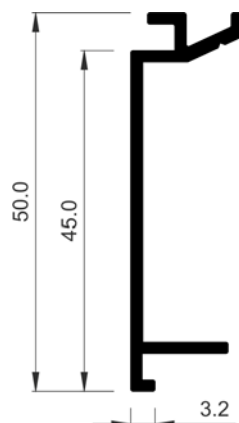

COR-2721	
Descripción Description	Tapa guía Guide cover
Peso Weight (g/m)	351
Superficie Surface (dm ² /m)	17,43
Ix (cm⁴)	3,91
Iy (cm⁴)	0,29
Observaciones Observations	Tornillo Ø3.9 mm DIN7504N-A2 Screw Ø3.9 mm DIN7504N-A2

COR 70 C16 ST
Perfiles a escala

COR 70 C16 ST
Profiles to scale

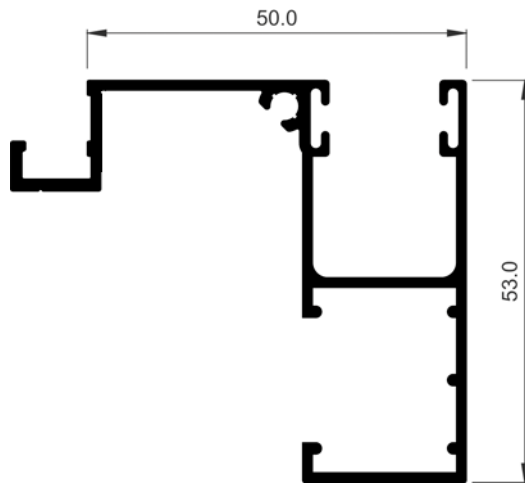

COR-2752	
Descripción Description	Guía de 50 mm Guide of 50 mm
Peso Weight (g/m)	758,7
Superficie Surface (dm ² /m)	41,84
Ix (cm⁴)	8,43
Iy (cm⁴)	9,58
Observaciones Observations	Tornillo Ø3.9 mm DIN7504N-A2 Screw Ø3.9 mm DIN7504N-A2

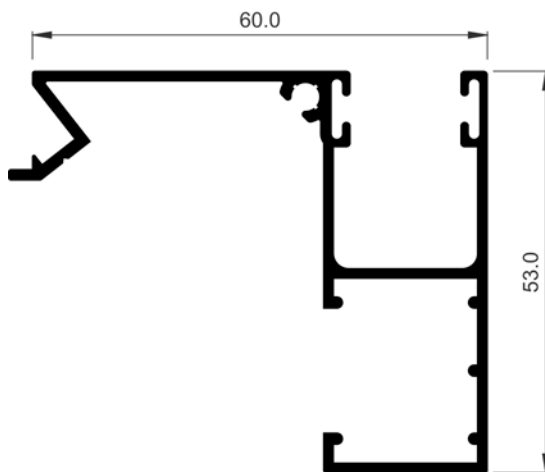

COR-2753	
Descripción Description	Guía de 60 mm Guide of 60 mm
Peso Weight (g/m)	761,4
Superficie Surface (dm ² /m)	42,42
Ix (cm⁴)	8,9
Iy (cm⁴)	10,72
Observaciones Observations	Tornillo Ø3.9 mm DIN7504N-A2 Screw Ø3.9 mm DIN7504N-A2

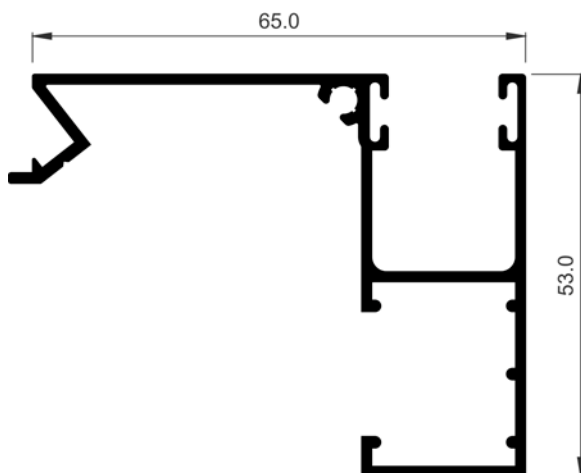

COR-2754	
Descripción Description	Guía de 65 mm Guide of 65 mm
Peso Weight (g/m)	777,6
Superficie Surface (dm ² /m)	43,42
Ix (cm⁴)	9,13
Iy (cm⁴)	13
Observaciones Observations	Tornillo Ø3.9 mm DIN7504N-A2 Screw Ø3.9 mm DIN7504N-A2

COR 70 C16 ST
Perfiles a escala

COR 70 C16 ST
Profiles to scale

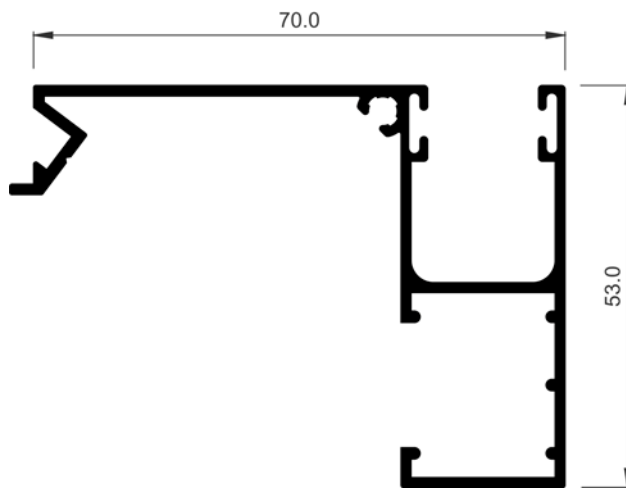

COR-2755	
Descripción Description	Guía de 70 mm Guide of 70 mm
Peso Weight (g/m)	810
Superficie Surface (dm ² /m)	44,33
Ix (cm⁴)	9,48
Iy (cm⁴)	16,21
Observaciones Observations	Tornillo Ø3.9 mm DIN7504N-A2 Screw Ø3.9 mm DIN7504N-A2

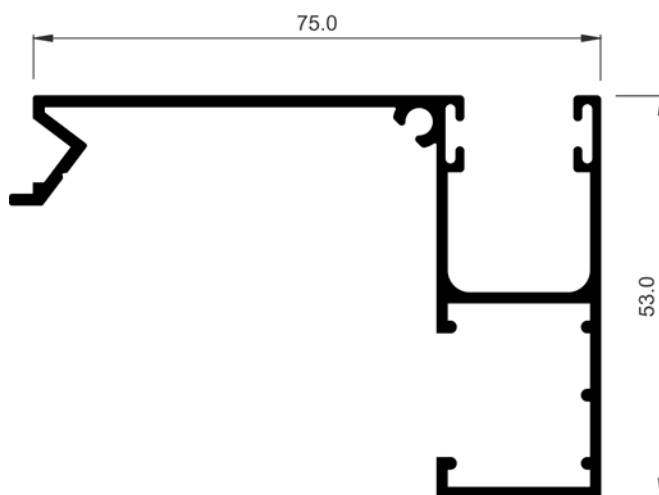

COR-2756	
Descripción Description	Guía de 75 mm Guide of 75 mm
Peso Weight (g/m)	828,9
Superficie Surface (dm ² /m)	44,99
Ix (cm⁴)	9,72
Iy (cm⁴)	18,84
Observaciones Observations	Tornillo Ø3.9 mm DIN7504N-A2 Screw Ø3.9 mm DIN7504N-A2

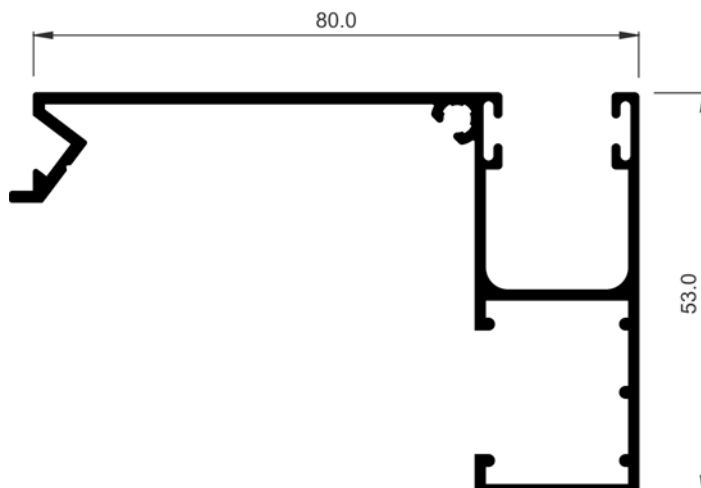

COR-2757	
Descripción Description	Guía de 80 mm Guide of 80 mm
Peso Weight (g/m)	847,8
Superficie Surface (dm ² /m)	46,33
Ix (cm⁴)	9,91
Iy (cm⁴)	22,59
Observaciones Observations	Tornillo Ø3.9 mm DIN7504N-A2 Screw Ø3.9 mm DIN7504N-A2

COR 70 C16 ST
Perfiles a escala

COR 70 C16 ST
Profiles to scale

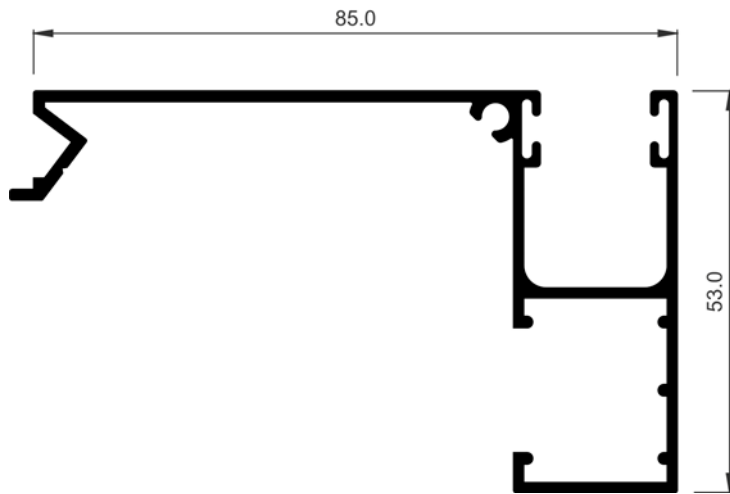

COR-2758	
Descripción Description	Guía de 85 mm Guide of 85 mm
Peso Weight (g/m)	866,7
Superficie Surface (dm ² /m)	46,99
Ix (cm ⁴)	10,13
Iy (cm ⁴)	25,79
Observaciones Observations	Tornillo Ø3.9 mm DIN7504N-A2 Screw Ø3.9 mm DIN7504N-A2

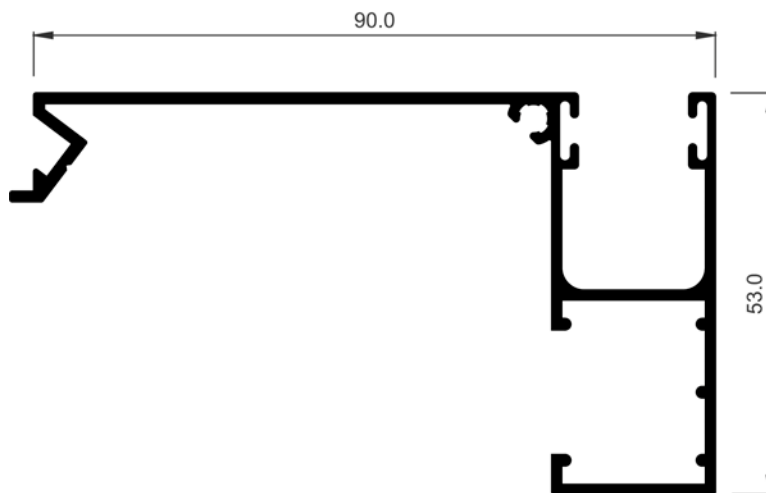

COR-2759	
Descripción Description	Guía de 90 mm Guide of 90 mm
Peso Weight (g/m)	885,6
Superficie Surface (dm ² /m)	48,32
Ix (cm ⁴)	10,3
Iy (cm ⁴)	30,36
Observaciones Observations	Tornillo Ø3.9 mm DIN7504N-A2 Screw Ø3.9 mm DIN7504N-A2

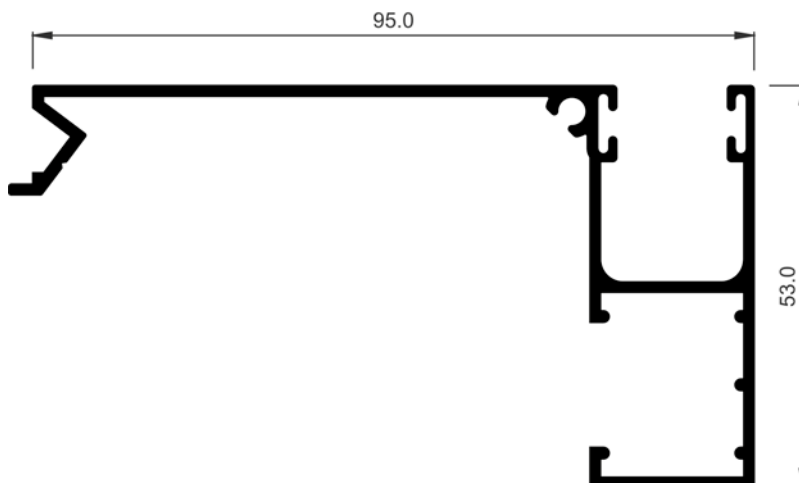

COR-2760	
Descripción Description	Guía de 95 mm Guide of 95 mm
Peso Weight (g/m)	918
Superficie Surface (dm ² /m)	48,83
Ix (cm ⁴)	10,72
Iy (cm ⁴)	34,47
Observaciones Observations	Tornillo Ø3.9 mm DIN7504N-A2 Screw Ø3.9 mm DIN7504N-A2

COR 70 C16 ST
Perfiles a escala

COR 70 C16 ST
Profiles to scale

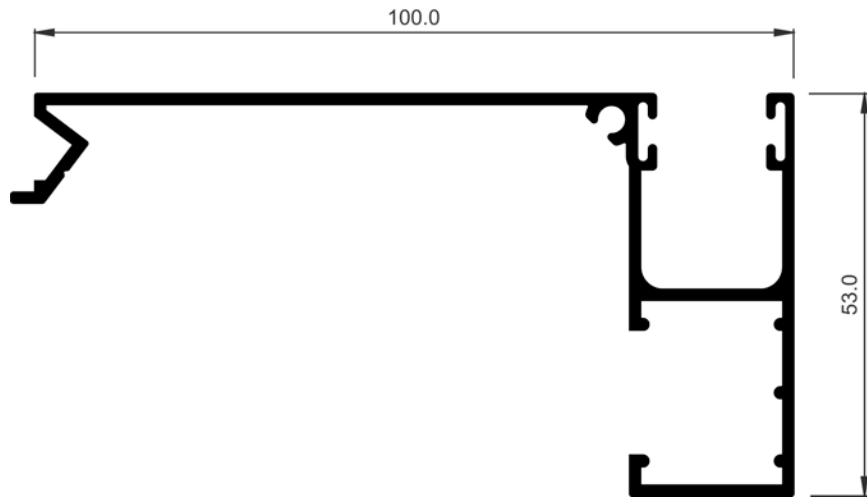

COR-2761	
Descripción Description	Guía de 100 mm Guide of 100 mm
Peso Weight (g/m)	950,4
Superficie Surface (dm²/m)	49,73
Ix (cm⁴)	11,1
Iy (cm⁴)	39,59
Observaciones Observations	Tornillo Ø3.9 mm DIN7504N-A2 Screw Ø3.9 mm DIN7504N-A2

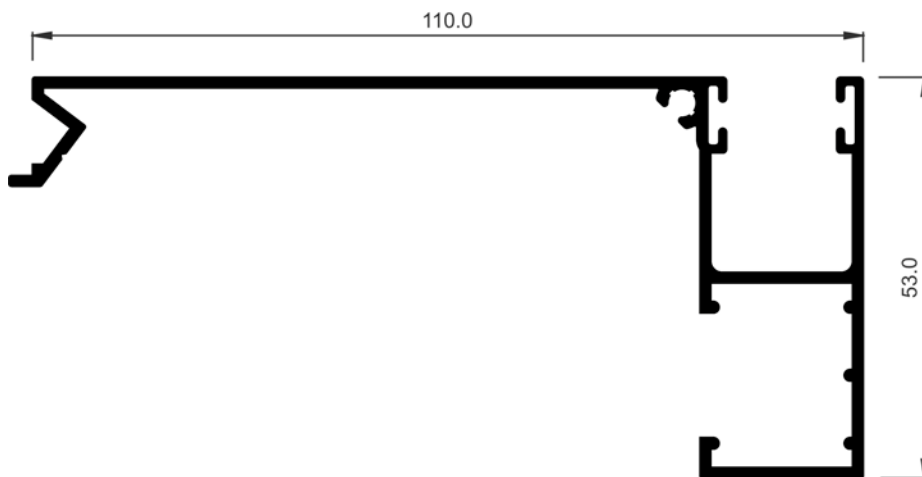

COR-2763	
Descripción Description	Guía de 110 mm Guide of 110 mm
Peso Weight (g/m)	977,4
Superficie Surface (dm²/m)	52,13
Ix (cm⁴)	11,4
Iy (cm⁴)	50,19
Observaciones Observations	Tornillo Ø3.9 mm DIN7504N-A2 Screw Ø3.9 mm DIN7504N-A2

COR 70 C16 ST
Perfiles a escala

COR 70 C16 ST
Profiles to scale

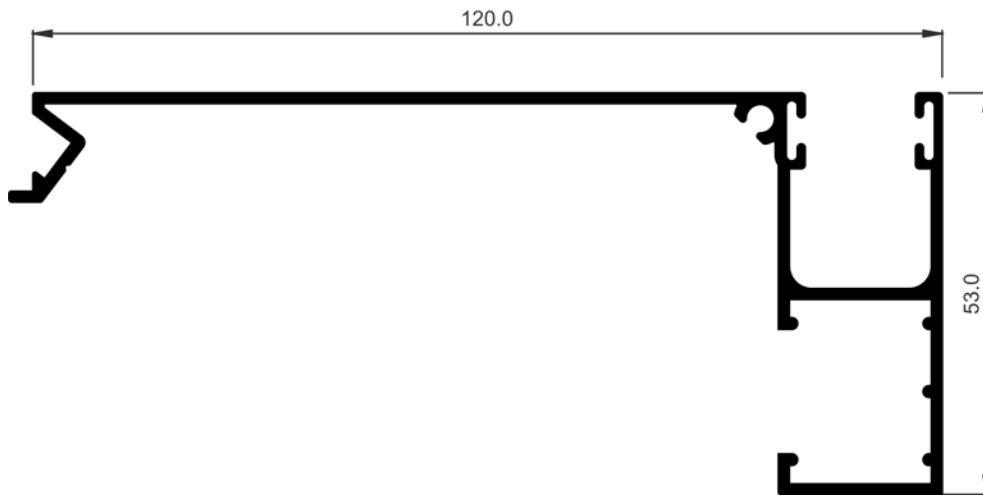

COR-2765

Descripción Description	Guía de 120 mm 120 mm guide
Peso Weight (g/m)	1028,7
Superficie Surface (dm ² /m)	53,82
Ix (cm ⁴)	63,68
Iy (cm ⁴)	11,77
Observaciones Observations	Tornillo Ø3.9 mm DIN7504N-A2 Screw Ø3.9 mm DIN7504N-A2

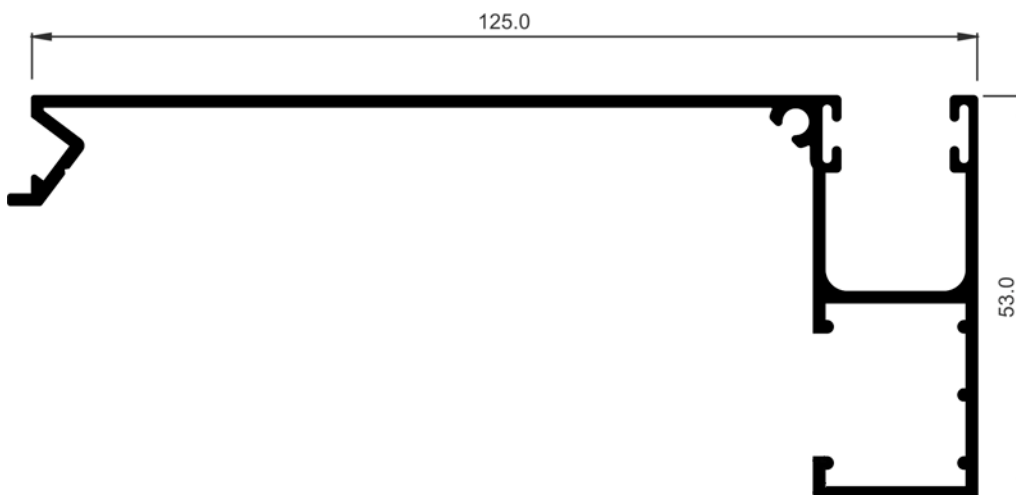

COR-2766

Descripción Description	Guía de 125 mm 125 mm guide
Peso Weight (g/m)	1047,6
Superficie Surface (dm ² /m)	54,82
Ix (cm ⁴)	11,93
Iy (cm ⁴)	70,69
Observaciones Observations	Tornillo Ø3.9 mm DIN7504N-A2 Screw Ø3.9 mm DIN7504N-A2

COR 70 C16 ST
Perfiles a escala

COR 70 C16 ST
Profiles to scale

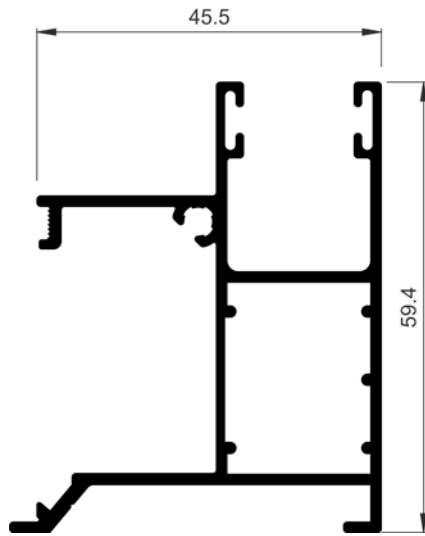

COR-2800	
Descripción Description	Guía de 45,5 mm embutir recogedor Cram scoop 45,5 mm guide
Peso Weight (g/m)	907,2
Superficie Surface (dm ² /m)	47,85
Ix (cm⁴)	10,85
Iy (cm⁴)	7,1
Observaciones Observations	Tornillo Ø3.9 mm DIN7504N-A2 Screw Ø3.9 mm DIN7504N-A2

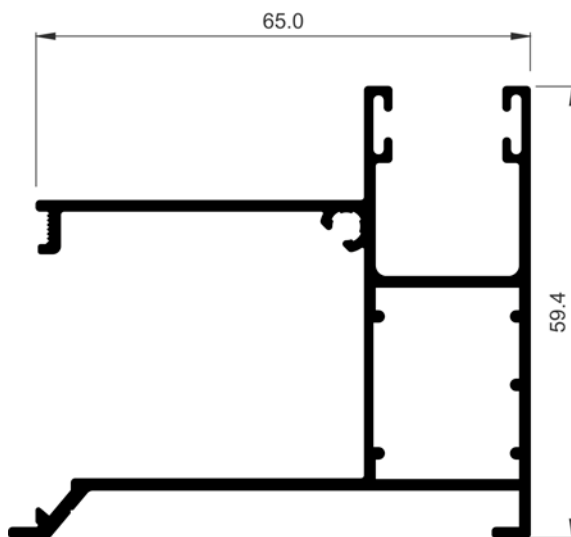

COR-2802	
Descripción Description	Guía de 65 mm embutir recogedor Cram scoop 65 mm guide
Peso Weight (g/m)	1061,1
Superficie Surface (dm ² /m)	55,65
Ix (cm⁴)	12,79
Iy (cm⁴)	16,98
Observaciones Observations	Tornillo Ø3.9 mm DIN7504N-A2 Screw Ø3.9 mm DIN7504N-A2

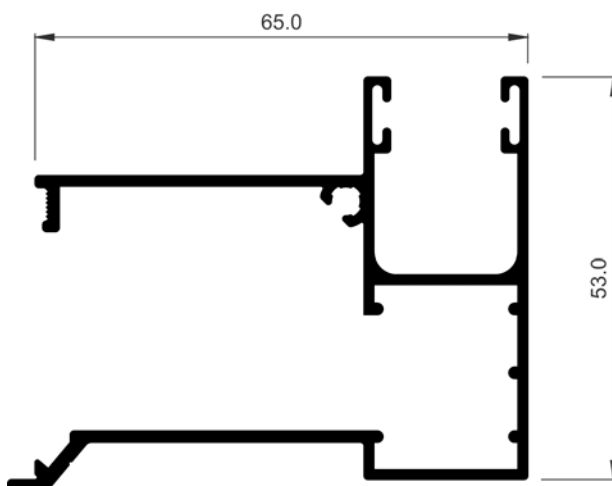

COR-2810	
Descripción Description	Guía de 65 mm embutir recogedor Cram scoop 65 mm guide
Peso Weight (g/m)	953,1
Superficie Surface (dm ² /m)	50,76
Ix (cm⁴)	10,16
Iy (cm⁴)	15,92
Observaciones Observations	Tornillo Ø3.9 mm DIN7504N-A2 Screw Ø3.9 mm DIN7504N-A2

COR 70 C16 ST
Perfiles a escala

COR 70 C16 ST
Profiles to scale

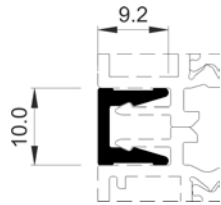

COR-4993	
Descripción Description	Unión marcos con enganche Frame joint profile with hook
Peso Weight (g/m)	108
Superficie Surface (dm ² /m)	5,18
Ix (cm⁴)	0,52
Iy (cm⁴)	0,28

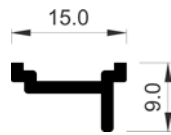

COR-7251	
Descripción Description	Unión de marcos oculta Concealed frame joint profile
Peso Weight (g/m)	105,3
Superficie Surface (dm ² /m)	5,15
Ix (cm⁴)	0,02
Iy (cm⁴)	0,08
Observaciones Observations	Tornillo Ø2.9 mm DIN7504N-A2 Ø2.9 mm DIN7504N-A2 screw

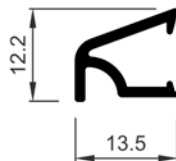

COR-8296	
Descripción Description	Goterón Raindrop
Peso Weight (g/m)	116,1
Superficie Surface (dm ² /m)	7,37
Ix (cm⁴)	0,06
Iy (cm⁴)	0,07
Tapas Covers	258206
Tornillería Screws	238297

aluminiosiberica.pai.pt



Aluminios Iberica, Lda

Sede e Fábrica: Rua parque Industrial, Nº 126
4720-536 Lago Amares
Telef. 253 310 250 / 253 310 251 Fax. 253 311 830
Email: geral@aluminiosiberica.pt

Filiais:

Vila Real Lugar de Couços – EN 115
5000-122 Justes – Vila Real
Telef. 259 331 778 / Fax. 259 928 092
Email: vreal@aluminiosiberica.pt



EXEMPLO CONCRETO
Painéis Sandwich - Perfis - Chapas - Remates - Acessórios

Vila Nova de Gaia (Exemplo Concreto, LDA)
Rua Nova de São Caetano, nº3
4405-819 Vilar do Paraíso
Telef. 227 629 539
Email: gaia@exemploconcreto.com



Armazém: Est. Do Campo de Aviação
3510-824 Campo – Viseu
Telef. 232 459 138 / 232 459 741
Fax. 232 450 140
Email: geral@alviz.pt



Armazém: Zona Industrial de Vilamoura
Lote 28 - Apartado 841
8126 -910 Quarteira
Telef. 289 322 748 Fax. 289 301 928
Email: pala.loule@sapo.pt



Armazém: Av. Almirante Gago Coutinho
Portela de Sintra - Apartado 212
2711 - 901 Sintra
Telef. 219 244 074 / 219 244 101 Fax. 219 241 015
Email: angularlda@sapo.pt