



Aluminios Iberica, Lda



PALA - MIGUEL & REIS, LDA.



EXEMPLO CONCRETO

Painéis Sandwich - Perfis - Chapas - Remates - Acessórios



ALUMÍNIOS DE VISEU, LDA.



ANGULAR - Alumínios, Lda.

Catálogo COR 80 HO



COR 80 HOJA OCULTA
Perfiles a escala

COR 80 HIDDEN SASH
Profiles to scale

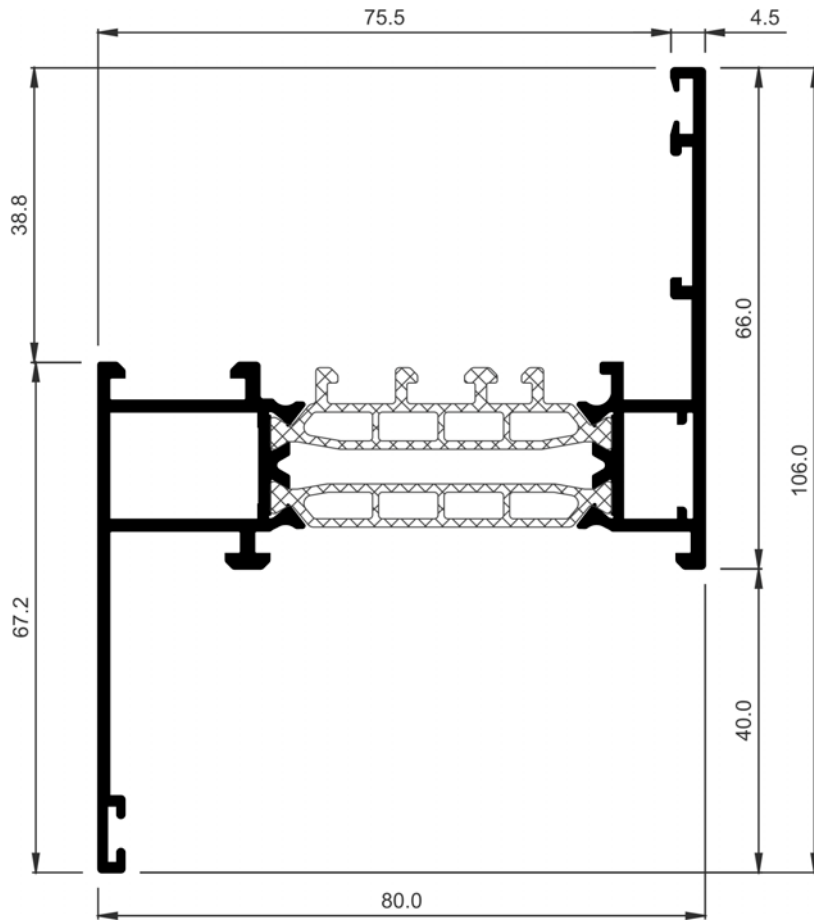

772446	
Descripción Description	Marco HO con solape de 40 mm Hidden sash frame with 40 mm overlap
Peso Weight (g/m)	1858,2
Superficie Surface (dm ² /m)	60,28
Ix (cm⁴)	21,32
Iy (cm⁴)	51,91
Escuadra principal Main cleat	347922
Troquel Punch tool	337999
Escuadra secundaria Secondary cleat	327921
Escuadra alineamiento Alignment cleat	287310
	960023

COR 80 HOJA OCULTA
Perfiles a escala

COR 80 HIDDEN SASH
Profiles to scale

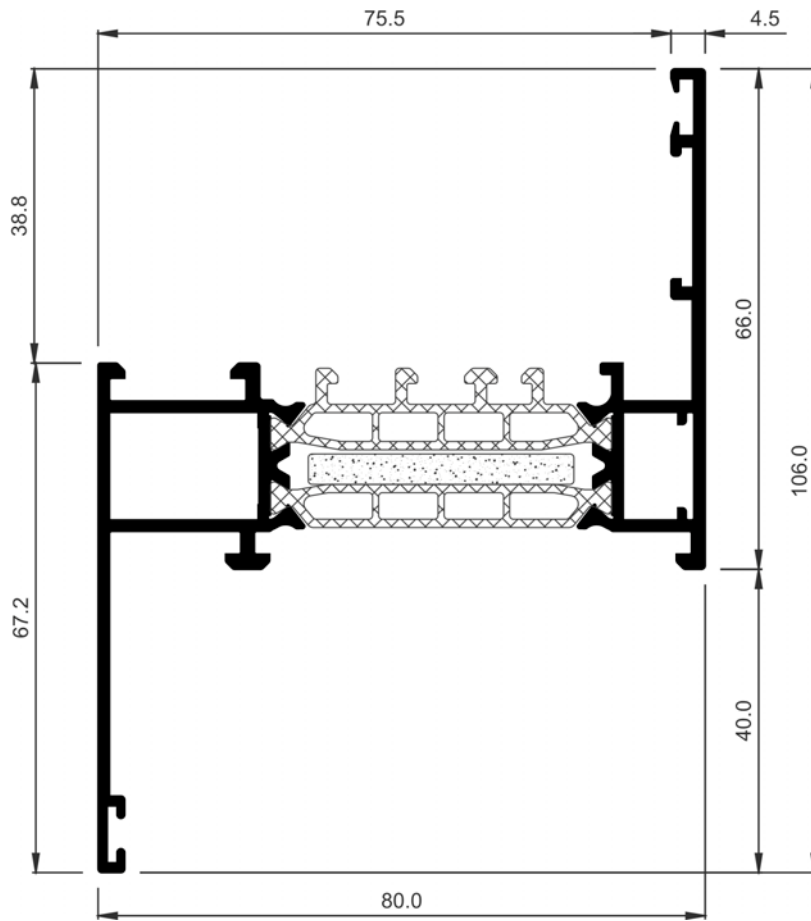

772447	
Descripción Description	Marco HO HI con solape de 40 mm Hidden sash frame with 40 mm overlap HI
Peso Weight (g/m)	1858,2
Superficie Surface (dm ² /m)	60,28
Ix (cm⁴)	21,32
Iy (cm⁴)	51,91
Escuadra principal Main cleat	347922
Troquel Punch tool	337999
Escuadra secundaria Secondary cleat	327921
Escuadra alineamiento Alignment cleat	287310
	960023

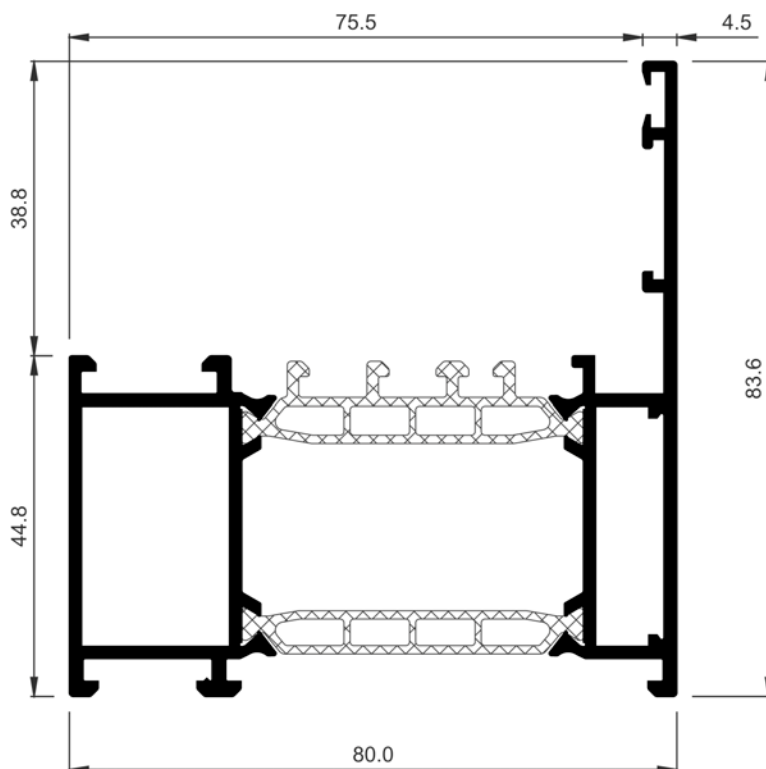

COR-7707	
Descripción Description	Marco balconera HO Balcony frame hidden sash
Peso Weight (g/m)	2036,4
Superficie Surface (dm ² /m)	65,11
Ix (cm⁴)	22,83
Iy (cm⁴)	54,35
Escuadra principal Main cleat	247231
Troquel Punch tool	337999
Escuadra secundaria Secondary cleat	357924
Escuadra alineamiento Alignment cleat	287310

COR 80 HOJA OCULTA
Perfiles a escala

COR 80 HIDDEN SASH
Profiles to scale

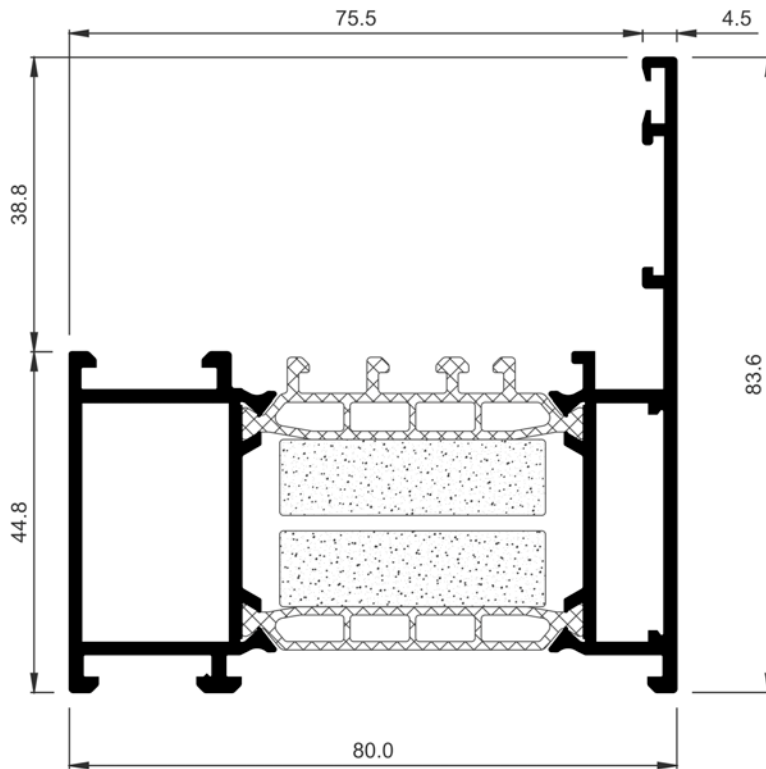

COR-7708	
Descripción Description	Marco balconera HO HI Balcony frame hidden sash HI
Peso Weight (g/m)	2036,4
Superficie Surface (dm ² /m)	65,11
Ix (cm⁴)	22,83
Iy (cm⁴)	54,35
Escuadra principal Main cleat	247231
Troquel Punch tool	337999
Escuadra secundaria Secondary cleat	357924
Escuadra alineamiento Alignment cleat	287310

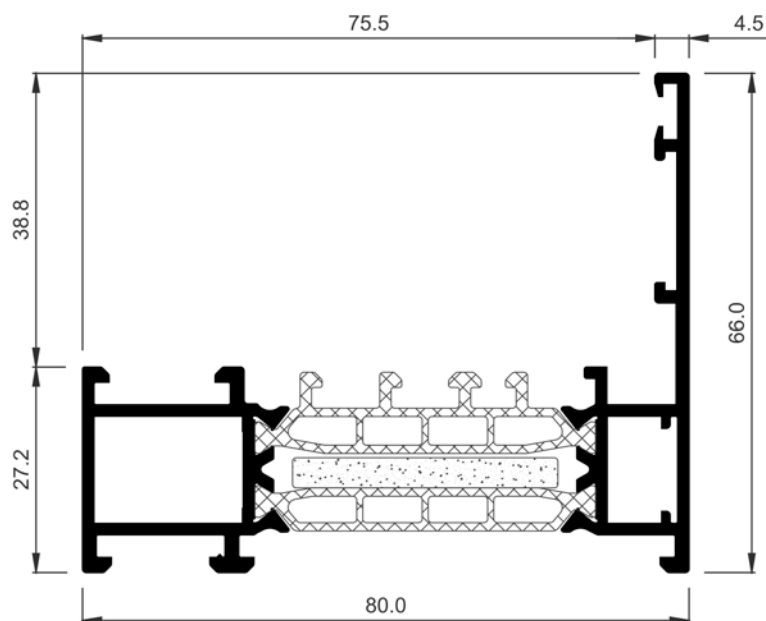

COR-7710	
Descripción Description	Marco HO HI Hidden Sash frame HI
Peso Weight (g/m)	1690,8
Superficie Surface (dm ² /m)	51,41
Ix (cm⁴)	10,57
Iy (cm⁴)	40,74
Escuadra principal Main cleat	347922
Troquel Punch tool	337999
Escuadra secundaria Secondary cleat	327921
Escuadra alineamiento Alignment cleat	287310

COR 80 HOJA OCULTA
Perfiles a escala

COR 80 HIDDEN SASH
Profiles to scale

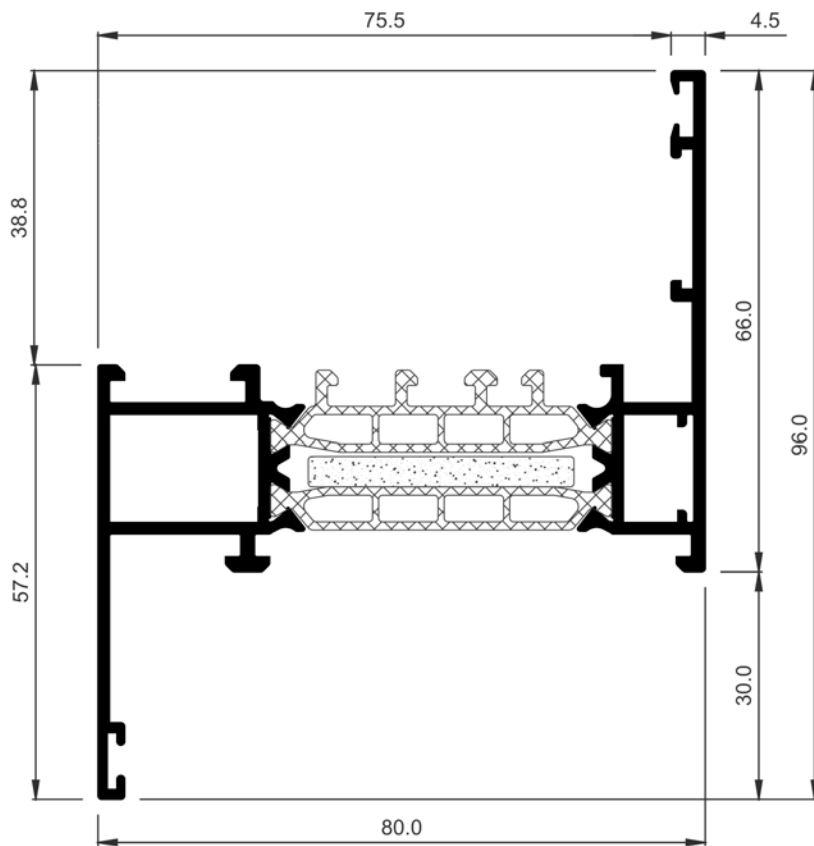

COR-7711	
Descripción Description	Marco con solape de 30 mm HO HI Hidden sash frame with 30 mm overlap HI
Peso Weight (g/m)	1815
Superficie Surface (dm ² /m)	58,48
I_x (cm ⁴)	16,92
I_y (cm ⁴)	49,33
Escuadra principal Main cleat	347922
Troquel Punch tool	337999
Escuadra secundaria Secondary cleat	327921
Escuadra alineamiento Alignment cleat	287310
	960023

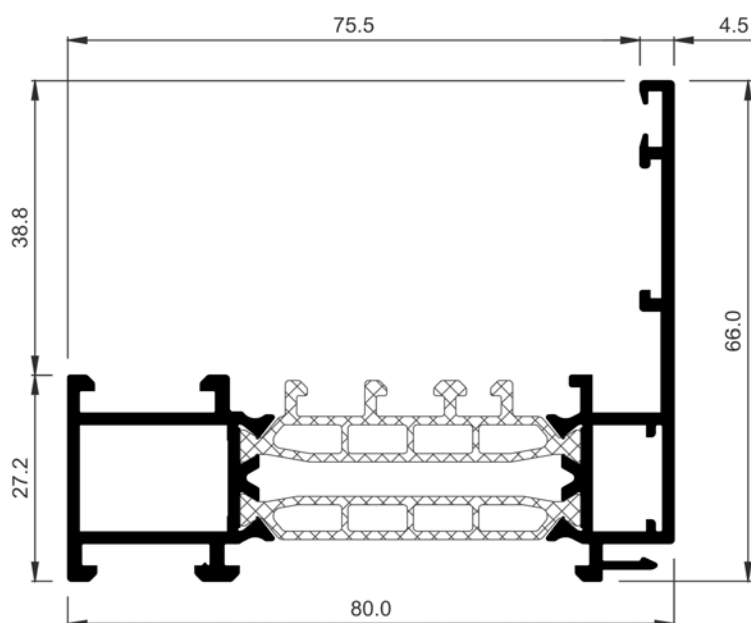

COR-7713	
Descripción Description	Marco con enganche HO Frame with hook Hidden Sash
Peso Weight (g/m)	1707
Superficie Surface (dm ² /m)	52,75
I_x (cm ⁴)	10,78
I_y (cm ⁴)	40,61
Escuadra principal Main cleat	347922
Troquel Punch tool	347799
Escuadra secundaria Secondary cleat	327921
Escuadra alineamiento Alignment cleat	287310

COR 80 HOJA OCULTA
Perfiles a escala

COR 80 HIDDEN SASH
Profiles to scale

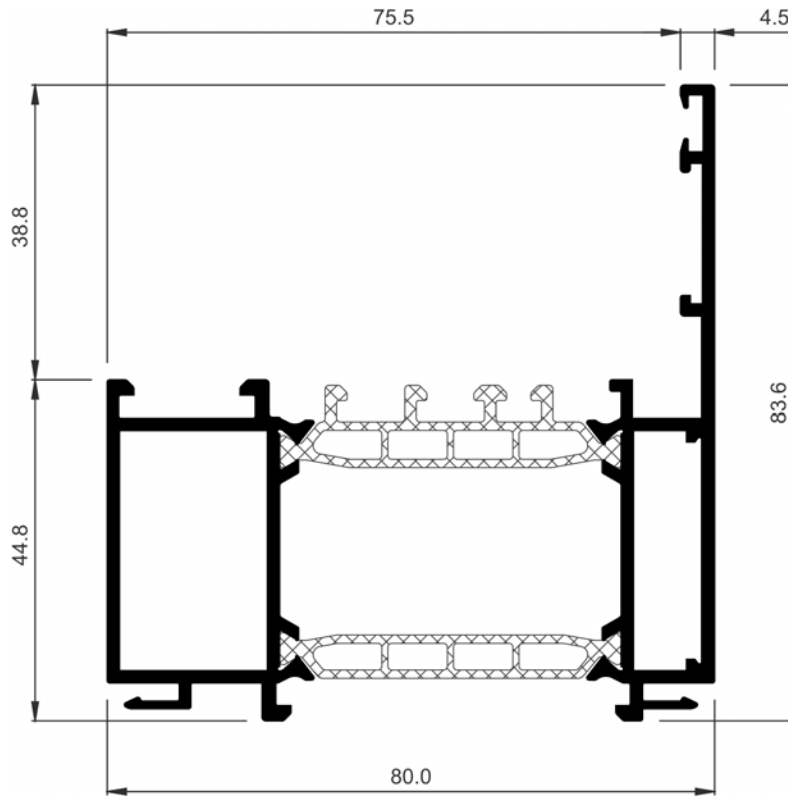

COR-7714	
Descripción Description	Marco balconera con enganches Balcony frame with hooks
Peso Weight (g/m)	2044,5
Superficie Surface (dm ² /m)	66,88
Ix (cm⁴)	22,97
Iy (cm⁴)	53,22
Escuadra principal Main cleat	247231
Troquel Punch tool	347799
Escuadra secundaria Secondary cleat	357924
Escuadra alineamiento Alignment cleat	287310

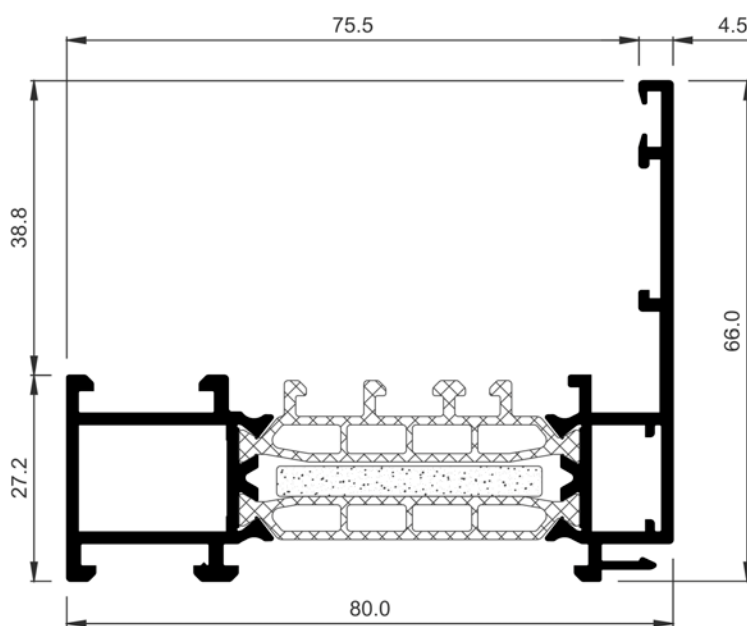

COR-7715	
Descripción Description	Marco con enganche HO HI Frame with hook Hidden Sash HI
Peso Weight (g/m)	1707
Superficie Surface (dm ² /m)	52,75
Ix (cm⁴)	10,78
Iy (cm⁴)	40,61
Escuadra principal Main cleat	347922
Troquel Punch tool	347799
Escuadra secundaria Secondary cleat	327921
Escuadra alineamiento Alignment cleat	287310

COR 80 HOJA OCULTA
Perfiles a escala

COR 80 HIDDEN SASH
Profiles to scale

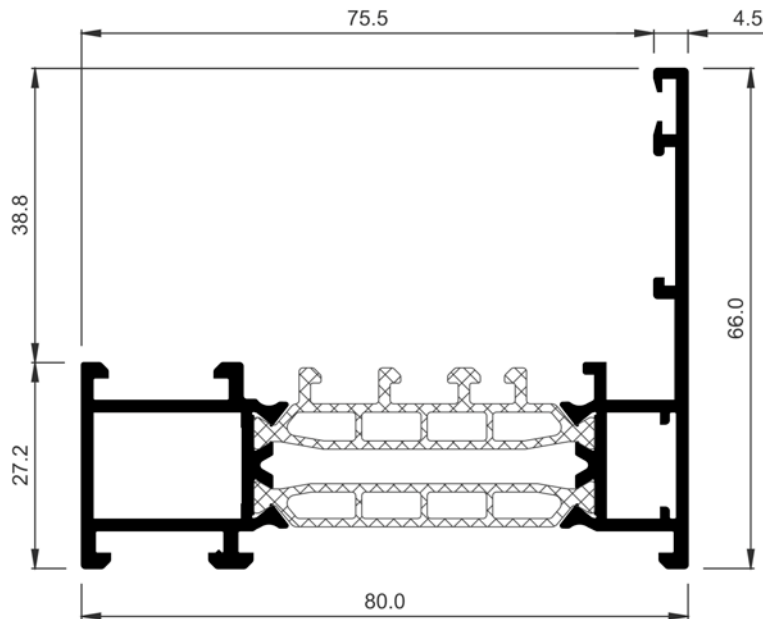

COR-7717	
Descripción Description	Marco HO Hidden Sash frame
Peso Weight (g/m)	1690,8
Superficie Surface (dm ² /m)	51,41
Ix (cm⁴)	10,57
Iy (cm⁴)	40,74
Escuadra principal Main cleat	347922
Troquel Punch tool	337999
Escuadra secundaria Secondary cleat	327921
Escuadra alineamiento Alignment cleat	287310

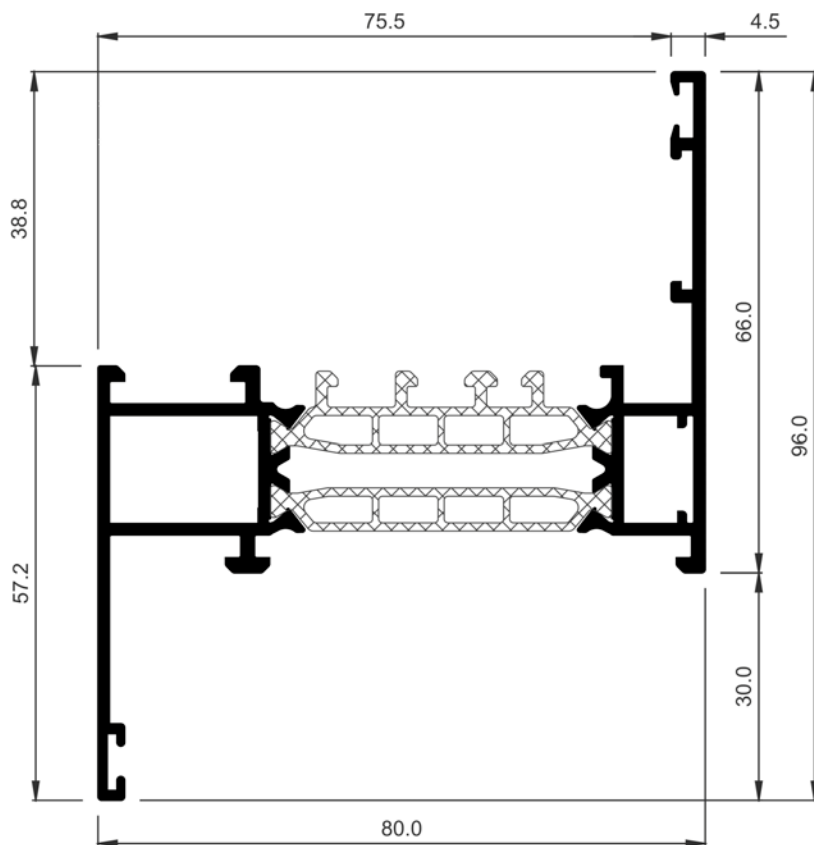

COR-7718	
Descripción Description	Marco con solape de 30 mm HO Hidden sash frame with 30 mm overlap
Peso Weight (g/m)	1815
Superficie Surface (dm ² /m)	58,48
Ix (cm⁴)	16,92
Iy (cm⁴)	49,33
Escuadra principal Main cleat	347922
Troquel Punch tool	337999
Escuadra secundaria Secondary cleat	327921
Escuadra alineamiento Alignment cleat	287310
	960023

COR 80 HOJA OCULTA
Perfiles a escala

COR 80 HIDDEN SASH
Profiles to scale

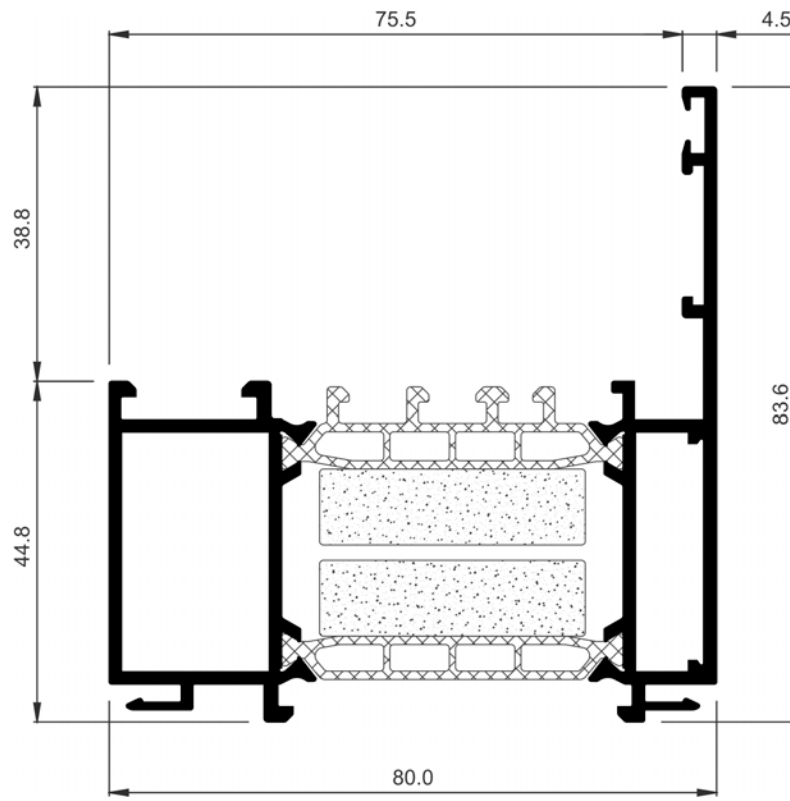

COR-7764	
Descripción Description	Marco balconera con enganches HI Balcony frame with hooks HI
Peso Weight (g/m)	2044,5
Superficie Surface (dm ² /m)	66,88
Ix (cm ⁴)	22,97
Iy (cm ⁴)	53,22
Escuadra principal Main cleat	247231
Troquel Punch tool	347799
Escuadra secundaria Secondary cleat	357924
Escuadra alineamiento Alignment cleat	287310

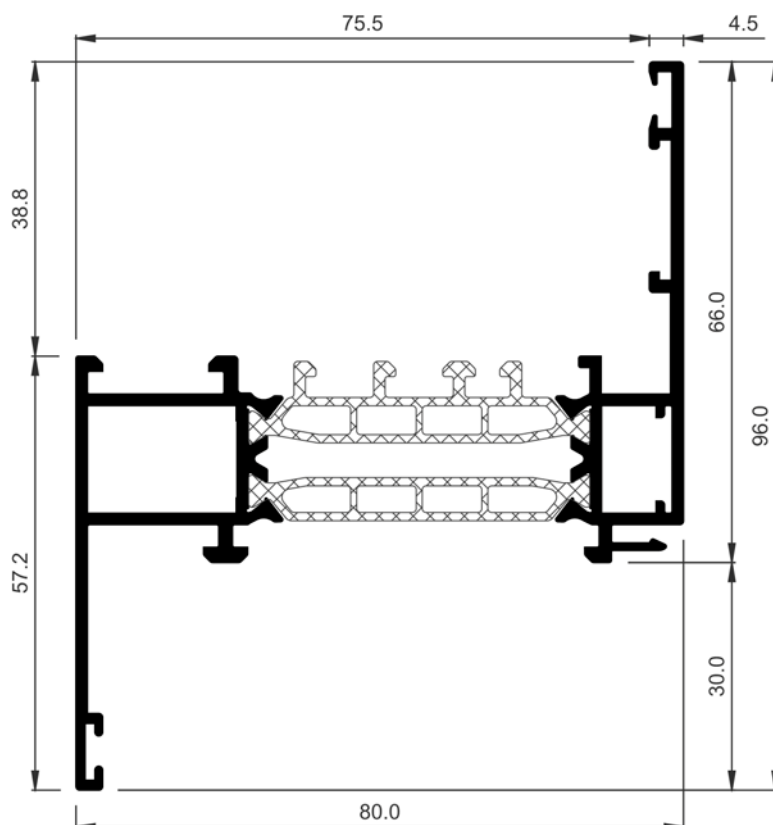

COR-7772	
Descripción Description	Marco con solape de 30 mm y enganche HO Frame with 30 mm overlap and hook Hidden Sash
Peso Weight (g/m)	1831,2
Superficie Surface (dm ² /m)	59,82
Ix (cm ⁴)	17,04
Iy (cm ⁴)	49,24
Escuadra principal Main cleat	347922
Troquel Punch tool	347799
Escuadra secundaria Secondary cleat	327921
Escuadra alineamiento Alignment cleat	287310
	960023

COR 80 HOJA OCULTA
Perfiles a escala

COR 80 HIDDEN SASH
Profiles to scale

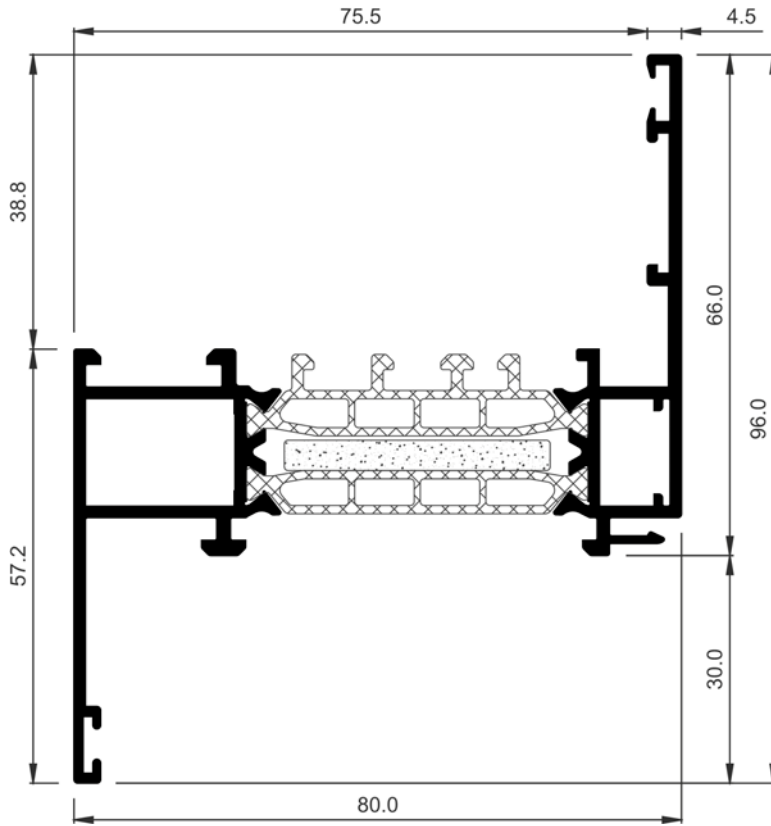

COR-7773	
Descripción Description	Marco con solape de 30 mm y enganche HO HI Frame with 30 mm overlap and hook Hidden Sash HI
Peso Weight (g/m)	1831,2
Superficie Surface (dm ² /m)	59,82
I_x (cm ⁴)	17,04
I_y (cm ⁴)	49,24
Escuadra principal Main cleat	347922
Troquel Punch tool	347799
Escuadra secundaria Secondary cleat	327921
Escuadra alineamiento Alignment cleat	287310
	960023

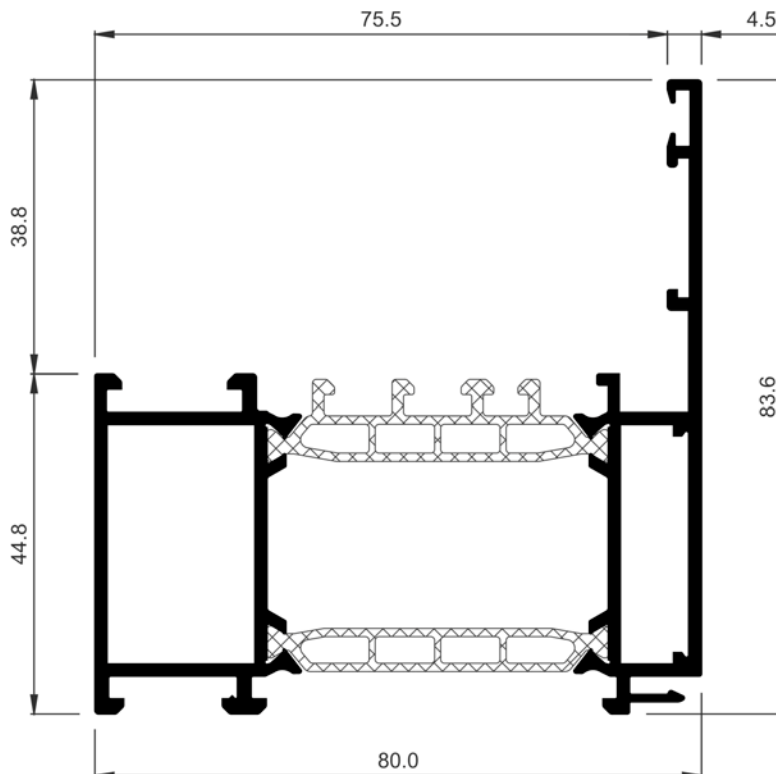

COR-7778	
Descripción Description	Marco balconera con enganche exterior HO Balcony frame with exterior hook HO
Peso Weight (g/m)	2052,6
Superficie Surface (dm ² /m)	66,48
I_x (cm ⁴)	23,28
I_y (cm ⁴)	54,24
Escuadra principal Main cleat	247231
Troquel Punch tool	347799
Escuadra secundaria Secondary cleat	357924
Escuadra alineamiento Alignment cleat	287310

COR 80 HOJA OCULTA
Perfiles a escala

COR 80 HIDDEN SASH
Profiles to scale

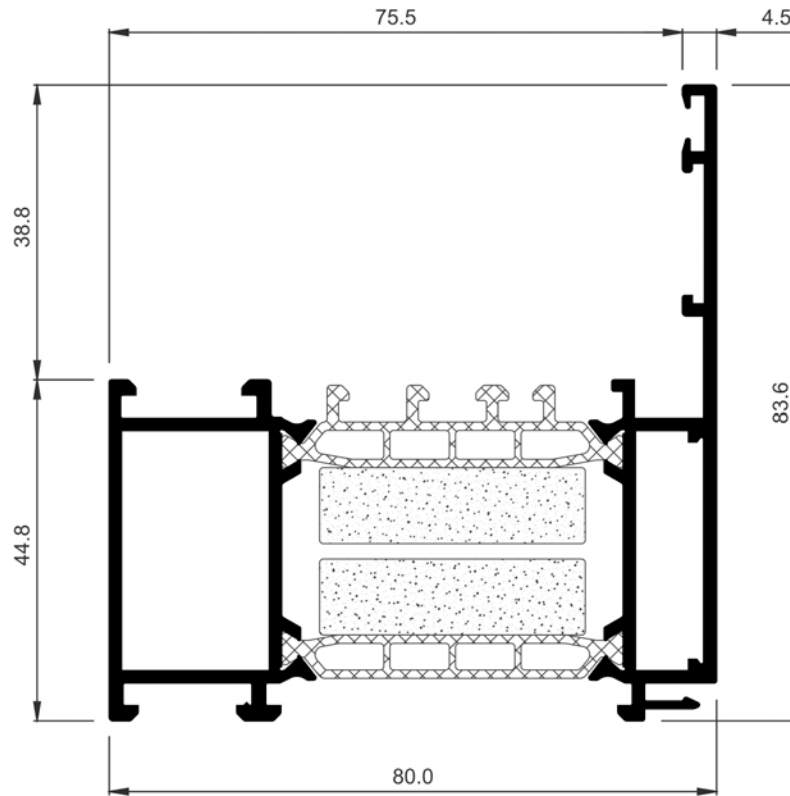

COR-7785	
Descripción Description	Marco balconera con enganche exterior HO HI Balcony frame with exterior hook HO HI
Peso Weight (g/m)	2052,6
Superficie Surface (dm ² /m)	66,48
Ix (cm⁴)	23,28
Iy (cm⁴)	54,24
Escuadra principal Main cleat	247231
Troquel Punch tool	347799
Escuadra secundaria Secondary cleat	357924
Escuadra alineamiento Alignment cleat	287310

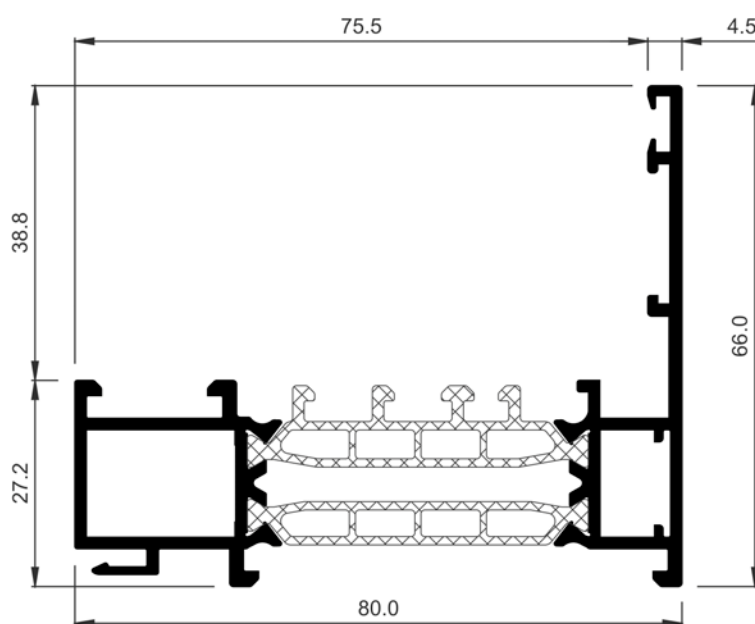

COR-7786	
Descripción Description	Marco con enganche interior HO Frame with interior attachments Hidden Sash
Peso Weight (g/m)	1680
Superficie Surface (dm ² /m)	51,8
Ix (cm⁴)	10,42
Iy (cm⁴)	39,72
Escuadra principal Main cleat	347922
Troquel Punch tool	347799
Escuadra secundaria Secondary cleat	327921
Escuadra alineamiento Alignment cleat	287310

COR 80 HOJA OCULTA
Perfiles a escala

COR 80 HIDDEN SASH
Profiles to scale

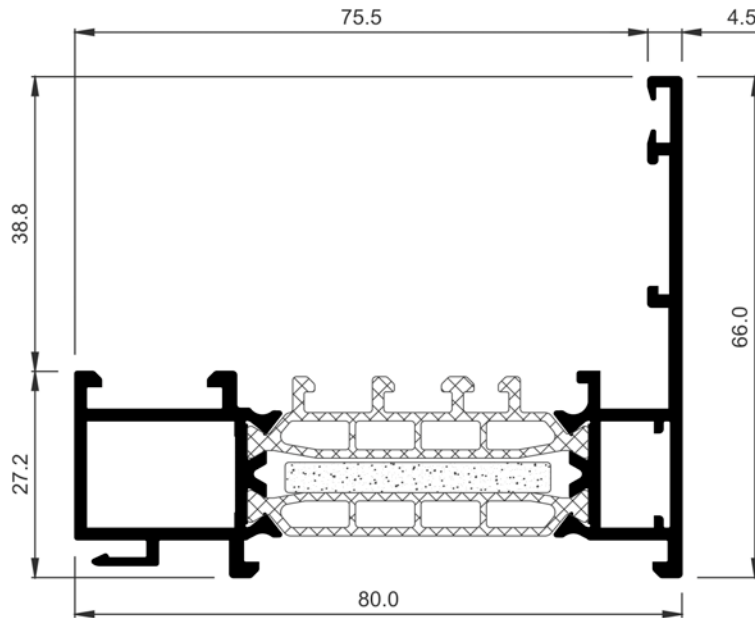

COR-7787	
Descripción Description	Marco con enganche interior HO HI Frame with interior attachments Hidden Sash HI
Peso Weight (g/m)	1680
Superficie Surface (dm ² /m)	51,8
Ix (cm⁴)	10,42
Iy (cm⁴)	39,72
Escuadra principal Main cleat	347922
Troquel Punch tool	347799
Escuadra secundaria Secondary cleat	327921
Escuadra alineamiento Alignment cleat	287310

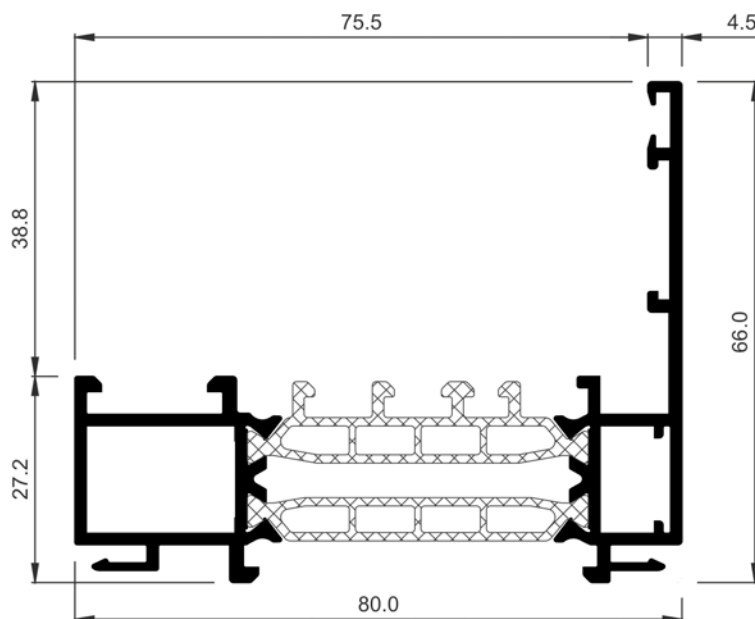

COR-7788	
Descripción Description	Marco con doble enganche HO Frame with double attachments Hidden Sash
Peso Weight (g/m)	1696,2
Superficie Surface (dm ² /m)	53,14
Ix (cm⁴)	10,62
Iy (cm⁴)	39,56
Escuadra principal Main cleat	347922
Troquel Punch tool	347799
Escuadra secundaria Secondary cleat	327921
Escuadra alineamiento Alignment cleat	287310

COR 80 HOJA OCULTA
Perfiles a escala

COR 80 HIDDEN SASH
Profiles to scale

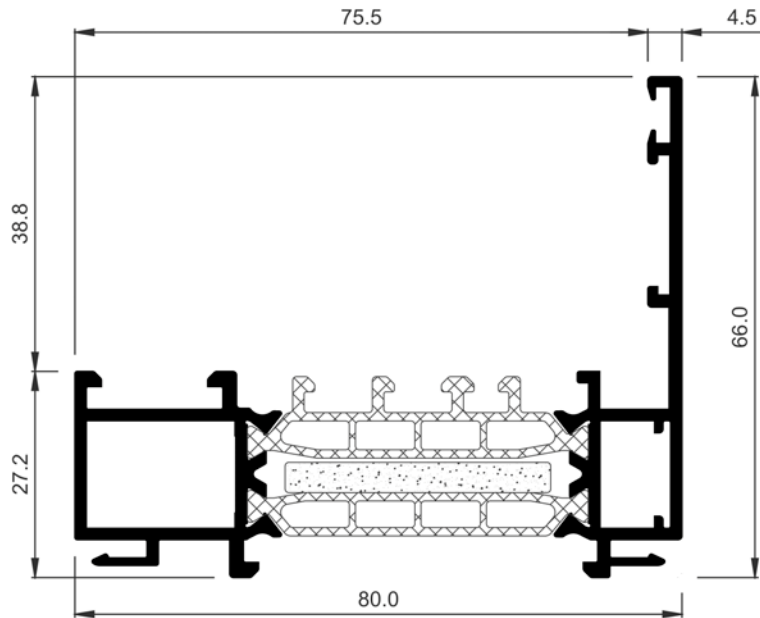

COR-7789	
Descripción Description	Marco con doble enganche HO HI Frame with double attachments Hidden Sash HI
Peso Weight (g/m)	1696,2
Superficie Surface (dm ² /m)	53,14
Ix (cm⁴)	10,62
Iy (cm⁴)	39,56
Escuadra principal Main cleat	347922
Troquel Punch tool	347799
Escuadra secundaria Secondary cleat	327921
Escuadra alineamiento Alignment cleat	287310

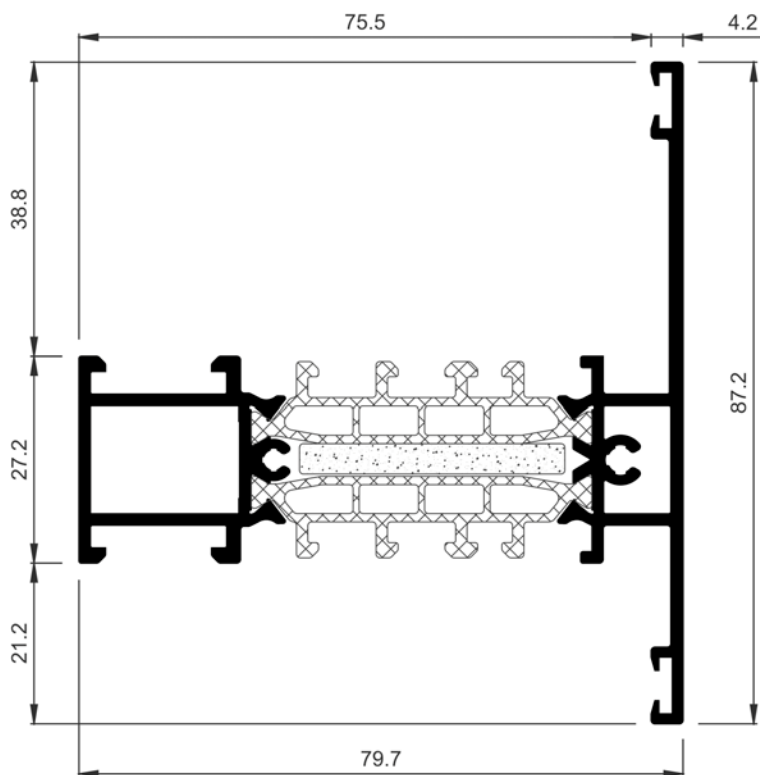

COR-7712	
Descripción Description	Travesaño hoja-fijo HO HI Fixed-sash transom Hidden Sash HI
Peso Weight (g/m)	1844,7
Superficie Surface (dm ² /m)	58,99
Ix (cm⁴)	14,15
Iy (cm⁴)	44,42
Fresa Miller	327991
	347791
	347991
Troquel Punch tool	337999
Tope travesaño interior Internal transom stop	920140
Tope travesaño exterior External transom stop	327971

COR 80 HOJA OCULTA
Perfiles a escala

COR 80 HIDDEN SASH
Profiles to scale

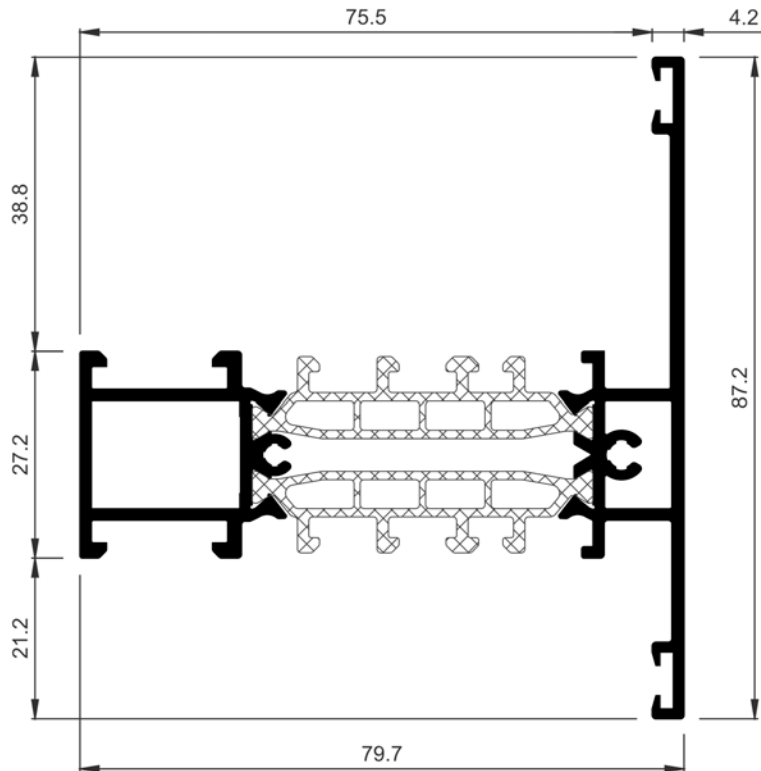

COR-7719	
Descripción Description	Travesaño hoja-fijo HO Fixed-sash transom Hidden Sash
Peso Weight (g/m)	1844,7
Superficie Surface (dm ² /m)	58,99
Ix (cm⁴)	14,15
Iy (cm⁴)	44,42
Fresa Miller	327991 347791 347991
Troquel Punch tool	337999
Tope travesaño interior Internal transom stop	920140
Tope travesaño exterior External transom stop	327971

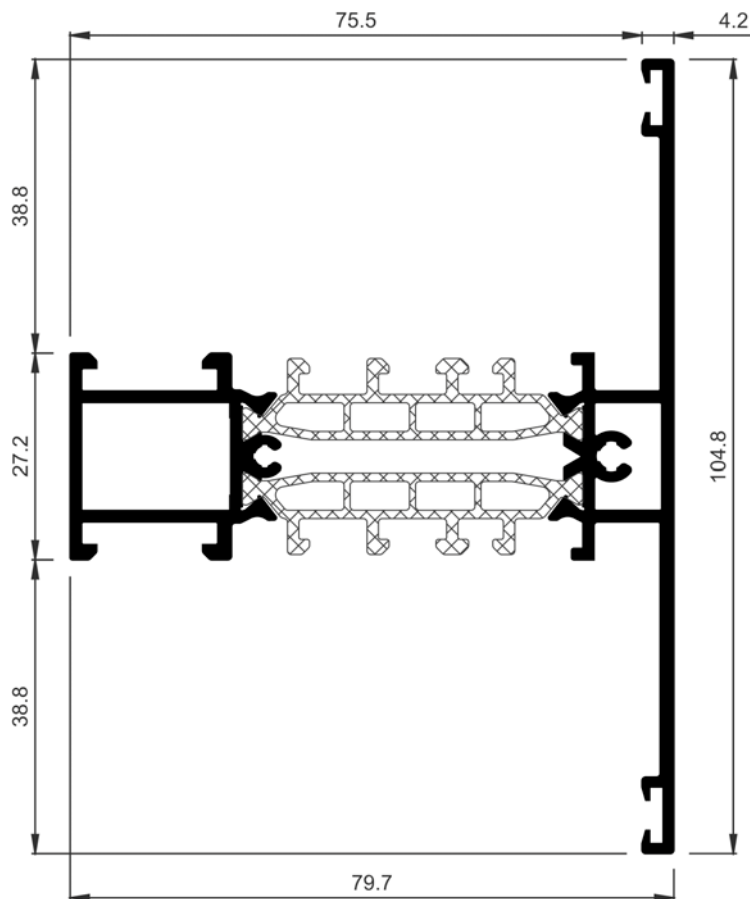

COR-7779	
Descripción Description	Travesaño simétrico HO Hidden Sash symmetrical transom
Peso Weight (g/m)	1941,9
Superficie Surface (dm ² /m)	62,45
Ix (cm⁴)	21,64
Iy (cm⁴)	47,17
Fresa Miller	327991 347791 347792
Troquel Punch tool	337999
Tope travesaño interior Internal transom stop	920140
Tope travesaño exterior External transom stop	327971

COR 80 HOJA OCULTA
Perfiles a escala

COR 80 HIDDEN SASH
Profiles to scale

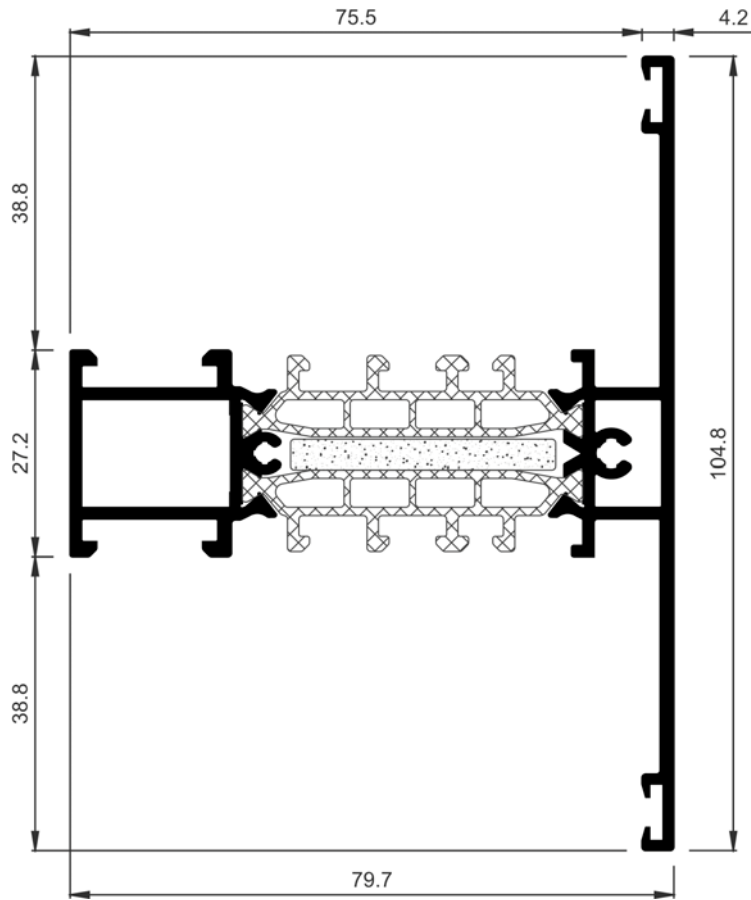

COR-7782	
Descripción Description	Travesaño simétrico HO HI HI Hidden Sash symmetrical transom
Peso Weight (g/m)	1941,9
Superficie Surface (dm ² /m)	62,45
Ix (cm⁴)	21,64
Iy (cm⁴)	47,17
Fresa Miller	327991
	347791
	347991
Troquel Punch tool	337999
Tope travesaño interior Internal transom stop	920140
Tope travesaño exterior External transom stop	327971

COR 80 HOJA OCULTA
Perfiles a escala

COR 80 HIDDEN SASH
Profiles to scale

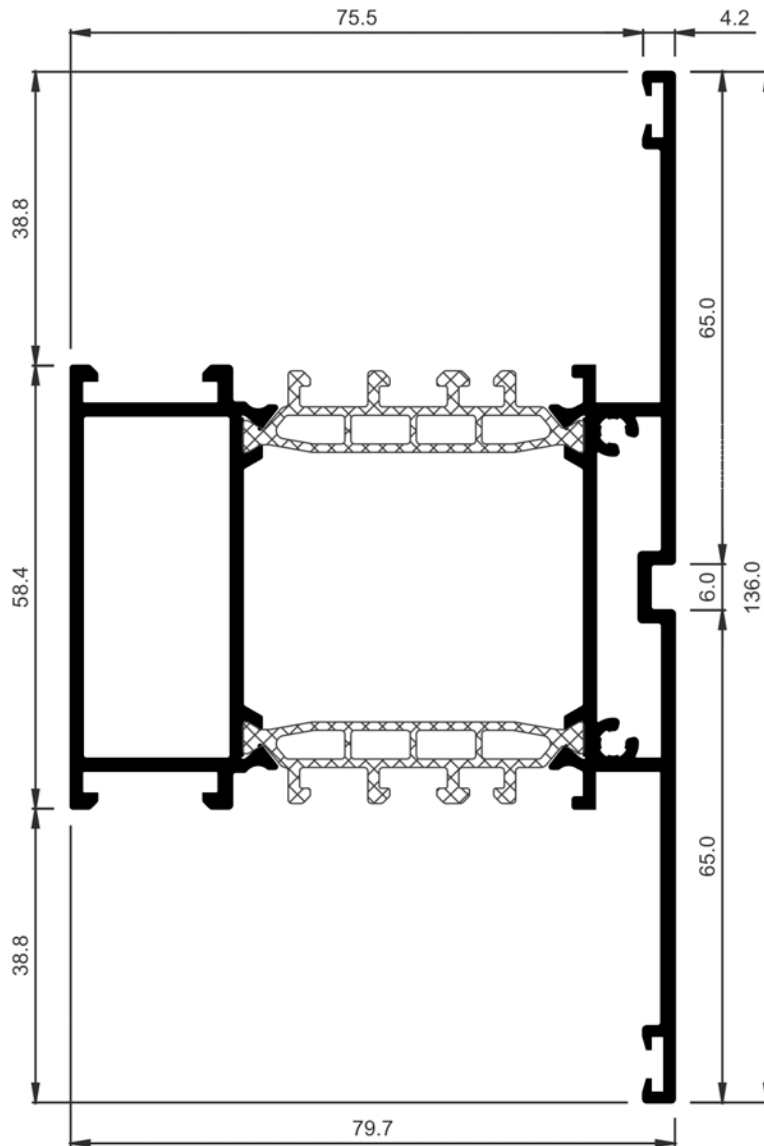

COR-7783	
Descripción Description	Travesaño de doble apertura HO Hidden Sash double opening transom
Peso Weight (g/m)	2535,9
Superficie Surface (dm ² /m)	87,41
Ix (cm⁴)	59,56
Iy (cm⁴)	71,12
Fresa Miller	327991 347791 347991
Troquel Punch tool	337999
Tope travesaño interior Internal transom stop	367983
Tope travesaño exterior External transom stop	327971

COR 80 HOJA OCULTA
Perfiles a escala

COR 80 HIDDEN SASH
Profiles to scale

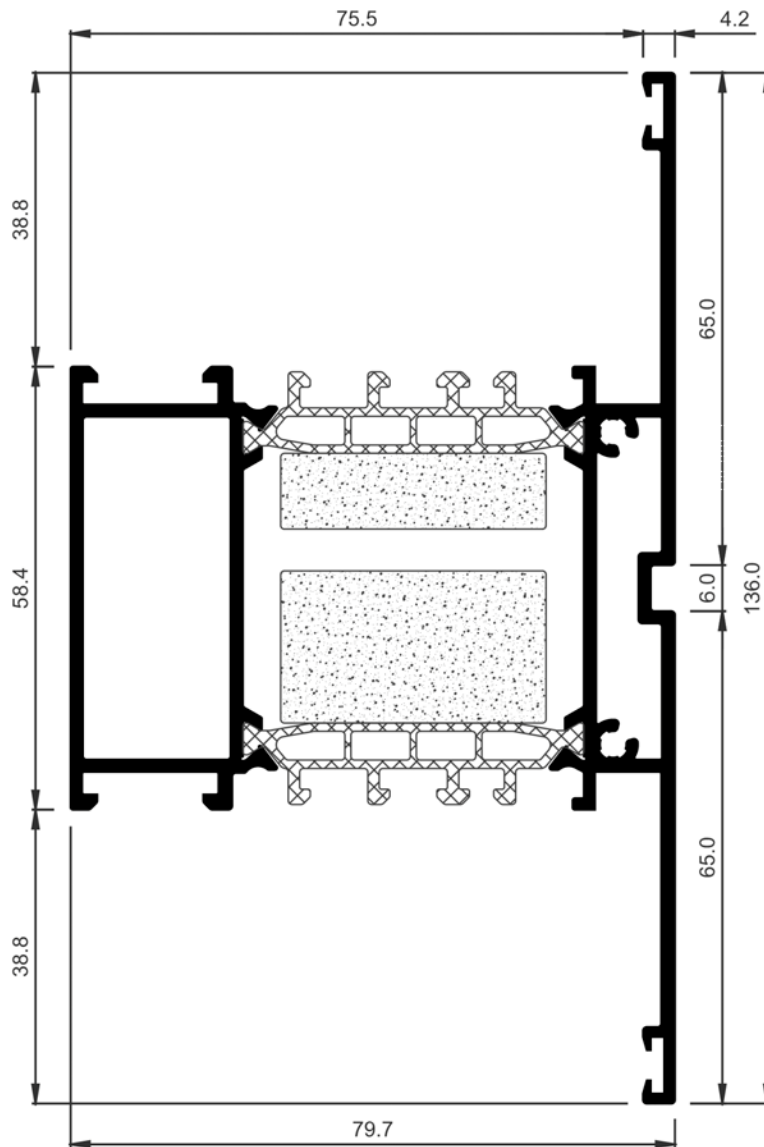

COR-7784	
Descripción Description	Travesaño de doble apertura HO HI HI Hidden Sash double opening transom
Peso Weight (g/m)	2535,9
Superficie Surface (dm ² /m)	87,41
Ix (cm⁴)	59,56
Iy (cm⁴)	71,12
Fresa Miller	327991 347791 347991
Troquel Punch tool	337999
Tope travesaño interior Internal transom stop	367983
Tope travesaño exterior External transom stop	327971

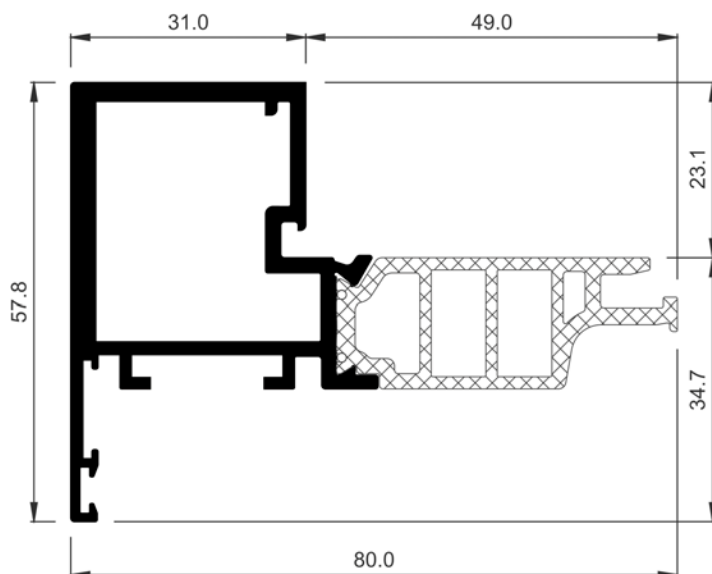

COR-7704	
Descripción Description	Hoja de ventana vidrio pegado Glued glass window sash
Peso Weight (g/m)	1742,1
Superficie Surface (dm ² /m)	40,1
Ix (cm⁴)	10,01
Iy (cm⁴)	7,67
Escuadra principal Main cleat	227042
Troquel Punch tool	337999
Escuadra secundaria Secondary cleat	327921
Escuadra alineamiento Alignment cleat	217003

COR 80 HOJA OCULTA
Perfiles a escala

COR 80 HIDDEN SASH
Profiles to scale

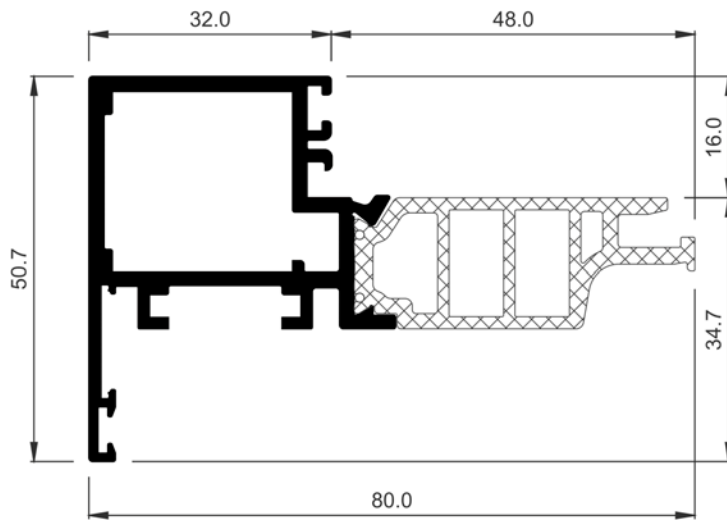

COR-7705	
Descripción Description	Hoja de ventana de 48 mm 48 mm window sash
Peso Weight (g/m)	1553,1
Superficie Surface (dm ² /m)	38,91
Ix (cm⁴)	6,03
Iy (cm⁴)	6,41
Escuadra principal Main cleat	248221
Troquel Punch tool	337999
Escuadra secundaria Secondary cleat	327921
Escuadra alineamiento Alignment cleat	920135

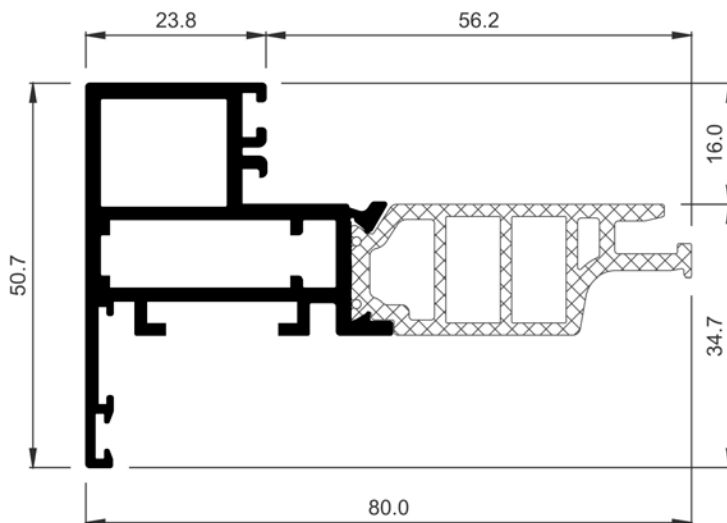

COR-7706	
Descripción Description	Hoja de ventana de 56 mm 56 mm window sash
Peso Weight (g/m)	1601,7
Superficie Surface (dm ² /m)	41,96
Ix (cm⁴)	5,43
Iy (cm⁴)	5,82
Escuadra principal Main cleat	248220
Troquel Punch tool	347799
Escuadra secundaria Secondary cleat	327921
Escuadra alineamiento Alignment cleat	217003

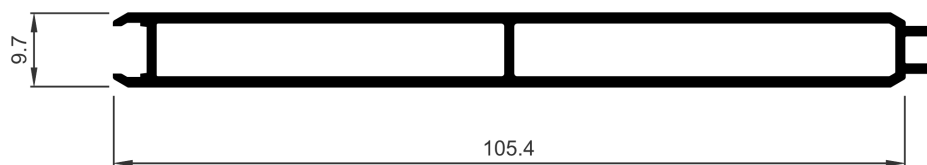

COR-2366	
Descripción Description	Lama contra de ventana Window louvre
Peso Weight (g/m)	796,5
Superficie Surface (dm ² /m)	47,49
Ix (cm⁴)	0,48
Iy (cm⁴)	30,48

COR 80 HOJA OCULTA
Perfiles a escala

COR 80 HIDDEN SASH
Profiles to scale

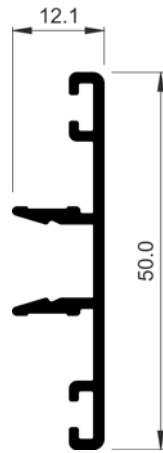

COR-8055	
Descripción Description	Tapeta divisor de hoja HO Cover sash divider HS
Peso Weight (g/m)	345,6
Superficie Surface (dm ² /m)	17,85
Ix (cm⁴)	2,55
Iy (cm⁴)	0,11
Tapas Covers	397950

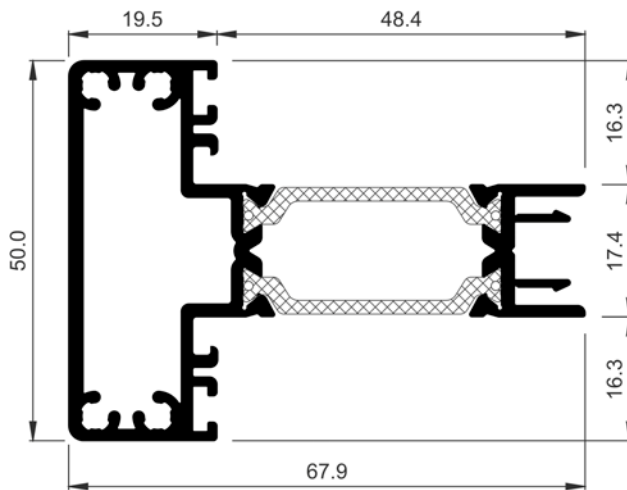

COR-8062	
Descripción Description	Divisor de hoja HO Sash divider HS
Peso Weight (g/m)	1736,7
Superficie Surface (dm ² /m)	52,42
Ix (cm⁴)	9,05
Iy (cm⁴)	19,62
Fresa Miller	397990
Observaciones Observations	Válido sólo para hoja COR-7705 Valid only for sash COR-7705

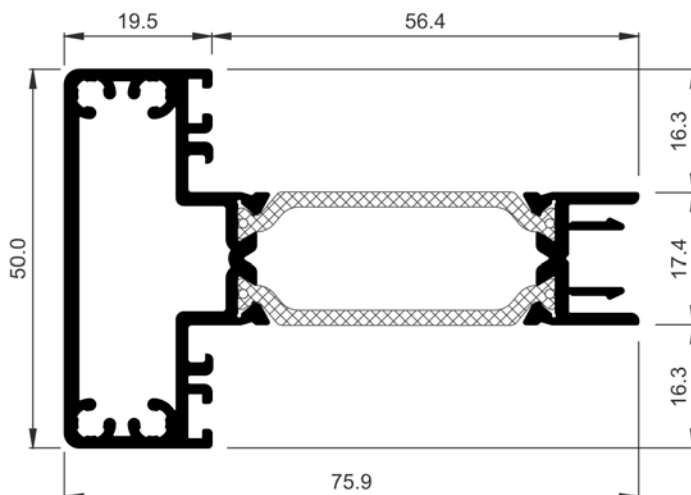

COR-8063	
Descripción Description	Divisor de hoja HO Sash divider HS
Peso Weight (g/m)	1736,7
Superficie Surface (dm ² /m)	52,42
Ix (cm⁴)	9,05
Iy (cm⁴)	25,9
Fresa Miller	397990
Observaciones Observations	Válido sólo para hoja COR-7706 Valid only for sash COR-7706

COR 80 HOJA OCULTA
Perfiles a escala

COR 80 HIDDEN SASH
Profiles to scale

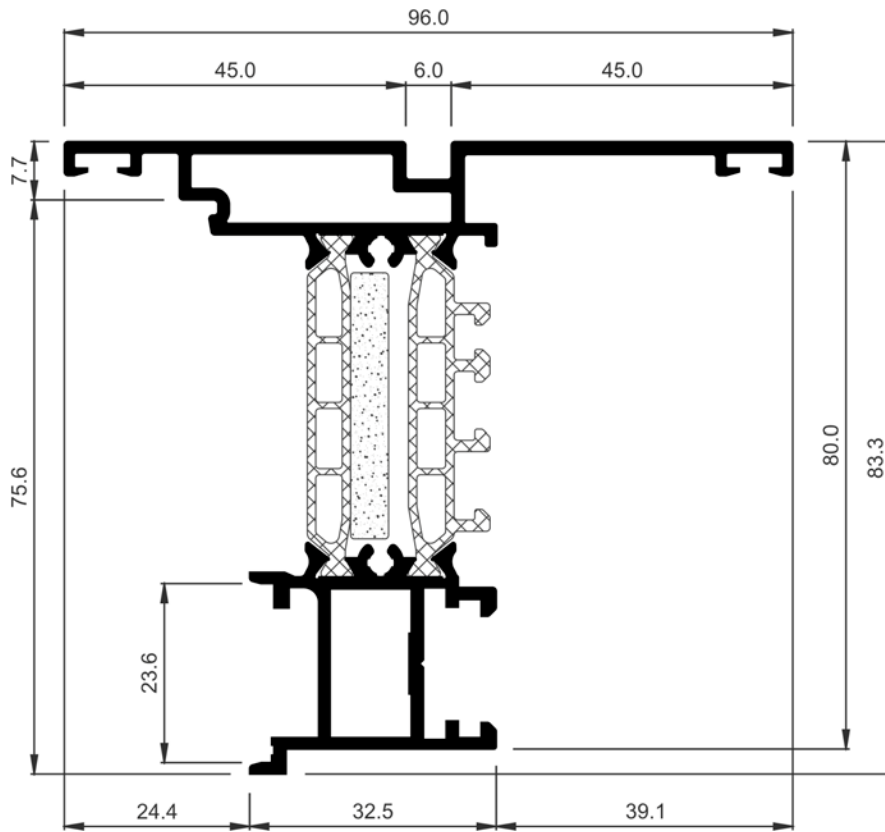

COR-7709

Descripción Description	Inversor HO HI Inverter Hidden Sash HI
Peso Weight (g/m)	2033,7
Superficie Surface (dm ² /m)	67,16
Ix (cm ⁴)	51,69
Iy (cm ⁴)	20,09
Fresa Miller	347907
Tapas Covers	377709
Tornillería Screws	813922

COR 80 HOJA OCULTA
Perfiles a escala

COR 80 HIDDEN SASH
Profiles to scale

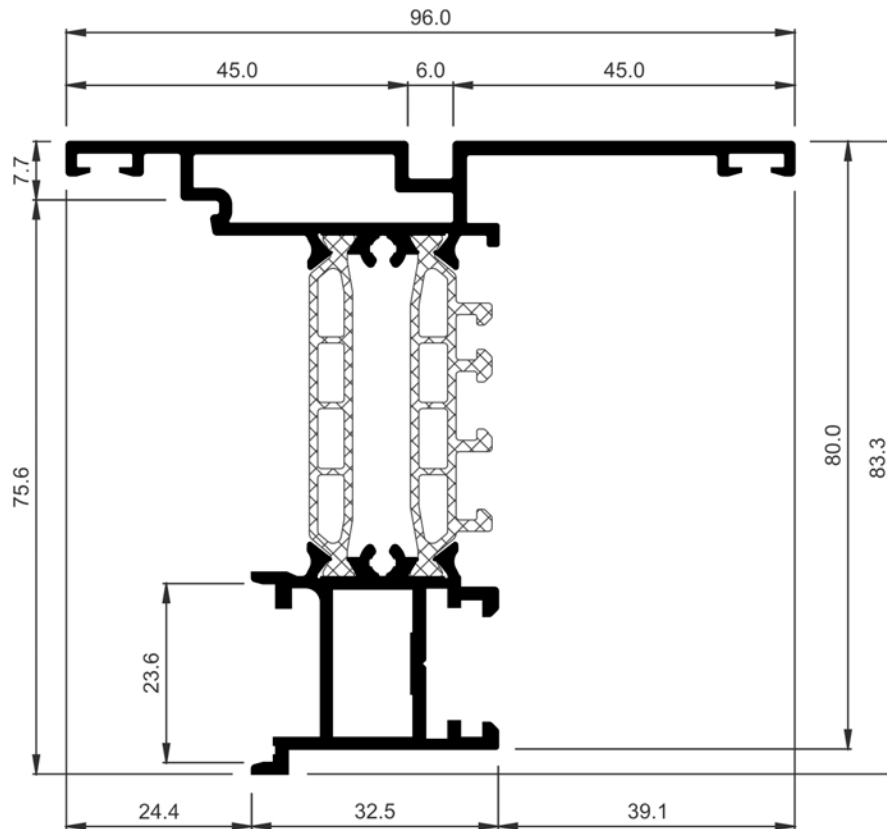

COR-7716

Descripción Description	Inversor HO Inverter Hidden Sash
Peso Weight (g/m)	2033,7
Superficie Surface (dm ² /m)	67,16
Ix (cm ⁴)	51,69
Iy (cm ⁴)	20,09
Fresa Miller	347907
Tapas Covers	377709
Tornillería Screws	813922

COR 80 HOJA OCULTA
Perfiles a escala

COR 80 HIDDEN SASH
Profiles to scale

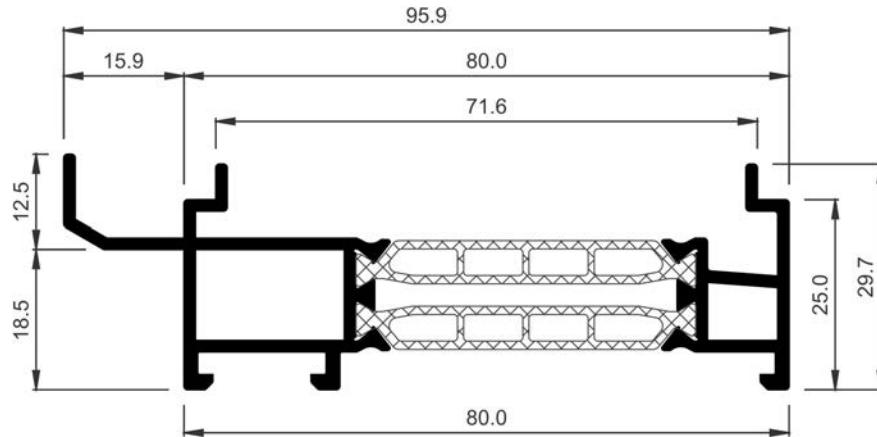

COR-7760	
Descripción Description	Condensación Condensation
Peso Weight (g/m)	1504,5
Superficie Surface (dm ² /m)	43,39
Ix (cm ⁴)	2,01
Iy (cm ⁴)	37,45
Tapas Covers	257200

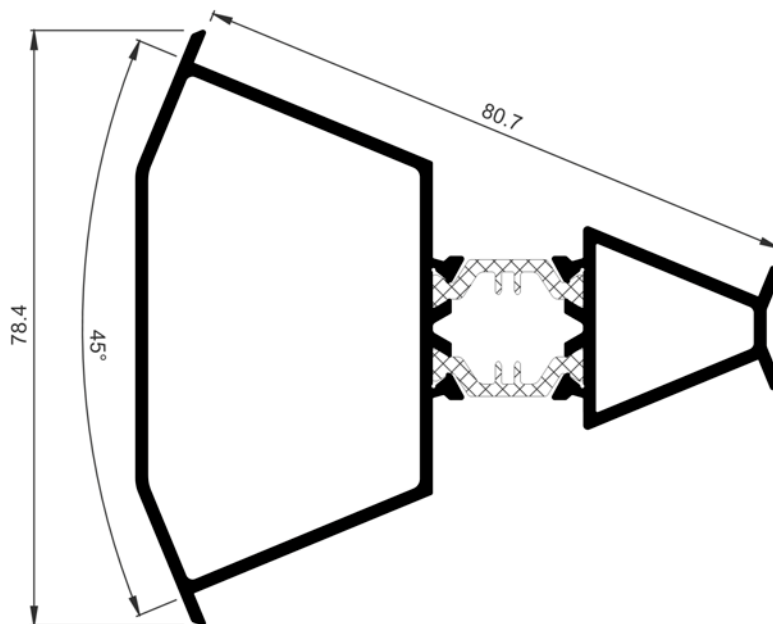

COR-3881	
Descripción Description	Esquinero fijo 135° 135° Corner
Peso Weight (g/m)	1471,7
Superficie Surface (dm ² /m)	61,69
Ix (cm ⁴)	16,26
Iy (cm ⁴)	33,73

COR 80 HOJA OCULTA
Perfiles a escala

COR 80 HIDDEN SASH
Profiles to scale

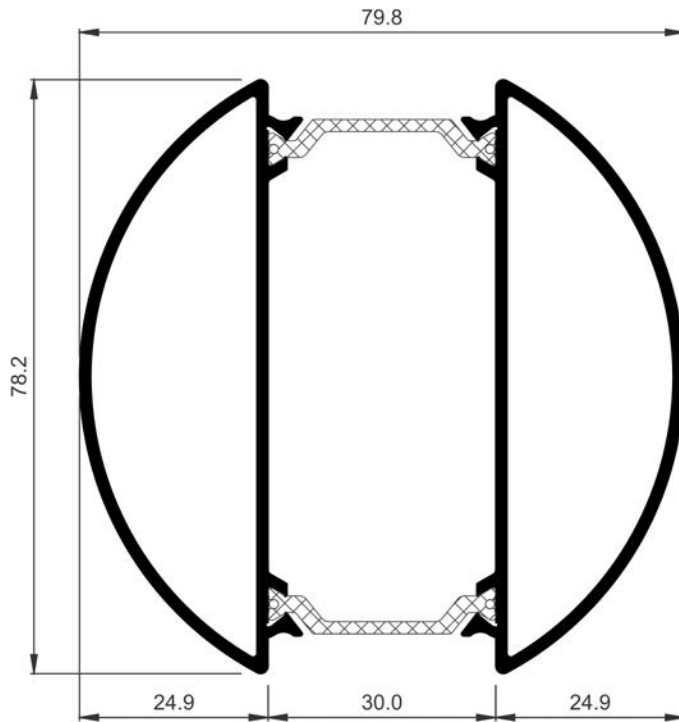

COR-7780	
Descripción Description	Esquinero regulable Adjustable corner attachment
Peso Weight (g/m)	1786,6
Superficie Surface (dm ² /m)	74,14
Ix (cm⁴)	32,41
Iy (cm⁴)	35,27

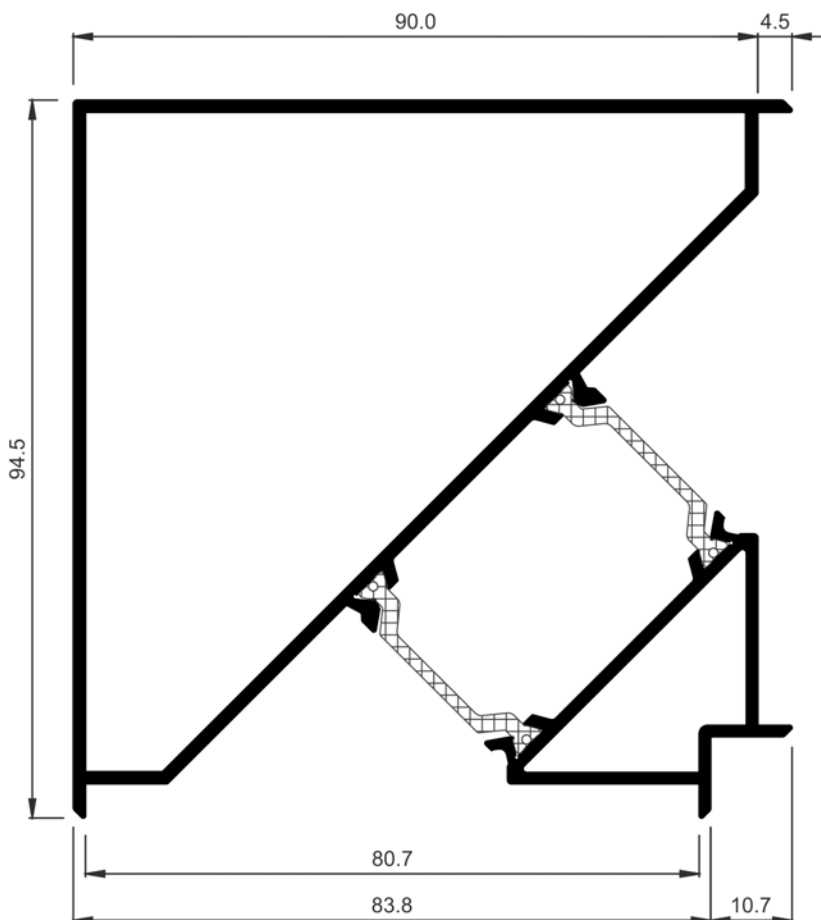

COR-7781	
Descripción Description	Esquinero recto Straight corner
Peso Weight (g/m)	2253,7
Superficie Surface (dm ² /m)	93,01
Ix (cm⁴)	78,33
Iy (cm⁴)	78,33

COR 80 HOJA OCULTA
Perfiles a escala

COR 80 HIDDEN SASH
Profiles to scale

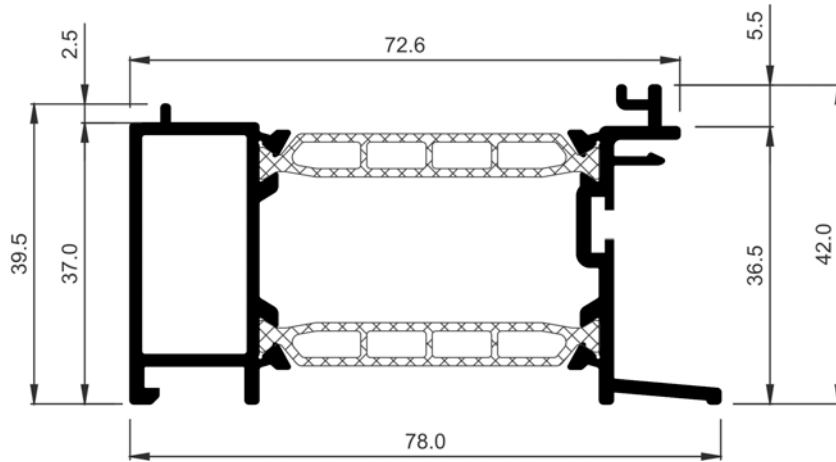

COR-7767	
Descripción Description	Suplemento drenaje oculto Concealed drainage subcill
Peso Weight (g/m)	1581,9
Superficie Surface (dm ² /m)	44,23
Ix (cm⁴)	5,98
Iy (cm⁴)	27,41

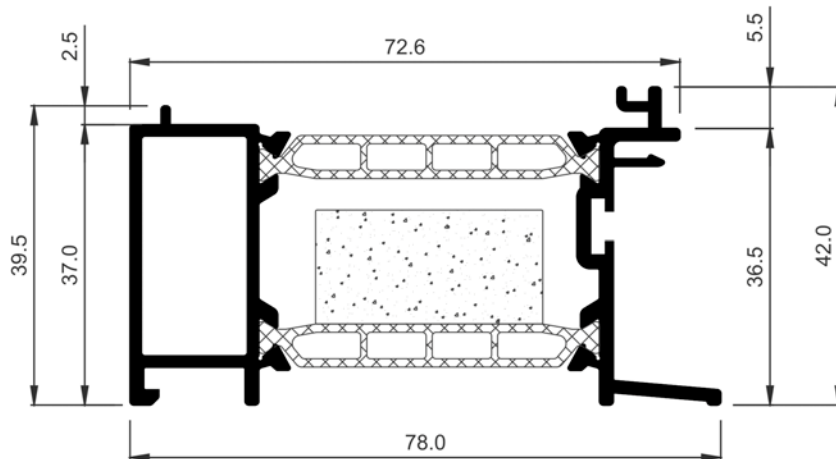

COR-7768	
Descripción Description	Suplemento drenaje oculto HI Concealed drainage subcill HI
Peso Weight (g/m)	1581,9
Superficie Surface (dm ² /m)	44,23
Ix (cm⁴)	5,98
Iy (cm⁴)	27,41

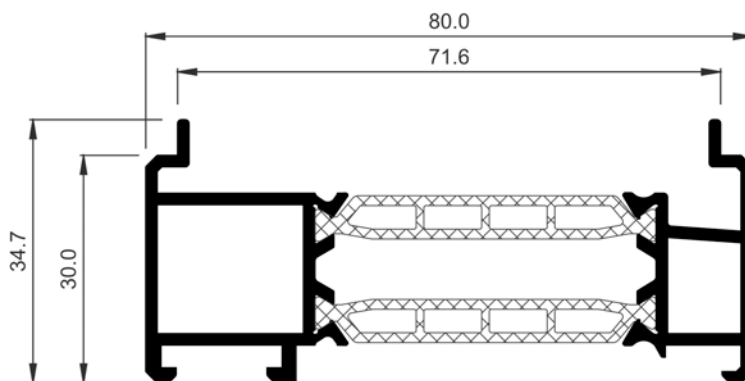

COR-7797	
Descripción Description	Suplemento marco 30 mm Frame supplement 30 mm
Peso Weight (g/m)	1485,6
Superficie Surface (dm ² /m)	43,3
Ix (cm⁴)	2,74
Iy (cm⁴)	32,39

COR 80 HOJA OCULTA
Perfiles a escala

COR 80 HIDDEN SASH
Profiles to scale

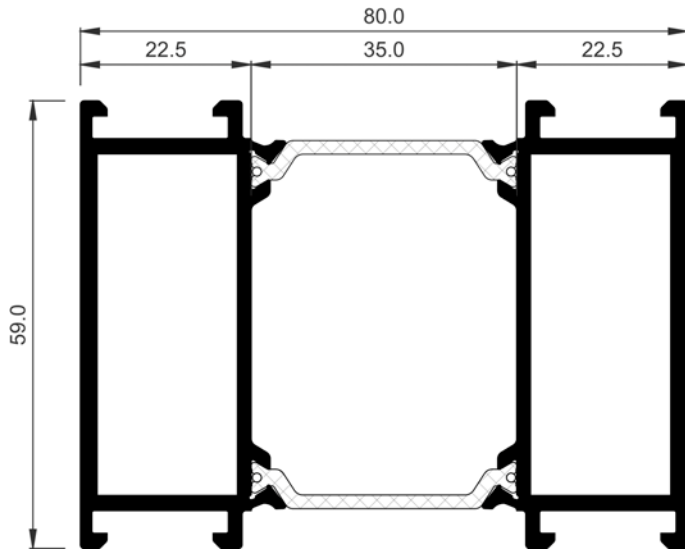

COR-7790	
Descripción Description	Suplemento marco Frame supplement
Peso Weight (g/m)	2121,4
Superficie Surface (dm ² /m)	70,38
Ix (cm ⁴)	25,2
Iy (cm ⁴)	60,9

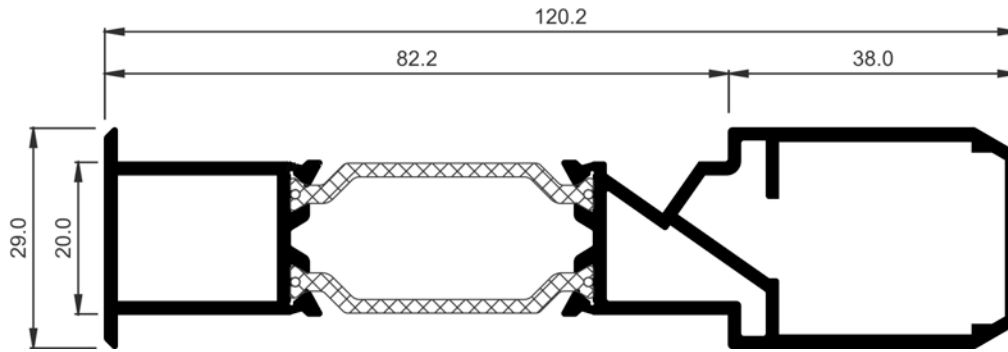

COR-7744	
Descripción Description	Unión de marcos con refuerzo Frame joint profile with reinforcement
Peso Weight (g/m)	1728,9
Superficie Surface (dm ² /m)	62,83
Ix (cm ⁴)	4,53
Iy (cm ⁴)	78,21
Tapas Covers	257201

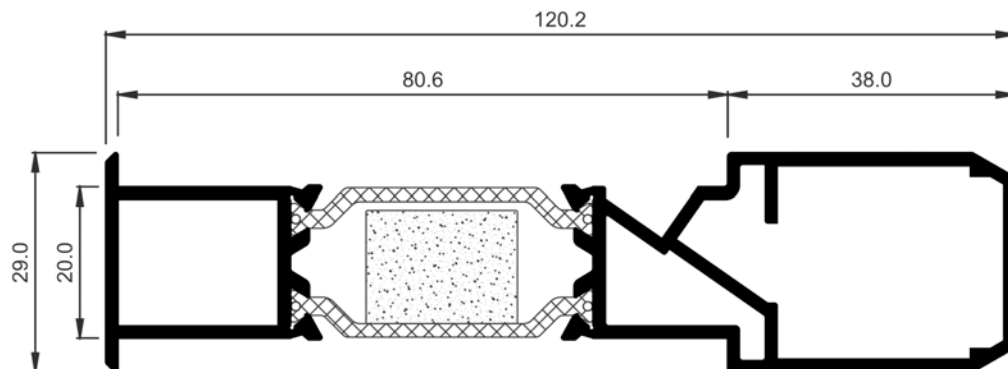

COR-7745	
Descripción Description	Unión de marcos con refuerzo HI Frame joint profile with reinforcement HI
Peso Weight (g/m)	1728,9
Superficie Surface (dm ² /m)	62,83
Ix (cm ⁴)	4,53
Iy (cm ⁴)	78,21
Tapas Covers	257201

COR 80 HOJA OCULTA
Perfiles a escala

COR 80 HIDDEN SASH
Profiles to scale

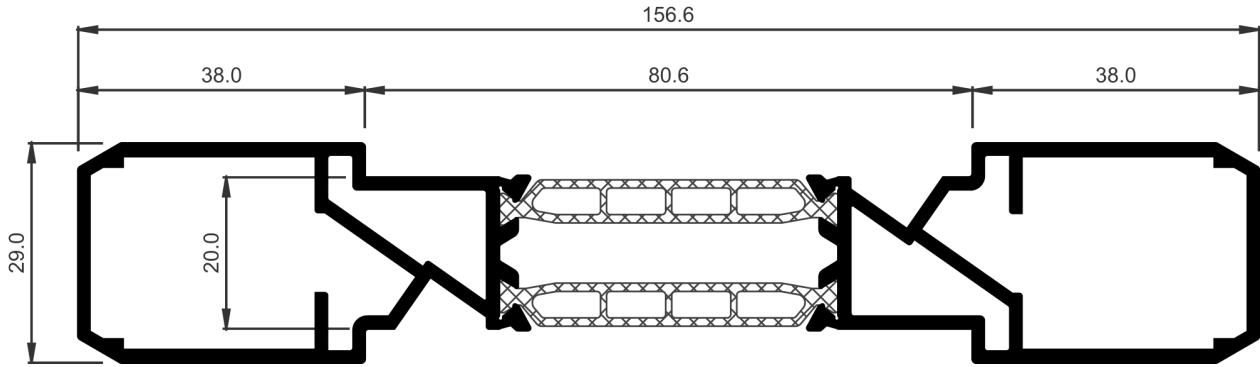

COR-7746	
Descripción Description	Unión de marcos con doble refuerzo Frame joint profile with double reinforcement
Peso Weight (g/m)	2414,4
Superficie Surface (dm²/m)	83,16
Ix (cm⁴)	6,84
Iy (cm⁴)	172,81
Tapas Covers	257201

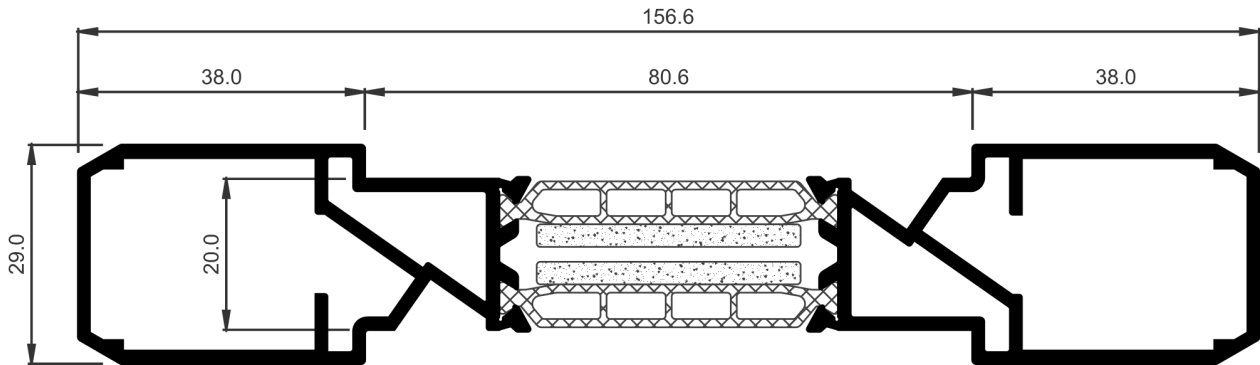

COR-7747	
Descripción Description	Unión de marcos con doble refuerzo HI Frame joint profile with double reinforcement HI
Peso Weight (g/m)	2414,4
Superficie Surface (dm²/m)	83,16
Ix (cm⁴)	6,84
Iy (cm⁴)	172,81
Tapas Covers	257201

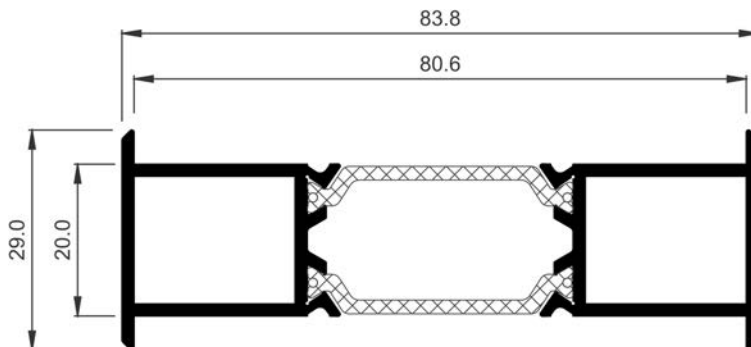

COR-7754	
Descripción Description	Unión de marcos Frame joint profile
Peso Weight (g/m)	1203,4
Superficie Surface (dm²/m)	42,5
Ix (cm⁴)	2,22
Iy (cm⁴)	31,11

COR 80 HOJA OCULTA
Perfiles a escala

COR 80 HIDDEN SASH
Profiles to scale

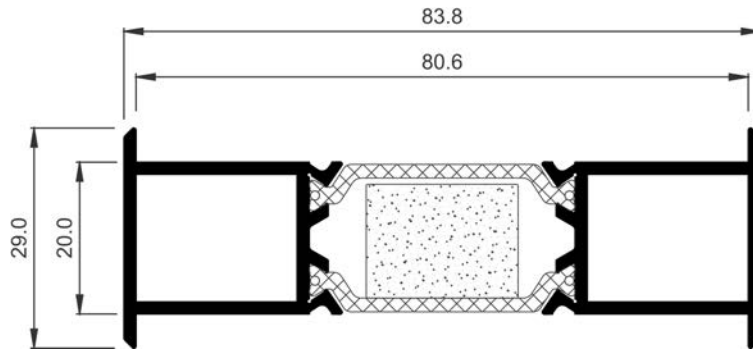

COR-7755	
Descripción Description	Unión de marcos HI HI frame joint profile
Peso Weight (g/m)	1203,4
Superficie Surface (dm ² /m)	42,5
Ix (cm⁴)	2,22
Iy (cm⁴)	31,11

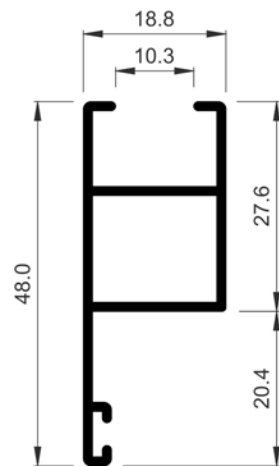

770226	
Descripción Description	Hoja de contra recta Straight shutter sash
Peso Weight (g/m)	399,6
Superficie Surface (dm ² /m)	24,06
Ix (cm⁴)	2,5
Iy (cm⁴)	0,81
Escuadra principal Main cleat	920425
Troquel Punch tool	337999

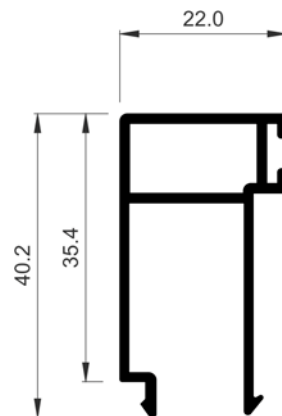

COR-7011	
Descripción Description	Junquillo recto clip para fijos - HO Straight beading clip for fixed-Hidden Sash
Peso Weight (g/m)	429,3
Superficie Surface (dm ² /m)	25,09
Ix (cm⁴)	2,41
Iy (cm⁴)	0,95

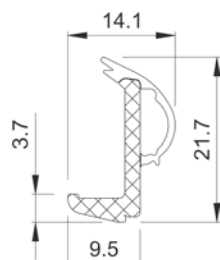

COR-7088	
Descripción Description	Junquillo exterior HO (PVC) Hidden sash outside beading (PVC)

COR 80 HOJA OCULTA
Perfiles a escala

COR 80 HIDDEN SASH
Profiles to scale

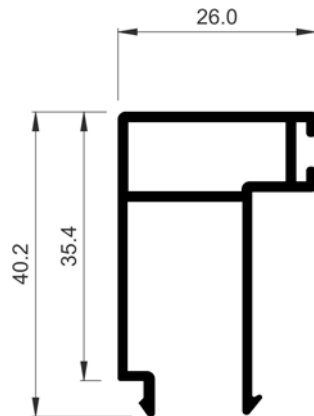

COR-7090	
Descripción Description	Junquillo para fijos - HO Beading for fixed part - Hidden Sash
Peso Weight (g/m)	459
Superficie Surface (dm ² /m)	26,71
Ix (cm⁴)	2,54
Iy (cm⁴)	1,26

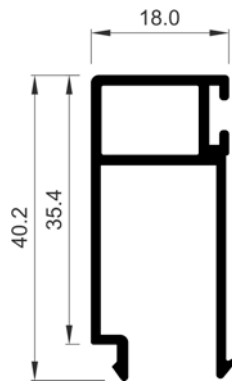

COR-7098	
Descripción Description	Junquillo de 18 mm para fijos - HO 18 mm beading for fixed part - Hidden Sash
Peso Weight (g/m)	410,4
Superficie Surface (dm ² /m)	23,51
Ix (cm⁴)	2,29
Iy (cm⁴)	0,75

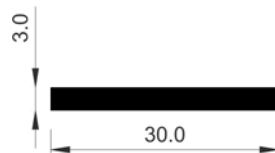

603003	
Descripción Description	Pletina de 30x3 mm Plate 30x3mm
Peso Weight (g/m)	243
Superficie Surface (dm ² /m)	6,6
Ix (cm⁴)	0,01
Iy (cm⁴)	0,68

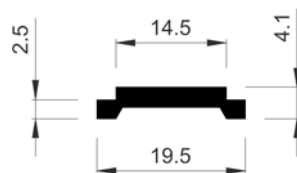

COR-2030	
Descripción Description	Pletina falleba aluminio Aluminium espagnolette
Peso Weight (g/m)	143,1
Superficie Surface (dm ² /m)	5
Ix (cm⁴)	0,01
Iy (cm⁴)	0,16

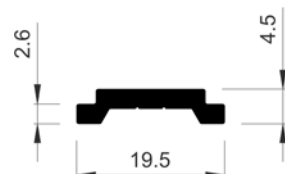

COR-2130	
Descripción Description	Pletina falleba poliamida Polyamide espagnolette

COR 80 HOJA OCULTA
Perfiles a escala

COR 80 HIDDEN SASH
Profiles to scale

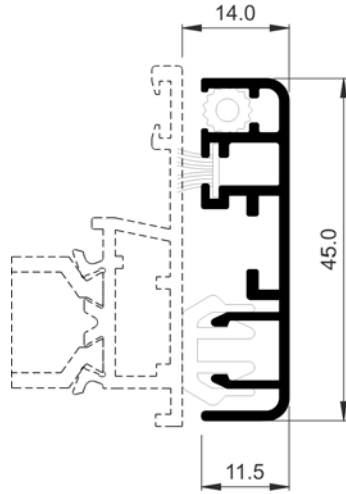

COR-2170	
Descripción Description	Mosquitera fija Fixed insect screen
Peso Weight (g/m)	405
Superficie Surface (dm ² /m)	24,41
Ix (cm⁴)	3,02
Iy (cm⁴)	0,19
Varios Various	272170
Juntas Gaskets	272100 950040
Escuadra alineamiento Alignment cleat	245054
Observaciones Observations	Telas mosquitera 272125/26/27/28 Mosquito net 272125/26/27/28

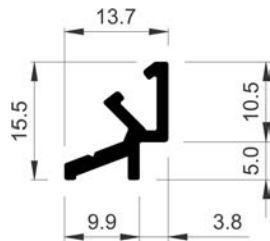

COR-2714	
Descripción Description	Acople esquinero regulable Adjustable corner attachment
Peso Weight (g/m)	162
Superficie Surface (dm ² /m)	7,34
Ix (cm⁴)	0,1
Iy (cm⁴)	0,08
Observaciones Observations	Tornillo Ø3.5 mm DIN7504N Ø3.5 mm DIN7504N screw

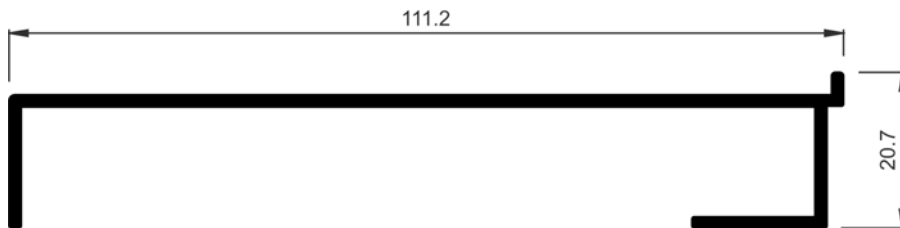

COR-2778	
Descripción Description	Peana de 110 mm 110 mm stand
Peso Weight (g/m)	696,6
Superficie Surface (dm ² /m)	32,73
Ix (cm⁴)	0,89
Iy (cm⁴)	38,59

COR 80 HOJA OCULTA
Perfiles a escala

COR 80 HIDDEN SASH
Profiles to scale

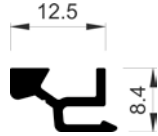

COR-2843	
Descripción Description	Grapa para enganche postizo Clip for coupling for hook
Peso Weight (g/m)	116,1
Superficie Surface (dm ² /m)	6,17
Ix (cm⁴)	0,02
Iy (cm⁴)	0,07
Tornillería Screws	822919

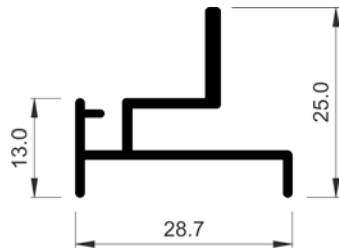

COR-2890	
Descripción Description	Complemento tapa registro (para panel) Register cover complement (for pannel)
Peso Weight (g/m)	280,8
Superficie Surface (dm ² /m)	15,65
Ix (cm⁴)	0,37
Iy (cm⁴)	0,73
Juntas Gaskets	262810
Tornillería Screws	853913

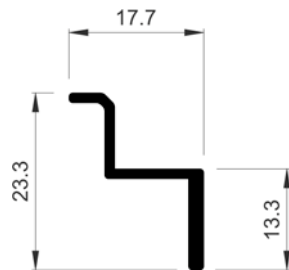

COR-2891	
Descripción Description	Asiento tapa registro Register cover seat
Peso Weight (g/m)	159,3
Superficie Surface (dm ² /m)	7,92
Ix (cm⁴)	0,23
Iy (cm⁴)	0,19
Juntas Gaskets	262810

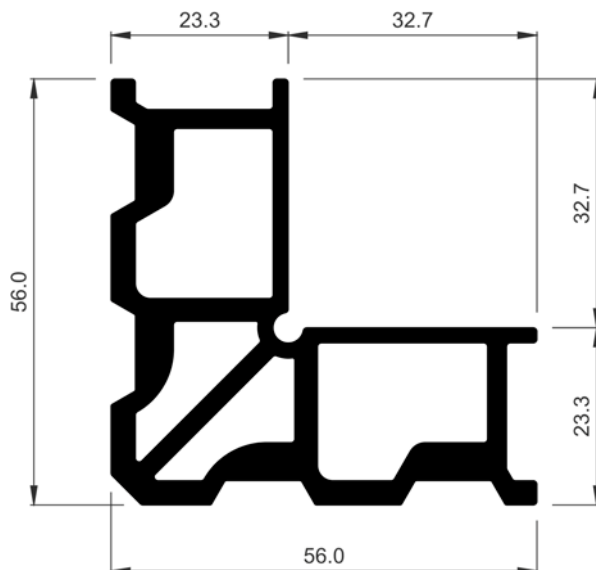

COR-3157	
Descripción Description	Perfil para escuadra de ensamblar de 23,30 mm Profile for assembly cleat - 23,30 mm
Peso Weight (g/m)	2143,9
Superficie Surface (dm ² /m)	52,05
Ix (cm⁴)	20,71
Iy (cm⁴)	20,71

COR 80 HOJA OCULTA
Perfiles a escala

COR 80 HIDDEN SASH
Profiles to scale

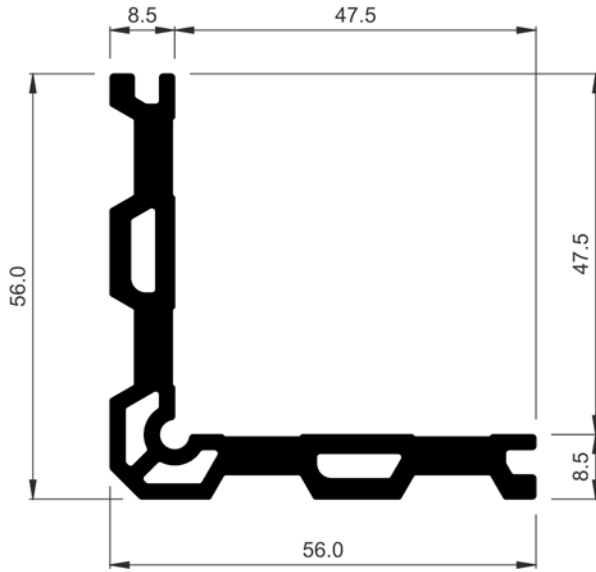

COR-3158	
Descripción Description	Perfil para escuadra de ensamblar de 8,50 mm Profile for assembly cleat - 8,50 mm
Peso Weight (g/m)	1493,1
Superficie Surface (dm ² /m)	35,64
Ix (cm⁴)	15,55
Iy (cm⁴)	15,55

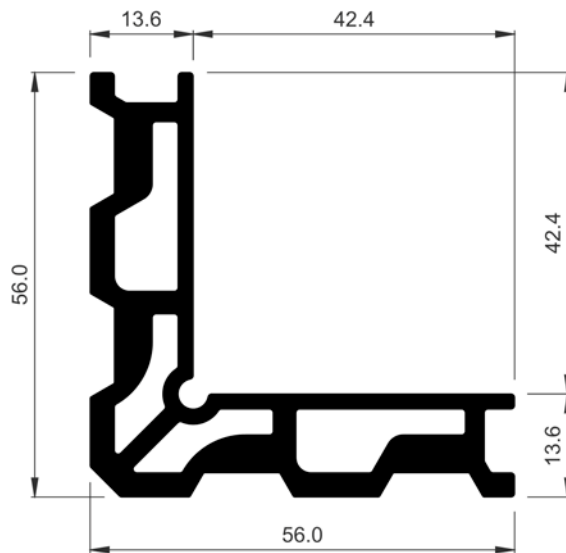

COR-3160	
Descripción Description	Perfil para escuadra de ensamblar de 13,60 mm Profile for assembly cleat - 13,60 mm
Peso Weight (g/m)	1884,6
Superficie Surface (dm ² /m)	45,94
Ix (cm⁴)	18,6
Iy (cm⁴)	18,6

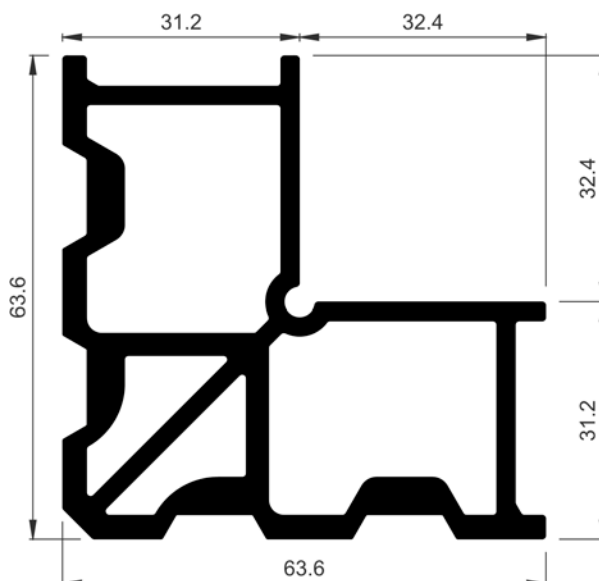

COR-3161	
Descripción Description	Perfil para escuadra de ensamblar de 31,20 mm Profile for assembly cleat - 31,20 mm
Peso Weight (g/m)	2651,4
Superficie Surface (dm ² /m)	62,87
Ix (cm⁴)	34,52
Iy (cm⁴)	34,52

COR 80 HOJA OCULTA
Perfiles a escala

COR 80 HIDDEN SASH
Profiles to scale

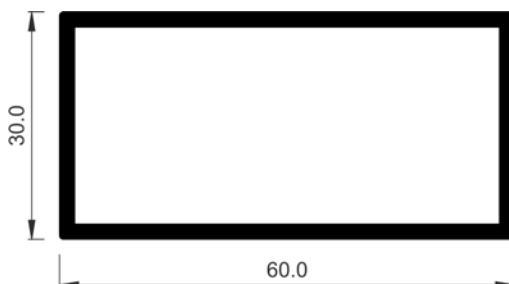
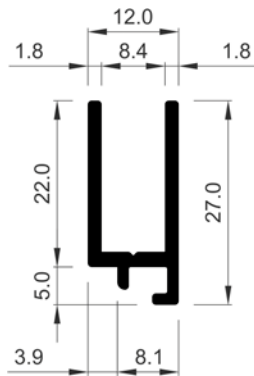
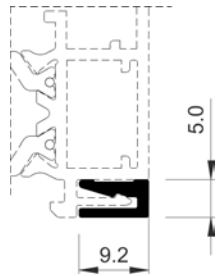
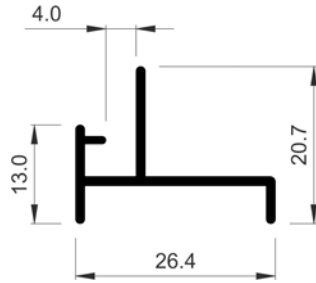

COR-5057	
Descripción Description	Complemento tapa registro (para chapa) Register cover complement (for plate)
Peso Weight (g/m)	191,7
Superficie Surface (dm ² /m)	12,06
Ix (cm⁴)	0,14
Iy (cm⁴)	0,5
Juntas Gaskets	262810
Tornillería Screws	853913

COR-7993	
Descripción Description	Remate enganches Hook finishing
Peso Weight (g/m)	78,3
Superficie Surface (dm ² /m)	4,23
Ix (cm⁴)	0,01
Iy (cm⁴)	0,02

COR-7997	
Descripción Description	Acople para junta de dilatación Expansion gasket attachment
Peso Weight (g/m)	297
Superficie Surface (dm ² /m)	12,56
Ix (cm⁴)	0,63
Iy (cm⁴)	0,24
Juntas Gaskets	347901
Tornillería Screws	813919

806030	
Descripción Description	Tubo de 60x30x2 mm 60x30x2 mm tube
Peso Weight (g/m)	928,8
Superficie Surface (dm ² /m)	34,4
Ix (cm⁴)	15,93
Iy (cm⁴)	5,29

COR 80 HOJA OCULTA
Perfiles a escala

COR 80 HIDDEN SASH
Profiles to scale

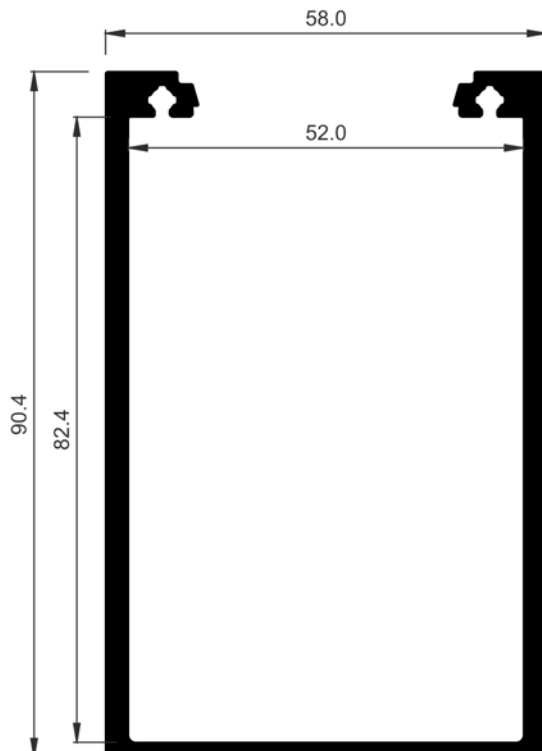
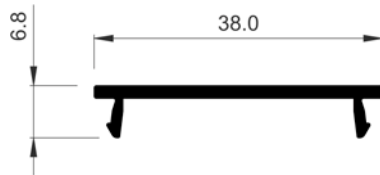
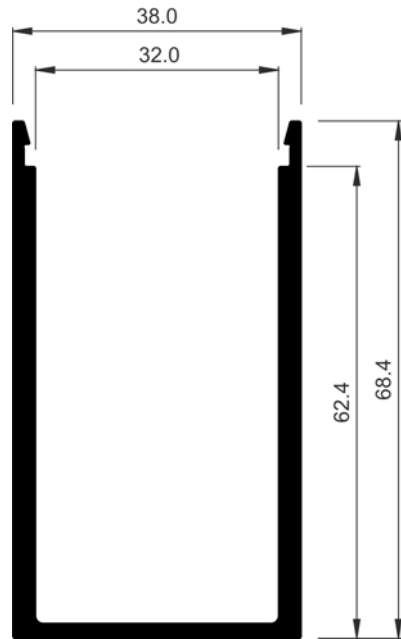

COR-1700	
Descripción Description	U de refuerzo Reinforcement U
Peso Weight (g/m)	1239,3
Superficie Surface (dm ² /m)	34,5
Ix (cm⁴)	20,05
Iy (cm⁴)	12,71
Observaciones Observations	Con tapa Cor-1701 With cover Cor-1701

COR-1701	
Descripción Description	Tapa clipaje U refuerzo Reinforcement U-clip end plate
Peso Weight (g/m)	202,5
Superficie Surface (dm ² /m)	10
Ix (cm⁴)	0,02
Iy (cm⁴)	1,09

COR-1703	
Descripción Description	U de refuerzo 90x58 mm 90x58 mm reinforcement U
Peso Weight (g/m)	1952,1
Superficie Surface (dm ² /m)	52,44
Ix (cm⁴)	70,69
Iy (cm⁴)	47,16
Observaciones Observations	Con tapa Cor-1701 With cover Cor-1701

COR 80 HOJA OCULTA
Perfiles a escala

COR 80 HIDDEN SASH
Profiles to scale

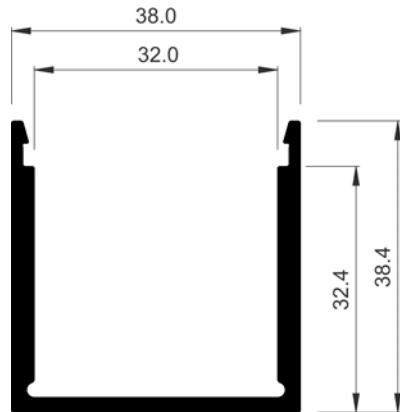

COR-1704	
Descripción Description	U refuerzo 40 mm Reinforcement U 40 mm
Peso Weight (g/m)	743,31
Superficie Surface (dm ² /m)	22,78
Ix (cm ⁴)	3,77
Iy (cm ⁴)	7,09
Observaciones Observations	Con tapa Cor-1701 With cover Cor-1701

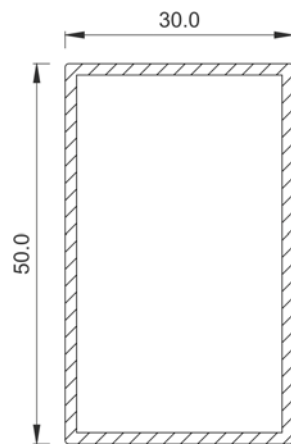

COR-6852	
Descripción Description	Tubo de 50x30 INOX 50x30 mm stainless tube
Ix (cm ⁴)	7,87
Iy (cm ⁴)	3,54

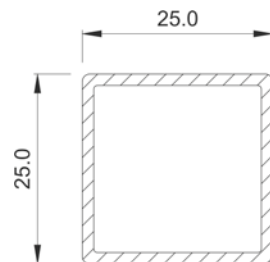

COR-7252	
Descripción Description	Tubo 25x25 INOX Tube of 25x25 stainless steel
Superficie Surface (dm ² /m)	18,8
Ix (cm ⁴)	1,29
Iy (cm ⁴)	1,29

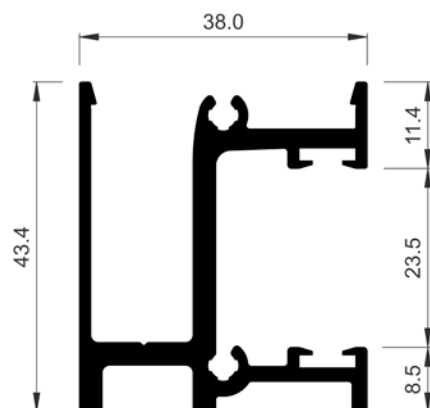

COR-8540	
Descripción Description	Soporte barandilla superpuesta Juliet balcony support
Peso Weight (g/m)	1012,5
Superficie Surface (dm ² /m)	34,51
Ix (cm ⁴)	7,15
Iy (cm ⁴)	5,04
Tapas Covers	358542
Tornillería Screws	814832 824222
Observaciones Observations	Compatible con perfil Cor-1701 Compatible with profile Cor-1701

COR 80 HOJA OCULTA
Perfiles a escala

COR 80 HIDDEN SASH
Profiles to scale

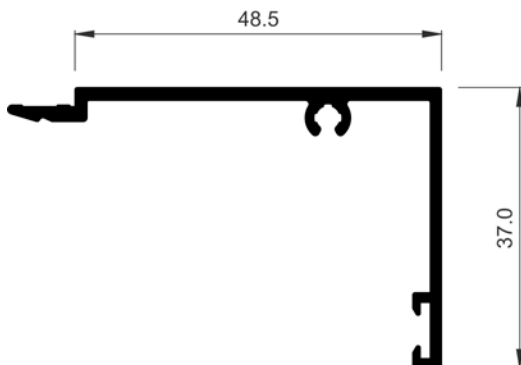
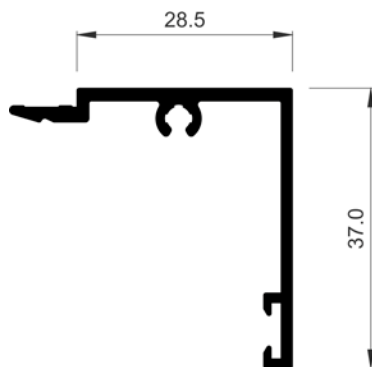
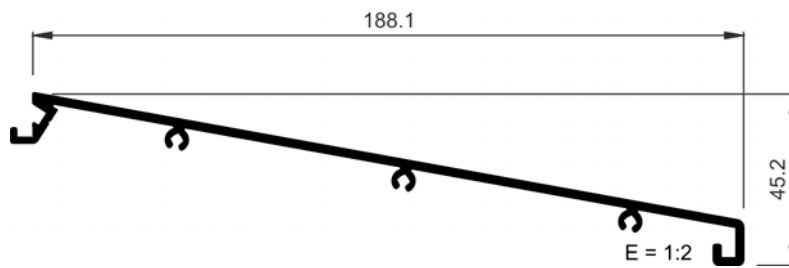
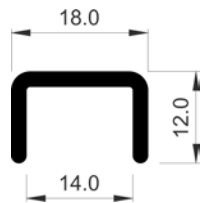
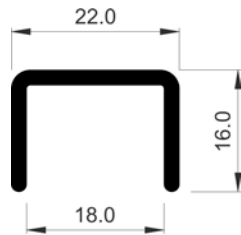

COR-8562	
Descripción Description	Remate vidrio 8.8 Glass finishing 8.8
Peso Weight (g/m)	261,9
Superficie Surface (dm ² /m)	9,97
Ix (cm ⁴)	2,4
Iy (cm ⁴)	7

COR-8563	
Descripción Description	Remate vidrio 6.6 Glass finishing 6.6
Peso Weight (g/m)	197,1
Superficie Surface (dm ² /m)	7,57
Ix (cm ⁴)	0,9
Iy (cm ⁴)	0,33

772694	
Descripción Description	Alargadera de 190 mm 190 mm cill
Peso Weight (g/m)	1385,1
Superficie Surface (dm ² /m)	53,44
Ix (cm ⁴)	6,7
Iy (cm ⁴)	191,64
Observaciones Observations	CONSULTAR DISPONIBILIDAD CHECK AVAILABILITY

COR-1780	
Descripción Description	Tapé recto de 28,5 mm Straight cap of 28,5 mm
Peso Weight (g/m)	388,8
Superficie Surface (dm ² /m)	18,5
Ix (cm ⁴)	2,01
Iy (cm ⁴)	1,87
Tapas Covers	371780

COR-1781	
Descripción Description	Tapé recto de 48,5 mm Straight cap of 48,5 mm
Peso Weight (g/m)	480,6
Superficie Surface (dm ² /m)	22,5
Ix (cm ⁴)	2,25
Iy (cm ⁴)	5,96
Tapas Covers	371780

COR 80 HOJA OCULTA
Perfiles a escala

COR 80 HIDDEN SASH
Profiles to scale

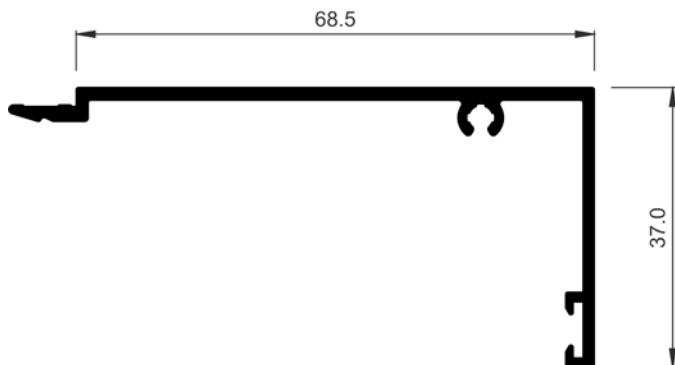

COR-1782	
Descripción Description	Tapé recto de 68,5 mm Straight cap of 68,5 mm
Peso Weight (g/m)	572,4
Superficie Surface (dm ² /m)	26,5
Ix (cm⁴)	2,41
Iy (cm⁴)	13,47
Tapas Covers	371780

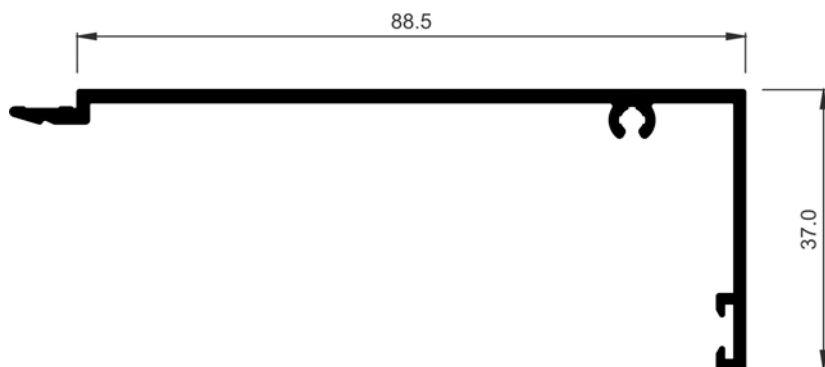

COR-1783	
Descripción Description	Tapé recto de 88,5 mm Straight cap of 88,5 mm
Peso Weight (g/m)	664,2
Superficie Surface (dm ² /m)	30,5
Ix (cm⁴)	2,53
Iy (cm⁴)	25,14
Tapas Covers	371780

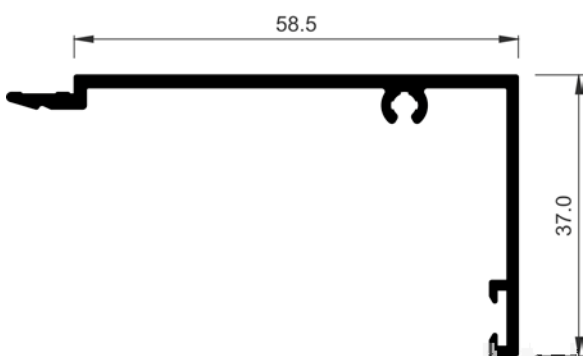

COR-1784	
Descripción Description	Tapé recto de 58,5 mm Straight cap of 58,5 mm
Peso Weight (g/m)	529,2
Superficie Surface (dm ² /m)	24,52
Ix (cm⁴)	2,34
Iy (cm⁴)	9,28
Tapas Covers	371780

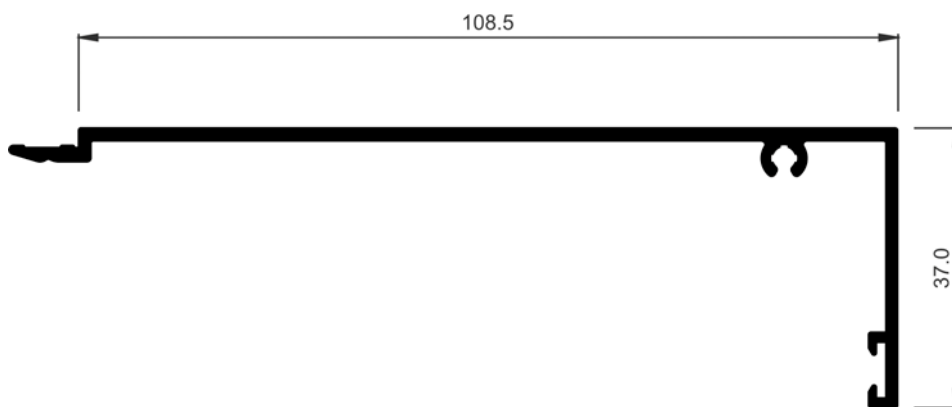

COR-1785	
Descripción Description	Tapé recto de 108,50 mm Straight cap of 108,50 mm
Peso Weight (g/m)	756
Superficie Surface (dm ² /m)	34,57
Ix (cm⁴)	2,62
Iy (cm⁴)	41,58

COR 80 HOJA OCULTA
Perfiles a escala

COR 80 HIDDEN SASH
Profiles to scale

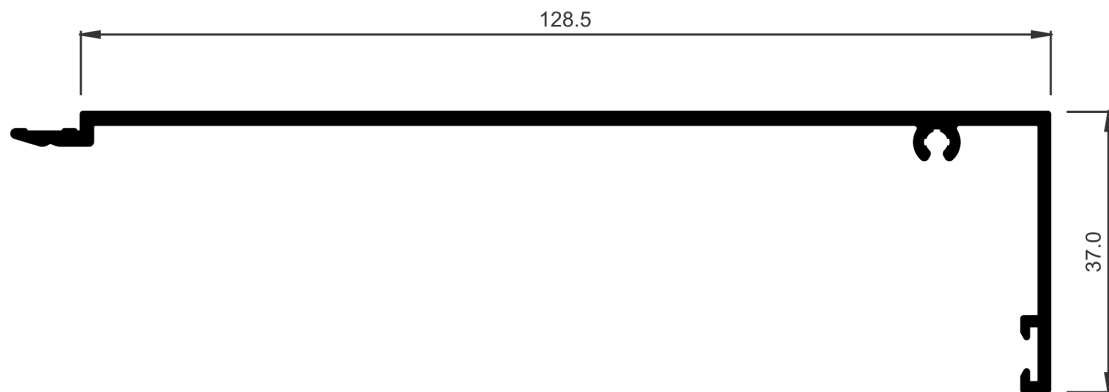

COR-1786	
Descripción Description	Tapé recto de 128,50 mm Straight cap of 128,50 mm
Peso Weight (g/m)	847,8
Superficie Surface (dm ² /m)	38,57
Ix (cm ⁴)	2,69
Iy (cm ⁴)	63,65

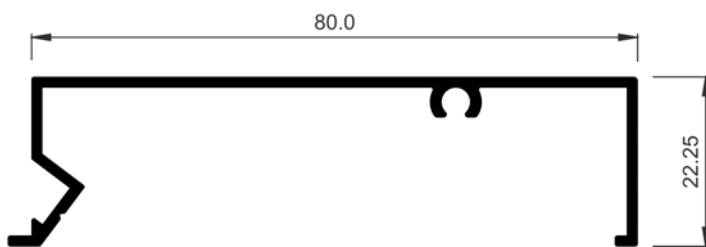

COR-2724	
Descripción Description	Cubre premarco 80 mm Pre-frame cover 80 mm
Peso Weight (g/m)	537,3
Superficie Surface (dm ² /m)	28,05
Ix (cm ⁴)	0,99
Iy (cm ⁴)	17,3
Observaciones Observations	Tornillo Ø3.9 mm DIN7504N-A2 Ø3.9 mm DIN7504N-A2 screw

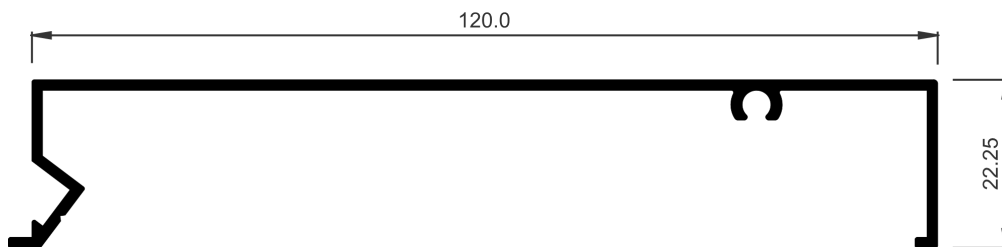

COR-2726	
Descripción Description	Cubre premarco 120 mm Pre-frame cover 120 mm
Peso Weight (g/m)	688,5
Superficie Surface (dm ² /m)	36,05
Ix (cm ⁴)	1,09
Iy (cm ⁴)	47,2
Observaciones Observations	Tornillo Ø3.9 mm DIN7504N-A2 Ø3.9 mm DIN7504N-A2 screw

COR 80 HOJA OCULTA
Perfiles a escala

COR 80 HIDDEN SASH
Profiles to scale

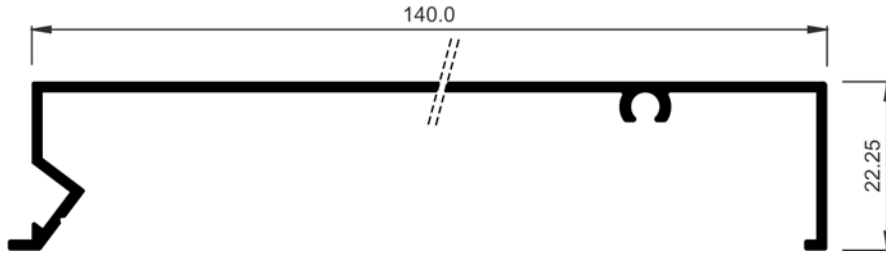

COR-2727	
Descripción Description	Cubre premarco 140 mm Pre-frame cover 140 mm
Peso Weight (g/m)	764,1
Superficie Surface (dm ² /m)	40,05
Ix (cm ⁴)	1,13
Iy (cm ⁴)	69,51
Observaciones Observations	Tornillo Ø3.9 mm DIN7504N-A2 Ø3.9 mm DIN7504N-A2 screw

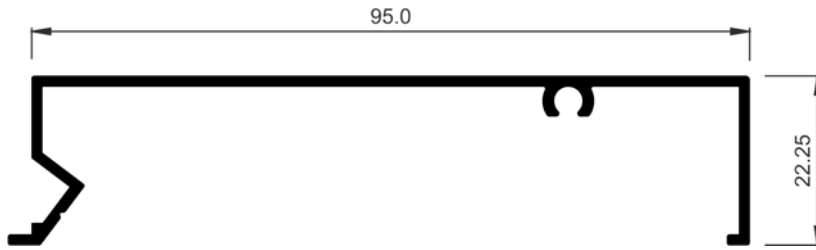

COR-2790	
Descripción Description	Cubre premarco 95 mm Pre-frame cover 95 mm
Peso Weight (g/m)	591,3
Superficie Surface (dm ² /m)	30,96
Ix (cm ⁴)	1,02
Iy (cm ⁴)	26,25
Observaciones Observations	Tornillo Ø3.9 mm DIN7504N-A2 Ø3.9 mm DIN7504N-A2 screw

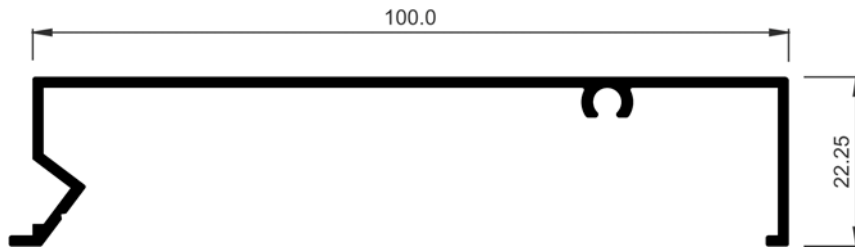

COR-2791	
Descripción Description	Cubre premarco 100 mm Pre-frame cover 100 mm
Peso Weight (g/m)	610,2
Superficie Surface (dm ² /m)	31,96
Ix (cm ⁴)	1,03
Iy (cm ⁴)	29,81
Observaciones Observations	Tornillo Ø3.9 mm DIN7504N-A2 Ø3.9 mm DIN7504N-A2 screw

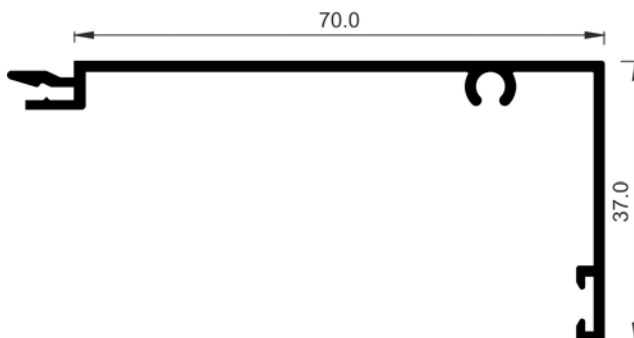

COR-2815	
Descripción Description	Tapé recto de 70 mm Straight cap of 70 mm
Peso Weight (g/m)	499,5
Superficie Surface (dm ² /m)	28,54
Ix (cm ⁴)	2,16
Iy (cm ⁴)	13,69

COR 80 HOJA OCULTA
Perfiles a escala

COR 80 HIDDEN SASH
Profiles to scale

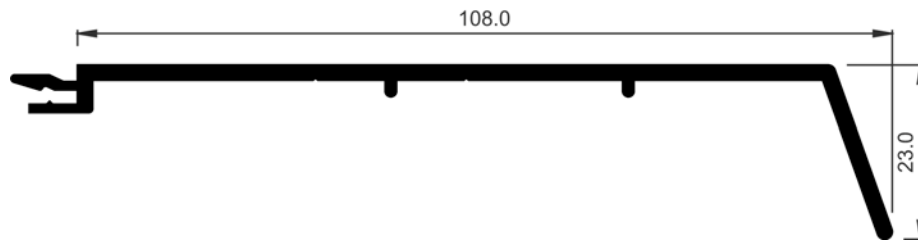

COR-2816	
Descripción Description	Tapé achaflanado de 108 mm Bevelled cap of 108 mm
Peso Weight (g/m)	753,3
Superficie Surface (dm ² /m)	29,58
Ix (cm ⁴)	0,64
Iy (cm ⁴)	37,19

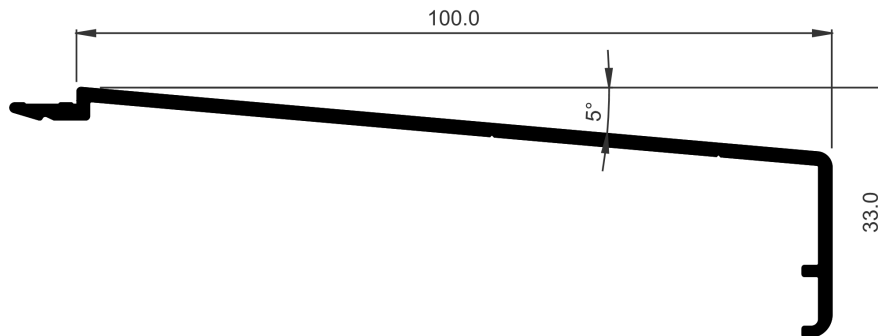

COR-2817	
Descripción Description	Alargadera con enganche de 100 mm Extension with attachment of 100 mm
Peso Weight (g/m)	626,4
Superficie Surface (dm ² /m)	27,69
Ix (cm ⁴)	1,34
Iy (cm ⁴)	29,29

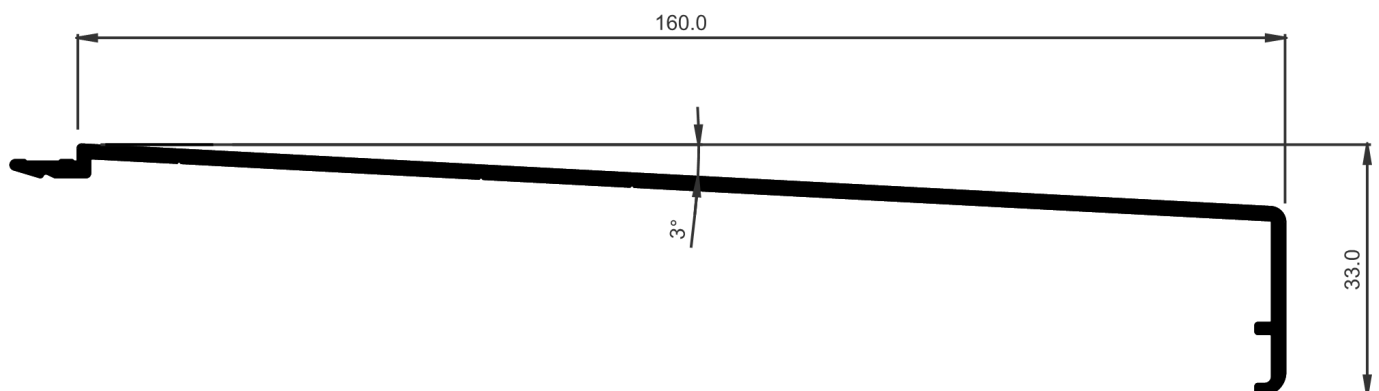

COR-2818	
Descripción Description	Alargadera con enganche de 160 mm Extension with attachment of 160 mm
Peso Weight (g/m)	901,8
Superficie Surface (dm ² /m)	39,76
Ix (cm ⁴)	1,47
Iy (cm ⁴)	97,1

COR 80 HOJA OCULTA
Perfiles a escala

COR 80 HIDDEN SASH
Profiles to scale

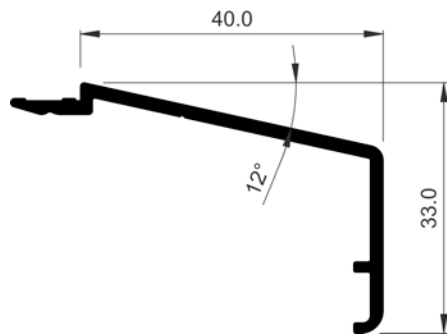

COR-2819	
Descripción Description	Alargadera con enganche de 40 mm Extension with attachment of 40 mm
Peso Weight (g/m)	353,7
Superficie Surface (dm ² /m)	15,8
Ix (cm⁴)	1,12
Iy (cm⁴)	3,38

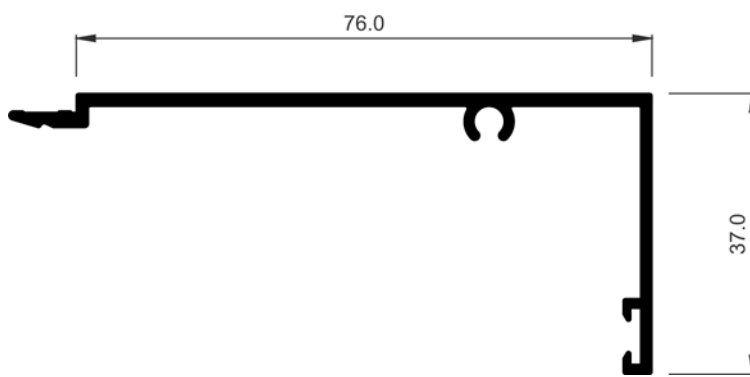

COR-2824	
Descripción Description	Tapé recto de 75 mm Straight cap of 75 mm
Peso Weight (g/m)	604,8
Superficie Surface (dm ² /m)	27,93
Ix (cm⁴)	2,46
Iy (cm⁴)	17,14

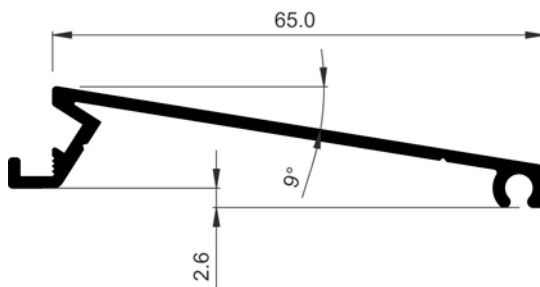

COR-2870	
Descripción Description	Alargadera de 65 mm 65 mm cill
Peso Weight (g/m)	415,8
Superficie Surface (dm ² /m)	19,92
Ix (cm⁴)	0,23
Iy (cm⁴)	8,45
Observaciones Observations	Tornillo Ø3.9 mm DIN7504N-A2 Ø3.9 mm DIN7504N-A2 screw

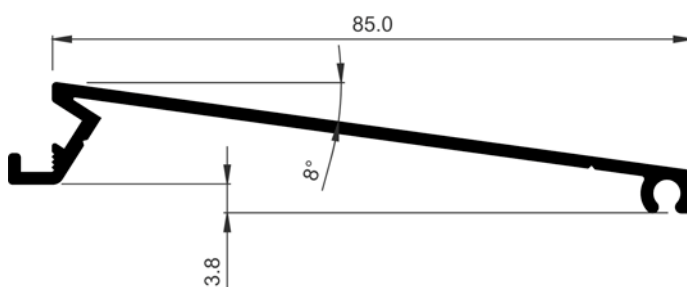

COR-2872	
Descripción Description	Alargadera de 85 mm 85 mm cill
Peso Weight (g/m)	496,8
Superficie Surface (dm ² /m)	23,92
Ix (cm⁴)	0,3
Iy (cm⁴)	16,49
Observaciones Observations	Tornillo Ø3.9 mm DIN7504N-A2 Ø3.9 mm DIN7504N-A2 screw

COR 80 HOJA OCULTA
Perfiles a escala

COR 80 HIDDEN SASH
Profiles to scale

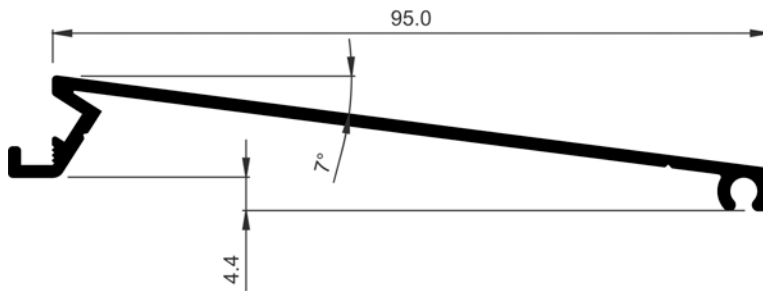

COR-2873	
Descripción Description	Alargadera de 95 mm 95 mm cill
Peso Weight (g/m)	537,3
Superficie Surface (dm ² /m)	25,92
Ix (cm⁴)	0,35
Iy (cm⁴)	21,83
Observaciones Observations	Tornillo Ø3.9 mm DIN7504N-A2 Ø3.9 mm DIN7504N-A2 screw

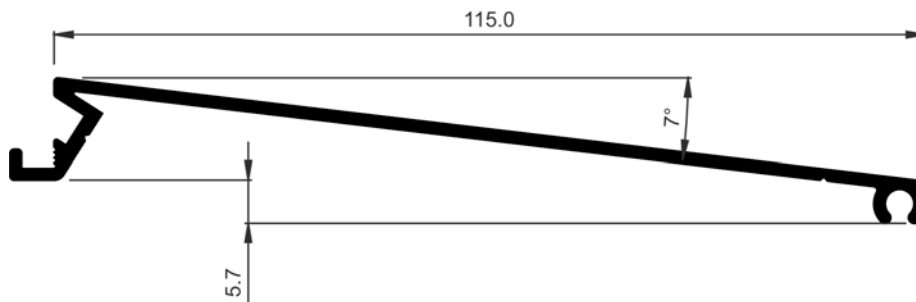

COR-2875	
Descripción Description	Alargadera de 115 mm 115 mm cill
Peso Weight (g/m)	618,3
Superficie Surface (dm ² /m)	29,93
Ix (cm⁴)	0,45
Iy (cm⁴)	35,54
Observaciones Observations	Tornillo Ø3.9 mm DIN7504N-A2 Ø3.9 mm DIN7504N-A2 screw

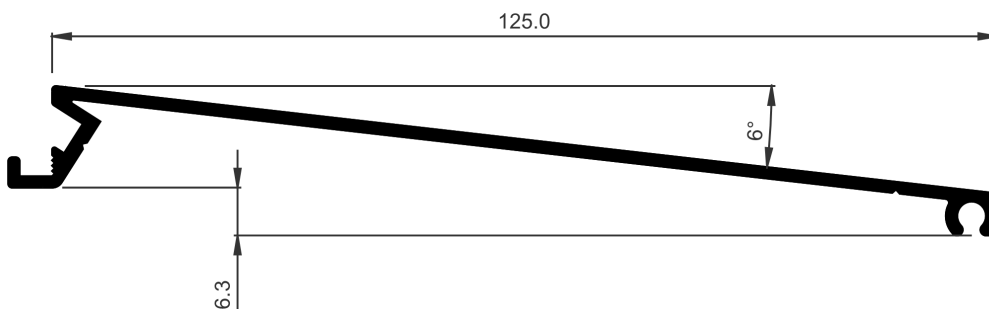

COR-2876	
Descripción Description	Alargadera de 125 mm 125 mm cill
Peso Weight (g/m)	656,1
Superficie Surface (dm ² /m)	31,93
Ix (cm⁴)	0,51
Iy (cm⁴)	44,06
Observaciones Observations	Tornillo Ø3.9 mm DIN7504N-A2 Ø3.9 mm DIN7504N-A2 screw

COR 80 HOJA OCULTA
Perfiles a escala

COR 80 HIDDEN SASH
Profiles to scale

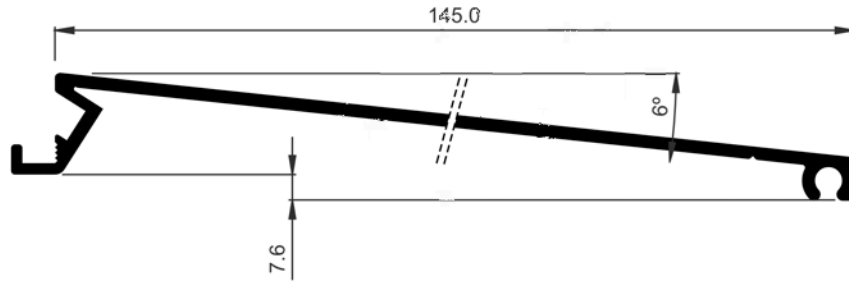

COR-2878	
Descripción Description	Alargadera de 145 mm 145 mm cill
Peso Weight (g/m)	737,1
Superficie Surface (dm ² /m)	35,94
Ix (cm ⁴)	0,64
Iy (cm ⁴)	64,8
Observaciones Observations	Tornillo Ø3.9 mm DIN7504N-A2 Ø3.9 mm DIN7504N-A2 screw

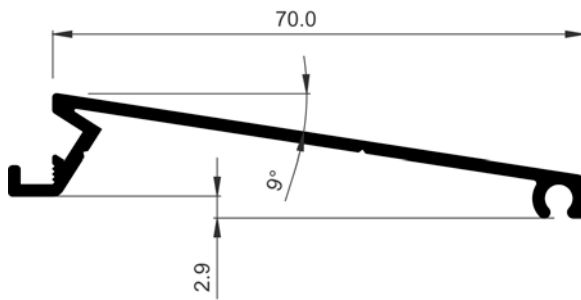

COR-2888	
Descripción Description	Alargadera de 70 mm 70 mm cill
Peso Weight (g/m)	437,4
Superficie Surface (dm ² /m)	20,92
Ix (cm ⁴)	0,25
Iy (cm ⁴)	10,17
Observaciones Observations	Tornillo Ø3.9 mm DIN7504N-A2 Ø3.9 mm DIN7504N-A2 screw

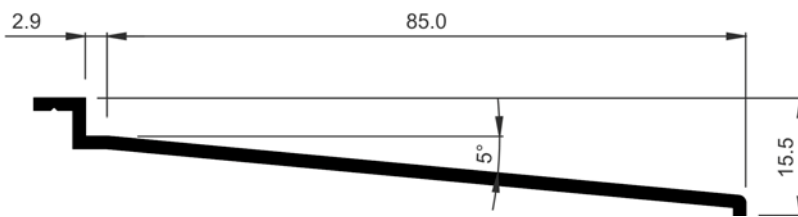

COR-7055	
Descripción Description	Alargadera de 85 mm 85 mm cill
Peso Weight (g/m)	434,7
Superficie Surface (dm ² /m)	20,54
Ix (cm ⁴)	0,19
Iy (cm ⁴)	12,95
Tornillería Screws	812913

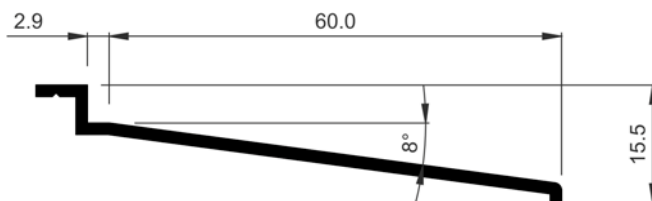

COR-7056	
Descripción Description	Alargadera de 60 mm 60 mm cill
Peso Weight (g/m)	307,8
Superficie Surface (dm ² /m)	15,57
Ix (cm ⁴)	0,15
Iy (cm ⁴)	5
Tornillería Screws	812913

COR 80 HOJA OCULTA
Perfiles a escala

COR 80 HIDDEN SASH
Profiles to scale

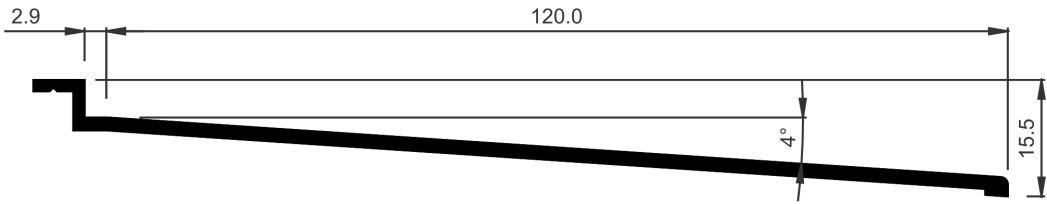

COR-7057	
Descripción Description	Alargadera de 120 mm 120 mm cill
Peso Weight (g/m)	618,3
Superficie Surface (dm ² /m)	27,5
Ix (cm ⁴)	0,23
Iy (cm ⁴)	33,9
Tornillería Screws	812913

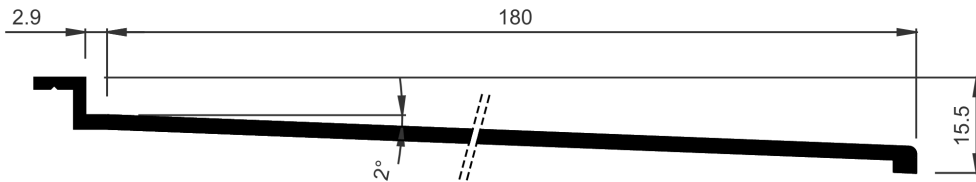

COR-7072	
Descripción Description	Alargadera de 180 mm 180 mm cill
Peso Weight (g/m)	950,4
Superficie Surface (dm ² /m)	39,66
Ix (cm ⁴)	0,26
Iy (cm ⁴)	110,95
Tornillería Screws	812913

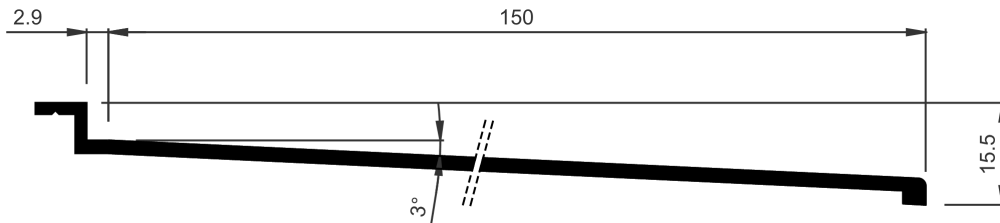

COR-7073	
Descripción Description	Alargadera de 150 mm 150 mm cill
Peso Weight (g/m)	764,1
Superficie Surface (dm ² /m)	33,66
Ix (cm ⁴)	0,22
Iy (cm ⁴)	64,13
Tornillería Screws	812913

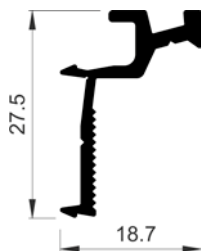

COR-2705	
Descripción Description	Grapa para solapes Clip for overlap
Peso Weight (g/m)	232,2
Superficie Surface (dm ² /m)	112,1
Ix (cm ⁴)	0,58
Iy (cm ⁴)	0,23
Tornillería Screws	853913

COR 80 HOJA OCULTA
Perfiles a escala

COR 80 HIDDEN SASH
Profiles to scale

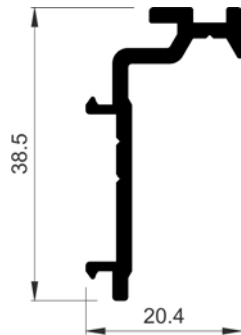

COR-2744	
Descripción Description	Grapa para solapes Clip for overlap
Peso Weight (g/m)	348,3
Superficie Surface (dm ² /m)	13,98
Ix (cm⁴)	1,84
Iy (cm⁴)	0,36
Tornillería Screws	853913

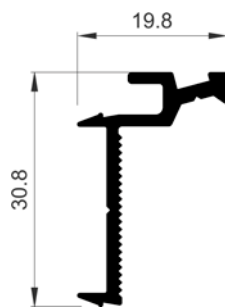

COR-2842	
Descripción Description	Grapa para solapes Clip for overlap
Peso Weight (g/m)	261,9
Superficie Surface (dm ² /m)	12,73
Ix (cm⁴)	0,9
Iy (cm⁴)	0,24
Tornillería Screws	853913

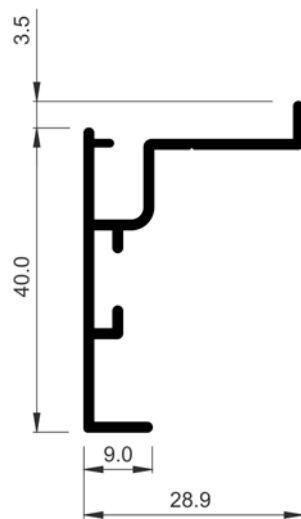

770224	
Descripción Description	Solape de registro recto Straight register overlap
Peso Weight (g/m)	353,7
Superficie Surface (dm ² /m)	20,3
Ix (cm⁴)	2,24
Iy (cm⁴)	0,98
Juntas Gaskets	262810
Escuadra alineamiento Alignment cleat	245054
Observaciones Observations	Tornillo Ø3.9 mm DIN7504N-A2 Screw Ø3.9 mm DIN7504N-A2

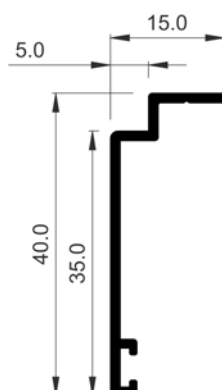

770229	
Descripción Description	Solape de 35 mm 35 mm overlap
Peso Weight (g/m)	205
Superficie Surface (dm ² /m)	12
Ix (cm⁴)	1,38
Iy (cm⁴)	0,11
Escuadra alineamiento Alignment cleat	282730

COR 80 HOJA OCULTA
Perfiles a escala

COR 80 HIDDEN SASH
Profiles to scale

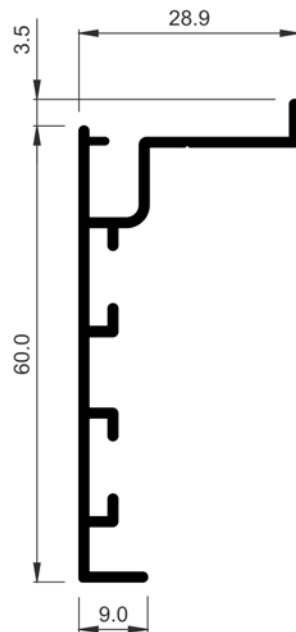

770563	
Descripción Description	Solape 60 mm 60 mm overlap
Peso Weight (g/m)	469,8
Superficie Surface (dm ² /m)	26,85
Ix (cm⁴)	6,94
Iy (cm⁴)	1,09
Escuadra alineamiento Alignment cleat	245054
Observaciones Observations	Tornillo Ø3,9 mm DIN7504N-A2 Screw Ø3,9 mm DIN7504N-A2

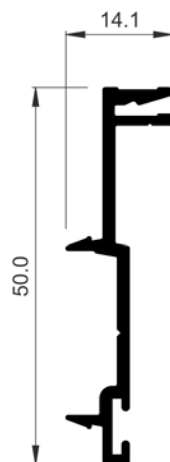

COR-1767	
Descripción Description	Solape de 50 mm con clip 35 mm overlap with clip
Peso Weight (g/m)	332,1
Superficie Surface (dm ² /m)	16,79
Ix (cm⁴)	3,19
Iy (cm⁴)	0,07

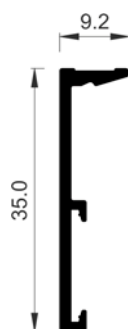

COR-1770	
Descripción Description	Solape de 35 mm 35 mm overlap
Peso Weight (g/m)	197,1
Superficie Surface (dm ² /m)	10,05
Ix (cm⁴)	0,95
Iy (cm⁴)	0,03
Escuadra alineamiento Alignment cleat	920135

COR 80 HOJA OCULTA
Perfiles a escala

COR 80 HIDDEN SASH
Profiles to scale

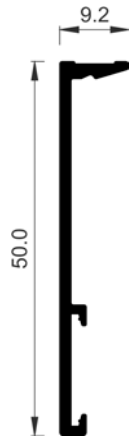

COR-1771	
Descripción Description	Solape de 50 mm 50 mm overlap
Peso Weight (g/m)	256,5
Superficie Surface (dm ² /m)	13,06
Ix (cm ⁴)	2,5
Iy (cm ⁴)	0,03
Escuadra alineamiento Alignment cleat	920135

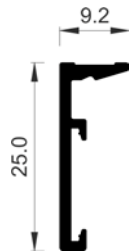

COR-1772	
Descripción Description	Solape de 25 mm 25 mm overlap
Peso Weight (g/m)	156,6
Superficie Surface (dm ² /m)	80,6
Ix (cm ⁴)	0,39
Iy (cm ⁴)	0,02
Escuadra alineamiento Alignment cleat	920135

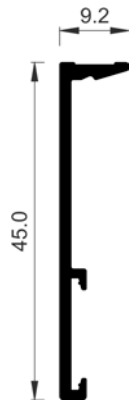

COR-1773	
Descripción Description	Solape de 45 mm 45 mm overlap
Peso Weight (g/m)	237,6
Superficie Surface (dm ² /m)	12,06
Ix (cm ⁴)	1,87
Iy (cm ⁴)	0,03
Escuadra alineamiento Alignment cleat	920135

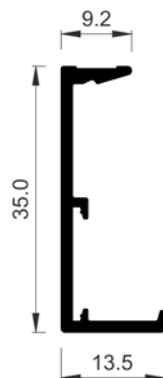

COR-1774	
Descripción Description	Solape de 35x13,5 mm 35x13,5 mm overlap
Peso Weight (g/m)	240,3
Superficie Surface (dm ² /m)	12,27
Ix (cm ⁴)	1,42
Iy (cm ⁴)	0,11
Escuadra alineamiento Alignment cleat	920135

COR 80 HOJA OCULTA
Perfiles a escala

COR 80 HIDDEN SASH
Profiles to scale

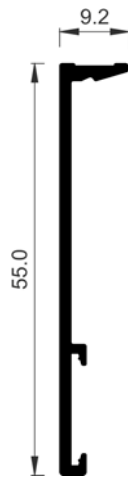

COR-1776	
Descripción Description	Solape de 55 mm 55 mm overlap
Peso Weight (g/m)	278,1
Superficie Surface (dm ² /m)	14,06
Ix (cm⁴)	3,23
Iy (cm⁴)	0,28
Escuadra alineamiento Alignment cleat	920135

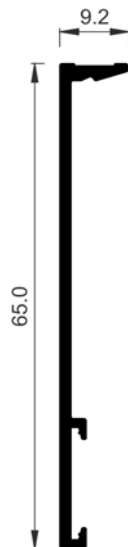

COR-1777	
Descripción Description	Solape de 65 mm 65 mm overlap
Peso Weight (g/m)	318,6
Superficie Surface (dm ² /m)	16,06
Ix (cm⁴)	5,1
Iy (cm⁴)	0,29
Escuadra alineamiento Alignment cleat	920135

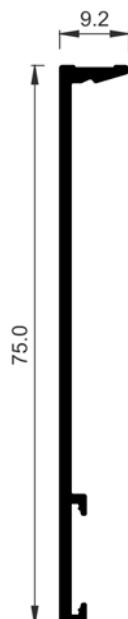

COR-1778	
Descripción Description	Solape de 75 mm 75 mm overlap
Peso Weight (g/m)	35,91
Superficie Surface (dm ² /m)	18,06
Ix (cm⁴)	7,57
Iy (cm⁴)	0,29
Escuadra alineamiento Alignment cleat	920135

COR 80 HOJA OCULTA
Perfiles a escala

COR 80 HIDDEN SASH
Profiles to scale

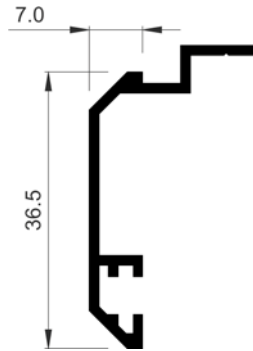

COR-2026	
Descripción Description	Solape 35 mm 35 mm overlap
Peso Weight (g/m)	272,7
Superficie Surface (dm ² /m)	15,24
Ix (cm⁴)	1,8
Iy (cm⁴)	0,33
Escuadra alineamiento Alignment cleat	212008
Observaciones Observations	Tornillo Ø3.9 mm DIN7504N-A2. Screw Ø3.9 mm DIN7504N-A2

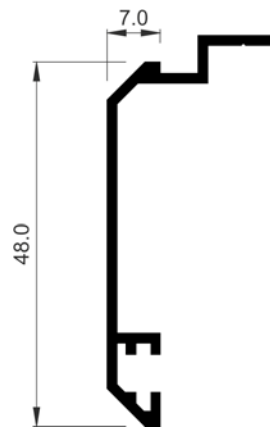

COR-2036	
Descripción Description	Solape 48 mm 48 mm overlap
Peso Weight (g/m)	272,7
Superficie Surface (dm ² /m)	17,63
Ix (cm⁴)	3,19
Iy (cm⁴)	0,31
Escuadra alineamiento Alignment cleat	212008
Observaciones Observations	Tornillo Ø3.9 mm DIN7504N-A2 Screw Ø3.9 mm DIN7504N-A2

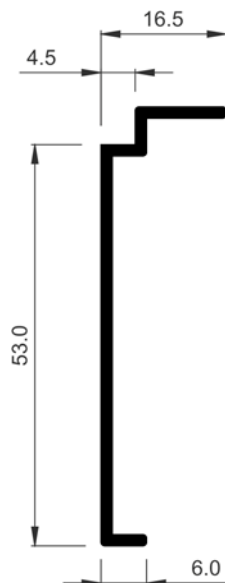

COR-2077	
Descripción Description	Solape recto de 53 mm 53 mm straight overlap
Peso Weight (g/m)	315,9
Superficie Surface (dm ² /m)	15,75
Ix (cm⁴)	4,43
Iy (cm⁴)	0,17
Observaciones Observations	Tornillo Ø3.9 mm DIN7504N-A2 Screw Ø3.9 mm DIN7504N-A2

COR 80 HOJA OCULTA
Perfiles a escala

COR 80 HIDDEN SASH
Profiles to scale

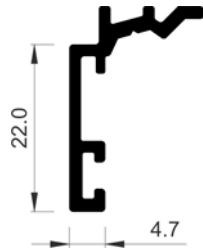

COR-2725	
Descripción Description	Solape recto 22 mm 22 mm straight overlap
Peso Weight (g/m)	245,7
Superficie Surface (dm ² /m)	11,2
Ix (cm⁴)	0,71
Iy (cm⁴)	0,2
Escuadra alineamiento Alignment cleat	212007
Observaciones Observations	Tornillo Ø3,9 mm DIN7504P-A2 Screw Ø3,9 mm DIN7504N-A2

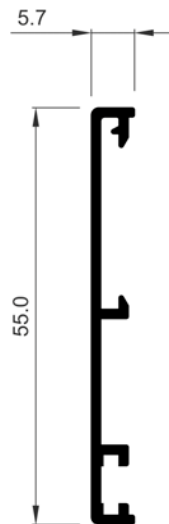

COR-2728	
Descripción Description	Solape recto de 55 mm Straight overlap 55 mm
Peso Weight (g/m)	270
Superficie Surface (dm ² /m)	16,03
Ix (cm⁴)	3,19
Iy (cm⁴)	0,02
Escuadra alineamiento Alignment cleat	212008 912100
Observaciones Observations	Grapa 2705 Clip 2705

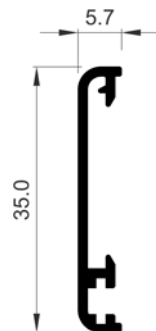

COR-2731	
Descripción Description	Solape de 35 mm Straight overlap 35 mm
Peso Weight (g/m)	183,6
Superficie Surface (dm ² /m)	11
Ix (cm⁴)	0,92
Iy (cm⁴)	0,02
Escuadra alineamiento Alignment cleat	212007 912100
Observaciones Observations	Grapa 2705 Clip 2705

COR 80 HOJA OCULTA
Perfiles a escala

COR 80 HIDDEN SASH
Profiles to scale

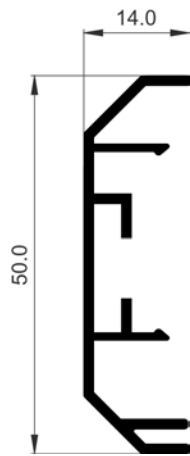

COR-2733	
Descripción Description	Solape chaflán de 50 mm Bevelled overlap 50 mm
Peso Weight (g/m)	367,2
Superficie Surface (dm ² /m)	21,82
Ix (cm⁴)	2,94
Iy (cm⁴)	1,75
Escuadra alineamiento Alignment cleat	207004 277004
Observaciones Observations	Grapa 2744 Clip 2744

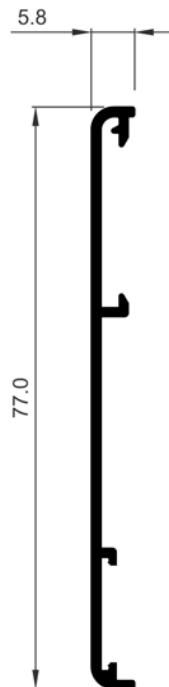

COR-2734	
Descripción Description	Solape de 77 mm 77 mm overlap
Peso Weight (g/m)	337,5
Superficie Surface (dm ² /m)	19,66
Ix (cm⁴)	7,31
Iy (cm⁴)	0,02
Escuadra alineamiento Alignment cleat	912100 920135
Observaciones Observations	Grapa 2705 Clip 2705

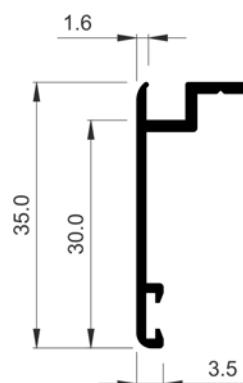

COR-2735	
Descripción Description	Solape de 35 mm Screw overlap
Peso Weight (g/m)	205,2
Superficie Surface (dm ² /m)	12,02
Ix (cm⁴)	0,99
Iy (cm⁴)	0,11
Tornillería Screws	852913
Escuadra alineamiento Alignment cleat	212007

COR 80 HOJA OCULTA
Perfiles a escala

COR 80 HIDDEN SASH
Profiles to scale

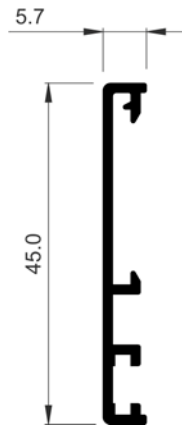

COR-2745	
Descripción Description	Solape recto 45 mm Straight overlap 45 mm
Peso Weight (g/m)	237,6
Superficie Surface (dm ² /m)	14,03
Ix (cm⁴)	1,88
Iy (cm⁴)	0,02
Escuadra alineamiento Alignment cleat	212008 912100
Observaciones Observations	Grapa 2705 Clip 2705

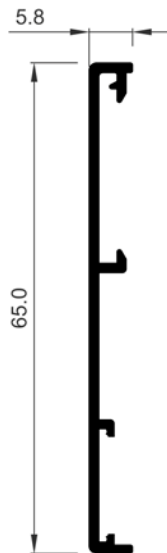

COR-2773	
Descripción Description	Solape recto de 65 mm Straight overlap 65 mm
Peso Weight (g/m)	299,7
Superficie Surface (dm ² /m)	17,49
Ix (cm⁴)	4,7
Iy (cm⁴)	0,02
Escuadra alineamiento Alignment cleat	912100 920135
Observaciones Observations	Grapa 2705 Clip 2705

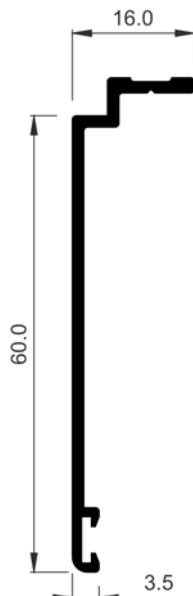

COR-2781	
Descripción Description	Solape recto 60 mm 60 mm straight overlap
Peso Weight (g/m)	337,5
Superficie Surface (dm ² /m)	17,32
Ix (cm⁴)	5,59
Iy (cm⁴)	0,18
Escuadra alineamiento Alignment cleat	212007
Observaciones Observations	Tornillo Ø3.9 mm DIN7504N-A2 Screw Ø3.9 mm DIN7504N-A2

COR 80 HOJA OCULTA
Perfiles a escala

COR 80 HIDDEN SASH
Profiles to scale

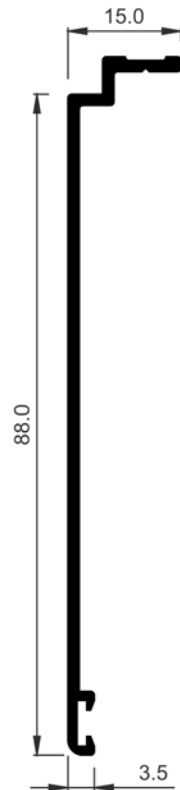

COR-2788	
Descripción Description	Solape recto 88 mm 88 mm straight overlap
Peso Weight (g/m)	450,9
Superficie Surface (dm ² /m)	22,92
Ix (cm⁴)	14,88
Iy (cm⁴)	0,19
Escuadra alineamiento Alignment cleat	212007
Observaciones Observations	Tornillo Ø3.9 mm DIN7504N-A2 Screw Ø3.9 mm DIN7504N-A2

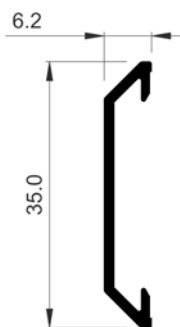

COR-2831	
Descripción Description	Solape de 35 mm 35 mm overlap
Peso Weight (g/m)	159,3
Superficie Surface (dm ² /m)	9,31
Ix (cm⁴)	0,76
Iy (cm⁴)	0,02
Escuadra alineamiento Alignment cleat	242831
Grapa Clip	342842

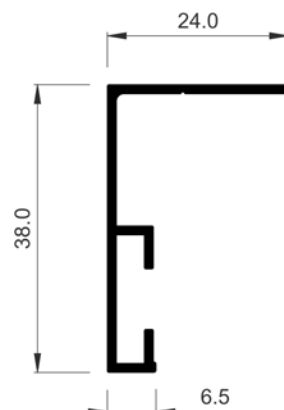

COR-2833	
Descripción Description	Tapajuntas atornillar 38 mm 38 mm flashings screw
Peso Weight (g/m)	259,2
Superficie Surface (dm ² /m)	16,08
Ix (cm⁴)	1,74
Iy (cm⁴)	0,37
Tornillería Screws	813919
Escuadra alineamiento Alignment cleat	207004 277004

COR 80 HOJA OCULTA
Perfiles a escala

COR 80 HIDDEN SASH
Profiles to scale

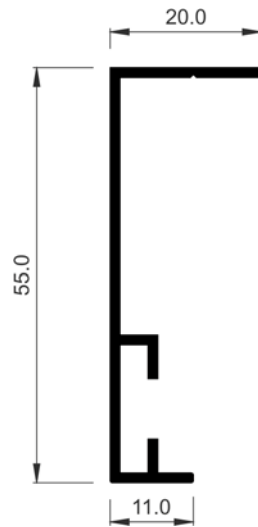

COR-2834	
Descripción Description	Solape de 55 mm atornillar (en L) 55 mm overlap screw (in L)
Peso Weight (g/m)	340,2
Superficie Surface (dm ² /m)	19,71
Ix (cm⁴)	4,91
Iy (cm⁴)	0,28
Tornillería Screws	813919
Escuadra alineamiento Alignment cleat	207004 277004

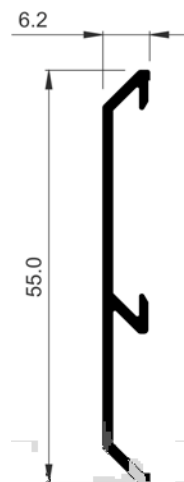

COR-2835	
Descripción Description	Solape de 55 mm 55 mm overlap
Peso Weight (g/m)	253,8
Superficie Surface (dm ² /m)	14,4
Ix (cm⁴)	2,44
Iy (cm⁴)	0,03
Escuadra alineamiento Alignment cleat	242831
Grapa Clip	342842

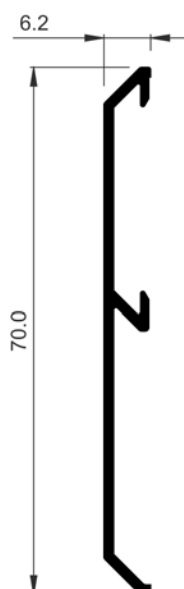

COR-2837	
Descripción Description	Solape de 70 mm 70 mm overlap
Peso Weight (g/m)	305,1
Superficie Surface (dm ² /m)	17,4
Ix (cm⁴)	4,74
Iy (cm⁴)	0,03
Escuadra alineamiento Alignment cleat	242831
Grapa Clip	342842

COR 80 HOJA OCULTA
Perfiles a escala

COR 80 HIDDEN SASH
Profiles to scale



COR-2839	
Descripción Description	Solape recto de 40 mm 40 mm straight overlap
Peso Weight (g/m)	232,2
Superficie Surface (dm ² /m)	14,42
Ix (cm⁴)	1,59
Iy (cm⁴)	0,04
Escuadra alineamiento Alignment cleat	920135
Observaciones Observations	Grapa 2744 Clip 2744

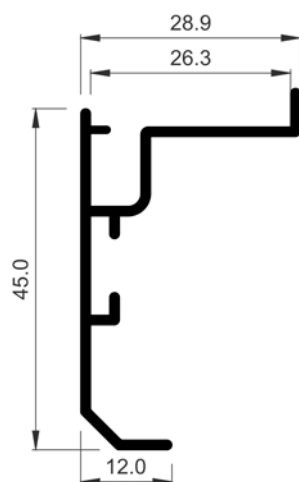

COR-2894	
Descripción Description	Solape de registro de 45 mm 45 mm register overlap
Peso Weight (g/m)	372,6
Superficie Surface (dm ² /m)	21,37
Ix (cm⁴)	2,87
Iy (cm⁴)	1
Tornillería Screws	813919
Escuadra alineamiento Alignment cleat	245054
Observaciones Observations	Tornillo Ø3,9 mm DIN7504N-A2 Screw Ø3,9 mm DIN7504N-A2

COR 80 HOJA OCULTA
Perfiles a escala

COR 80 HIDDEN SASH
Profiles to scale

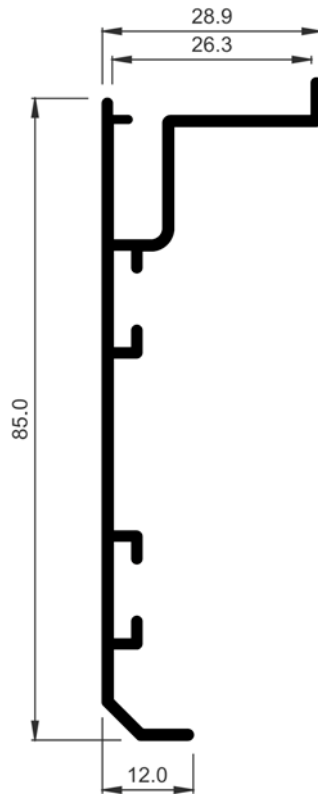

COR-2898	
Descripción Description	Solape de registro de 85 mm 85 mm register overlap
Peso Weight (g/m)	612,9
Superficie Surface (dm ² /m)	33,06
Ix (cm⁴)	17,56
Iy (cm⁴)	1,24
Tornillería Screws	813919
Escuadra alineamiento Alignment cleat	245054
Observaciones Observations	Tornillo Ø3.9 mm DIN7504N-A2 Screw Ø3.9 mm DIN7504N-A2

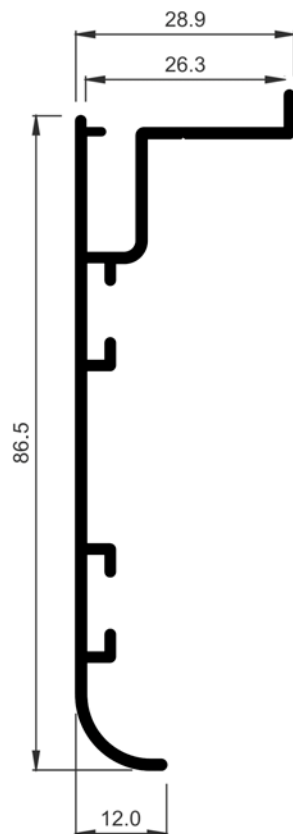

COR-5054	
Descripción Description	Solape de registro curvo de 86.50 mm Curve register overlap of 86,50 mm
Peso Weight (g/m)	621
Superficie Surface (dm ² /m)	33,11
Ix (cm⁴)	17,92
Iy (cm⁴)	1,23
Escuadra alineamiento Alignment cleat	245054
Observaciones Observations	Tornillo Ø3.9 mm DIN7504N-A2 Screw Ø3.9 mm DIN7504N-A2

COR 80 HOJA OCULTA
Perfiles a escala

COR 80 HIDDEN SASH
Profiles to scale

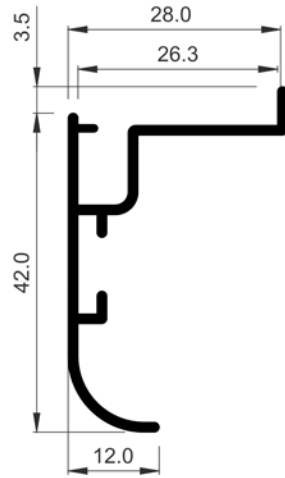

COR-5056	
Descripción Description	Solape de registro Register overlap
Peso Weight (g/m)	356,4
Superficie Surface (dm ² /m)	20,49
Ix (cm⁴)	2,38
Iy (cm⁴)	0,97
Escuadra alineamiento Alignment cleat	245054
Observaciones Observations	Tornillo Ø3.9 mm DIN7504N-A2 Screw Ø3.9 mm DIN7504N-A2

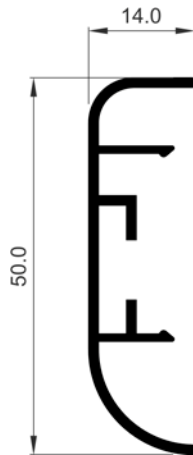

COR-7026	
Descripción Description	Solape de 50 mm 50 mm overlap
Peso Weight (g/m)	340,2
Superficie Surface (dm ² /m)	20,45
Ix (cm⁴)	2,99
Iy (cm⁴)	0,18
Escuadra alineamiento Alignment cleat	207004 277004
Observaciones Observations	Grapa 2744 Clip 2744

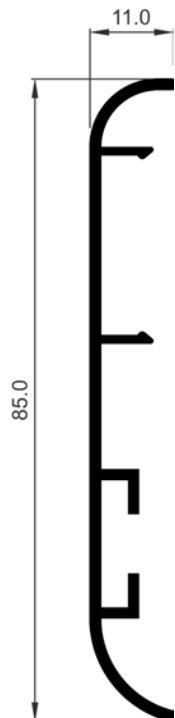

COR-7027	
Descripción Description	Solape de 85 mm 85 mm overlap
Peso Weight (g/m)	464,4
Superficie Surface (dm ² /m)	25,82
Ix (cm⁴)	11,36
Iy (cm⁴)	0,12
Escuadra alineamiento Alignment cleat	207004 277004
Observaciones Observations	Grapa 2744 Clip 2744

COR 80 HOJA OCULTA
Perfiles a escala

COR 80 HIDDEN SASH
Profiles to scale

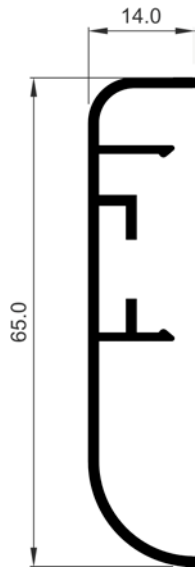

COR-7029	
Descripción Description	Solape de 65 mm 65 mm overlap
Peso Weight (g/m)	394,2
Superficie Surface (dm ² /m)	23,45
Ix (cm⁴)	5,75
Iy (cm⁴)	0,2
Escuadra alineamiento Alignment cleat	207004 277004
Observaciones Observations	Grapa 2744 Clip 2744

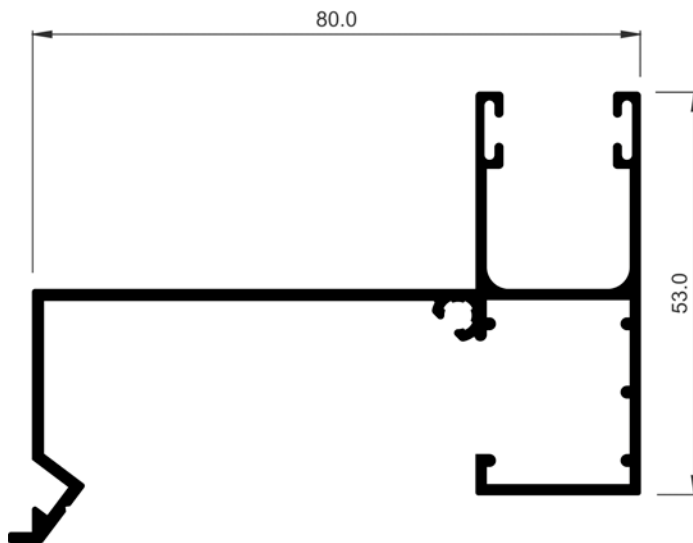

COR-2708	
Descripción Description	Guía de 80 mm 80 mm guide
Peso Weight (g/m)	926,1
Superficie Surface (dm ² /m)	50,34
Ix (cm⁴)	7,61
Iy (cm⁴)	29,27
Observaciones Observations	Tornillo Ø3.9 mm DIN7504N-A2. Sólo válida para persianas motorizadas Ø3.9 mm DIN7504N- A2 screw. Only for motorized shutters

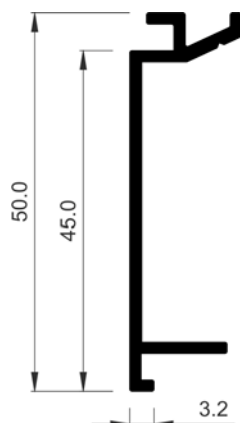

COR-2721	
Descripción Description	Tapa guía Guide cover
Peso Weight (g/m)	351
Superficie Surface (dm ² /m)	17,43
Ix (cm⁴)	3,91
Iy (cm⁴)	0,29
Observaciones Observations	Tornillo Ø3.9 mm DIN7504N-A2 Screw Ø3.9 mm DIN7504N-A2

COR 80 HOJA OCULTA
Perfiles a escala

COR 80 HIDDEN SASH
Profiles to scale

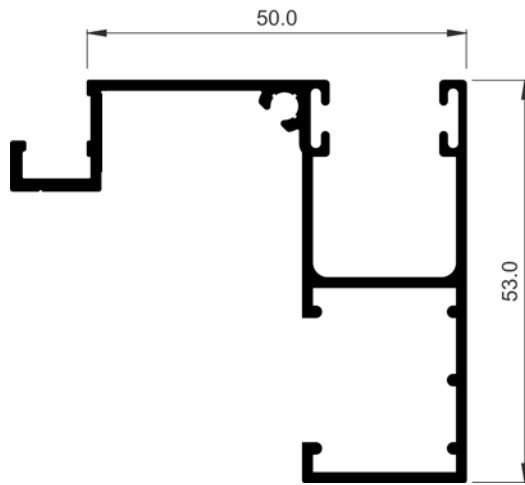

COR-2752	
Descripción Description	Guía de 50 mm Guide of 50 mm
Peso Weight (g/m)	758,7
Superficie Surface (dm ² /m)	41,84
Ix (cm⁴)	8,43
Iy (cm⁴)	9,58
Observaciones Observations	Tornillo Ø3.9 mm DIN7504N-A2 Screw Ø3.9 mm DIN7504N-A2

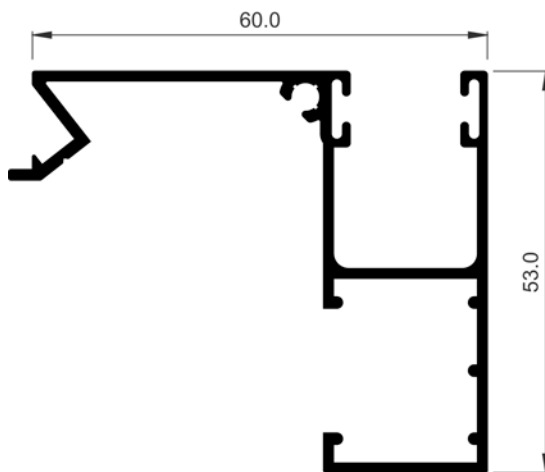

COR-2753	
Descripción Description	Guía de 60 mm Guide of 60 mm
Peso Weight (g/m)	761,4
Superficie Surface (dm ² /m)	42,42
Ix (cm⁴)	8,9
Iy (cm⁴)	10,72
Observaciones Observations	Tornillo Ø3.9 mm DIN7504N-A2 Screw Ø3.9 mm DIN7504N-A2

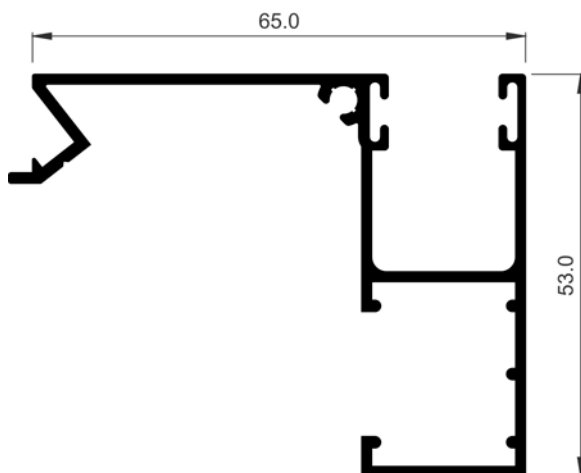

COR-2754	
Descripción Description	Guía de 65 mm Guide of 65 mm
Peso Weight (g/m)	777,6
Superficie Surface (dm ² /m)	43,42
Ix (cm⁴)	9,13
Iy (cm⁴)	13
Observaciones Observations	Tornillo Ø3.9 mm DIN7504N-A2 Screw Ø3.9 mm DIN7504N-A2

COR 80 HOJA OCULTA
Perfiles a escala

COR 80 HIDDEN SASH
Profiles to scale

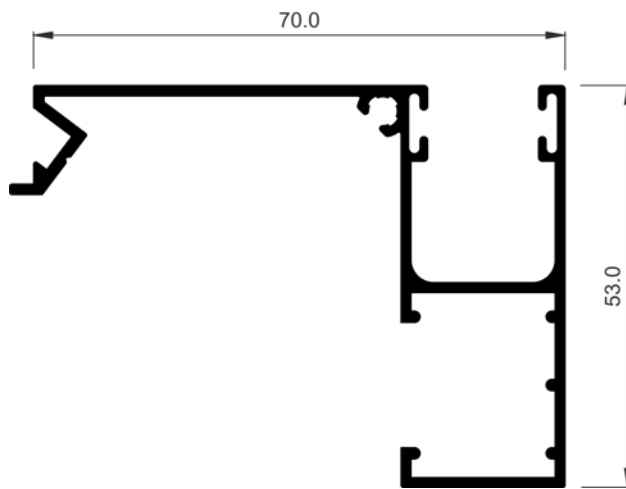

COR-2755	
Descripción Description	Guía de 70 mm Guide of 70 mm
Peso Weight (g/m)	810
Superficie Surface (dm ² /m)	44,33
Ix (cm⁴)	9,48
Iy (cm⁴)	16,21
Observaciones Observations	Tornillo Ø3.9 mm DIN7504N-A2 Screw Ø3.9 mm DIN7504N-A2

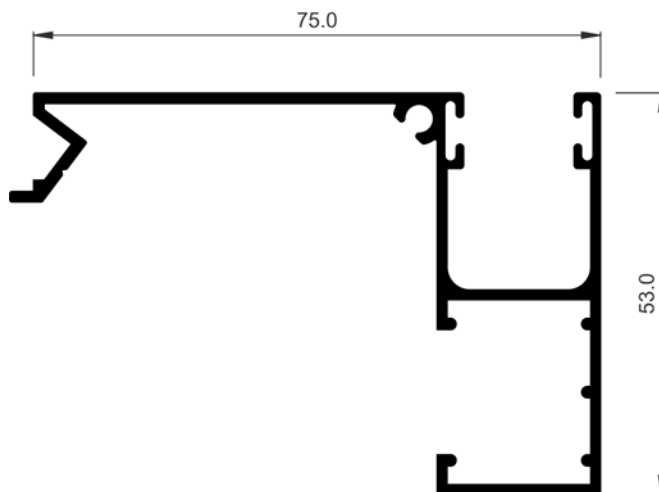

COR-2756	
Descripción Description	Guía de 75 mm Guide of 75 mm
Peso Weight (g/m)	828,9
Superficie Surface (dm ² /m)	44,99
Ix (cm⁴)	9,72
Iy (cm⁴)	18,84
Observaciones Observations	Tornillo Ø3.9 mm DIN7504N-A2 Screw Ø3.9 mm DIN7504N-A2

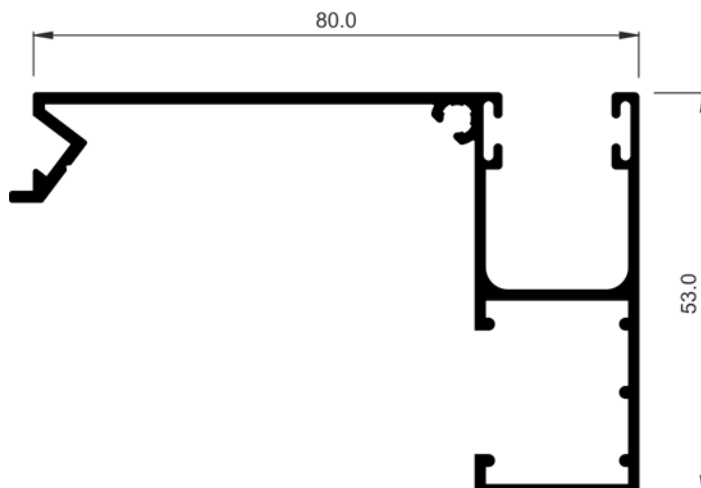

COR-2757	
Descripción Description	Guía de 80 mm Guide of 80 mm
Peso Weight (g/m)	847,8
Superficie Surface (dm ² /m)	46,33
Ix (cm⁴)	9,91
Iy (cm⁴)	22,59
Observaciones Observations	Tornillo Ø3.9 mm DIN7504N-A2 Screw Ø3.9 mm DIN7504N-A2

COR 80 HOJA OCULTA
Perfiles a escala

COR 80 HIDDEN SASH
Profiles to scale

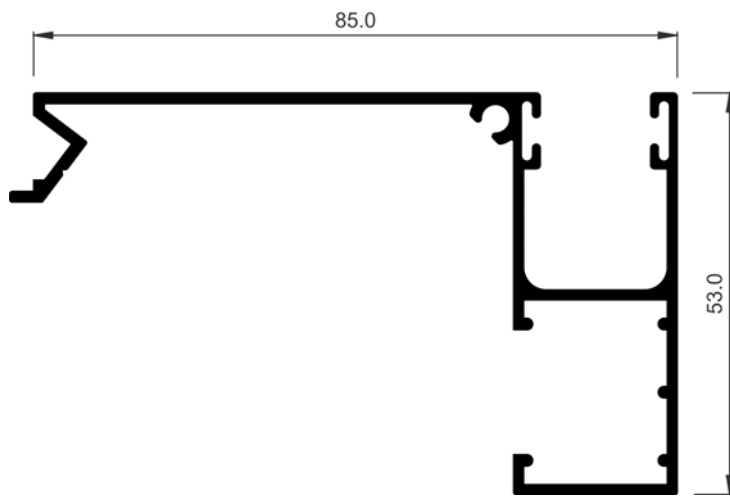

COR-2758	
Descripción Description	Guía de 85 mm Guide of 85 mm
Peso Weight (g/m)	866,7
Superficie Surface (dm ² /m)	46,99
Ix (cm⁴)	10,13
Iy (cm⁴)	25,79
Observaciones Observations	Tornillo Ø3.9 mm DIN7504N-A2 Screw Ø3.9 mm DIN7504N-A2

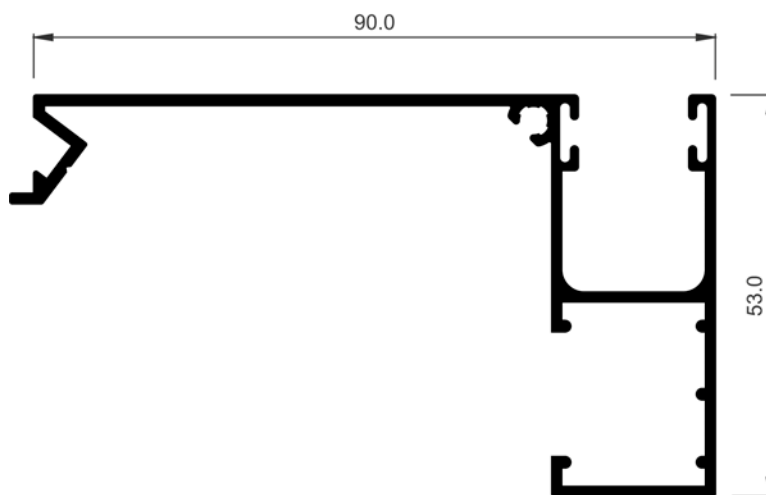

COR-2759	
Descripción Description	Guía de 90 mm Guide of 90 mm
Peso Weight (g/m)	885,6
Superficie Surface (dm ² /m)	48,32
Ix (cm⁴)	10,3
Iy (cm⁴)	30,36
Observaciones Observations	Tornillo Ø3.9 mm DIN7504N-A2 Screw Ø3.9 mm DIN7504N-A2

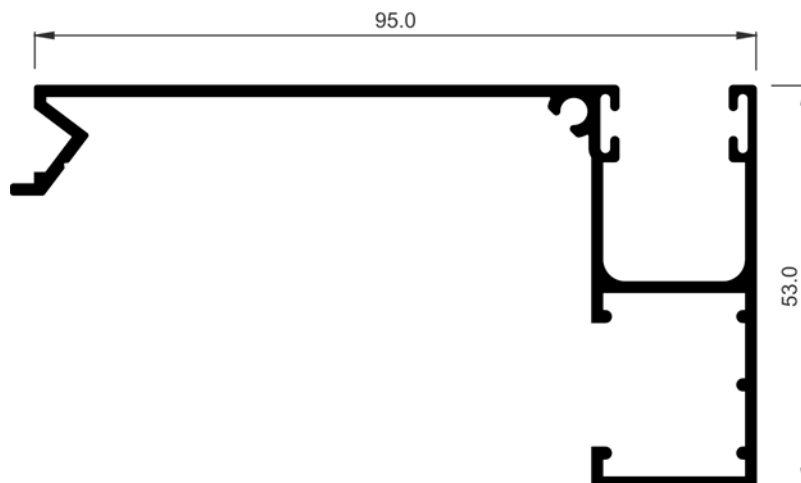

COR-2760	
Descripción Description	Guía de 95 mm Guide of 95 mm
Peso Weight (g/m)	918
Superficie Surface (dm ² /m)	48,83
Ix (cm⁴)	10,72
Iy (cm⁴)	34,47
Observaciones Observations	Tornillo Ø3.9 mm DIN7504N-A2 Screw Ø3.9 mm DIN7504N-A2

COR 80 HOJA OCULTA
Perfiles a escala

COR 80 HIDDEN SASH
Profiles to scale

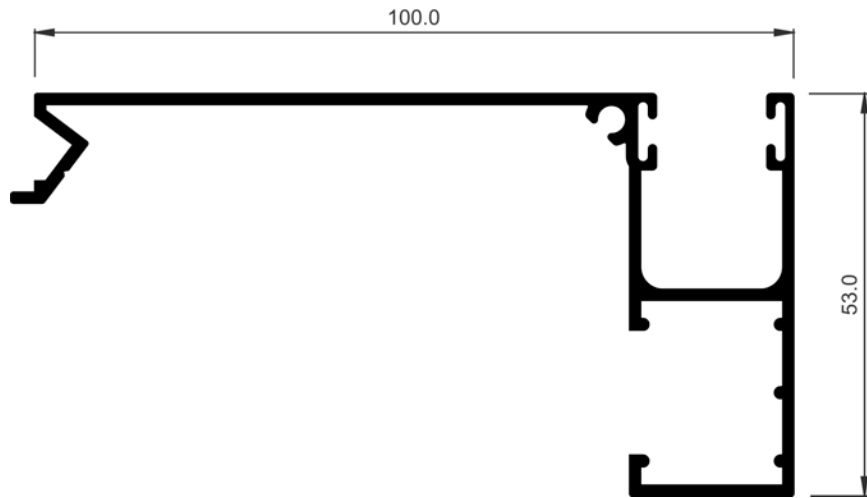

COR-2761	
Descripción Description	Guía de 100 mm Guide of 100 mm
Peso Weight (g/m)	950,4
Superficie Surface (dm ² /m)	49,73
Ix (cm ⁴)	11,1
Iy (cm ⁴)	39,59
Observaciones Observations	Tornillo Ø3.9 mm DIN7504N-A2 Screw Ø3.9 mm DIN7504N-A2

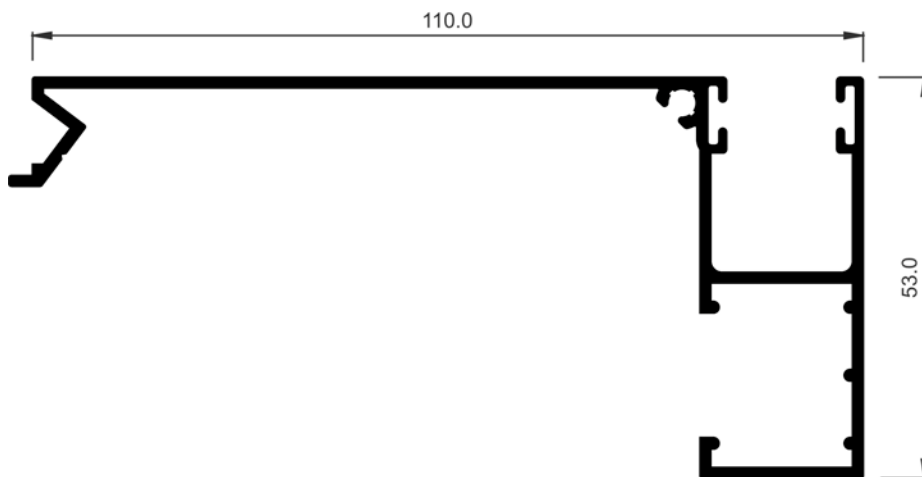

COR-2763	
Descripción Description	Guía de 110 mm Guide of 110 mm
Peso Weight (g/m)	977,4
Superficie Surface (dm ² /m)	52,13
Ix (cm ⁴)	11,4
Iy (cm ⁴)	50,19
Observaciones Observations	Tornillo Ø3.9 mm DIN7504N-A2 Screw Ø3.9 mm DIN7504N-A2

COR 80 HOJA OCULTA
Perfiles a escala

COR 80 HIDDEN SASH
Profiles to scale

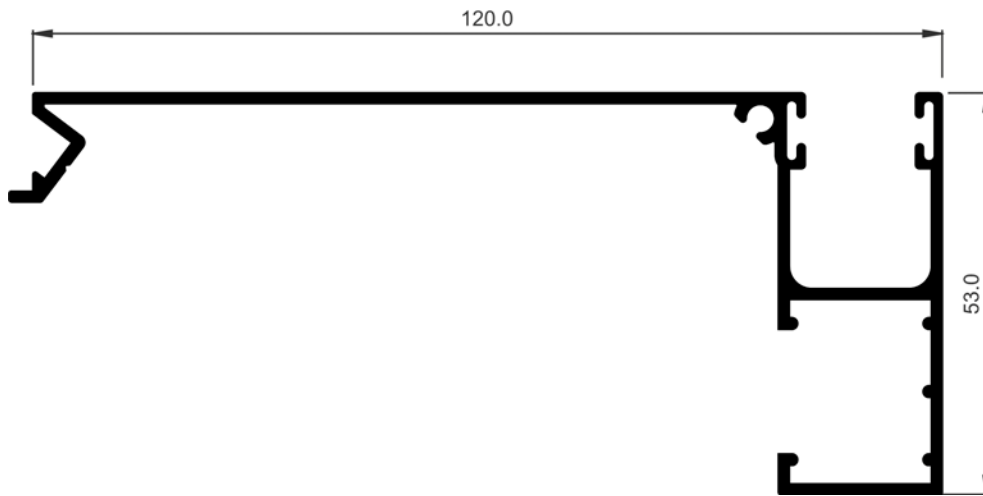

COR-2765

Descripción Description	Guía de 120 mm 120 mm guide
Peso Weight (g/m)	1028,7
Superficie Surface (dm ² /m)	53,82
Ix (cm ⁴)	63,68
Iy (cm ⁴)	11,77
Observaciones Observations	Tornillo Ø3.9 mm DIN7504N-A2 Screw Ø3.9 mm DIN7504N-A2

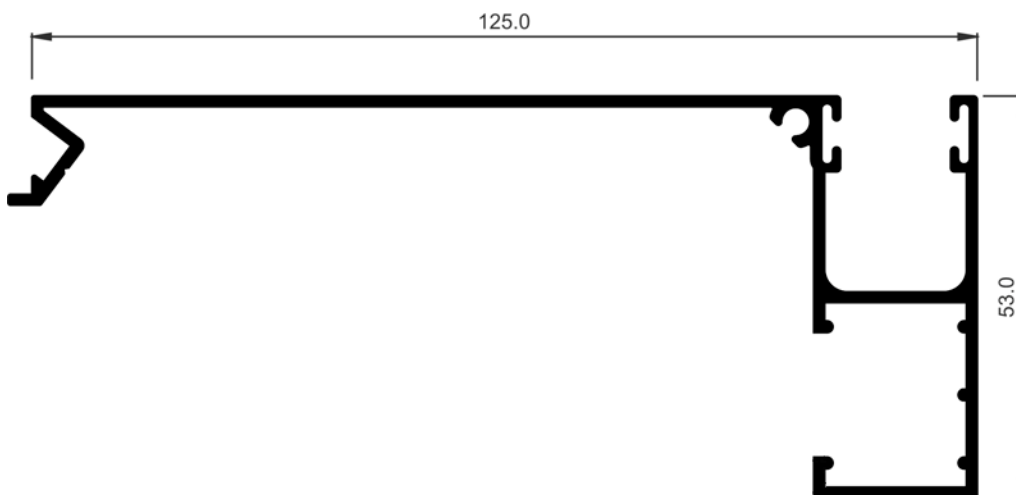

COR-2766

Descripción Description	Guía de 125 mm 125 mm guide
Peso Weight (g/m)	1047,6
Superficie Surface (dm ² /m)	54,82
Ix (cm ⁴)	11,93
Iy (cm ⁴)	70,69
Observaciones Observations	Tornillo Ø3.9 mm DIN7504N-A2 Screw Ø3.9 mm DIN7504N-A2

COR 80 HOJA OCULTA
Perfiles a escala

COR 80 HIDDEN SASH
Profiles to scale

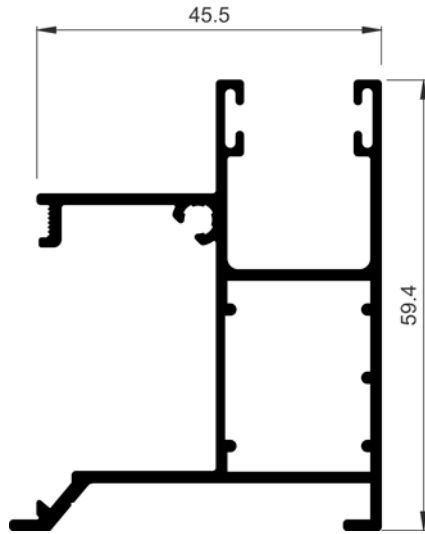

COR-2800	
Descripción Description	Guía de 45,5 mm embutir recogedor Cram scoop 45,5 mm guide
Peso Weight (g/m)	907,2
Superficie Surface (dm ² /m)	47,85
Ix (cm⁴)	10,85
Iy (cm⁴)	7,1
Observaciones Observations	Tornillo Ø3.9 mm DIN7504N-A2 Screw Ø3.9 mm DIN7504N-A2

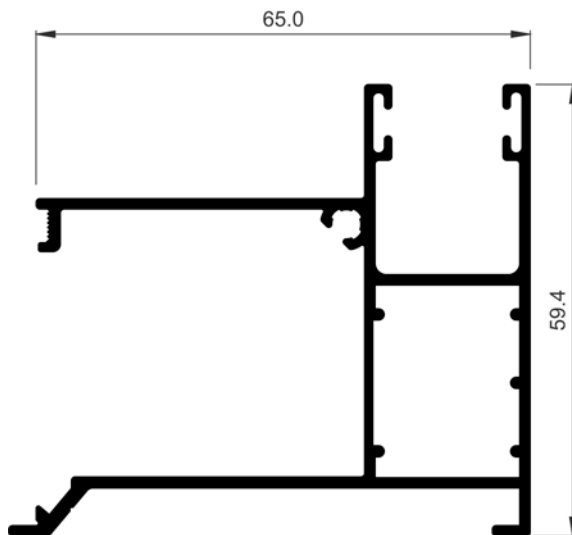

COR-2802	
Descripción Description	Guía de 65 mm embutir recogedor Cram scoop 65 mm guide
Peso Weight (g/m)	1061,1
Superficie Surface (dm ² /m)	55,65
Ix (cm⁴)	12,79
Iy (cm⁴)	16,98
Observaciones Observations	Tornillo Ø3.9 mm DIN7504N-A2 Screw Ø3.9 mm DIN7504N-A2

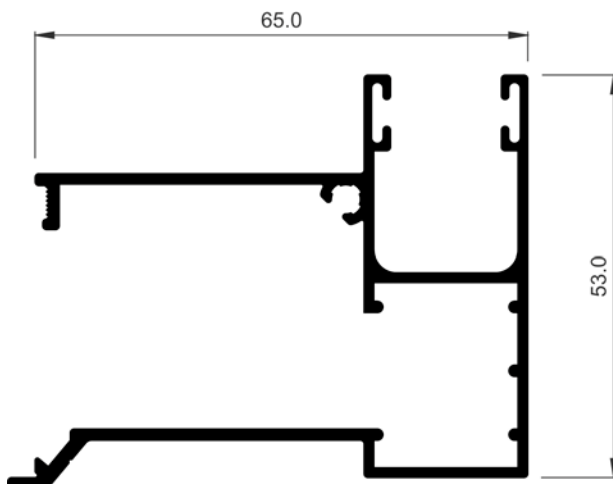

COR-2810	
Descripción Description	Guía de 65 mm embutir recogedor Cram scoop 65 mm guide
Peso Weight (g/m)	953,1
Superficie Surface (dm ² /m)	50,76
Ix (cm⁴)	10,16
Iy (cm⁴)	15,92
Observaciones Observations	Tornillo Ø3.9 mm DIN7504N-A2 Screw Ø3.9 mm DIN7504N-A2

COR 80 HOJA OCULTA
Perfiles a escala

COR 80 HIDDEN SASH
Profiles to scale

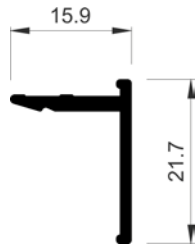

COR-7969	
Descripción Description	Tapa drenaje oculto Concealed drainage cover
Peso Weight (g/m)	162
Superficie Surface (dm ² /m)	7,54
Ix (cm⁴)	0,23
Iy (cm⁴)	0,13

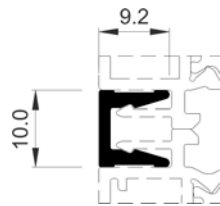

COR-4993	
Descripción Description	Unión marcos con enganche Frame joint profile with hook
Peso Weight (g/m)	108
Superficie Surface (dm ² /m)	5,18
Ix (cm⁴)	0,52
Iy (cm⁴)	0,28

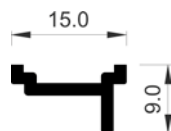

COR-7251	
Descripción Description	Unión de marcos oculta Concealed frame joint profile
Peso Weight (g/m)	105,3
Superficie Surface (dm ² /m)	5,15
Ix (cm⁴)	0,02
Iy (cm⁴)	0,08
Observaciones Observations	Tornillo Ø2.9 mm DIN7504N-A2 Ø2.9 mm DIN7504N-A2 screw

aluminiosiberica.pai.pt



Aluminios Iberica, Lda

Sede e Fábrica: Rua parque Industrial, Nº 126
4720-536 Lago Amares
Telef. 253 310 250 / 253 310 251 Fax. 253 311 830
Email: geral@aluminiosiberica.pt

Filiais:

Vila Real Lugar de Couços – EN 115
5000-122 Justes – Vila Real
Telef. 259 331 778 / Fax. 259 928 092
Email: vreal@aluminiosiberica.pt



EXEMPLO CONCRETO
Painéis Sandwich - Perfis - Chapas - Remates - Acessórios

Vila Nova de Gaia (Exemplo Concreto, LDA)
Rua Nova de São Caetano, nº3
4405-819 Vilar do Paraíso
Telef. 227 629 539
Email: gaia@exemploconcreto.com



Armazém: Est. Do Campo de Aviação
3510-824 Campo – Viseu
Telef. 232 459 138 / 232 459 741
Fax. 232 450 140
Email: geral@alviz.pt



Armazém: Zona Industrial de Vilamoura
Lote 28 - Apartado 841
8126 -910 Quarteira
Telef. 289 322 748 Fax. 289 301 928
Email: pala.loule@sapo.pt



Armazém: Av. Almirante Gago Coutinho
Portela de Sintra - Apartado 212
2711 - 901 Sintra
Telef. 219 244 074 / 219 244 101 Fax. 219 241 015
Email: angularlda@sapo.pt